

elevations

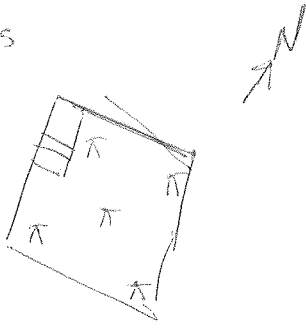

SITE <i>CH</i>	YEAR <i>04</i>	ROOM # or AREA NAME <i>m 32</i>	CONTEXT NUMBER <i>SR 338</i>
TYPE (positive, negative, wall) <i>positive</i>	DEFINITION (cut in floor of X, fill of pit Y, north wall of room Z, etc.) <i>collapse in room 32</i>		
DESCRIPTION (include consistency, color, composition, inclusions, dimensions; for cuts, also include shape and orientation) <i>layer of medium-large stones, large quantity of tile fragments in matrix of brown soil; covers entire area of room 32 - several pieces of modern material, ceramics are of mixed date, apparently typical for wall collapse (either material in fabric of walls) area of small charcoal flecks by Southside stairs.</i>			
MUNSELL COLOR <i>4/1 10YR (DARK GRAY)</i>	ELEVATIONS (if more than one, sketch locations on back) <i>Yes see back</i>		
FORMATION PROCESSES <u>NATURAL</u> ARTIFICIAL (circle one) <u>CASUAL</u> INTENTIONAL (circle one) TYPE: <i>collapse</i>			
STATE OF PRESERVATION <input type="checkbox"/> Very poor <input type="checkbox"/> Poor <input type="checkbox"/> Medium <input type="checkbox"/> Good <input checked="" type="checkbox"/> Very Good	STRATIGRAPHIC RELIABILITY <input type="checkbox"/> Very poor <input type="checkbox"/> Poor <input type="checkbox"/> Medium <input type="checkbox"/> Good <input checked="" type="checkbox"/> Very Good		
COVERS <i>SR 341, 346</i>	COVERED BY		
CUTS	CUT BY		
FILLS	FILLED BY		
ABUTS	ABUTTED BY		
EQUALS <i>338 339</i>	BONDS WITH		
INTERPRETATION <i>Collapse possibly induced by modern activity</i>			
MATERIAL DATABLE IN FIELD? (if yes, specify) <i>modern iron; 10th - 13th c ceramics</i>			PRELIMINARY DATE
FINDS (tick) <input checked="" type="checkbox"/> Pot <input checked="" type="checkbox"/> Bone <input checked="" type="checkbox"/> Glass <input checked="" type="checkbox"/> Metal <input type="checkbox"/> Wood <input type="checkbox"/> Leather <input checked="" type="checkbox"/> Tile <input checked="" type="checkbox"/> Other <input type="checkbox"/> None	TOTAL TILE WEIGHT (weigh in field) # buckets <i> </i>	SPECIAL FINDS (number and description, continue on back if necessary) <i>2114 Bone Handle 2104 Flat Marine Pottery 2116 waxed Bone Point 2101 Glass Frag of Vessel 2105 Glass in Glass 2102 Nail Frag Iron 2108 Glass Pin 2103 Glass 2109 Glass Bead 2111 Nail Head 2103 Glass</i>	
FLOAT? (Y/N) <i>N</i>	SAMPLE? (if yes, # and type) <i>N</i>	SECTION? (Y/N)	
PHOTO? (Y/N) <i>Y</i>	PLAN? (Y/N)	NOTEBOOK PAGES	SKETCH ON BACK? (Y/N) <i>N</i>
STRATIGRAPHIC NOTES/DOUBTS (include any comments on methods, contamination, excavation conditions, or anything else that seems relevant) <i>Rubble to S. Western Door b/w Rm 32 & 29 removed as part of this layer. Mixed in area to north ^{east} some pieces of 2.5 yr 4/4 Reddish Brown in Northeast. (this area assigned context # 346). Charcoal Sample taken from South side of stairs.</i>			
DATE <i>6/24/04</i>		INITIALS <i>g</i>	

Closed ✓