

SITE CHOBSP	YEAR 2006	ROOM # or AREA NAME Courtyard	CONTEXT NUMBER 0757
----------------	--------------	----------------------------------	------------------------

TYPE (positive, negative, wall) positive	DEFINITION (cut in floor of X, fill of pit Y, north wall of room Z, etc.) loose brown soil in NW courtyard
---	---

DESCRIPTION (include consistency, color, composition, inclusions, dimensions; for cuts, also include shape and orientation)

Loose brown layer that ~~was~~ had a high concentration of ceramics (^{many} ~~that~~ large in size) $\approx 10-20$ cm

Context R $\approx 70 \times 70$ cm. It was not very thick, less than 5 cm in depth from Dima's previously excavated trench to section 1. From section 1 to section 2 it varied in depth, taking a dive to as much as 15 cm in the center between the well + section 2. However, on both sides of the well it remained thin and near section 2 it thinned again. It was not located in Area 3, possibly due to the several pits that extended across the unit near section 2.

MUNSELL COLOR 7.5 YR 4/2	Color Brown
-----------------------------	----------------

FORMATION PROCESSES NATURAL ARTIFICIAL (circle one) CASUAL INTENTIONAL (circle one) TYPE: Accumulation

STATE OF PRESERVATION <input type="checkbox"/> Very poor <input type="checkbox"/> Poor <input checked="" type="checkbox"/> Medium <input type="checkbox"/> Good <input type="checkbox"/> Very Good	STRATIGRAPHIC RELIABILITY <input type="checkbox"/> Very poor <input type="checkbox"/> Poor <input checked="" type="checkbox"/> Medium <input checked="" type="checkbox"/> Good <input type="checkbox"/> Very Good
---	--

COVERS 0758, 0759, 816, 823,	COVERED BY 0752
---------------------------------	--------------------

CUTS	CUT BY 0763
------	----------------

FILLS 0834	FILLED BY
---------------	-----------

ABUTS	ABUTTED BY
-------	------------

EQUALS	BONDS WITH
--------	------------

INTERPRETATION

Possible surface / ~~maybe~~ fill
more likely a fill

MATERIAL DATABLE IN FIELD? (if yes, specify)	PRELIMINARY DATE
--	------------------

FINDS (tick) <input checked="" type="checkbox"/> Pot <input checked="" type="checkbox"/> Bone <input checked="" type="checkbox"/> Glass <input checked="" type="checkbox"/> Metal <input type="checkbox"/> Wood <input type="checkbox"/> Leather <input checked="" type="checkbox"/> Tile <input checked="" type="checkbox"/> Other <input type="checkbox"/> None plaster	TILE: (quantity buckets?)	SPECIAL FINDS (number and description, continue on back if necessary) 3655 spindle wheel (ceramic) 3665 iron object 3661 bronze object 3654 bronze wire
---	---------------------------	--

FLOAT? (Y/N) <input checked="" type="checkbox"/>	SAMPLE? (if yes, # and type)	SECTION? (Y/N)
--	------------------------------	----------------

PHOTO? (Y/N) <input checked="" type="checkbox"/>	PLAN? (Y/N)	NOTEBOOK PAGES SM: 4, 12, 15-18, 36	SKETCH ON BACK? (Y/N) <input checked="" type="checkbox"/>
--	-------------	--	---

STRATIGRAPHIC NOTES/DOUBTS (include any comments on methods, contamination, excavation conditions, or anything else that seems relevant)

Context ~~extends from~~ is surrounded by wall 297 on the west, unexcavated or on the S, excavated trench on the N and the balk b/w the well + well on N/NE.
1 piece of slag recovered.

DATE 26.VI.06	INITIALS SM	CLOSED (tick)
------------------	----------------	---------------

Area 2 contained vitreous + iron slag. Filled a sort of depression, ~~but~~ but not defined/delineated or given a cut, ~~the~~ plan 90 shows the resulting envelope.

SPECIAL FINDS (continued)



SKETCH



Context
757



new
excav
franch

slab

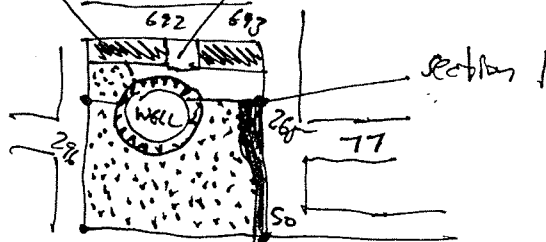

cut 0763