

SITE CH068R	YEAR 06	ROOM # or AREA NAME Church	CONTEXT NUMBER 0798
TYPE (positive, negative, wall) positive	DEFINITION (cut in floor of X, fill of pit Y, north wall of room Z, etc.) gray brown soil in the center of church		
DESCRIPTION (include consistency, color, composition, inclusions, dimensions; for cuts, also include shape and orientation) the area in front of the <sup>(S/SW)</sup> apse central part of church between the apse and the tombs. A light greyish brown earthy soil. Dimensions @ definition are $\approx$ 155 cm across (NE-SW) by 2.5 M (NW-SE). Includes tile, ceramic, human and animal bones, small quantity of charcoal. Several articulated skeletons lay next to each other.			
MUNSELL COLOR 5YR 6/2			
FORMATION PROCESSES NATURAL <u>ARTIFICIAL</u> (circle one) CASUAL INTENTIONAL (circle one) TYPE:			
STATE OF PRESERVATION <input type="checkbox"/> Very poor <input type="checkbox"/> Poor <input checked="" type="checkbox"/> Medium <input type="checkbox"/> Good <input type="checkbox"/> Very Good		STRATIGRAPHIC RELIABILITY <input type="checkbox"/> Very poor <input type="checkbox"/> Poor <input checked="" type="checkbox"/> Medium <input type="checkbox"/> Good <input type="checkbox"/> Very Good	
COVERS 881, 878, 999	COVERED BY		
CUTS	CUT BY		
FILLS 919, 923, 924	FILLED BY		
ABUTS	ABUTTED BY		
EQUALS	BONDS WITH		
INTERPRETATION			
MATERIAL DATABLE IN FIELD? (if yes, specify)			PRELIMINARY DATE
FINDS (tick) <input checked="" type="checkbox"/> Pot <input checked="" type="checkbox"/> Bone <input checked="" type="checkbox"/> Glass <input checked="" type="checkbox"/> Metal <input type="checkbox"/> Wood <input type="checkbox"/> Leather <input checked="" type="checkbox"/> Tile <input type="checkbox"/> Other <input type="checkbox"/> None	TILE: (quantity buckets?) ###	SPECIAL FINDS (number and description, continue on back if necessary) 3708 - plate 3709 - nail 3710 - game piece 3725 - glass 3727 - metal pin 3611 - Arc. frag-t (Plaster) 3612 - frag-t of whetstone 345 - Bone clasp 3616 - Bronze nail 3666 - Bronze coin 3702 - Bronze coin	
FLOAT? (Y/N)	SAMPLE? (if yes, # and type) 580, 651, 716, 719	SECTION? (Y/N)	
PHOTO? <input checked="" type="checkbox"/> (Y/N)	PLAN? (Y/N)	NOTEBOOK PAGES ASG-7, 10-12	SKETCH ON BACK? (Y/N)
STRATIGRAPHIC NOTES/DOUBTS (include any comments on methods, contamination, excavation conditions, or anything else that seems relevant) Sint in nails (excavated extent) with Flint Human & animal bones recovered			
DATE 3-VII-06		INITIALS AS	CLOSED (tick)

SPECIAL FINDS (continued)

- 3715 - Bronze Coin
- 3733 - Lead Strip
- 3740 - Iron Obj.
- 3743 - Bronze Coin
- 3744 - Iron obj.
- 3747 - Iron obj.
- 3749 - Iron obj.
- 3753 - Bronze Tack.
- 3758 - Lead Strip.
- 3771 - Bronze Obj.
- 3775 - Bronze Obj.
- 3776 - Millstone
- 3778 - Iron Ring

- 3780 - Iron Obj.
- 3785 - Marble Tile
- 3790 - Stone Stopper
- 3794 - Arc. frag-t Marble
- 3795 - Arc. frag-t Stone
- 3797 - Stone Grindstone
- 3806 - Stone Millstone
- 3817 - Iron obj.
- 3822 - Iron obj.
- 3824 - Bone piece
- 3826 - Nail with wood
- 3829 - Bronze obj.
- 3861 - Iron obj.
- 3862 - Iron obj.

- 3868 - Iron obj.
- 3870 - Iron obj.
- 3872 - Bronze coin
- 3873 - Bronze coin
- 3875 - Iron Strip.
- 3876 - Iron Strip.
- 3879 - Bronze strip
- 3884 - Glass Bead
- 3885 - Bronze Coin

SKETCH

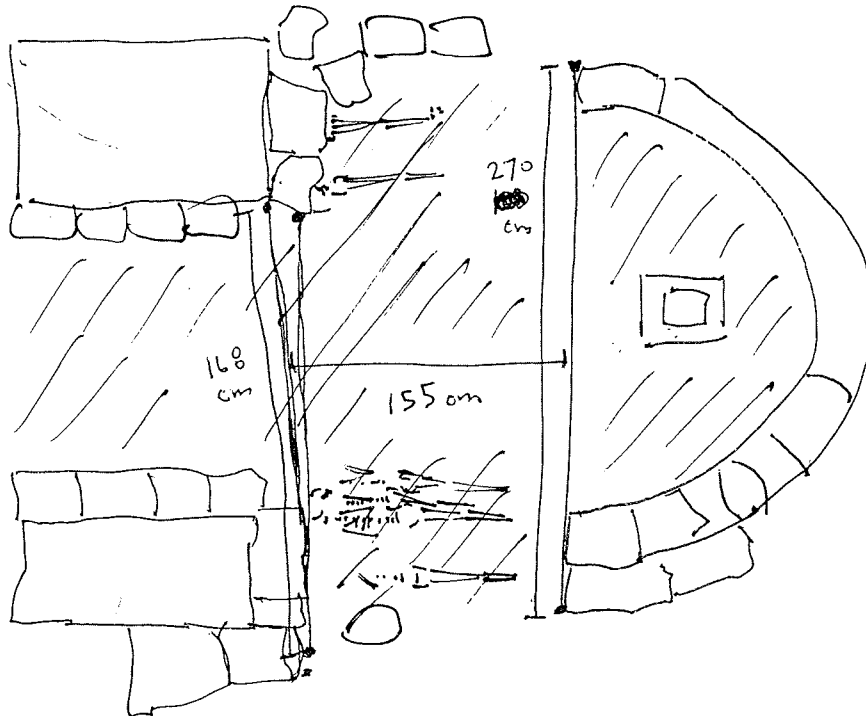

SM. & AS