

# Summary

Site:

General Area:

Level : — defined as —

actual levels

date excavated

Square

Features

Finds

Comments

**PIZZICA 1977**



*Mario*

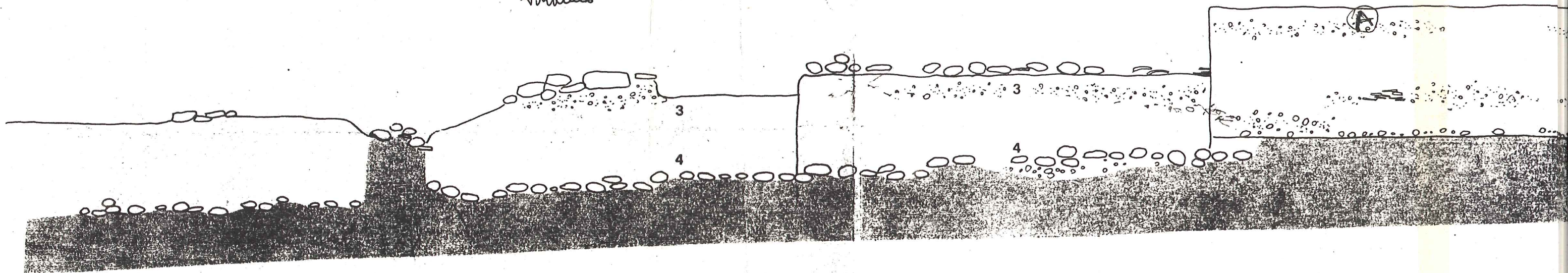

**SECTION W-E**

~~W-1, N-8~~  
N-1, N-8

WITH (77) LEVELS

7 SUPERIMPOSED (82) LEVELS





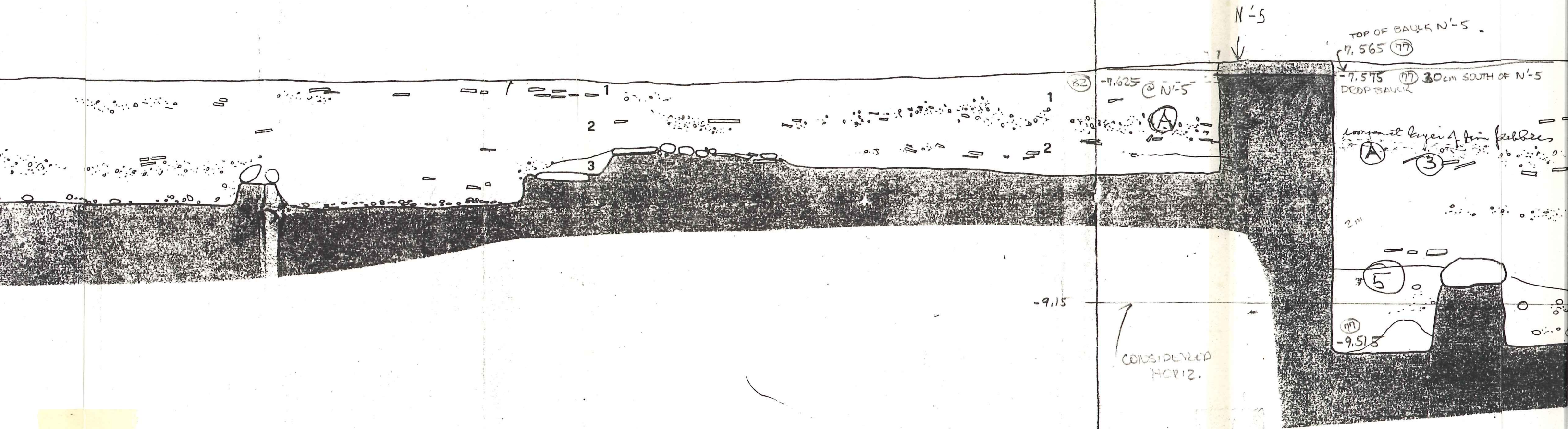



on dry range

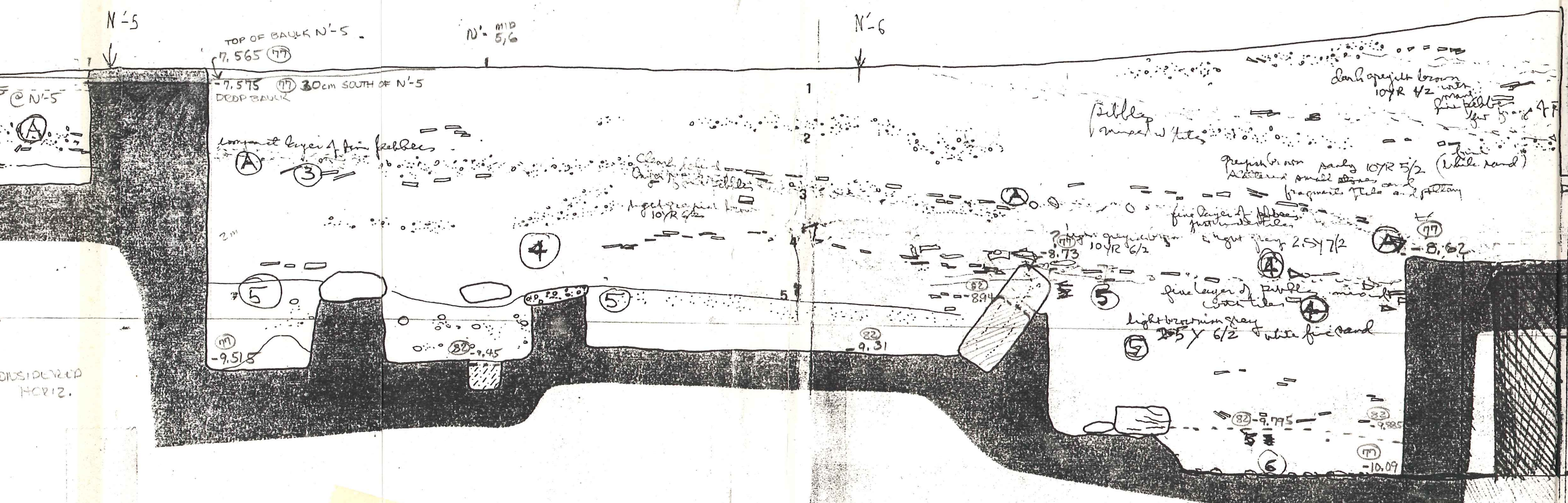

N-5

TOP OF BANK N-5

7.565 (77)

N- MID 5,6

N-6

N- MID 6,7

7.575 (77) 30cm SOUTH OF N-5  
DEEP BANK

compact layer of fine pebbles

(A)

(3)

Clear bed of  
10YR 6/2

light brown  
10YR 6/2

(4)

(5)

(77)  
-9.515

(82)  
-9.45

(82)  
-9.31

(77)  
-8.73

(5)

light brown grey  
2.5 x 6/2 white fine sand

(A)

(77)

-8.62

fine layer of pebbles  
10YR 6/2

(A)

(4)

(A)

(5)

(6)

(82)  
-9.775

(82)  
-9.825

(77)

-10.09

pebbles  
mixed w tiles

dark greyish brown  
10YR 4/2

fine pebbles  
10YR 4/2

greyish brown sandy  
10YR 5/2

(white sand)

scattered small stones and  
fragments of tiles and pottery

fine layer of pebbles  
10YR 6/2

light greyish brown  
10YR 6/2

(77)

(5)

DISORDERED  
HORIZ.



on dry surface

N-6  
MID  
5,7  
1

N-6

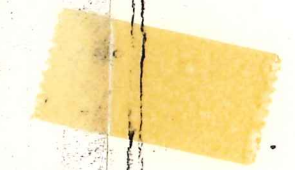
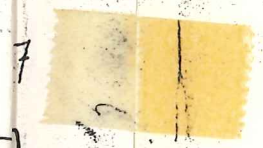
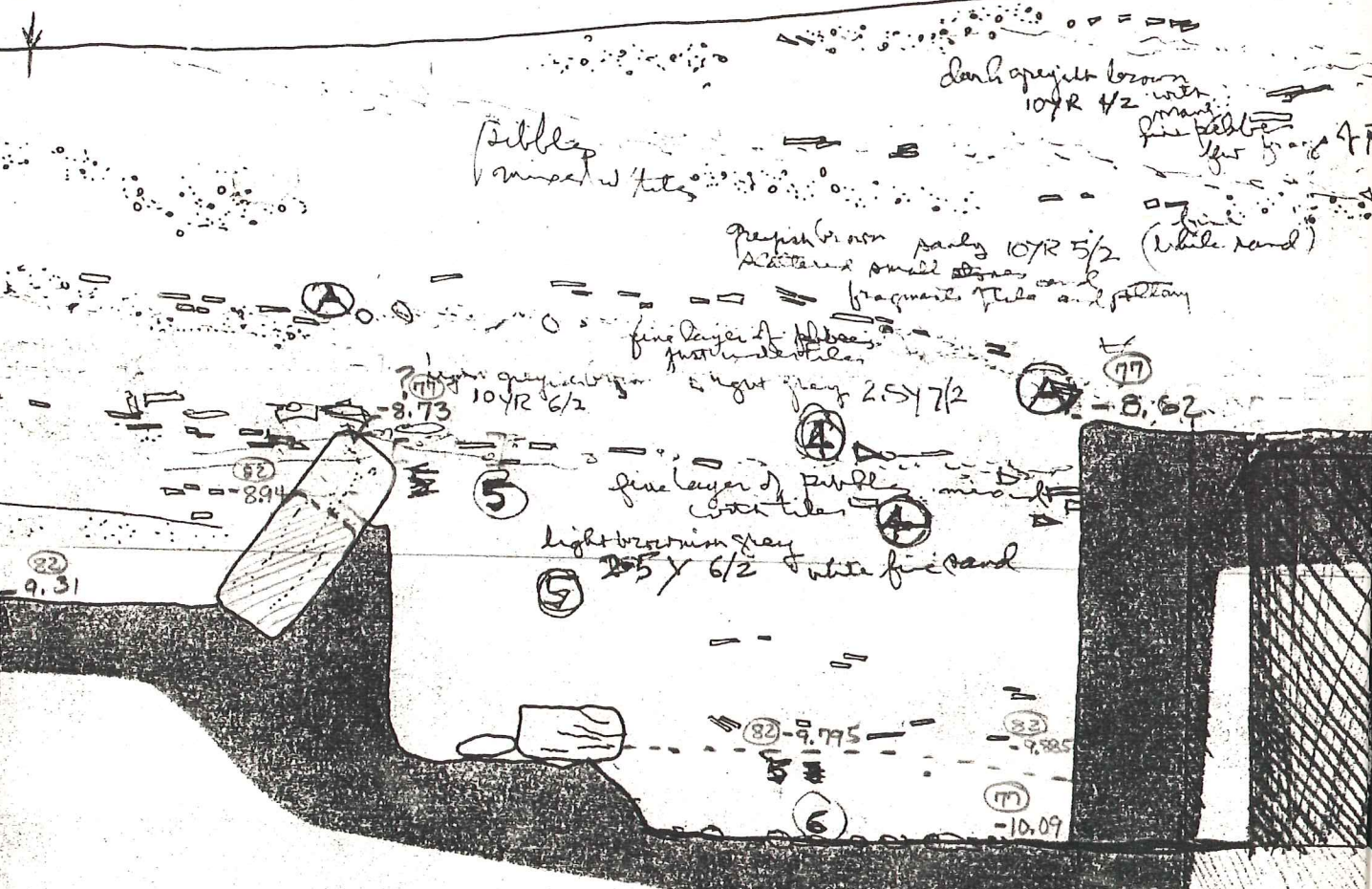

125





**PIZZICA 1982:  
SITE PLAN**

SCALE: 1:50





N-S bank in N-6/O-6 removed in 1982

Soil Sample

to take

→ Layer 4 - Grey clay above pavement

→ Layer 5 - Burned / bitume

Layer 4 - like 3, directly above tiles  
and burned layer

Layer 3 -

Layer 2

Layer 1.



Farmhouse

N'-4 level 2

lamp nozzle P2 464 T  
R.F. sherd 72 466 P

walls begin to emerge in  
this level

TC Statuette 473 T  
Stanger Statue 469 P.  
Roman lamp 467 T  
BG base 509 P  
Strigil 489 M

M'-3 M'-4 level 2

walls begin to emerge

mixed BG and greyware  
498, 499 P.

482

485

L.2 in M'-3 is level under  
gravel, in M'-4 it is  
level under gravel

loomweights  
votive vase 484



Level 3



RF shed 77-552  
draped female - a few  
cimo belt level of wall  
6'

Note - DRAPE female could be.  
77-549P. the one  
I believe to be PISTICI PTIR

M1-3 M4 L3  
AREA S. of WALL 5'  
(Now in PHOTO BOX 1)



(From 1977 notes)

N<sup>1</sup>-5

L.1 p 179 'little meters'  
drawing 27

L.2 p 179 Ca 50 cms below L.1. gravel, small stones  
drawing 27 in NW corner

L.3 p. 179 under tile fall, frags of bricked tiles  
drawing 27 columns

L.4 p 71 layer of stones in E  
drawing 27

L.5 p. 71-79 below layer of stones (same as  
that in N<sup>1</sup>-4, O<sup>1</sup>-4

b.2. nice black soil no stones  
some BF. Gorgons head - in O<sup>1</sup>-5  
Soil sample 77-70955  
black clay in brown clay with streaks  
of red sand. level of sample - 9.33

b.3 6<sup>th</sup> cut Polley. Black heavy  
soil complete

b.4. Complete TC of same (77.725)

b.5 6<sup>th</sup> cut material bronze shagil  
(77.735)

This brings us down to level  
of virgin soil



Area M-7 Excavation west half Level below bat 3

1. Subject

2. Horizontal location

3. Vertical location, strat. position

4. Dimensions

5. Matrix

6. Associations

BM .07 Hs E-6681

7. Description, discussion, sketch

A	3.11		D	3.23	D	3.405	
UPPER B	3.34	B	3.47	E	3.18		
C	3.17	C	3.52	F	3.15	F	3.345
H				G	3.14		
				H	3.09		

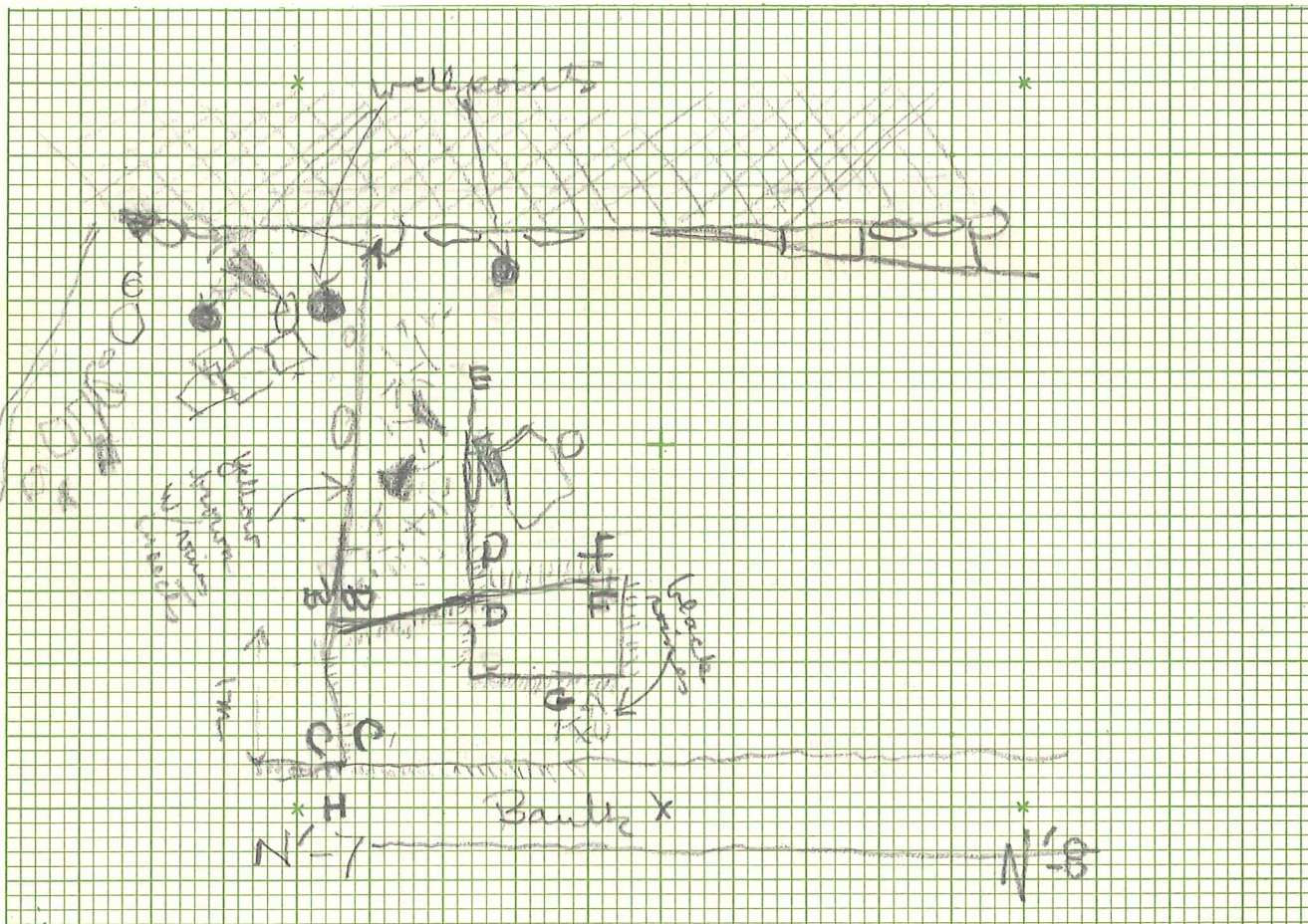

Scale 1:50 Title

Worked by, using trowel

Disposal of specimens

Reference

Photos Recorded by Jca Date 7/5/82



Area M-7W Excavation \_\_\_\_\_ Level below b. 3

1. Subject relation of layers of organic material NW quad 15 Estame in

2. Horizontal location SE quarter

3. Vertical location, strat. position \_\_\_\_\_

4. Dimensions \_\_\_\_\_

5. Matrix \_\_\_\_\_

6. Associations \_\_\_\_\_

7. Description, discussion, sketch \_\_\_\_\_

Sketch. Correct elevation on map

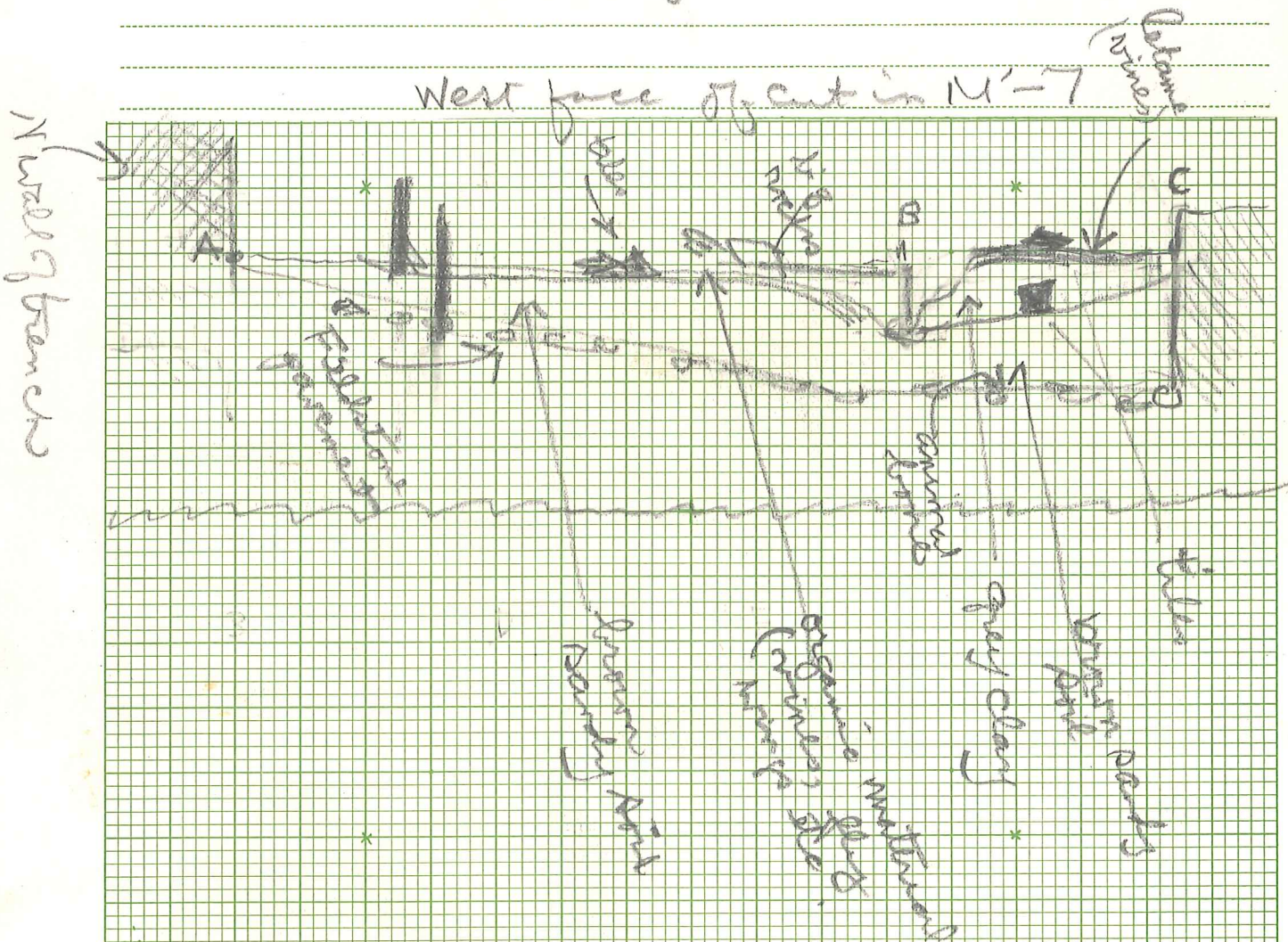

Scale 1:25 Title \_\_\_\_\_

Worked by, using \_\_\_\_\_

Disposal of specimens \_\_\_\_\_

Reference \_\_\_\_\_

Photos \_\_\_\_\_ Recorded by JCC Date 7/5/82



Area..... Excavation..... Level.....

1. Subject.....

2. Horizontal location.....

3. Vertical location, strat. position.....

4. Dimensions.....

5. Matrix.....

6. Associations.....

7. Description, discussion, sketch.....

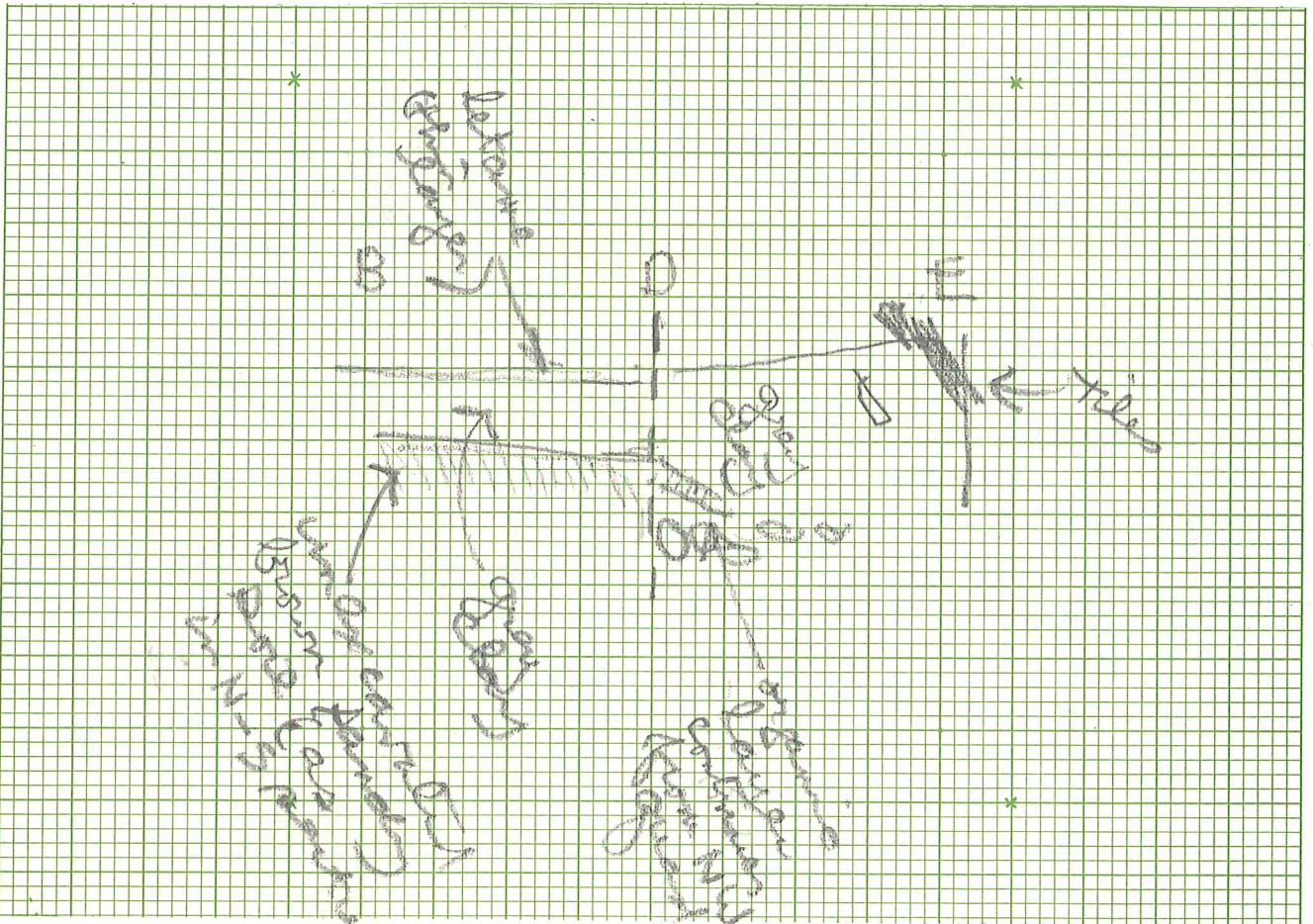

Scale..... Title.....

Worked by, using.....

Disposal of specimens.....

Reference.....

Photos..... Recorded by.....

Date 7/5/82



Canal 0'2

Battuta 7

Munsell: 10YR 4/2 (la parte sud)

Terra - albicciolo molto argilloso; p. rosso VERDE molto argilla con sabbia.

Ceramica - molti pezzi di vaso di tipo a sezione nera trovati tra le tegole anche in terra rossa nel terreno argilloso

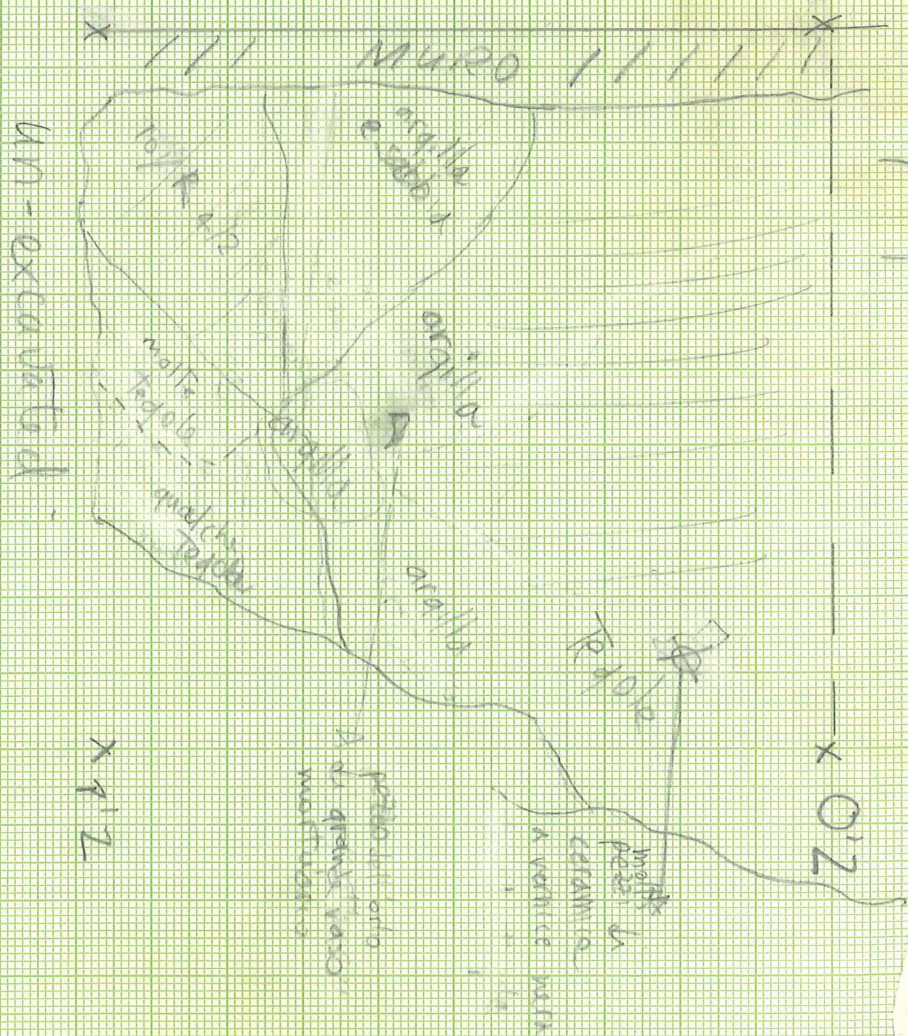

23-VII-82

F.

46 1512

10 X 10 TO THE CENTIMETER KEUFFEL & ESSER CO. MADE IN U.S.A.

KE

20



Canal

Batt. 6  
Level C

Beginning Batt. 5 -

Mature Munsell 10YR 4/6 - Clay and sand - with  
 2 small areas of argill. Earth comes up in large  
 clay chunks, but just S. there is gravelly clay.  
 The large limestone pits on top of the fall. North  
 of large limestone are no pits - only clay.  
 Large moulded (in decoration) mortar stones, which is  
 found just to the other 2 blocks just north of large  
 limestone. The pits here seem to continue South  
 from the catwalk base + columns down, found  
 June 14. The clay areas have puddles of  
 water in them.

- End Levels:
- P13 -9.14
  - P12 -9.22
  - Cr. of the fall -9.09
  - O'3 -9.15
  - O'2 -9.14



Photos after Batt. 6

JB. 23-VII-82

46 1512

KE 10 X 10 TO THE CENTIMETER 18 X 25 CM. KEUFFEL & ESSER CO. MADE IN U.S.A.



8

Area Level Excavation Level bat 3, Level A

1. Subject

2. Horizontal location square 0'2

3. Vertical location, strat. position Levels are end levels (A -)

4. Dimensions

5. Matrix "very dark grey clay" 10YR 3/1

6. Associations Small tiles and amphora fragments, smooth cobbles + pebbles.

7. Description, discussion, sketch Clay come up in large clumps which are difficult to haul on the shovel. Moist. Boxes found at junction of this square with N'2.

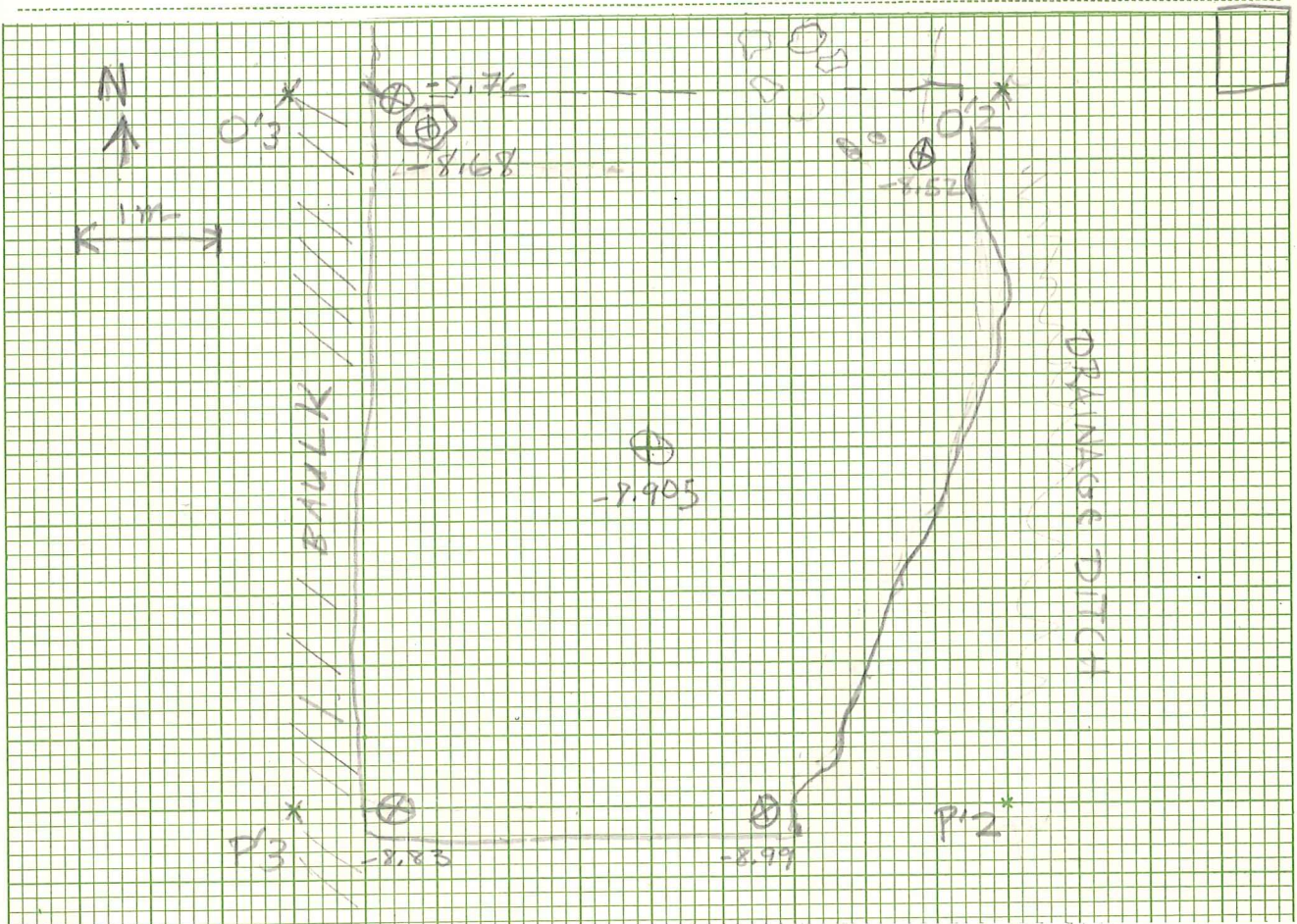

Scale 1 m. Title

Worked by, using

Disposal of specimens N'2 - 0'2 Batt 3 - 2 small bags pottery, 1 small bag boxes

Reference

Photos  Recorded by JCC; JB Date 10 - VI - 82



9

Area Canal Excavation \_\_\_\_\_ Level Batt. 3 (Level A)

1. Subject \_\_\_\_\_

2. Horizontal location square N'2

3. Vertical location, strat. position Levels taken are end levels (after Batt. 3)

4. Dimensions \_\_\_\_\_

5. Matrix 10YR 3/1 Vy. DK. Gray Clay.

6. Associations S-most meters; roof tiles, slightly more pottery, (coarse ware)

7. Description, discussion, sketch Clay moist in large, dense chunks

stone = stone limestone = limestone PUDDING STONE FEEDLES

Possible column drum, elev. -8.625 on top. It appears unfluted, in 2<sup>nd</sup> M. to West, 2<sup>nd</sup> M. to North of Square. A scatter of stones and limestone chunks appears in Ctr. and N.W. corner (at N'2).

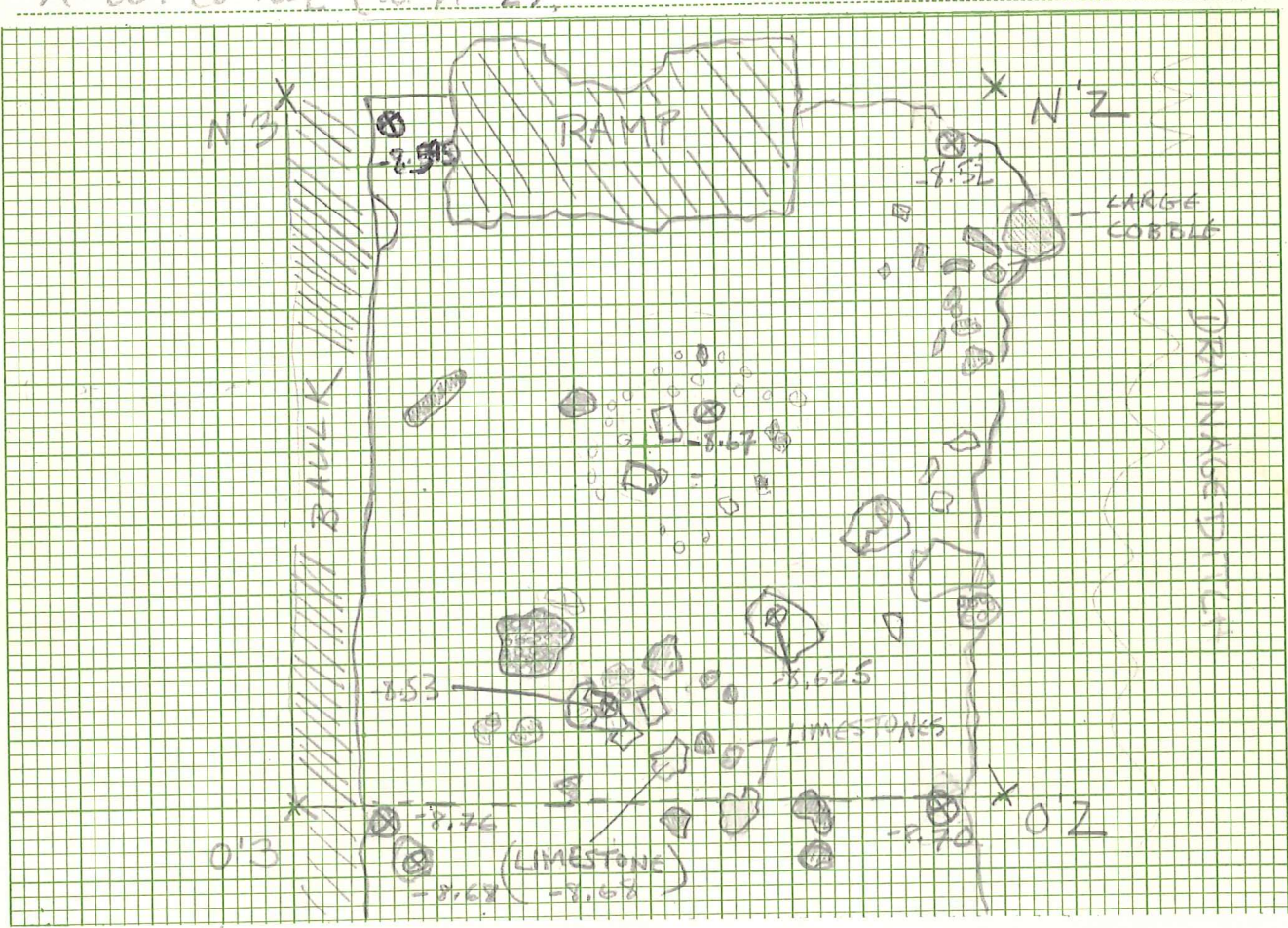

Scale 1M Title \_\_\_\_\_

Worked by, using Picks + shovels Dumper 5 workmen

Disposal of specimens O'2-N'2 Batt 3 2 small bags pottery 1 small bag. bones.

Reference \_\_\_\_\_

Photos  Recorded by JB Date 10-11-82



Area Canal Excavation Level bat 2 (bottom of)  
level 5 (⊗ -) are end levels

1. Subject

2. Horizontal location N' 2

3. Vertical location, strat. position Levels (⊗ -) are end levels

4. Dimensions

5. Matrix (sun-dried - early d.m.) 10YR 3/1 Vg DK. Gray (Clay)

6. Associations Scattered roof tile frags, some scattered smoothed pebbles; Bones more frequent in Northernmost meter

7. Description, discussion, sketch pudding stones are

OTHER stones are limestone (Calcarenta di G.), (unless labelled otherwise)

2 Pudding Stones protrude part way from matrix. Appear to lie on E-W axis in relation to ea other. Scattered limestone chunks.

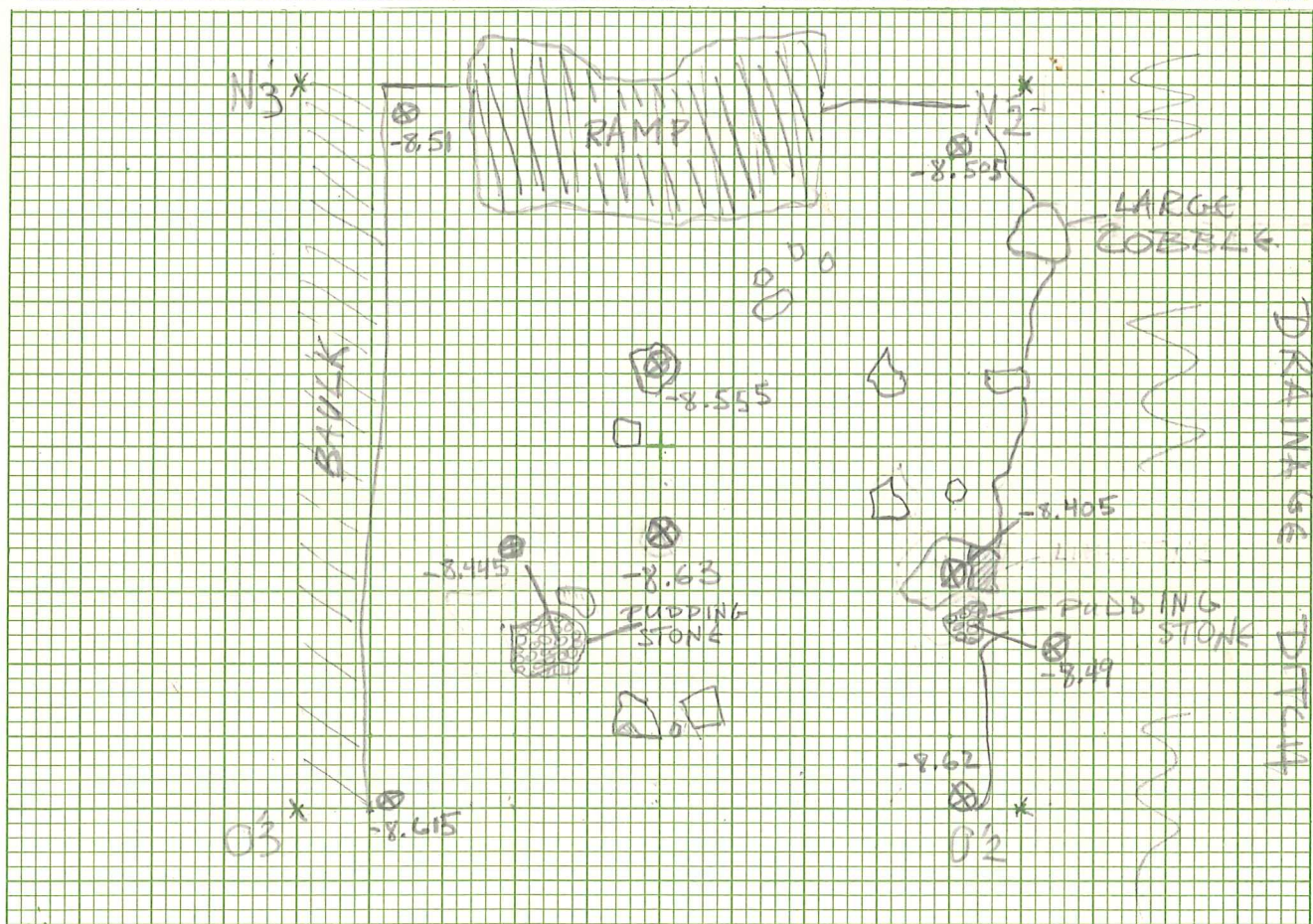

Scale  $\longleftrightarrow$  1 = 1/2 M. Title

Worked by, using

Disposal of specimens — dug previous to sketch

Reference

Photos  Recorded by Jennifer Brehob (J.B.) Date 10-VI-82



Area Canal Excavation Level Batt 1, Level A

1. Subject

2. Horizontal location M'Z

3. Vertical location, strat. position LEVEL A Levels taken after removal of dried grass.

4. Dimensions

5. Matrix Dried grass, thin layer (0.5 cm.) Roof tile frags, small pebbles.

6. Associations 10YR 3/1 Very Dark Grey

7. Description, discussion, sketch Earth is in smaller clumps + is drier, -densely filled with pebbles and tile frags. No pottery was picked up.

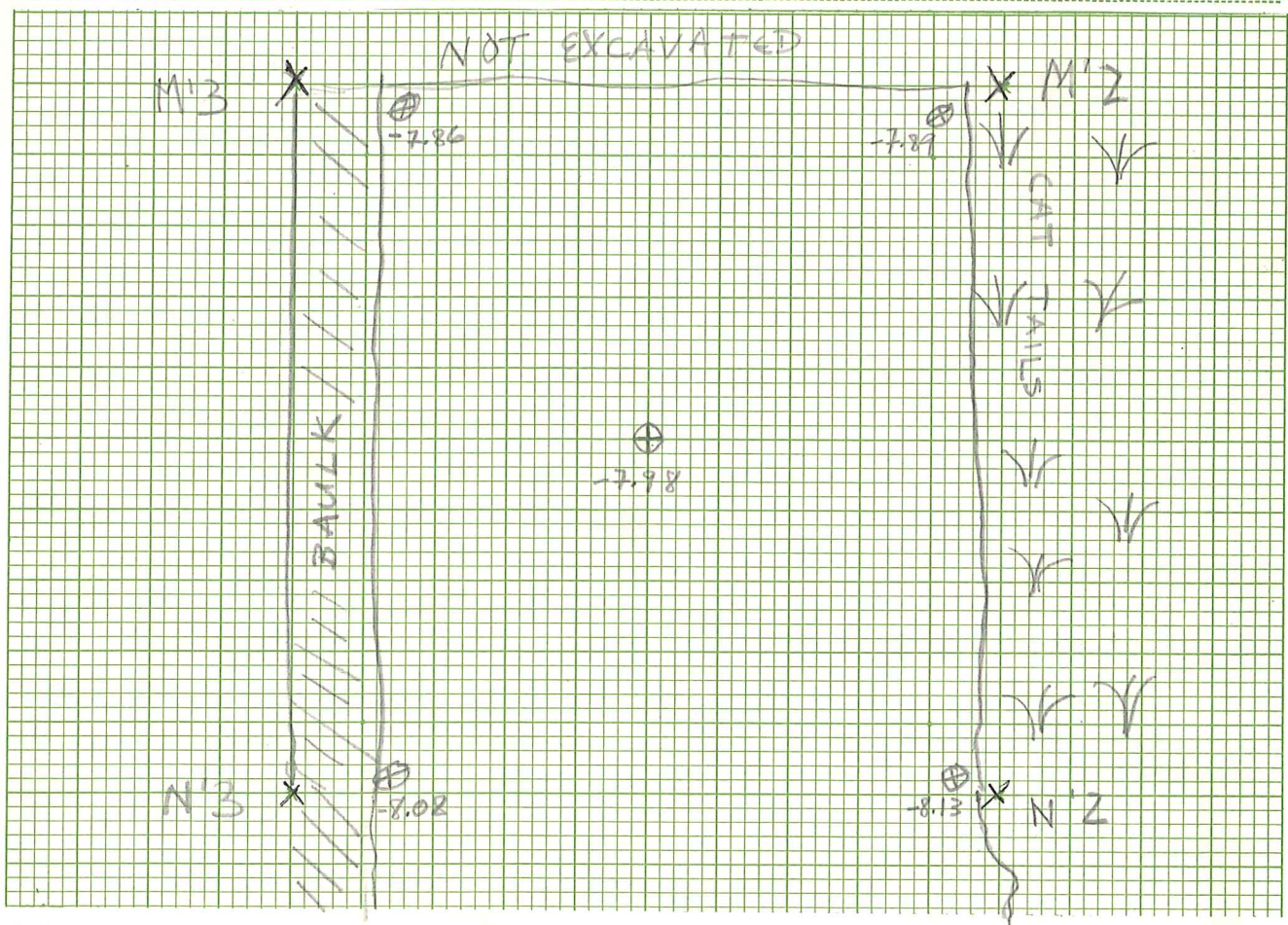

Scale Title

Worked by, using

Disposal of specimens No Finds

Reference

Photos Recorded by J.B. Date 10-VI-82



Area Canal Excavation

Level Bat 1, Level A

1. Subject

2. Horizontal location M'2

3. Vertical location, strat. position End levels are given.

4. Dimensions

5. Matrix 10YR 3/1 Very Dark Grey 10YR 4/2 Dark greyish brown when dry.

6. Associations Dense concentration of roof-tile frags and smooth pebbles.

7. Description, discussion, sketch Approx. 1/2 of this Bat. was dug 10-VI-82, and the rest in the a.m. 11-VI-82. There were some sprinkles of rain in the p.m. 10-VI-82

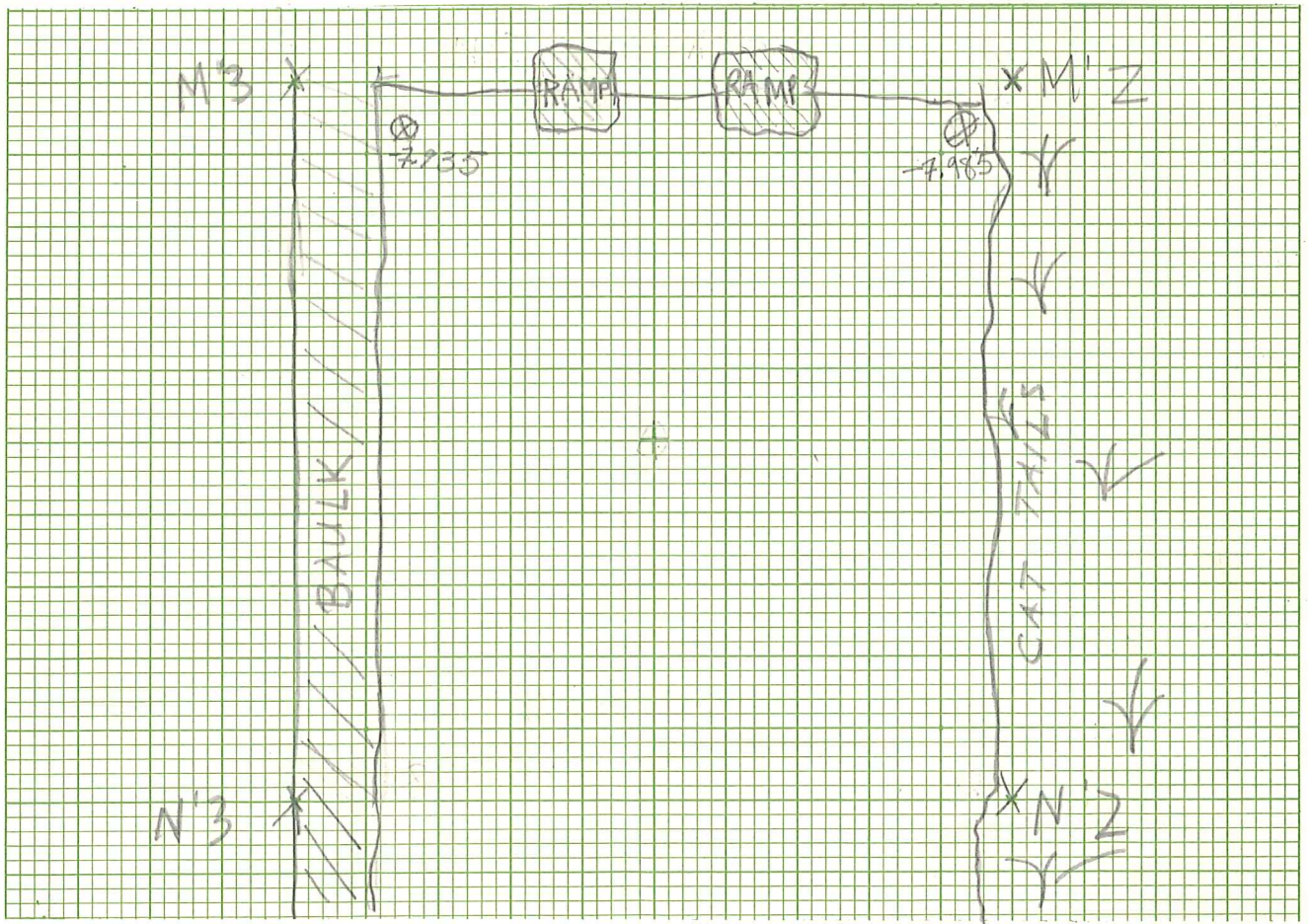

Scale

Title

Worked by, using

Disposal of specimens M'2 Bat. 1, Level A - few finds - 2 bone frags + coarse ware.

Reference

Photos

Recorded by

J.B.

Date

11-VI-82



13

Area Canal Excavation Level Batt. 2 LEVEL A

1. Subject

2. Horizontal location M'Z

3. Vertical location, strat. position

4. Dimensions

5. Matrix 10 YR 4/2 Dark Grayish Brown. Larger, hard sandy clay lumps.

6. Associations Rounded stones (a few), many roof tile frags, some bones, some pottery.

7. Description, discussion, sketch Large limestone block appears in E of trench. It has an indentation on the north side, resembling some sort of quarry mark - 3cm. wide, and 12cm. of the length appears

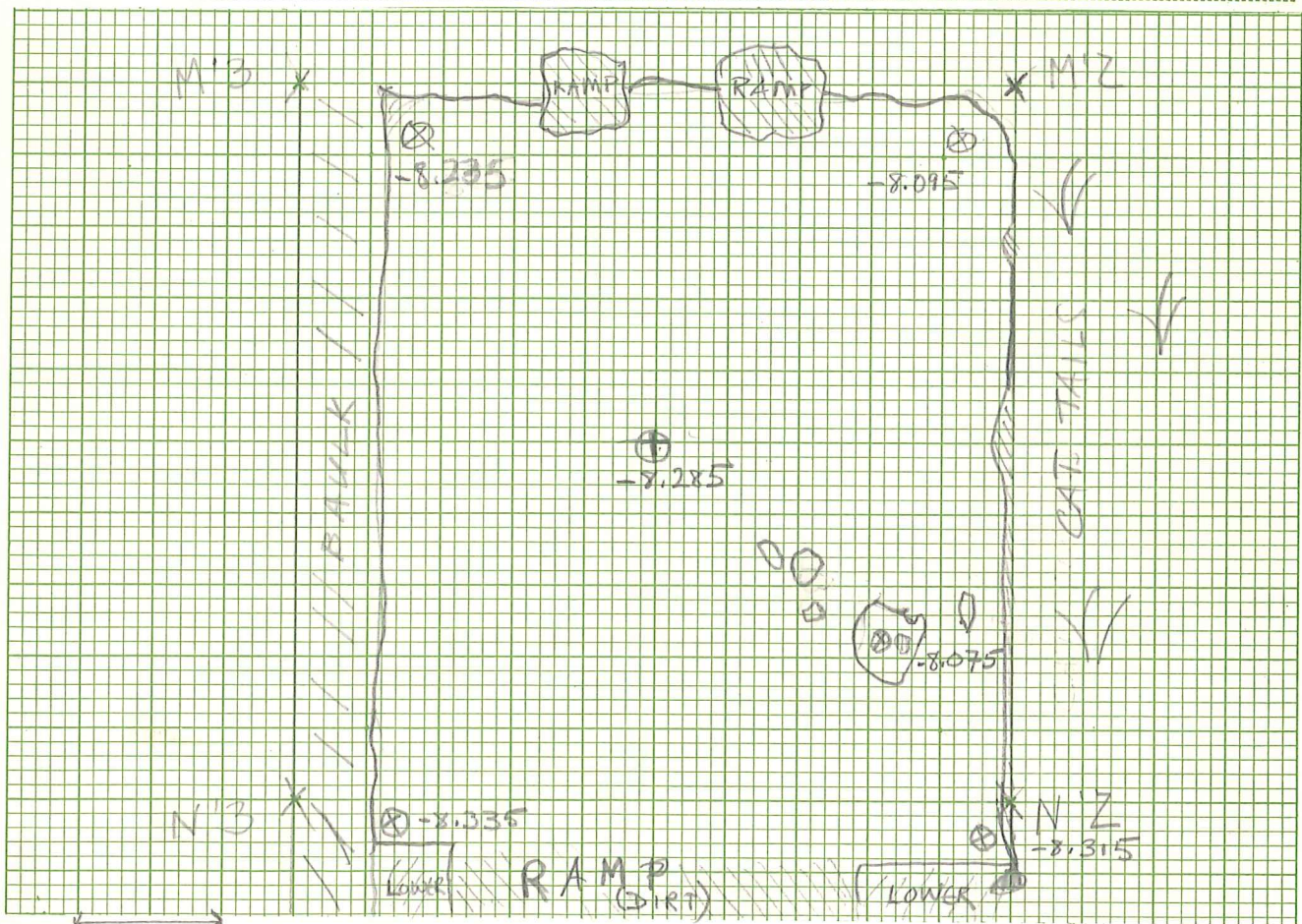

Scale 1 M. Title

Worked by, using 5 workmen, picks, shovels, dumper.

Disposal of specimens Batt. 2, level A - Bones, Pottery (Coarse ware) M'Z

Reference

Photos Recorded by J.B. Date 11-VI-82



Area Canal Excavation

Level Batt. 3 Level A

1. Subject

2. Horizontal location M'Z

3. Vertical location, strat. position End levels are given

4. Dimensions

5. Matrix 10YR 3/1 Very dark gray sandy clay

6. Associations many roof tile frag. Some pebbles some field stones. Coarse ware Round, corn wt., teeth + bones, large pan tile frag.

7. Description, discussion, sketch. In the 1<sup>st</sup> meter N of South towards the center was a limestone chunk - it rolled out of the dirt. Some large bones in the 1<sup>st</sup> m. N. of S. and ctr.

O = limestone ● = fieldstone ⊕ = tile

Quite a few large, rounded chunks of limestone are coming up with the clay chunks, in the ctr. of square Ramp was left in place.

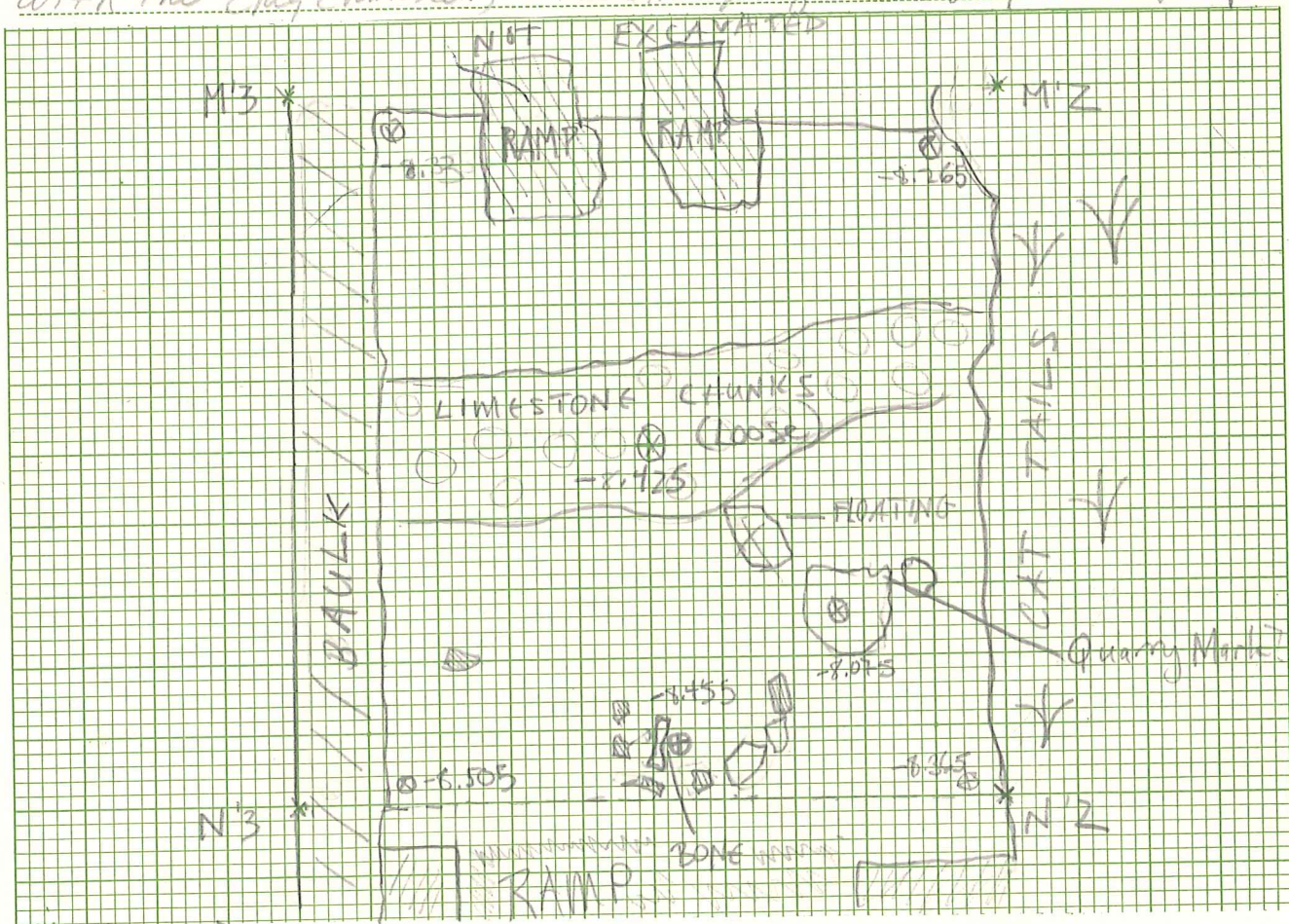

Scale 1M.

Title

Worked by, using

Disposal of specimens M'Z Batt 3 Level A

Reference

Photos

Recorded by J.B.

Date 11-VI-82

1 Bag for Bones  
1 Bag for tile  
1 Bag pottery



15

Area Canal Excavation

Level Batt 4 level A

1. Subject

2. Horizontal location M'Z

3. Vertical location, strat. position (End levels were taken)

4. Dimensions

5. Matrix 10YR4/1 dark gray sandy clay

6. Associations Few smooth pebbles or no field stones at immed. South. large coarse ware sherds - very few

7. Description, discussion, sketch This is a thin battuta (10cm.) of many roof tiles (fragments) and chunks of limestone. The bottom of the batt. at the S, has sunken chunks of limestone, fieldstones and roof tile frags. The large limestone rock in the S-E is a large piece of column drum, unplotted. The Ramp was left in place.



**KEY**

- = fieldstone
- = limestone
- = tile frag.
- = level reading
- = rock or feature remnant
- = border of heaviest concentration of the scatter.

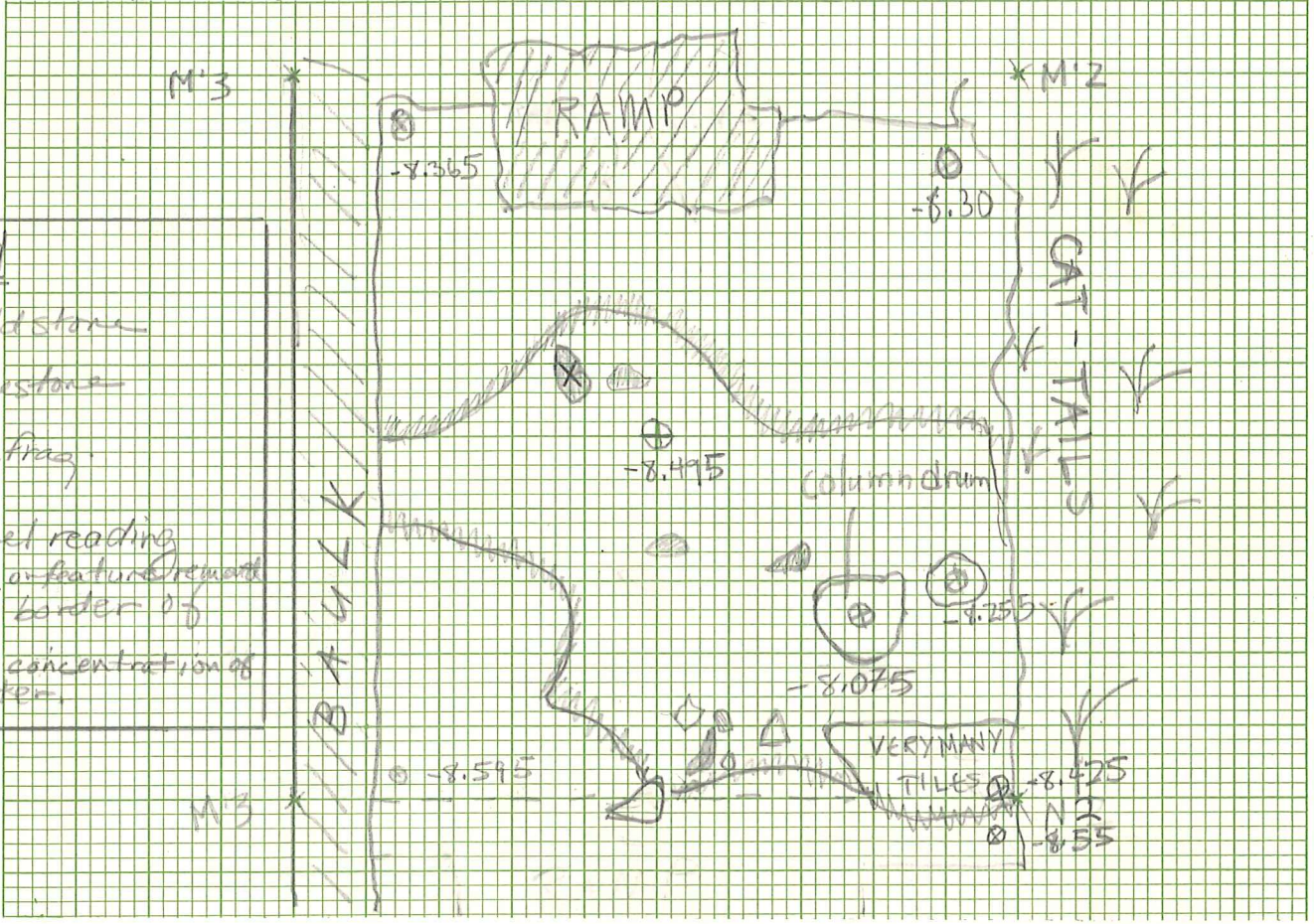

Scale \_\_\_\_\_ Title \_\_\_\_\_

Worked by, using \_\_\_\_\_

Disposal of specimens M'Z Batt 4 level A 1 Bag Boxes

Reference \_\_\_\_\_ 1 Bag Pottery

Photos \_\_\_\_\_ Recorded by J.B. Date 11-VI-82



16

Area Canal Excavation Level Batt. 4

1. Subject

2. Horizontal location square O'2

3. Vertical location, strat. position

4. Dimensions

5. Matrix 10YR 3/1 very dark gray clay. Roof tile frags.

6. Associations Bit of black gong, coarseware, smooth pebbles (few) moist clay in chunks. At N side, clay varying between 10YR 3/1 and 10YR 4/1 (Dark gray) In N.W.

7. Description, discussion, sketch. In N.W. sandy clay of 10YR: 4/2, 4/6 and 5/8. In this area the sandy yellowish clay comes off onto the grey smooth clay. There is a cut line stone block in the 2nd N.W. of E and N-most M. of the square. E. of the sandy clay the soil is more clay like and 10YR 4/2 all over.

N ↑

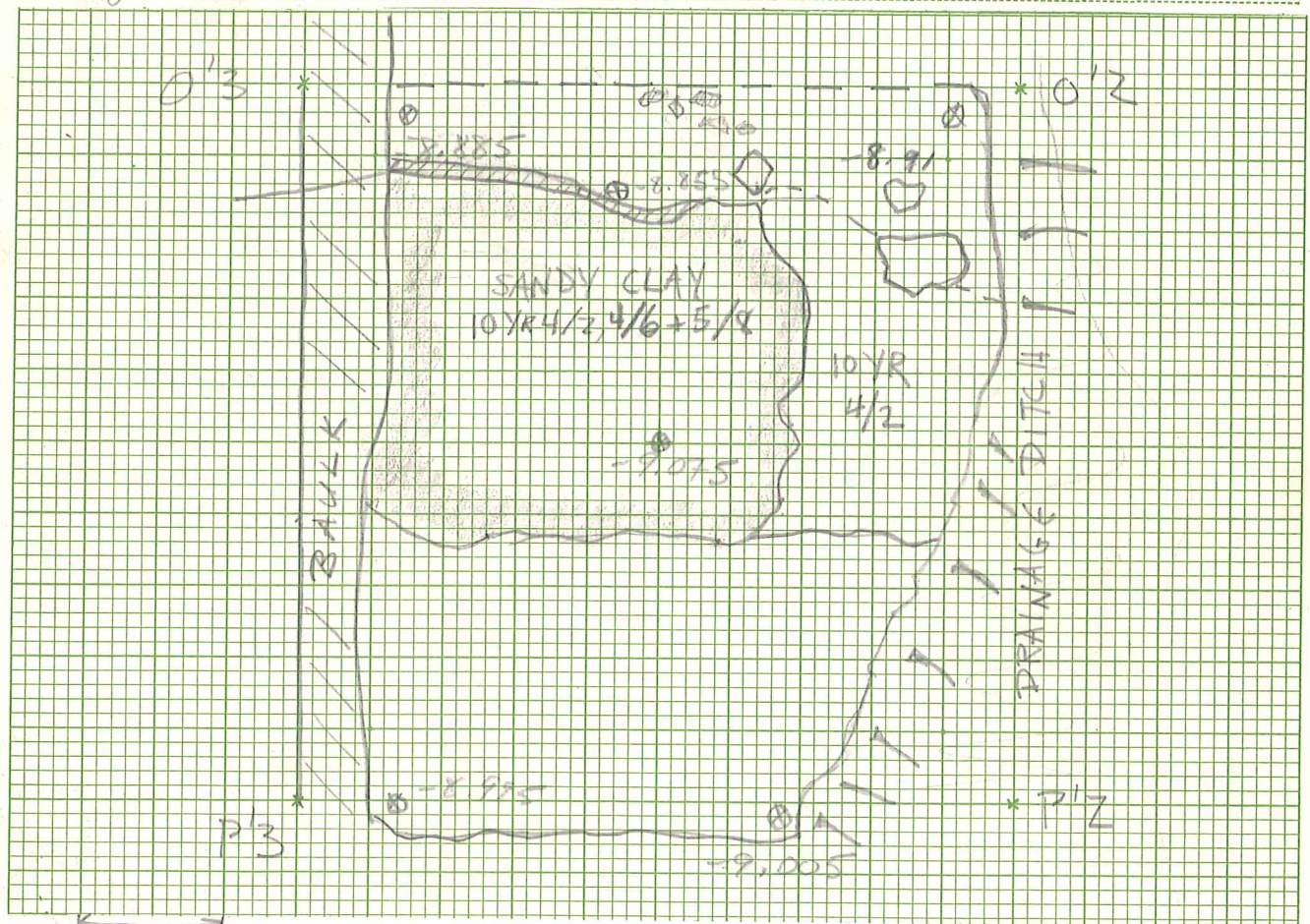

Scale 1 M Title

Worked by, using

Disposal of specimens O'2, N'2, Batt. 4. 2 bags pottery / bag bones

Reference

Photos Recorded by J.B. Date 14-VI-82



17

U. T. Austin—GENERAL RECORD FORM

Site P2

Area Canal Excavation Level Batt. 4 LEVEL B

1. Subject ?? 1978 trench has pebble layer as well. Also in N-S trench of 1981. This may be a continuation of this layer into this trench.

2. Horizontal location N'2

3. Vertical location, strat. position

4. Dimensions

5. Matrix 10YR 3/1 very dark grey, gravelly clay

6. Associations Roof tiles, pebbles, some field stones

7. Description, discussion, sketch column drum is now revealed - 44cm high, and c. 56cm diameter. Pops of Toronto trowels around and finds more tiles under the clay in S.E. corner. The PEBBLE CONCENTRATION AND TILES ARE PACKED IN, WITH THE COLUMN DRUM AND SOME LIMESTONE CHUNKS PACKED IN. THE ROUND LIMESTONE just N. of O'2 is likely to be a catapult ball - like those in the city.

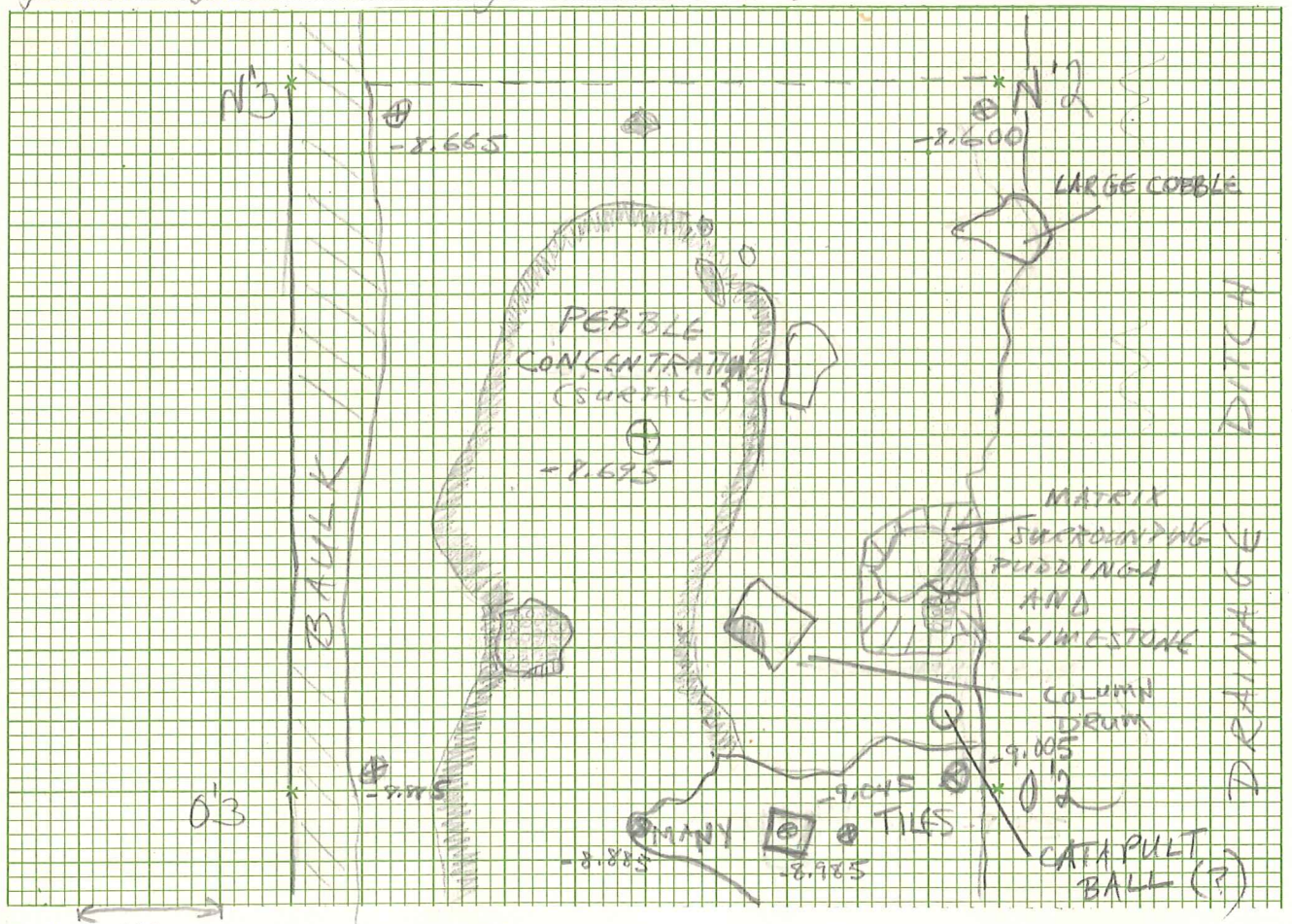

Scale 1M Title  
Worked by, using  
Disposal of specimens O'2-N'2 Batt. 4 2 blue pottery, 1 bag bones  
Reference  
Photos Recorded by JB Date 14-VI-82



Area Canal Excavation Bath 5

1. Subject

2. Horizontal location M12

3. Vertical location, strat. position

4. Dimensions

5. Matrix 10YR 4/2 Dark grayish brown

6. Associations Some gravel chunks of greenish gray (?) with charcoal inclusions - 45% (?) - stuff from a kiln? roof tiles.

7. Description, discussion, sketch The remold limestone is a catapult ball like those in the city near the Hunter. The column drum is near floating. There is another catapult base at the foot of the ramp (smaller).

One corner was and the frag - no level log. Rand left in place.

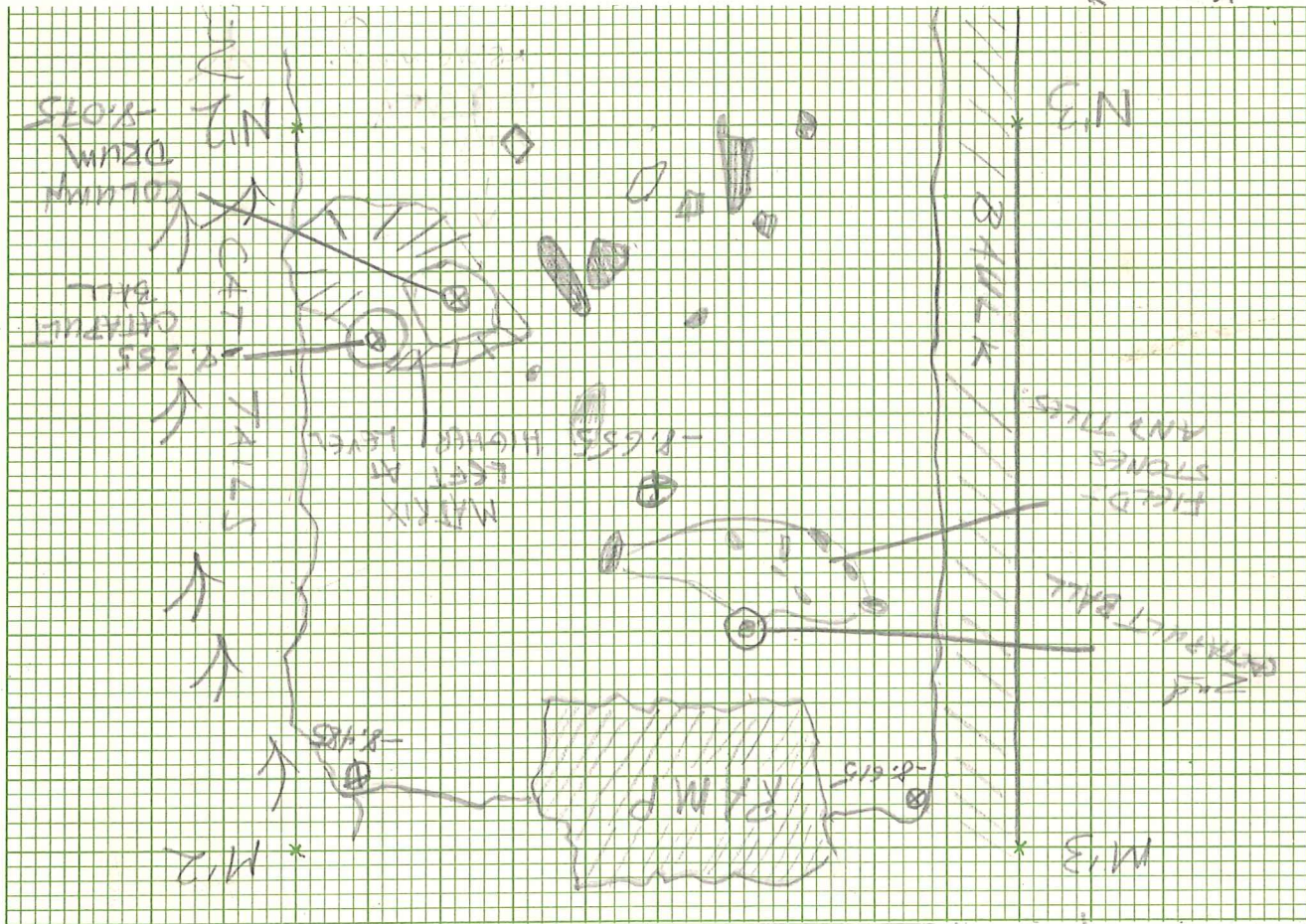

Scale

Title

Worked by, using

Disposal of specimens

Reference

Photos

Recorded by

JB

Date

14-VI-82

1 Bag Pottery  
1 Bag Bones

M12 Bath 5



Section of Bank N-7 etc.

Nahr  
Bank

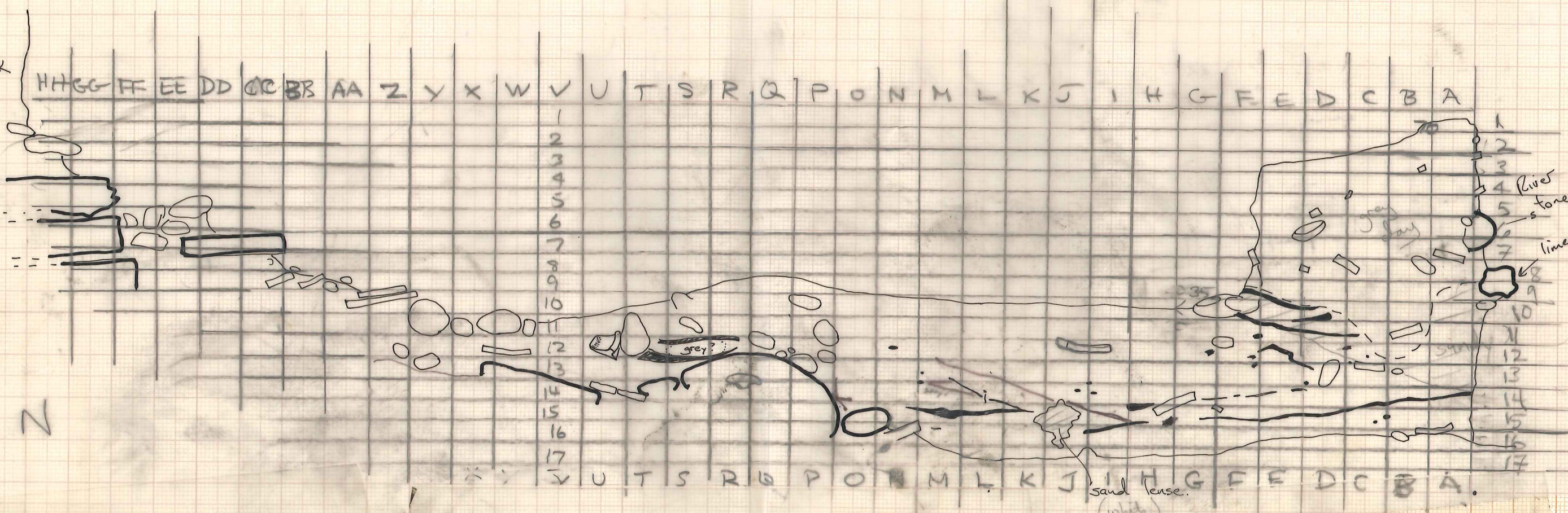

S



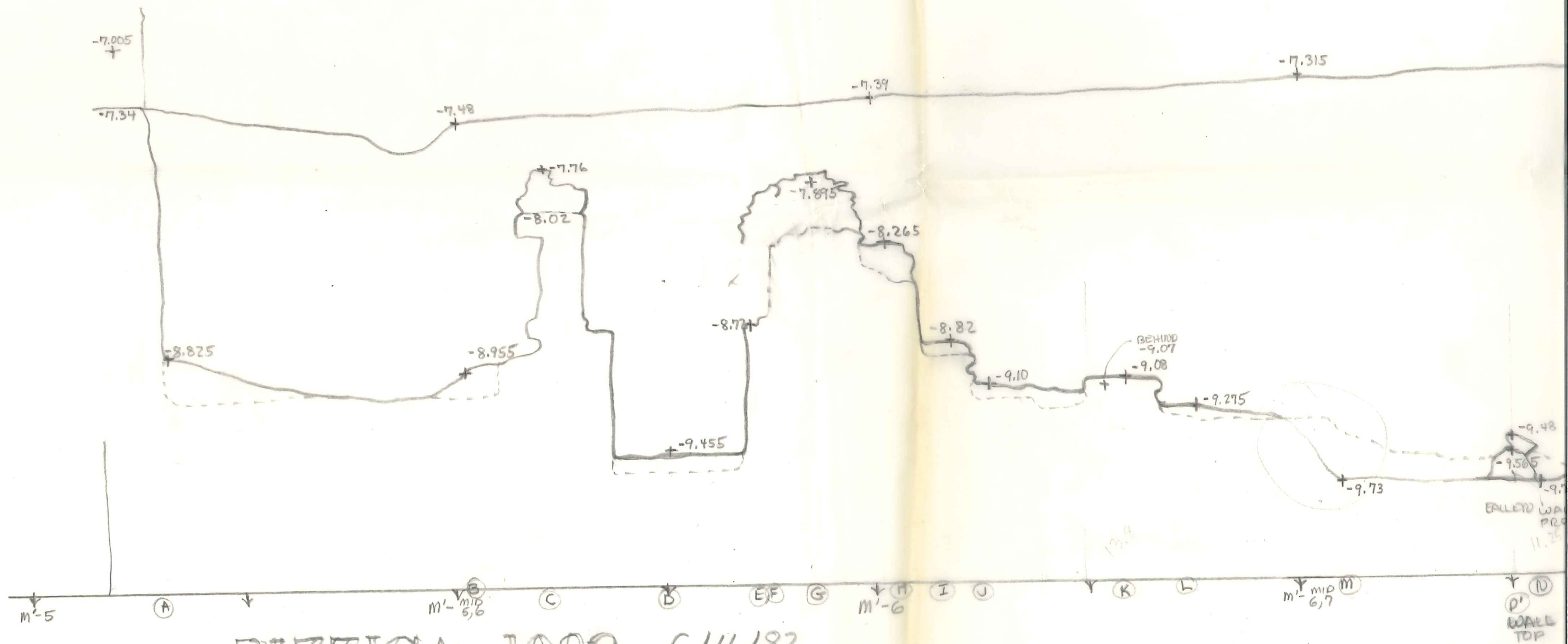

PIZZICA 1982 6/11/82  
 WELL TRENCH M'-5 M'-9

AT BATUTA #2  
 B.M. BED NO. L-3 @ -6.75



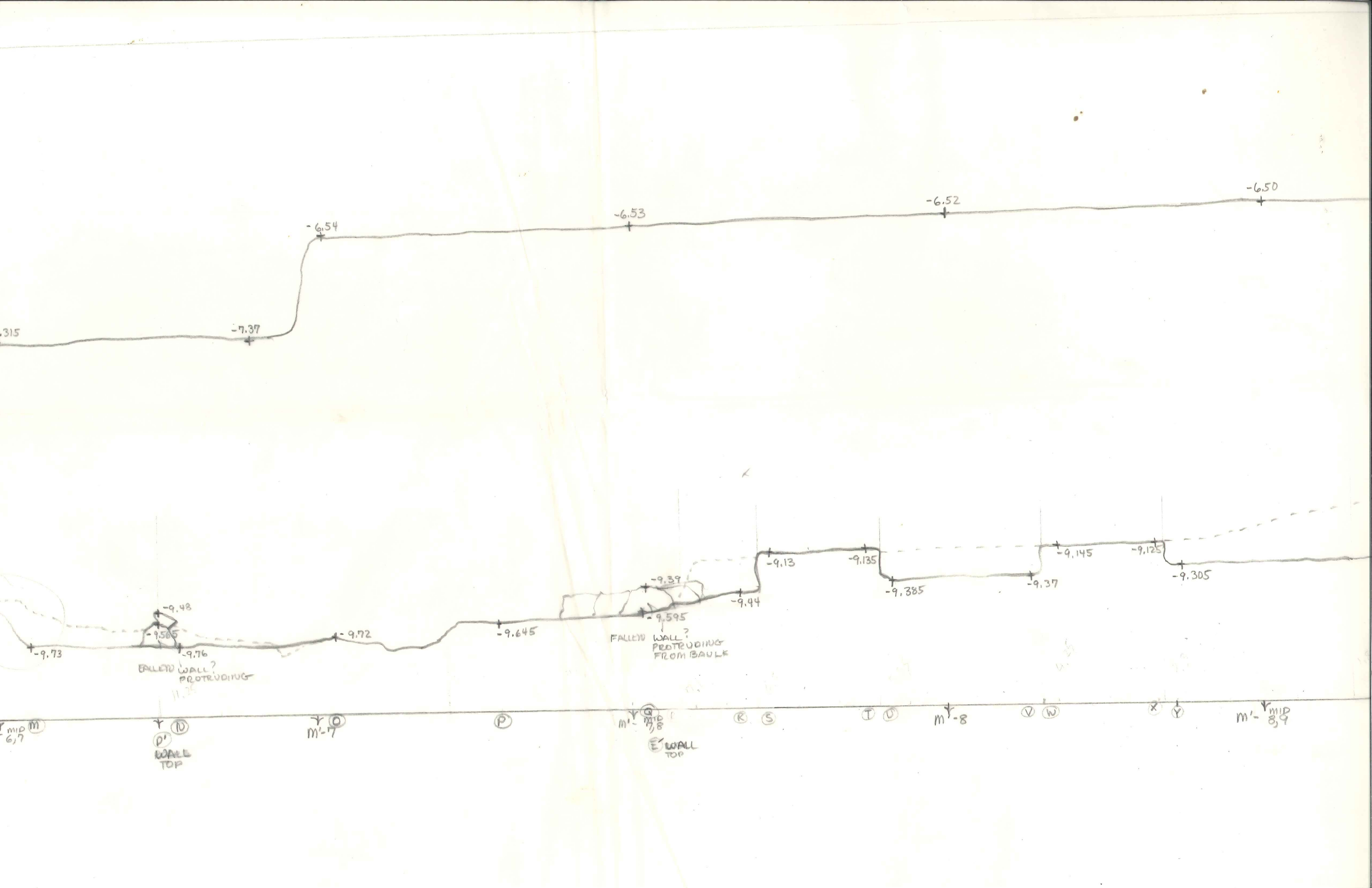

315

-7.37

-6.54

-6.53

-6.52

-6.50

-9.73

-9.48

-9.505

-9.76

-9.72

-9.645

-9.39

-9.595

-9.44

-9.13

-9.135

-9.385

-9.37

-9.145

-9.125

-9.305

M  
mid  
6,7

WALL  
TOP

M'-7

P

M'-8

WALL  
TOP

R S

M'-8

V W

X Y

M'-9  
mid  
8,9

FALLEN WALL?  
PROTRUDING  
FROM BAULK

FALLEN WALL?  
PROTRUDING



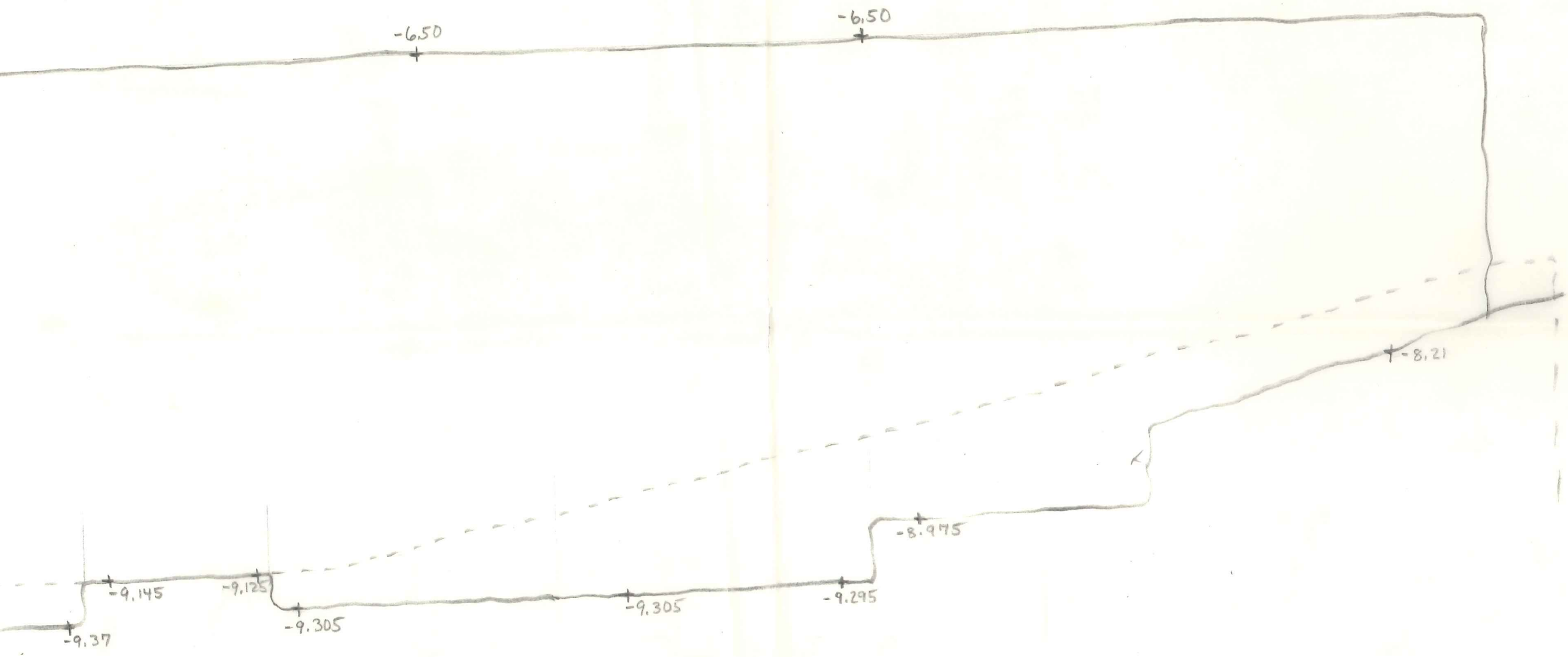

--- LINE 15 1981 LEVEL

Ⓧ Ⓦ M'-Y MID 8,9 Ⓩ A B M'-9 M'-9,10



L-5  
(5.745) + (-7.215)

+ (-6.945)  
M-5  
(-7.005)

M-5,6  
(-7.48)

M-6  
(-7.39)

(-7.315)

M-7  
(-6.54)

+ (-6.53)

M-8  
(-6.52)

+ (-6.50)

M-9  
(-6.50)

+ (-7.34) A

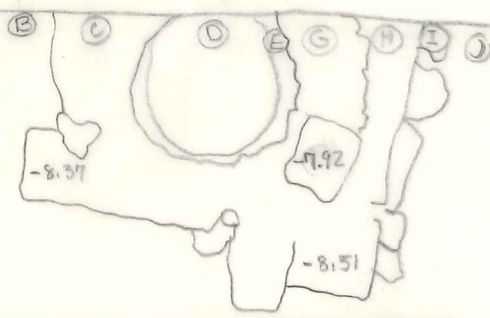

B  
-9.08

+9.11

N-5  
(-7.62)

+ (-9.45)

N-6  
(-9.31)

+ (-9.795)

N-7  
(-9.72)

+ (-8.525)

+ (-9.635)

N-8  
(-9.33)

+ (-9.16)

N-9  
(-8.76)

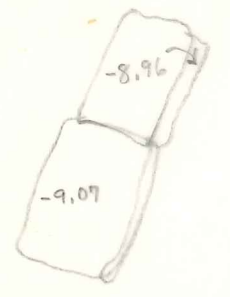

+ (-8.9)

(-9.01)  
+ (-8.99)



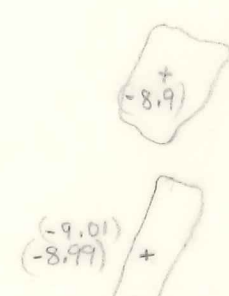
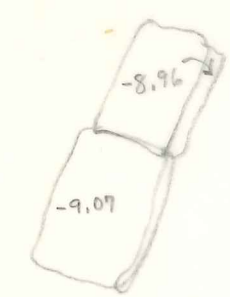
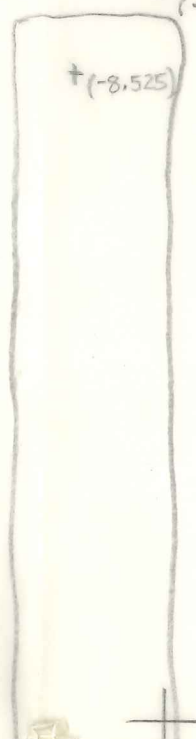
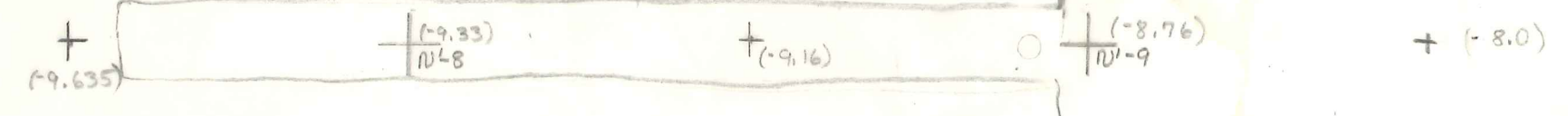
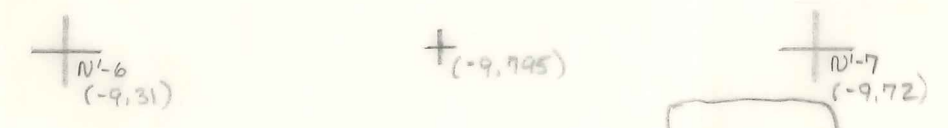
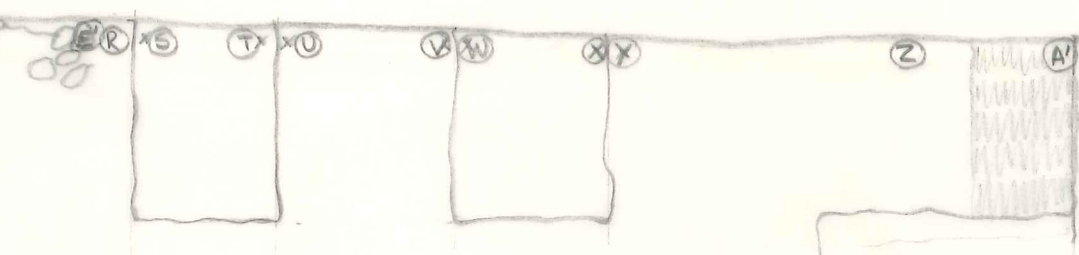
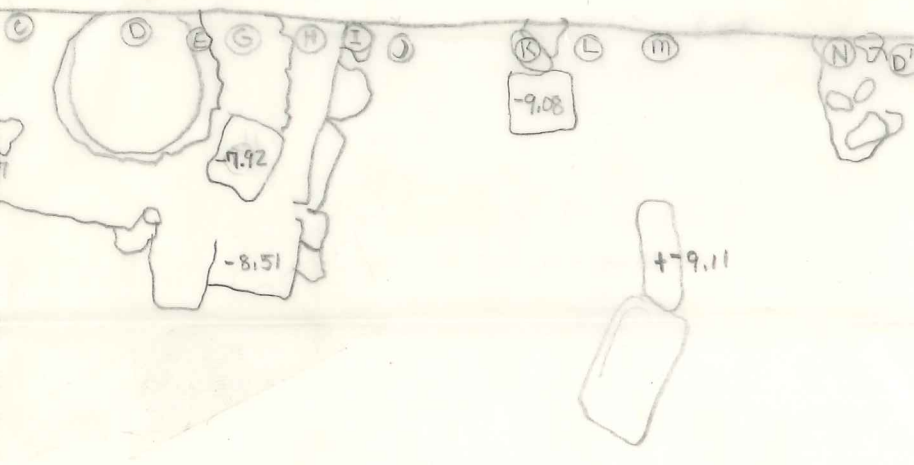
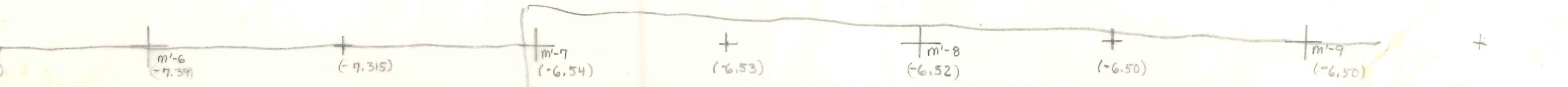



SCALE 1:50 B.M. ROCK N.W. L-3 @ -6.75

Well TRENCH @ BARUA #2 6/11/82

A	-8.825
B	-8.955
C	-7.76
D	-9.455
E	-8.72
F	-7.92
G	-7.895
H	-8.265
I	-8.82
J	-9.16
K	-9.07
L	-9.275
M	-9.73
N	-9.76
O	-9.72
P	-9.645
Q	-9.595
R	-9.44
S	-9.13
T	-4.135
U	-9.385
V	-9.37
W	-9.145
X	-9.125
Y	-9.305
Z	-9.305
A'	-9.295
B'	-8.975
C'	-8.21
D'	-9.48 @ Bed Rock
E'	-9.565 RUBBLE
F'	-9.39 FAULTED WALL

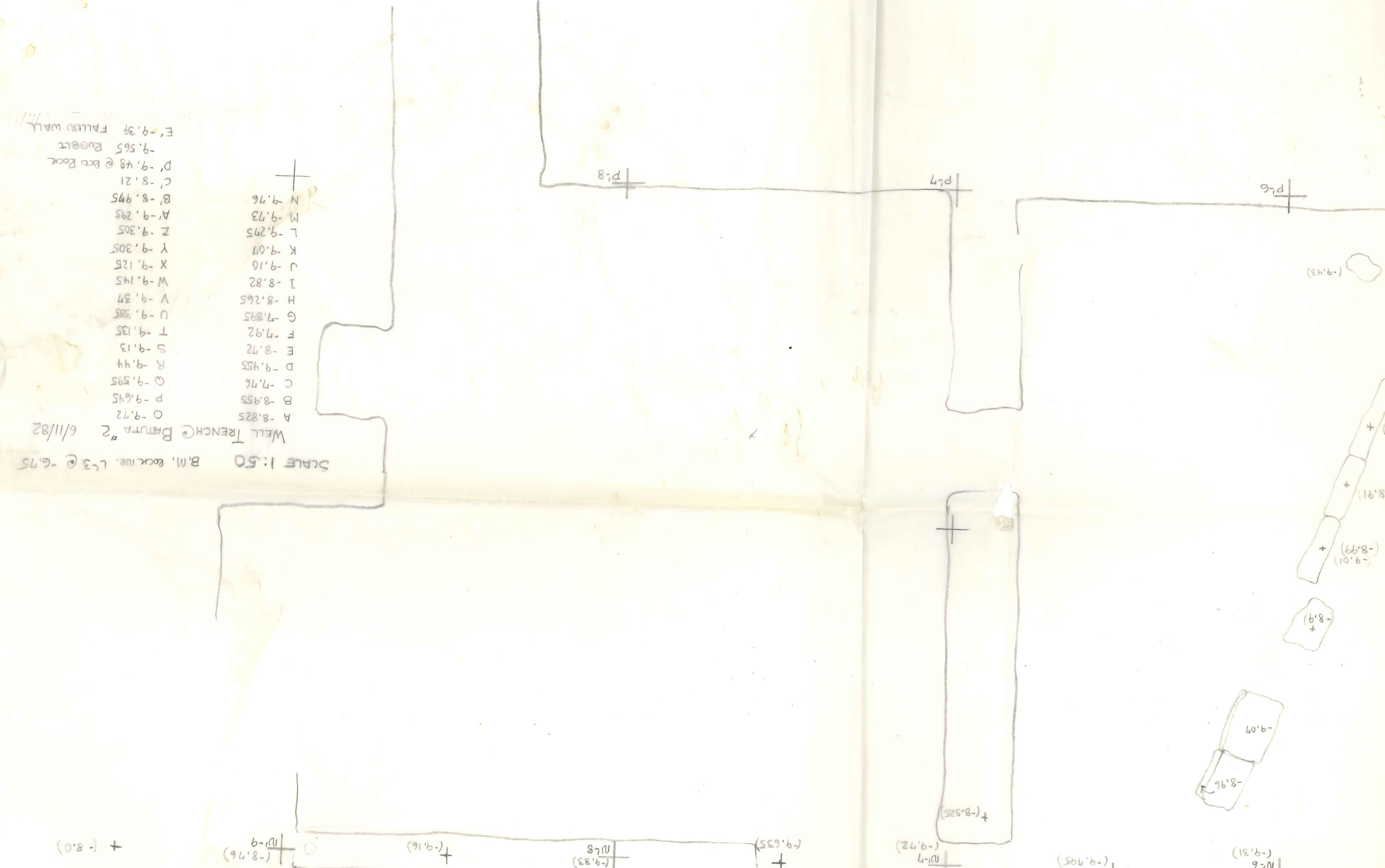



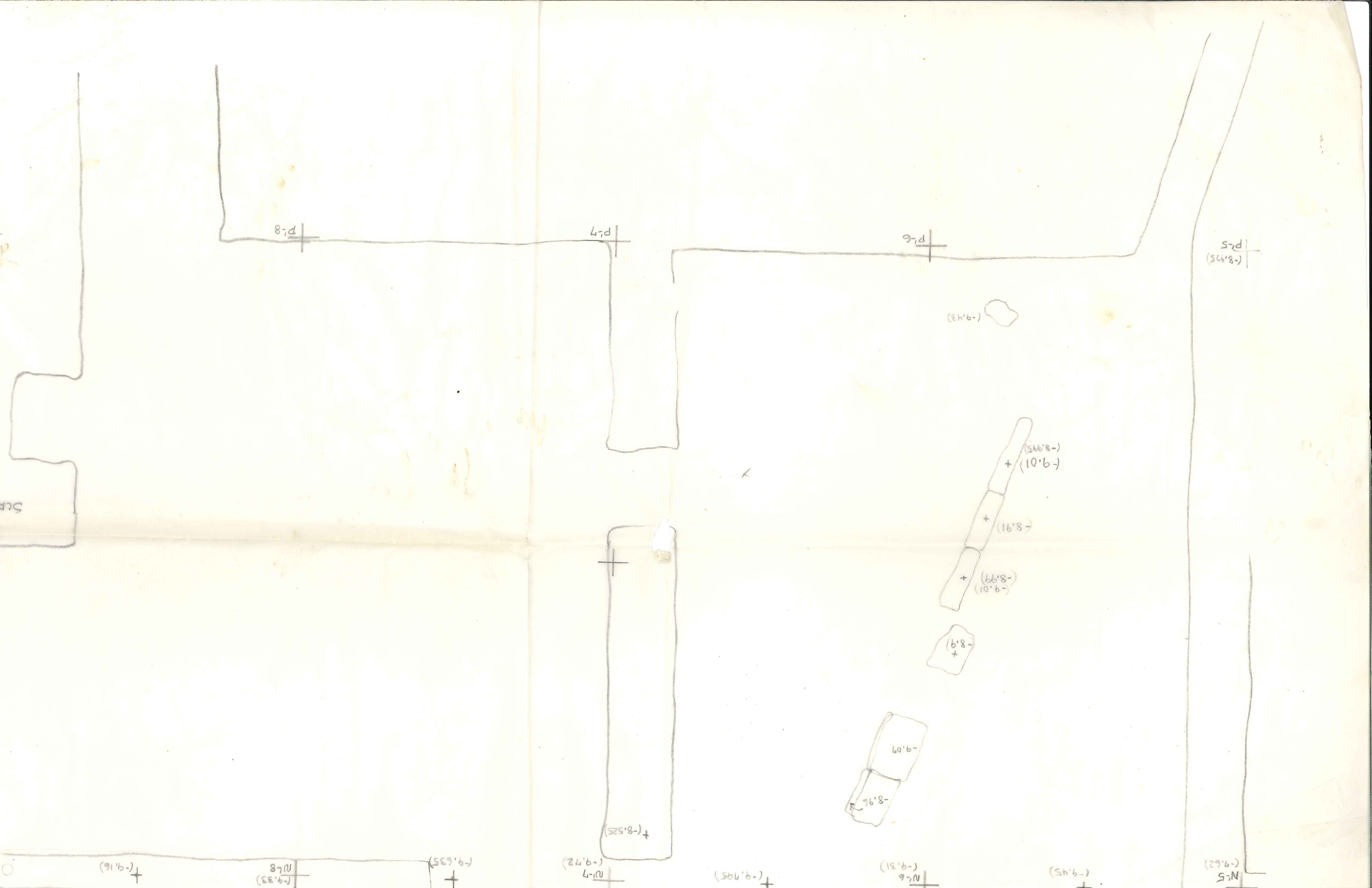



TEXAS

Date: 27 JUL 78 JB No. 7278-71255

Object: Soil Material: SS

Square: L-3 L-3

Photograph:

Level: B-3 SOUND VI

Drawing:

Dimensions: L., H., W., Th.,

Technique:

Condition:

Description: FLOTATION SAMPLE



TEXAS

Date: 27 011 78 JE No. PZ 78-714B

Object: Bone Material:

Square: N1-7-8 Photograph:

Level: Cleaning of Drawing:

Dimensions: L., Pavement H., W., Th., Surface

Technique:

Condition:

Description: 1/2 Bone frag. from cleaning of pavement surface - (from PZ-78-713PL)



TEXAS

Date: 27. VII. 78

No. PZ 78-715 T

Object: TILE SAMPLE

Material: Terracotta

Square: N-7-8

Photograph:

Cleaning of Pavement Surface

Level: 6, Batt. 1

Drawing:

Dimensions: L.,

H.,

W.,

Th.,

Technique:

Condition: Fragmented

Description:

7 flat pan tiles, 2 slightly curved  
pan tiles, 1 waterspout tile (A),  
various colors.  
(from PZ-78-713 PL)



TEXAS

Date: 27.VII.78

No. PZ 78 716T

Object: ARCHIT. ANTEFIX-GUTTER? Material: Terracotta

Square: N-7-8 Photograph: 79-28/31,32

Cleaning of Pavement Surface

Level: 6, Batt. 1 Drawing: 79 p4 #86

Dimensions: L., 14.5 cm. H., W., 14.5 cm. Th., 1.8 cm.

Technique:

Condition: Broken on all edges

Description:

Curved w/corner on one side  
104R 8/3 very pale brown  
from PZ 78-713 PL

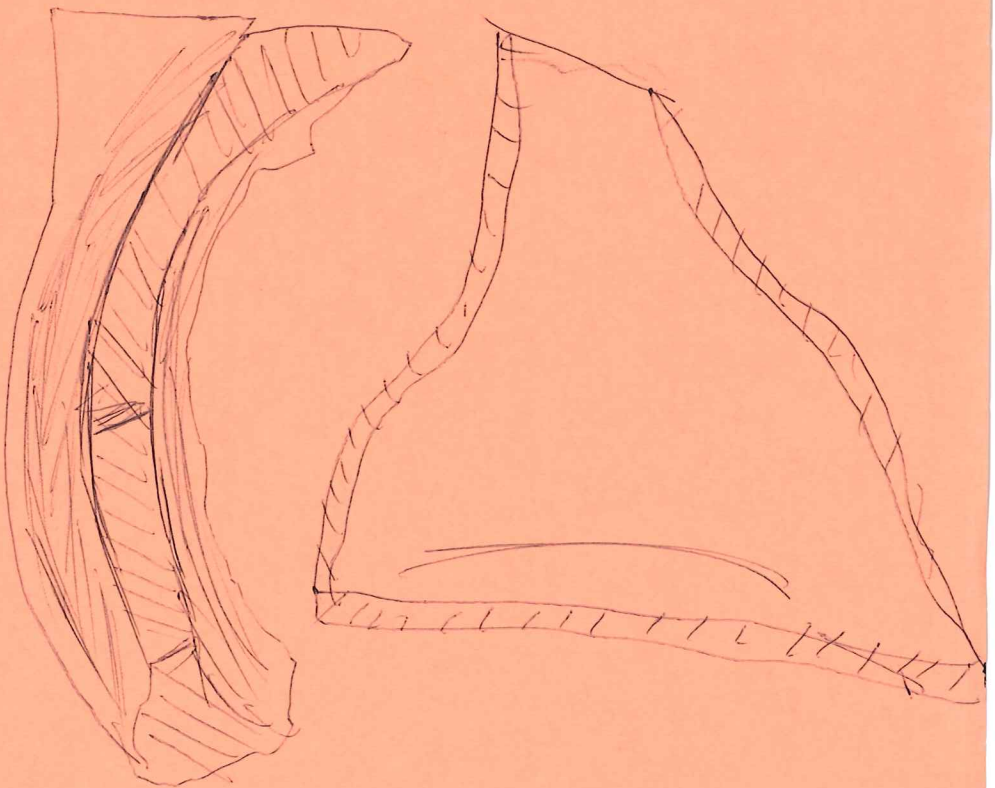



TEXAS

Date: 27. 78. VII (July) No. 72 ~~710~~ 717 P

Object: GRITTY SMELTING SPOUT Material: Ceramic

Square: N17-8 Photograph: 79-28/20

Cleaning of Pavement Surface

Level: 6, Batt. 1 Drawing: 79 p1 #71

Dimensions: L., 2.14 cm, H., W., 3.8-6.5 cm, Th., 0.9 cm.

Technique:

Condition:

Description:

54R 6/6 reddish yellow  
broken at end and at body attachment  
Small projectile on ~~one~~ one side, deep  
groove on other.  
(from PZ. 78. 713R)





① Pre-excavation

E

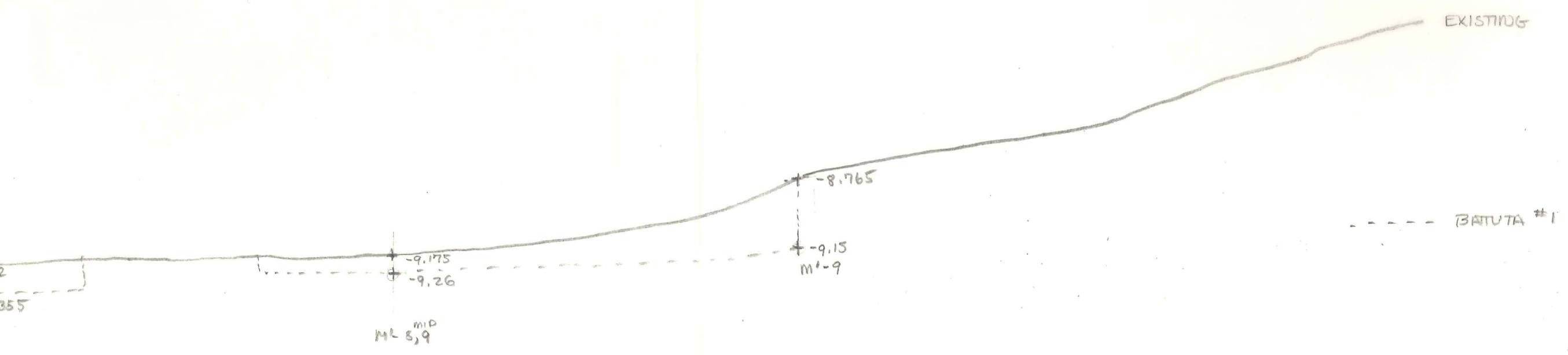



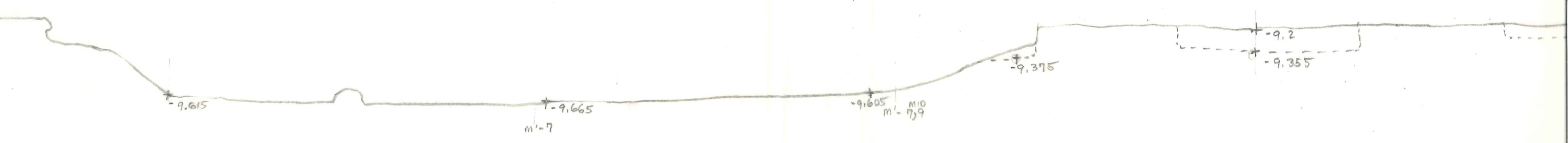



W

+

9.145

Pizzica 1982 6/7/82  
Well Trench M-5 M-9



this numbering trust  
corresponds to roadwork  
designation of  
material

fire gravel

77-5.685

B-190  
G-

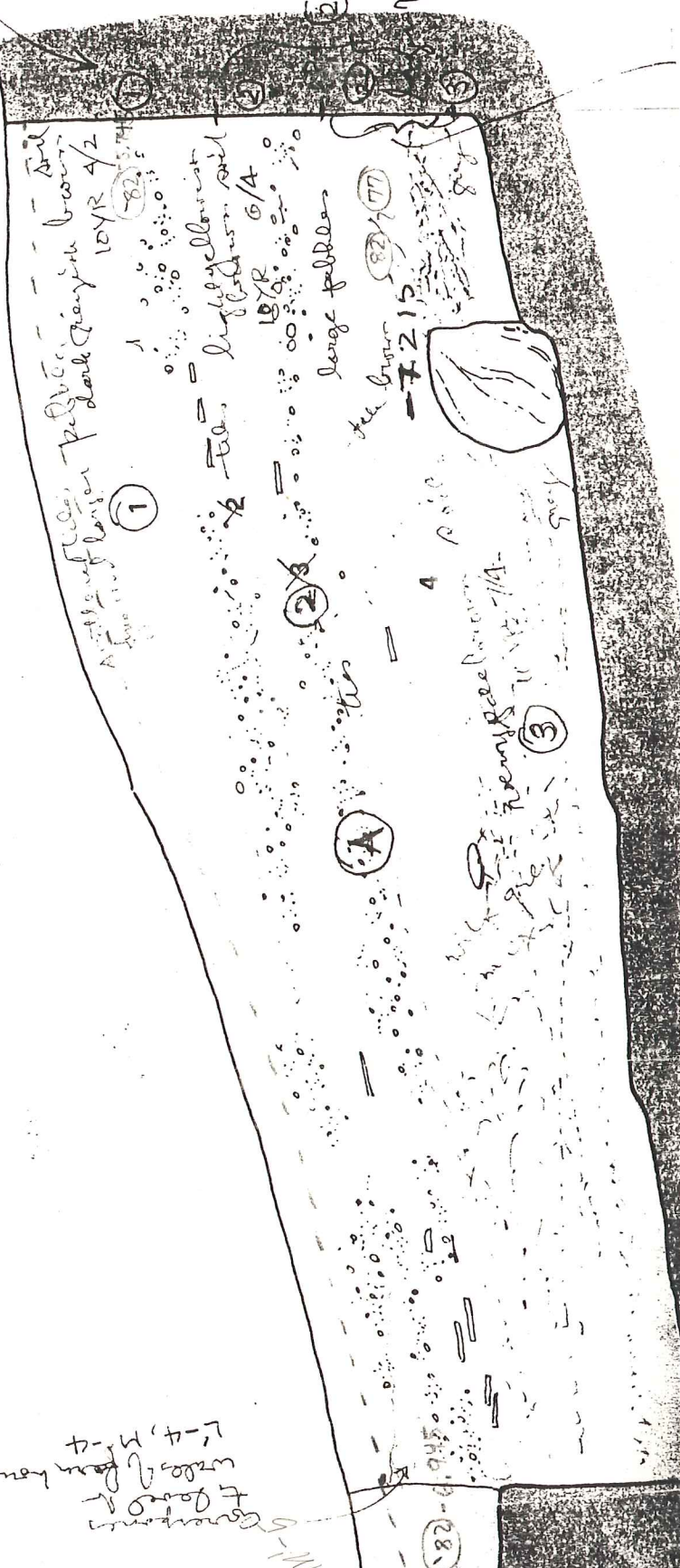

Layer of relatively clean pale  
brown earth sandwiched between  
two lenses of gravel in which the  
complete reverts came out in  
July 10-11, 1978  
This provides a terminus  
two layers in upper  
to layer gravel  
section

SECTION S-N  
P-5, L-5

PIZZICA 1977

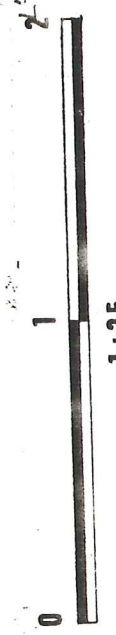

Albin

Sections of 77 LEVELS  
& New 82 LEVELS

Continuation  
of road  
L-4, M-4  
with  
from house - the road

M-5



Government  
F. O. O. O.  
with a Pan house - the 1000 area

Corresponds to upper level  
of pebbles in EW section in N-5

N-5

(177) - 7.565

(177) - 6.825

greyish brown soil  
10YR 5/2

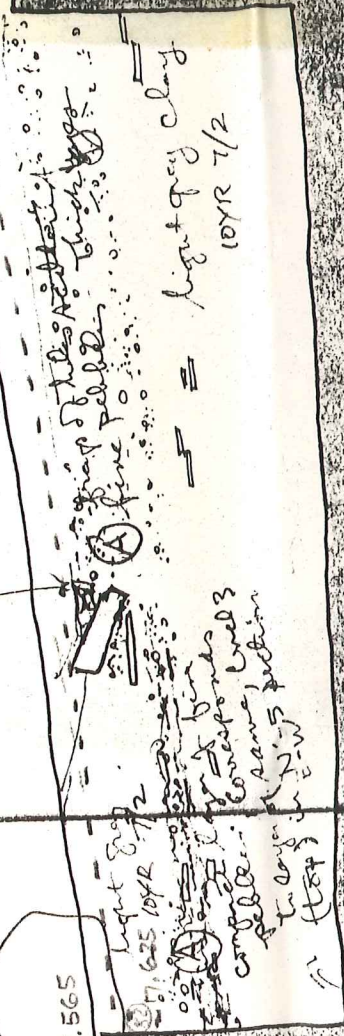

CONSIDERED HORIZ  
C - 9.38

N-5

(177) - 9.515

(177) - 9.655

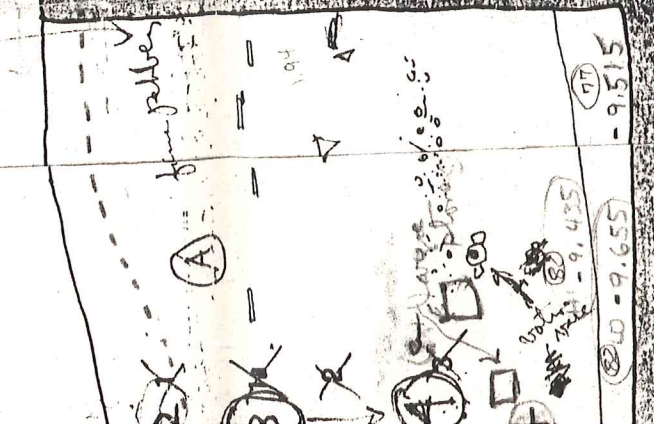

Light brown clay  
grey 10YR 5/2  
fine pebbles  
conglomerate  
pebbles  
in N-5 section  
L. clay in N-5 section



(cut & pass  
of Lip Road  
Hansen)

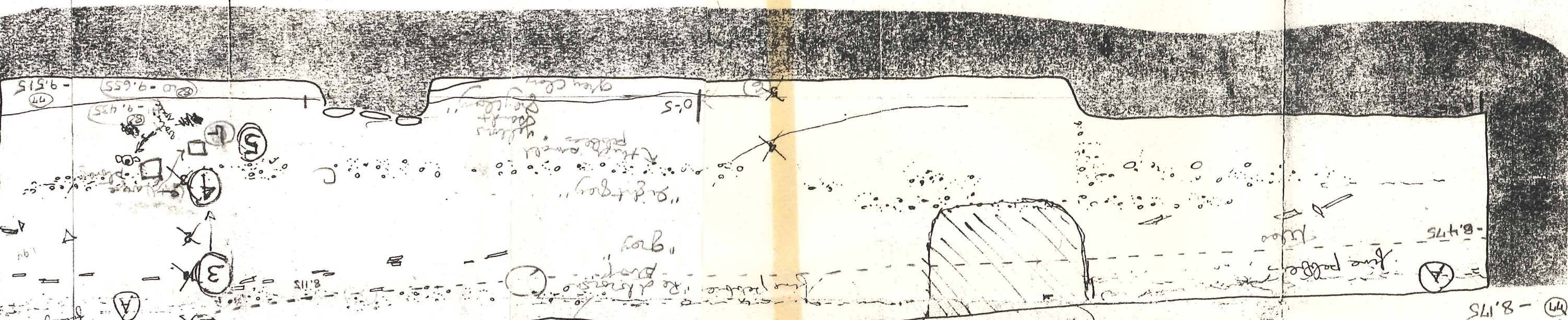

Construction of  
road in the R cut  
on north end  
east side of  
road

Cut for  
Water Lake

Green  
at pass

- 9.38

- 8.175

17 - 8.175







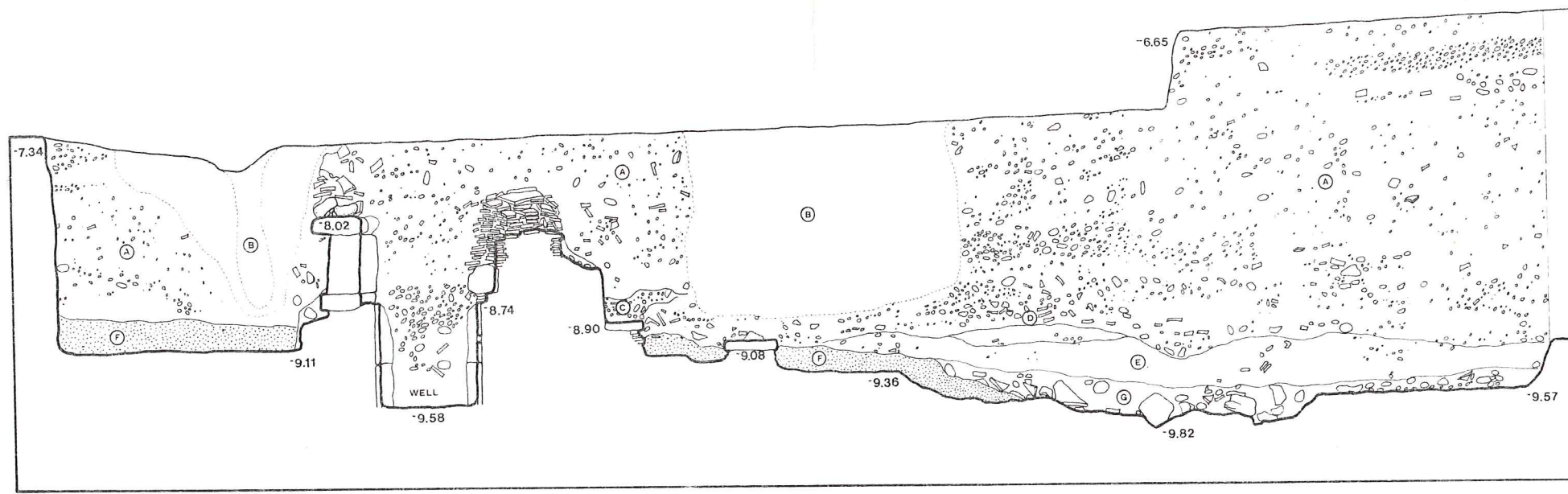

PIZZICA 1981  
 WELL TRENCH M'-5 M'-9  
 NORTH BAULK

SCALE: 1:25 0 0.5 10 m 20



PIZZICA 1981

SITE PLAN

SCALE = 1:50 0 1 2 3M

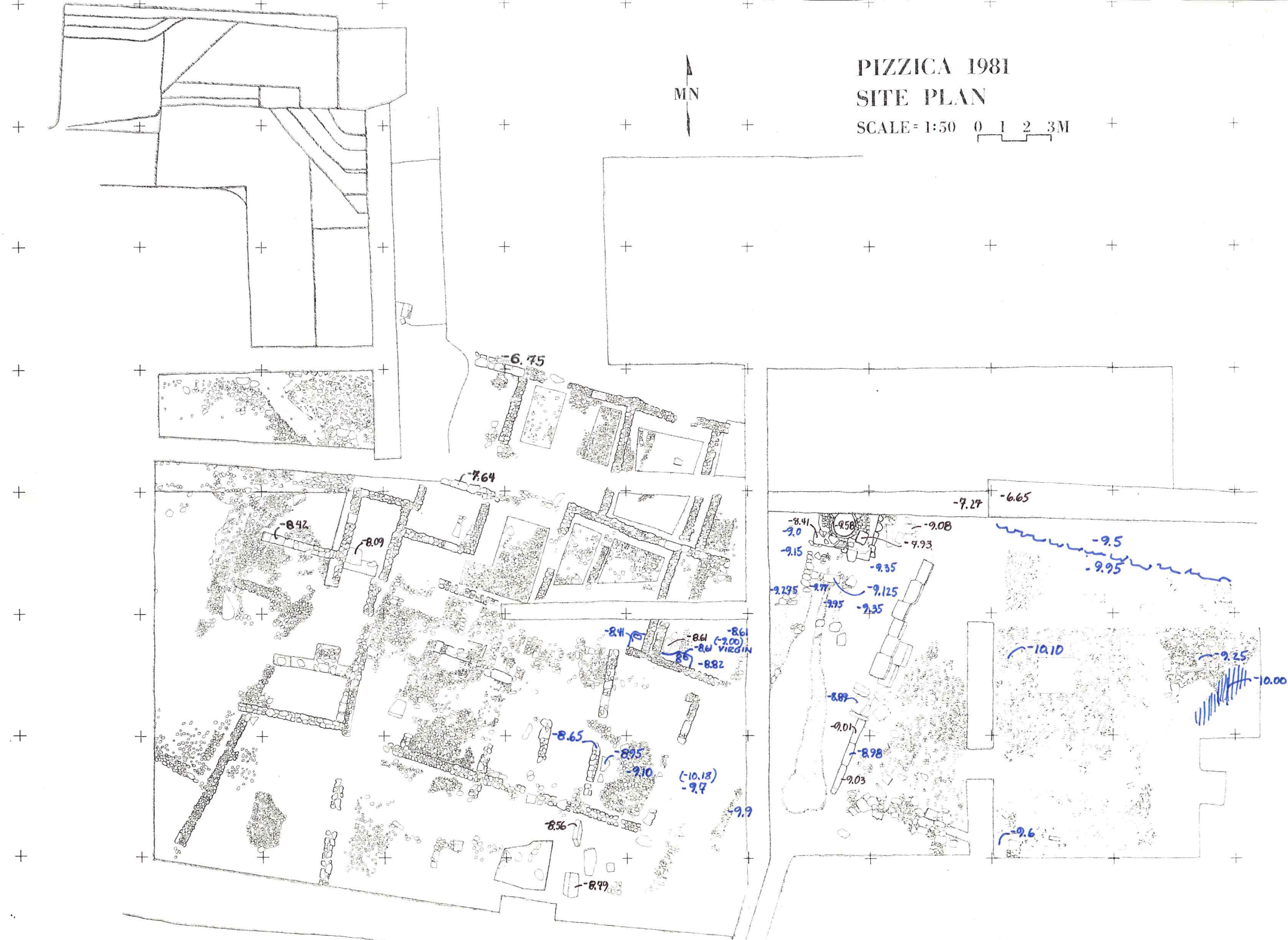

From B2 Sections









