

Pizzetti 1982

7

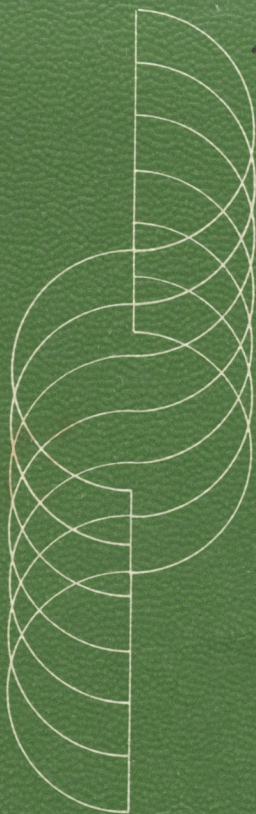

pignastyl

05

SANCTUARY N/S BANK at N'-5 BATTUTA 3

7-5

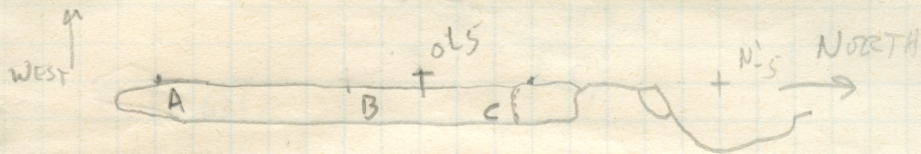

BM -07 Hi [6.68]

STATION	FS	ELEV
A \nearrow P-5	2.4	-9.08
B NEAR O'-5	2.38	-9.06
C \nearrow NEAR MID N'-O'-5	2.25	-8.93

COMPARISONS

	Hi [6.68]	FS	ELEV
A. MID N'-20'-2 WEST TRENCH		2.07	-8.75
B			
C			
D			
E			
F			

SANCTUARY wall N/S N-6.0'-5" COMPARISONS 7-6

BM +.13



→

+ N'-6



Hi. [6.62]

STATION	FS	ELEV
A WALL	2.28	-8.90
B MID ROCK WELL	2.16	-8.78
C TOP WELL BEHIND PUDDING ↳ SOFT C. DRUM	2.11	-8.73
D TOP STONE WELL FRONT MID ↳ CARPARD	1.37	-7.99
E BOTTOM BASIN WELL FRONT	3.02	-9.64
F ROCK IN BASIN WELL FRONT LARGE CARPARD ROCK IN FRONT OF WELL	2.53	-9.15

N/S BANK M-5 LAYER 4 Hi [6.62]

A STATUETTE 2.515

-9.135

	FS	ELEV
A	-1.79	-8.41
B	-1.82	-8.44
C	-1.76	-8.38

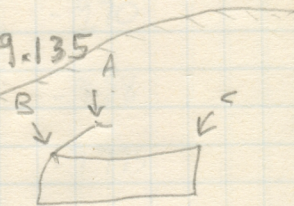

SANCTUARY BAWL E/W END WALL AT N'-6

+ N'-6 7-6

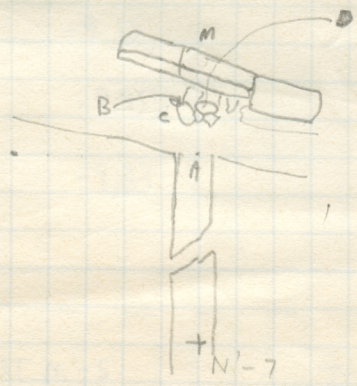
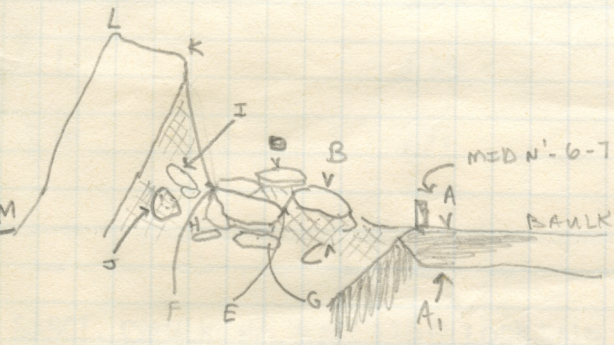

STATION HI [-6.62]

STATION	FS	ELEV.
A MED N'-6-7	3.22	-9.84
A ₁	3.54	-10.16
B	2.97	-9.59
C	3.24	-9.86
D	2.95	-9.57
E	3.08	-9.70
F	2.96	-9.58
G	3.155	-9.775
H	3.17	-9.79
I	2.91	-9.53
J	3.04	-9.66

SANCT. CONT.

BAULK W/E AND WALL AT N'-6

Hi [6.62]

7.6

K	2.53	-9.15
L	2.33	-8.95
m	2.71	-9.33

SANCT. BAULK N/S EAST SIDE LOOKING WEST M'-5

7-6

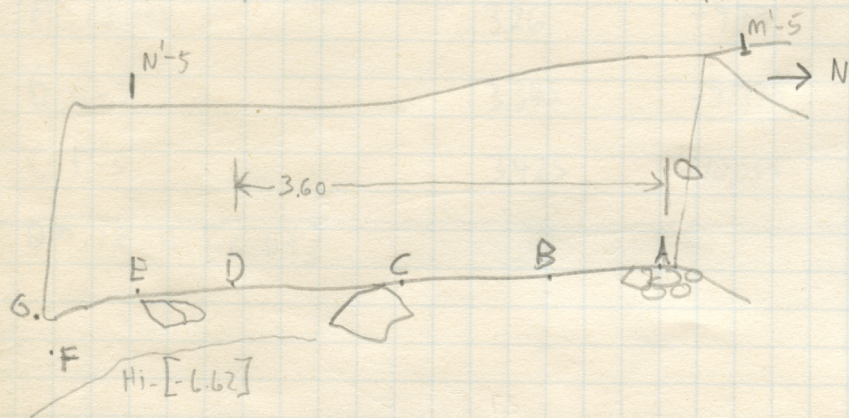

A	2.41	-9.03	G	2.98	-9.60
B	2.51	-9.13	H		
C	2.565	-9.185	I		
D	2.665	-9.285	J		
E	2.71	-9.33			
F	3.17	-9.79			

SANCTUARY LAYER 8 N'-5-0'-5

7.9.82

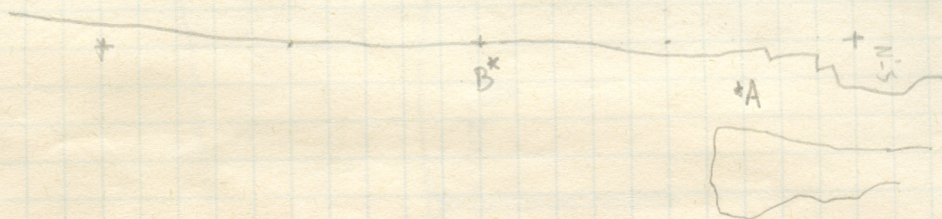

	B.M. 12	H _i [-6.63]	F.S.	ELEV.
A	CANAL		3.26	-9.89
B	0'-5		3.345	-9.975
C	1'-5		3.425	-10.055

B.M. 12 H_i [-6.63]

A	N'-9 BOTTOM OF SAND FILLED CAVITIES	2.93	-9.56
B			
C			

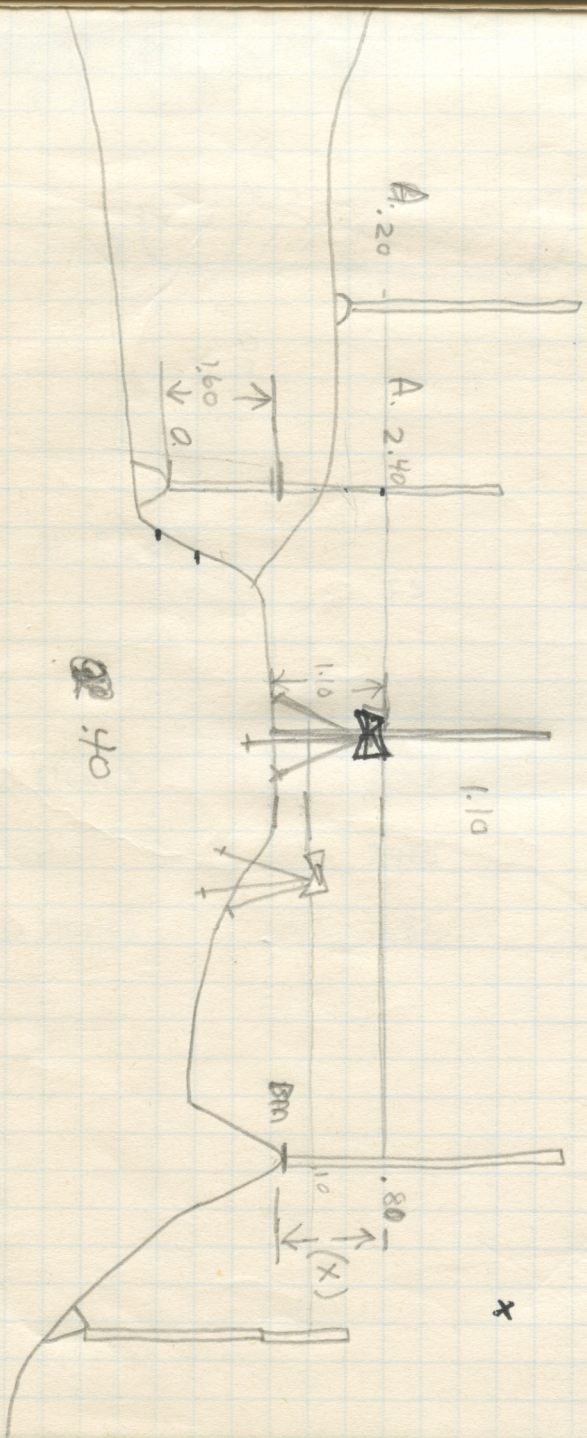

$A - X = B.M. - D.$
 $2.40 - .80 = -1.60$
 $.20 - .80 = +.60$

SANCTUARY
BAULK at N-8
E/W

85cm

7.16.82

DIFF
COLOR
SOIL -

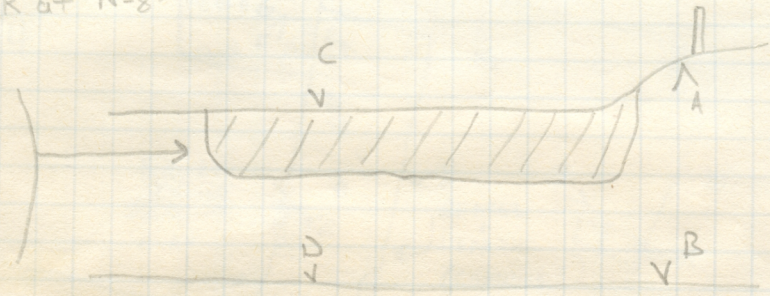

BM .14

Hi [-6.61]

STATION	FS	ELEV.
A N-9	2.33	-8.94
B FIELD STONES	2.87	-9.48
C MID TOP	2.485	-9.095
D FIELD STONES	2.83	-9.44

SANCTUARY

7.16.82

O-3-4



Sand + gravel
below
CLAY

GRAVEL
EARTH
(CHANNEL?)

CANAL

(0m.14) + PLS

B Hi [6.61]

0-5

+ N-S WELL

CHANNEL

STATION	FS	ELEV.	FS'	ELEV
A	3.09		L	2.73
B	3.125		M	2.715
C	3.115			
D	3.11			
E	2.935			
F	2.415			
G	2.935			
H	2.53			
I	2.76			
J	2.665			
K	FLAT STONE WALL	2.28		

SANCTUARY M.N'-7

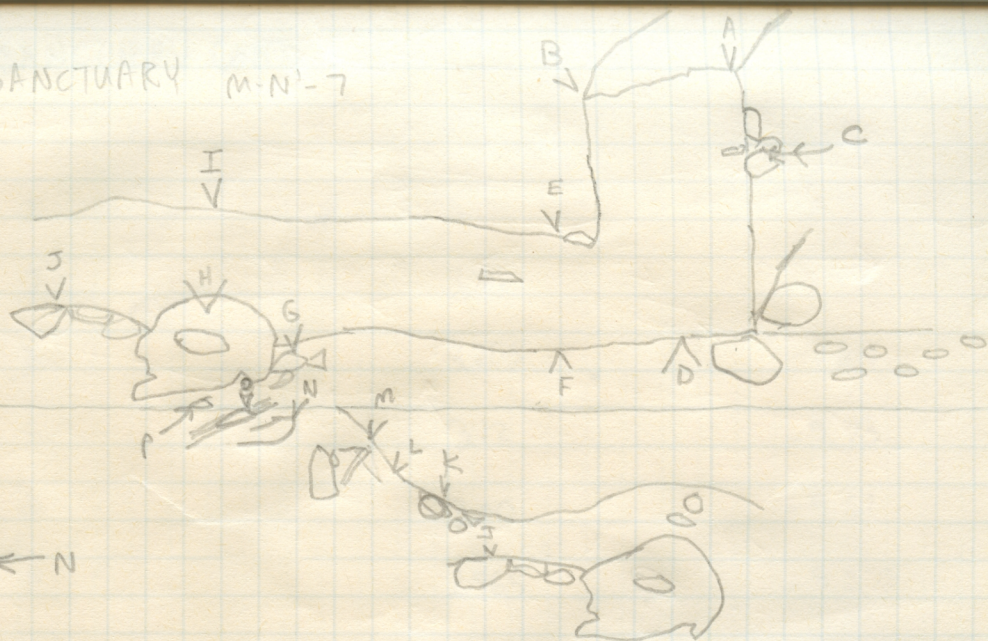

STATION

FS

ELEV

A

2.73

-9.34

B

2.83

-9.44

C

3.09

-9.70

D

3.50

-10.11

E

3.18

-9.79

F

3.545

-10.155

G

3.42

-10.03

H

3.27

-9.88

SANCTUARY CONT.

	FS	ELEV
I	3.12	-9.73
J	3.36	-9.97
K	3.205	-9.815
L	3.12	-9.73
M	3.00	-9.61
N	2.965	-9.575
O	2.875	-9.485
P	2.79	-9.40

SANCT. WELL INSIDE ELEV.

B.M. .16

7.16

Hi [-6.59]

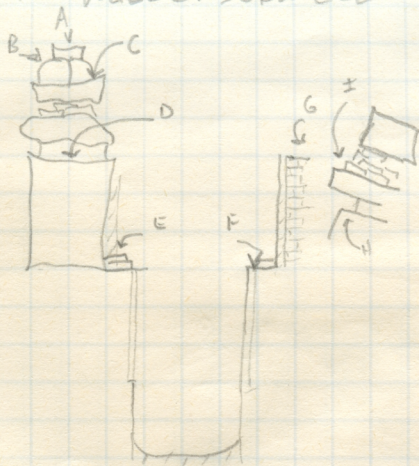

STATION	FS	ELEV
A	1.18	-7.77
B	1.21	-7.86
C	1.31	-7.90
D	1.645	-8.235
E	2.14	-8.73
F	2.14	-8.73
G Tile Top	1.61	-8.20
H.	1.89	-8.48

SANCTUARY

← N

7.19

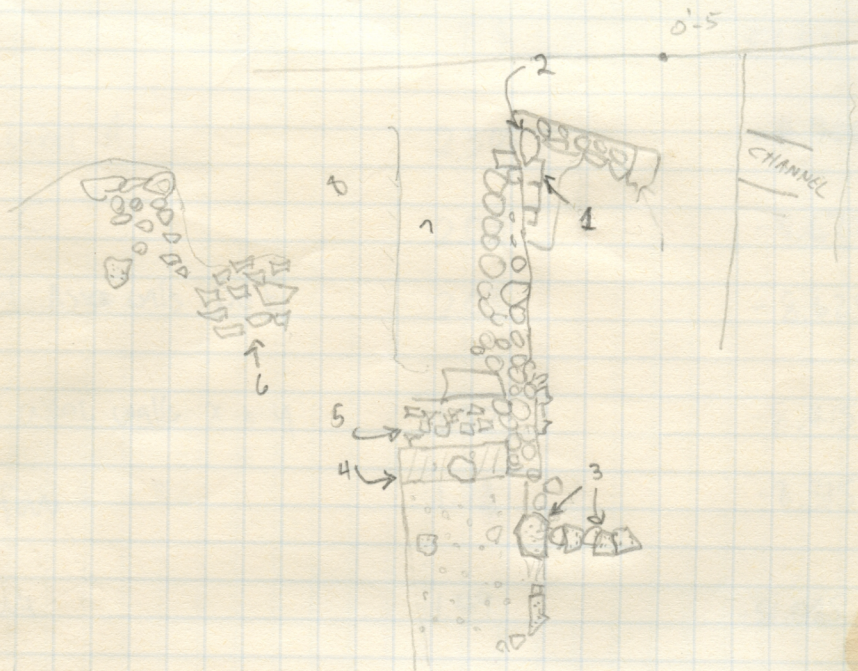

OVER →

COMPARISONS

A. TOP ROCK MON WALL	2.30	-8.89
B 2 nd from SEND MON WALL	2.39	-8.98
C TOP OF CONGLO WALL IN 0'-3 (3 rd block) N/S	2.35	-8.94

Bm = 155 Hi = [-6.595]

	FS	ELEV
1. Assoc. Level A	2.305	-8.900
2 Assoc C	2.08	-8.675
3 parent Assoc walls DdE	2.03	-8.625
4 parent assoc walls X & Y	1.82	-8.415
5 Tile Fall	1.72	-8.315
6 Tile Fall	1.49	-8.085
7 Ball 1	1.89	-8.485
8 bottom of ball 2	1.665	-8.260
9 pebble layer in bank (at intervals) just N of 0's	2.49	-9.085
10 " " "	2.21	-8.805
11 " " "	2.19	-8.785
12 " " "	2.20	-8.795
13		

SANCTUARY 0'-4 CERAMIC
FS (BATT 1) BM-.16 Hi [6.59] 7-19

A. 0'-4 2.74 -9.34

B Ceramic material 2.74 2.83 -9.42

UNDER FIELD STONE
LAYER IN 0'-4 EAST

→ (JUST UNDER FIELD STONES)
ARCHAIC MATERIAL

COMPARISON WITH VOTIVE CUP
FOUND IN N/S BULK IN N'S
(CHANNEL) ON 6-15-82
-9.23

7-20

SANCTUARY N'O'-4 BATT 1 ^{9m}.13 H. [6.62]

7-20
N →

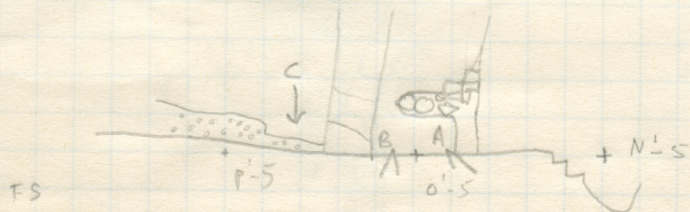

FS

A. 271 -9.33

B 278 -9.40

C FROM YESTERDAY
FOUND ARCHAIC
CERAMIC MATERIAL -9.42

BATT II LEONARDO

BATT III PEPPE

↳ pavement under THE

FALLEN TELES (-8.315)

N'-4

SANCT. CONT. N'-34, O'-34; BATT, 2 + 3;

7-20

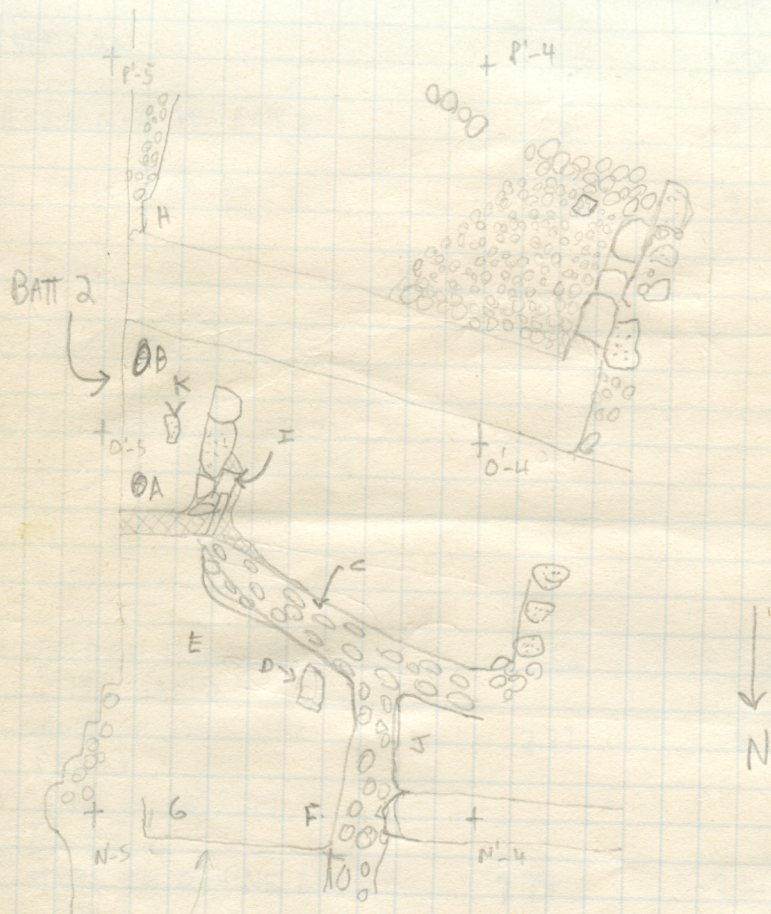

X/2 BUILDING

BATT 3

SANCT. CONT. N'-34, O'-34

BATT 2, BATT 3

7-20

STATION

FS

REV

BM-13

Hi [6.62]

A	IN N'-4 SE BATT (2)	2.85	-9.47
B	IN O'-4 NE BATT 2	2.90	-9.52
C	WALL XYZ		
D	STONE IN XYZ		
E	PAVEMENT ASSOC WITH BUILDING XYZ		
F	" "		
G	" "		
H	CHECK ON VETERAN'S [9.42] FINDS	2.82	-9.44
I	CHECK ON STONE WALL [8.90]	2.27	-8.89
J	CHECK ON PAVEMENT [8.41]		
K	STONE IN O'-4 NE BATT 2 [TOP]	2.79	-9.41

		BM-13	Hi [6.62]	7-20-82
A ₁	In N'-4 SE BATT (3) (same as A)	2.965		-9.59
B ₁	In O'-4 NE BATT 3 (same as B)	3.05		-9.67
A ₂	" BATT (4)	3.17		-9.79
B ₂	" BATT 4	3.25		-9.87

Hi [6.62]

SANCT. CONT

7-20

N'-4 BATTUTA 4 SECOND PAVEMENT. SMALL PEBBLES

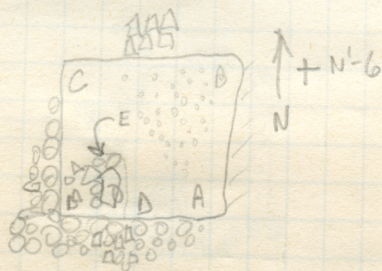

	FS	ELEV.
A	2.20	-8.82
B	1.99	-8.61
C	1.97	-8.59
D	2.18	-8.80
E TOP OF EXPOSED WALL	1.97	-8.61

N'-4 SE, O'-4 NE CHANNEL (LEONARDO)

Hi [6.63]

7-21

FS

ELEV

A₃ N'-4 SE BATT(5)

B₃ O'-4 NE BATT 5

C POCKET OF CLAY

D CHECK ON EARLIER READ 2.82
AT STATION H (7-20) [2.82] ✓

SANCT. CONT

N'-4 PAVEMENT

Hi [6.63]

7-21

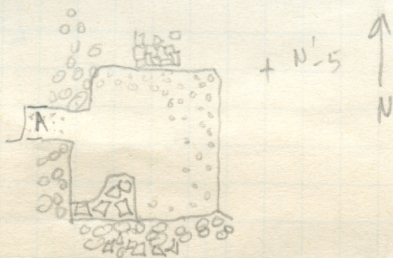

A 1.51 -8.14

B

C

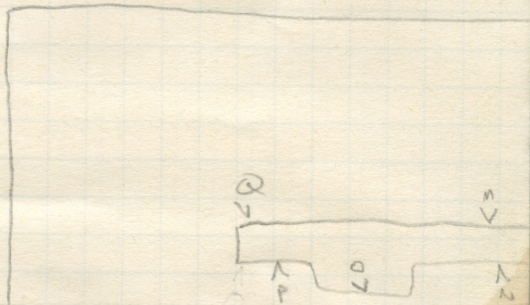

SECTION 0'-3.0'-4' LOOKING SOUTH

6m-12

CONT Hi [6.63]

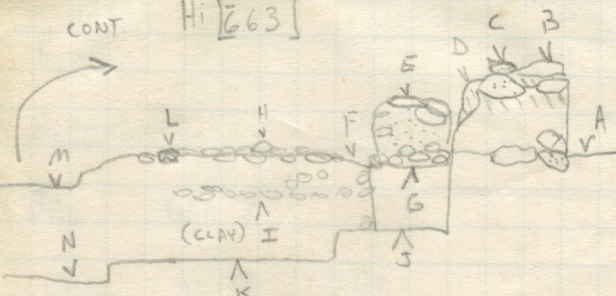

I 2.65 -9.28

J 2.95 -9.58

K 3.07 -9.70

L 2.43 -9.06

M 2.79 -9.42

N 3.32 -9.95

O 3.54 -10.17

P 3.12 -9.75

Q 2.75 -9.38

A 2.40 -9.03, E 2.32 -8.95

B 2.04 -8.67, F 2.54 -9.17

C 2.05 -8.68, G 2.67 -9.30

D 2.19 -8.82, H 2.37 -9.00

(TOP STONE)

WEST TRENCH

BM. 12

H. EL. 637

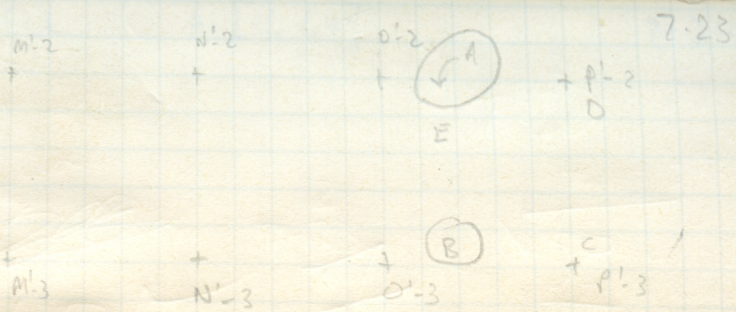

STATION	FS	ELEV
A 0'-2 BATT 5	-2.37	-9.00
B 0'-3 BATT 5	-2.36	-8.99
C 1'-3 BATT 6	-2.51	-9.14
D 1'-2 "	-2.59	-9.22
E Top of Tile Fall in P'-2	-2.46	-9.09
A ₁ 0'-2 "	-2.51	-9.14
B ₁ 0'-3 "	-2.52	-9.15
A ₂ BATT 7		
B ₂ " 7	2.48	
D ₂	2.77	

SANCTUARY WELL
BM. 11

Hi [-6.64]

7-24

	FS	ELEV
BATT 1 WELL BOTTOM 1. START WORK	2.90	-9.54
2. Rocks	3.26	-9.90
3. Sandy bott.	3.41	10.05
4. Large slab rock	3.02	(Nth end) 9.66
"	3.06	(Sth end) 9.70