

BLOCK NOTES

PIZZICA CANAL
NOTEBOOK 4

5 July 1977 - 15 July 1977



13) N'-6, O'-6

12) N'-5, O'-5

8) M-6

2) M'-2

11) N'-4

15)

N-S Trench

East Extension

5) M'-4

3) M'-2, N'-2

05) L'-4

6) M'-4, M'-3

9) N'-3

7) M'-5

1) M'-1

14) N'-7, O'-7

4) M'-3

10) N'-3, N'-4
Room 1

0) L'-3

WALL CONSTRUCTION

Wall construction -

- 1 L' ~~to~~ N edge
- 2 N edge
- 3 S
- 4 S
- 5 L E
- 6 L E
- 7 L+L' W
- 8 L+L' W
- 9 L+L' E
- 10 L south end
- 11 L
- 12 L' W end
- 13 L' W end
- 14 L' W end
- 15
- 16
- 17

map of the [unclear]

N^o-5 level 5 bath. 5

NW corner

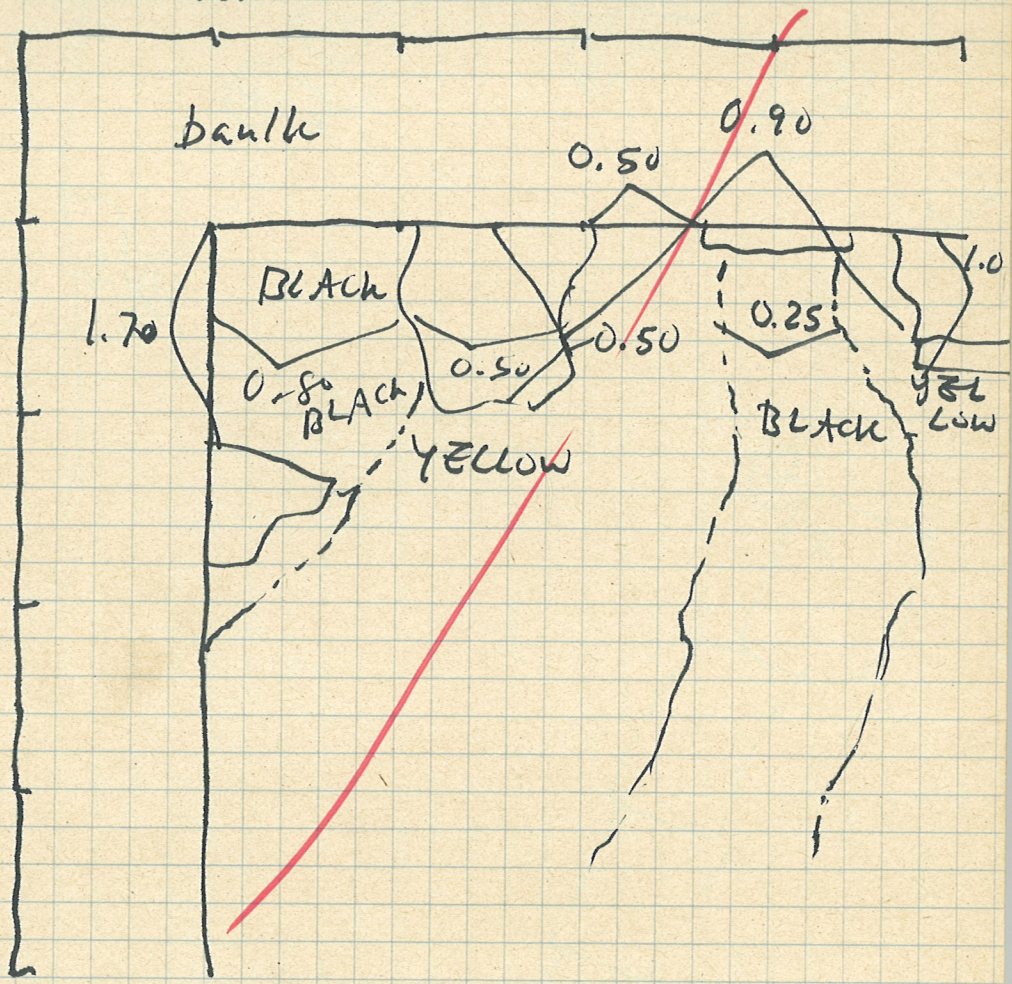

5 July LEVELS

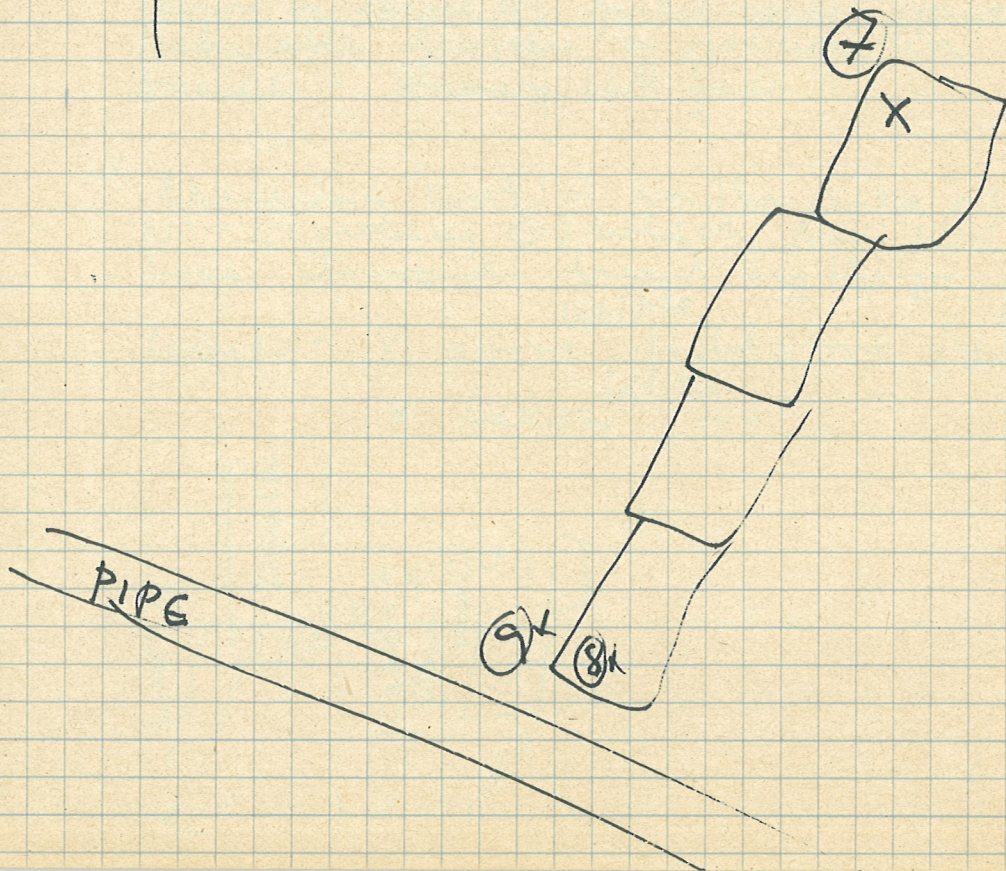
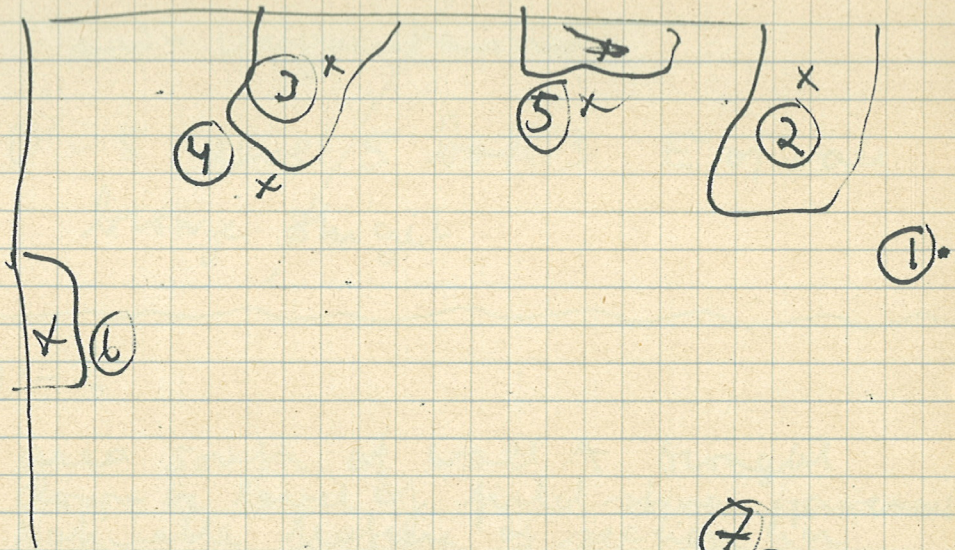

N¹-6 level 4 batt. 1
min - unguentarium

O¹-5 level 5 batt. 3 E of wall
bronze shingil

N¹-2

area south of wall A brought
down to level of field stone pavement
Noticeable feature of section in
bath - heavy hill fall.

clearing cut in the area of
N¹-2 (nearby E) which has not
been cleared dried by the pump,
levels - 3 above ^{visible} field stone pav.
4 below ^{visible} - - -

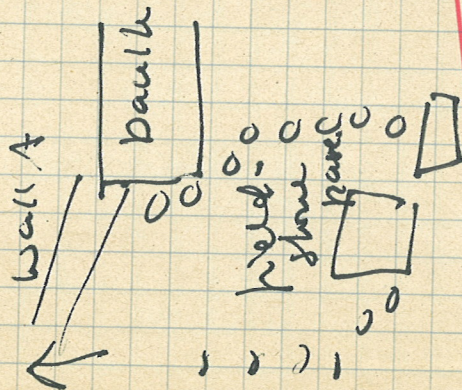

0'-5 South end, West of wall Level 5, BATT 5
CARBON SAMPLE - LARGE LIMB IN BLUISH-
GRAY CLAY MATRIX w/ SOME ROOTLETS.
Limb c. 0.40m x 0.12m. ACTUAL LEVEL -9.69
Found in area between large worked stones
left in situ from earlier batt.

N¹-7 Wednesday 6 July 1977

Sketch
plans
of all squares
sections
&
trenches

due to flooding of N¹+O¹-5 and
N¹, O¹-6 work was cont'd in N¹-7

Level 2 cont. of batt. 4 no tiles so
far - otherwise this level would
correspond to the level of the tile
fall in N¹-6, which is recorded as
level 3

Findings: S end of N¹-07

bronz ring - small piece missing

cont'd cleaning of N¹-4

wall 5' + cover SE

N¹-7 finds, cont'd

few tiles in N. end

lump of metal - lead?

one small ^{round} loom weight w. one hole

one large round loom weight w. hole
in center

large TC 'knob', + fragment of
another

a few bones

very little pottery
round brown weight w. 2 holes

level 3 ball. 1

although the tiles are not numerous
this level seems to correspond to
level 3 (with the tile fall) in N'-6

M'-5

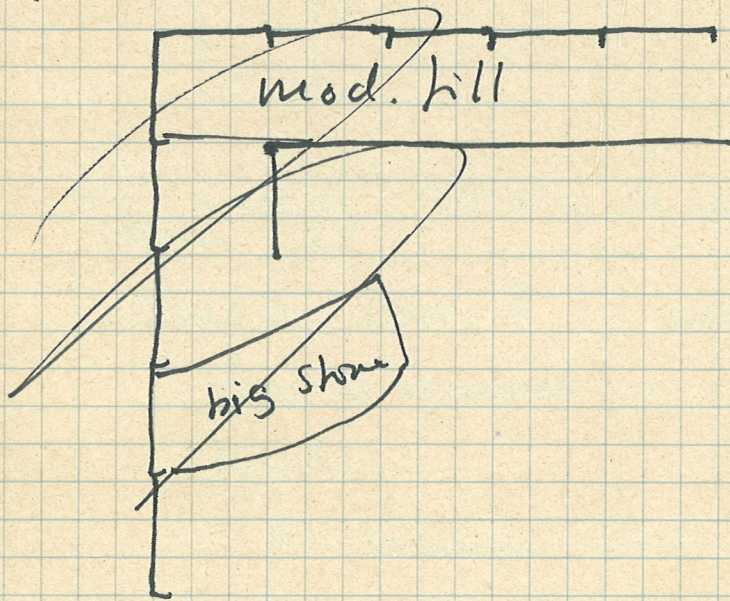

M'-5

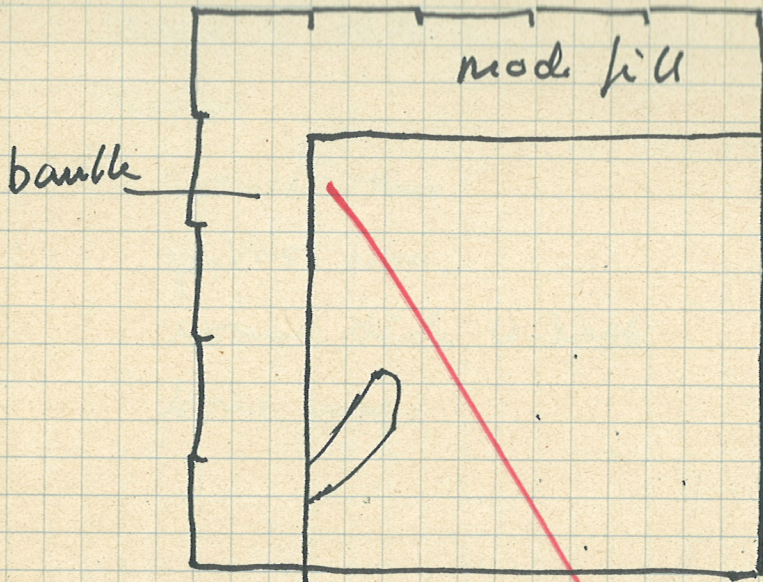

work cont'd - starting at level of big
stones (2)

level 3, bath. 2 (see PIZZICA
tiles + gravel 1976-1977
p. 179)

Findls:

TC column casing - fluted
large TC block with cylindrical
hole - don't put 3

TC column casing (?) iron
iron pipe

N' - 7, O' - 7

level 3 ball. 1

Finds:

Coarse ware

pitheo rim

round dish w. knob

bone pegs

general cleaning of wall 5'

Thursday 7 July 1977

~~N'-7, O'-7~~

~~level 3, batt. 1 cont'd from
yesterday (bones, coarse ware
iron bronze nail)~~

~~N'-6, O'-6~~

~~level 4, batt. 1 cont'd from 5 July~~

~~M'-5~~

~~level 3, batt. 2 cont'd~~

~~N'-6, O'-6~~

~~level 5 (correlation with N'-5, O'-5,
i.e. below surface of wall (which
is level 4))~~

~~batt. 1~~

~~N'-6, O'-6~~

~~level 4 batt. 1~~

~~Finds: coarse ware in abundance~~

~~ovine Sahyt's head~~

~~female head~~

~~statuette frag ca. 25~~

round loomweight 2 holes
broken

M¹-5 level 3, batt. 2 photographs
 Finds small bag of seeds
1 small statuette frag.
hard soil w. many small stones

M¹-5 level 3, batt. 3 tiles in section

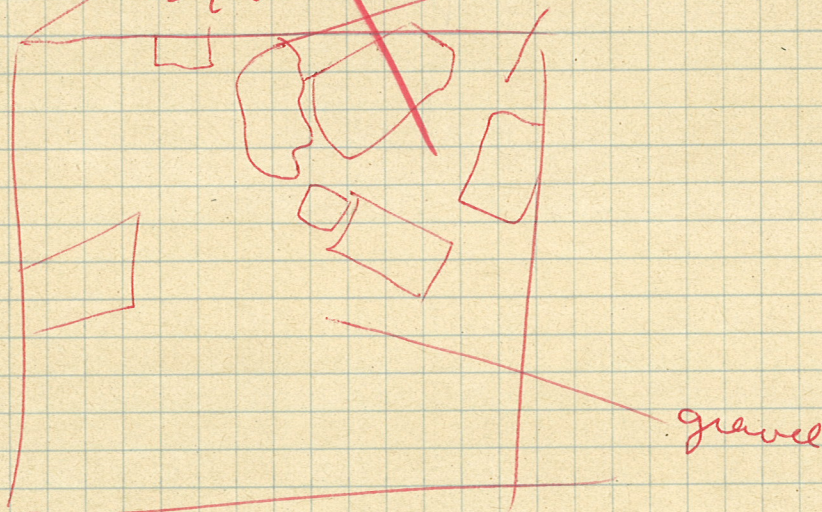

N²-6, O¹-6 level 5, bath 1

Finds: again much pottery

coarse ware

red ware

few painted sherds (mostly vase

bases) 4th cent?

neck of tall jar

hollow 'knob' or 'base' with thick

side

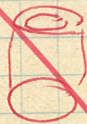

fragmentary white bead

'S. Giuseppe Vecchio' acc. to Emanuele

scrappy stamette legs

at the W end of N¹-6 appeared
2 large square stone blocks
which continue the line of the
wall in N¹-5, O¹-5. The edge of a
third block appears to the right
of the second block.

between this set of blocks and the
one previously uncovered, there's
a depression with fragments of
vases and tiles

N'-6

(testimonies? removed - consist of
levels 3 (hile fall 1), ~~level 4~~
~~level 5~~, and level 5 down to
level 4 below shoe blocks in
K123 4 (hile fall 2)

Finds:

level 3 ball 1

round disk w relief design

female volute head

statuette frag

black glaze

~~BF~~ shard

loom weight - 2 holes

encasement for column

rectangular piece of iron w
knob in center

Note layer of large field shoes
below hile fall #1

level 3 ball 2

statuette frag including head

loom weight

M'-5 level 3 ball 3

statuette frag - incl. head
n of stone in W bank

shell - red coarse ware

still gravel and hard soil
esp. E. half

N'-6 testimonio

level 4 ball 1

(below 2d tile fall)

male votive head

$2.66 + 1.13 =$
 $-1.53 - 7.78 =$
 $-9.31 + .40 =$
 -8.91

N'-6 TESTIMONIO LEVEL 4 CARBON SAMPLE
 LARGE FRAGMENTED LIMB, c. 0.06 x 0.04 m. in dark
 brown sandy clay. Rootlets present. Found east
 of wall c. 0.40 from base of level 5. Associated
 with large stones and fragments of tiles and pottery.
 ACTUAL LEVEL = -8.91 m.

M'-5 level 3 ball 4

statuette frag

N'-6 testimonio ~~level 4 ball 2~~

statuette frag

~~level 5 ball 1~~
upper surface below stones
of in M'-5

in the lower part of the
stratum and the large stone
appeared

Friday 8 July 1972

M¹-5

~~level 3, batt. 4 cont'd (removal
of soil)~~

~~volive head + other statuettes
column casing~~ hops

M¹-6

~~level 2, batt. 1~~

~~tiles + gravel~~

N¹-6, O¹-6

~~level 5, batt. 2~~

~~more tiles than in the
previous batt. along edge of wall
also blocks at S end, by pipes
1/2 of large basin~~

~~statuettes hops~~

~~RF shield w. meander pattern
and square w. dots~~

~~complete unegumentarium~~

dault

mod wh

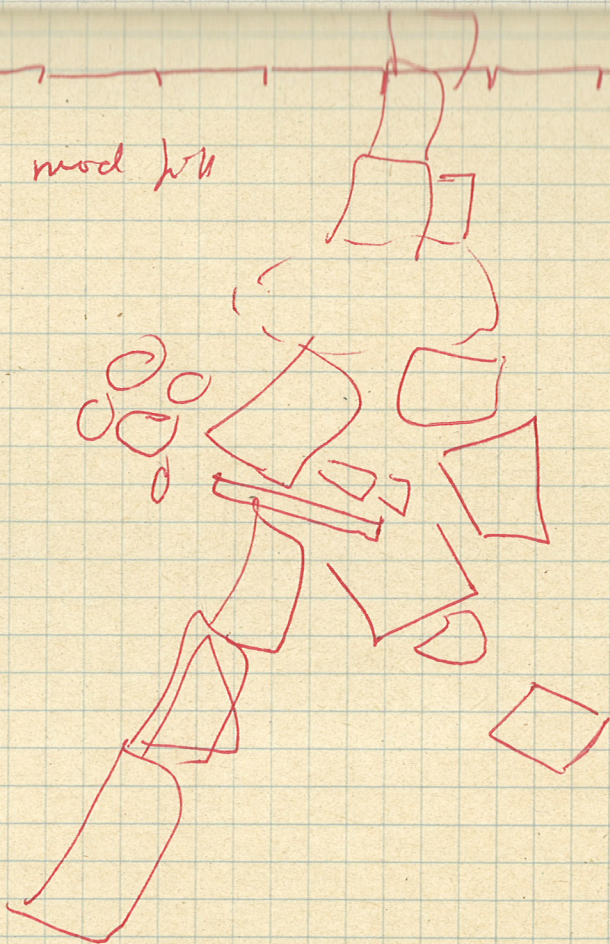

~~level 5, batt 2~~

~~finds:~~

~~painted shreds~~

~~statuette fragments~~

~~pyramidal loomweight
broken~~

~~RF shreds - 9.56~~

~~small pyramidal loom weight~~

~~level 6 batt 1~~

~~tile layer - very heavy black
soil~~

~~M-6 level 2 batt 1~~

~~finds: round loomweight - 2 holes~~

~~lump of iron~~

~~worn loomweight~~

~~fragment of loomweight 2 holes~~

~~fragment of TC statue (He)~~

~~painted slipper~~

N¹-6, D¹-6

~~level 6 batt. 1~~

~~nine RF sherds - same vase?
absolute D. 9. 71
(distance from the one previously
found ca 1.50 m.)~~

~~black-glaze plate frags~~

Monday 11 July

~~N¹-6 level 2, batt. 1 finished few sherds~~

~~level 3 batt. 1 started
(below tiles + gravel)~~

~~only W. part 1.50 m. left~~

N¹-6

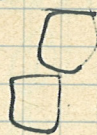

N26, O26 level 6 batt. 1
finished

noticeable tile fall and con-
centration of pottery

Finds:

statuette frag
seated fig - hand + upper
part of throne

1 box of sherds - a surprising
amount of coarse ware.

2 RF sherds - one with the
profile of a woman - might
belong to the vase

~~levels~~
elevations

- ① tiles N end - 9.73
- ② tiles S end - 9.58
- ③ square block - 9.58
- ④ block w. mason's mark
- 9.31

square block w. hole E of wall

NL6, 016

level 6 batt. 2

tiles lifted

beginning at the S end

M1-6

level 3 batt. 1

sherds

N corner's field stones

vase bottom

column drum

field stones

level 4 batt. 1

now definitely below tile face!

dark

below drum

N'-6, O'-6

level 6 ball. 2

Finels

~~heavy black
soil -
Carbon~~

~~more RF shards~~

~~shattered frags~~

~~Black Glaze cup~~

~~fig. 8 loom weight~~

~~shard w. loop design
black thin~~

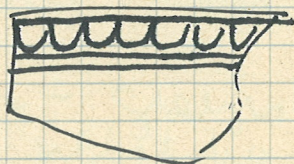

~~lipped vase vase in wall~~

~~N'-0'-6 level 5~~

~~righted E edge of wall~~

~~+ neck and handle~~

~~from same spot~~

~~coarse ware -~~

~~cylindrical neck~~

Carbon sample

level 6 batt. 2

E end of square

4.50 m. S of NE corner
of square

ca. 3.20 E of mason's mark

~~ML5 level 4 batt. 1~~

~~lamp, jar~~

~~Gones~~

~~statuette frags.~~

~~Including satyr's head~~

~~1 box~~

~~w. 5 beads~~

~~statuette~~

~~burial vase - grayish~~

~~neck + ribbed handle~~

~~N: 0'-6 LEVEL 6, BATT 2 CARBON SAMPLE~~

~~LARGE ROUGHLY RECTANGULAR CONCENTRATION OF CARBON:~~

~~3.00 x 0.40m Many limbs + lenses in a gray clay
matrix which has a greenish tint. Possibly the remains
of a burnt beam of wood. In east end of square~~

~~4.50 m South of NE corner of square and
ca. 3.20 m. East of mason's mark. Potholes present.
Usually lack of aluminum. ACTUAL LEVEL - -9.78m.~~

actual
width
is
greater
than
layer
point
to
N: 0'-7

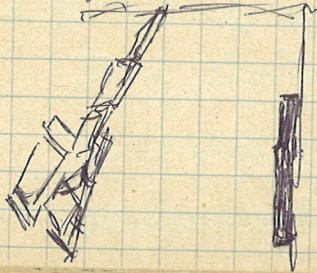

enter in book

p. 131

~~N1-6, O1-6
level 6 batt 2~~

~~San Nicola - satyr's head
bearded~~

~~(a San Giuseppe)!
fragile vase next to wall~~

~~M1-6 level 4, batt. 2~~

~~N1-6, O1-6.~~

~~level 6, batt 2~~

~~Statuette fragments~~

some more tiles
visible

3rd stone E of
2nd stone joint

~~N1-6, O1-6~~

~~level 6 batt. 3~~

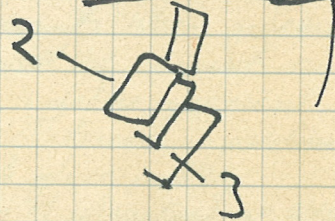

~~M1-6 level 4 batt. 2~~

small
vase

~~Finds:~~

~~2 RF sherds~~

~~shu design~~

~~meander~~

~~round loomweight~~

~~2 holes~~

female
figure
head

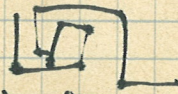
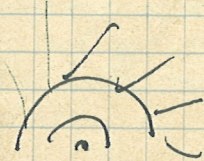

N 66 0' 6

level 6 batt 3

statuette frags

burnt area continues along E edge of square

blocks in N section, immediately E of wall - angle 2
Soil very wet here

small cup on pavement -
pavement - blocks

large basin fragments

N¹-2, -3 level 3 (levels 1/2 + part of 3 excav. in 1976)

This operation has the purpose of defining the area of the 6th B.C. sanctuary. Level 3 = area down to pavement. Level 4 = Area below pavement. Plan is to take area down only to the level of pavement. When pavement does not appear deeper excav. will be carried out to search for pavement. Also plan to define apparent entrance of structure to the west. Material is predom. coarse sand w/ some frags. of black glaze pottery. Pavement has appeared in interior of structure as expected.

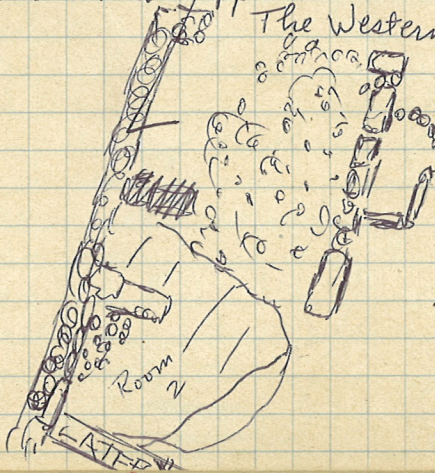

The Western entrance still is not def. but work on off. day should clarify set.

Large area around "Pit 2" does not yet show pavement. Further work tomor. should reveal it.

Tuesday 12 July 1977

N¹-6, O¹-6

level 6 ball 3 ~~cont'd~~ in S half of square left

level 6 ball 4 ~~cont'd~~ in N half - dark, heavy, clayey soil

M¹-6 level 4 ball 2 ~~cont'd~~ 1 box of ^{coarse} sherds few tiles

N¹-2, -3 ^{O¹-2-3} Work continues in attempt to clarify 6th c. structure

level 1 - completely excavated in 1976

level 2 - gravel area down to 0.05-0.10 m. above pavement; one area left unexcav. in 1976 to be taken down.

level 3 - area directly above + down to pavement c. 0.05-0.10 m depth; area to be taken down to pavement throughout squares under excavation.

level 4 - area below pavement

N¹-2, 30'-2-3 CARBON SAMPLE

Limbs and lenses in an area c. 0.12^m x 0.3^m bounded by broken pottery. At first it appeared that the carbon was located w/in one frag. vessel, however frags do appear to represent more than one vessel. (Frag. have been kept separate w/in lots.) Sample was located in N¹-3 level 3 very near level 4 where pavement should although none has appeared in this area, SAMPLE WAS 2.90 m. North of South wall of 6th c. structure + c. 0.10 m. East of latter wall running perpendicular of South 6th wall SAMPLE IN A GRAY CLAY MATRIX w/ STREAKS OF REDDISH SAND; ROOTLETS PRESENT. Pottery is all of very fine ^{friable} orange coarseware, most appears to be from a fairly large bowl, one rim fragment from a smaller cup or bowl with interior glaze and linear ^{decor.} design on exterior

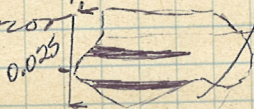

ACTUAL LEVEL - 9.22 m.

POSITION OF CARBON SAMPLE N'-3 —

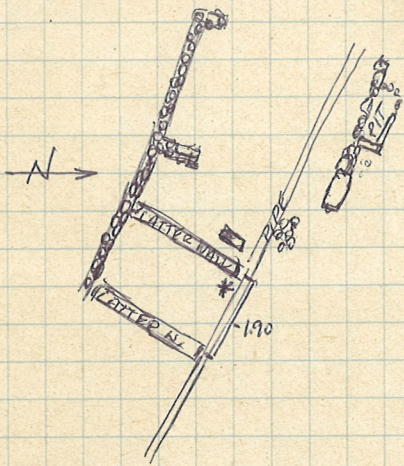

~~N'-6, 0'-6 level 6 batt. 3~~

~~large cover tile~~

~~level 6 batt. 4~~

~~NE corner very muddy clayey soil~~

~~Feet of S. Nicola + pag.~~

~~M'-6 level 4 batt 3 soil w. and
1 box of sherds - coarse few tiles sandy
found loom weight~~

~~level 4 batt 2~~

~~work female olive head~~

~~Level 6~~
N 6, 0' - 6, N end

level 6 ball

pottery
a few tile frags - all large
stones placed unevenly around
tiles
closest to wall greenish-gray
soil (2)

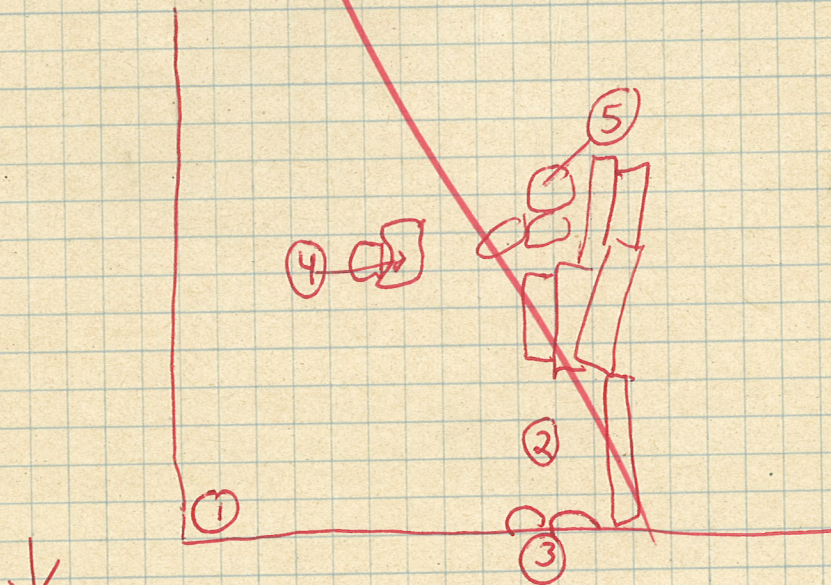

- N ↓
- | | | |
|-----|--------------------------------|--------|
| (1) | deepest point N corner | -10.17 |
| (2) | greenish-gray soil | -9.88 |
| (3) | stones in wall | -9.62 |
| (4) | blocks in center of square | -9.76 |
| (5) | pavement immediately E of wall | -9.94 |

M¹-6 level 4 batt 3

Finds one box of sherds
more crane wave

under hand
head

many
wet and
broken
pops

shattered pop cluster in NE
corner of batt.

foot

where soil is wet
also tiles there

vegetation

heavy wet soil - beginning of
tile ball

block at S end corresponding to
wall in N¹-6, O¹-6??

~~N¹-6, O¹-6 level 6 batt. 4~~

~~beautifully laid pavement cleaned
consist of field stone and tiles.~~

~~fair amount of tiles and large pops,
including large flat bricks.~~

~~large brick tile~~

M¹-6 level 4 batt. 3

3 box of sherds started

1 box of stat pop.

small
airballs

M^L-6 level 4 batt. 3

NE corner
more stab. traps. + W/Cs

N¹0'-2.3 - level 3 - fragment of long pin?
Bent into config resembling a bent out of shape
paper clip.

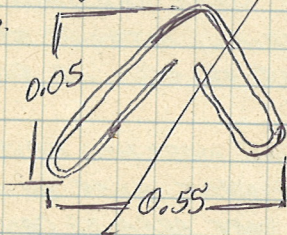

M^L-6 level 4 batt. 4

reached water level in NE corner
blocks visible in center
painted tiles along E edge

2 1/2 m from top
N section of square showed by a
M-6 excavation of mud fill

JULY 13, 1977

MONDAY JULY 18, 1977 —

N¹, 0' - 2 LEVEL 3 AREA ALONG EAST EDGE OF PAVEMENT
TROWEL FINISHED & NOW CONTINUES ON SOUTHWARD
PAVEMENT IS NOT PRESENT IN AREA BETWEEN LARGE WORKED
STONE STILL IN SITU & THE WESTERN CORNER FORMED BY M¹ & M²
PAVEMENT AREA ABOVE NORTH EDGE OF WORKED STONE MAY BE
IN CIRCULAR CONFIGURATION, BUT EXACT NATURE IS IMPOSSIBLE
TO ASCERTAIN DUE TO POSITION OF LARGE STONE

0' - 2 LEVEL 3 TROWEL WORK CONTINUES FROM ABOVE
NO DIFFERENCE IN MATERIAL. ALTHOUGH STATE OF PRESERVATION
VARIES THERE IS PAVEMENT OR BUILT UP PAVEMENT
THROUGHOUT AREA.

0' - 1 LEVEL 3 REMAINING WORKMEN HAVE ~~BE~~ CONTINUED
TAKEN DOWN AREA ALONG WEST EDGE OF SOUTHERNMOST
FRAG. OF A DOWN TO THE DIKE AREA OF CANAL. PAVEMENT
APPEARS TO BE PRESENT THROUGHOUT, BUT TROWEL WORK IS
NECESSARY. MATERIAL IS PREDOMINATELY COARSEWARE
WITH SOME BLACK GLAZE.

M¹ - 2 walls in this square cleaned for photo-
graphs and for study of construction.
Part of last year's fill removed in order
to expose sides of wall.

JULY 13, 1977

M-6 exploration of mud fill

N section of square showed by a cut

W of mud fill 1.50 m
2.10 m. from E edge
W 0.35 m

stat. bags appear immediately
also water at level 4

N-6, 0'-6 removal of wheelbarrow
ramps. level 6, batt. 4 cont'd
in S part of trench, immediately
N of pumps

N-1, 0'-2, -3 Level 3 - Long piece of metal, most likely
lead. Original function of lead unknown.

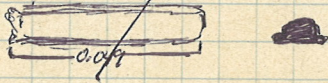

N-7, 0'-7

An E-W test cut, W 1.50 started
to explore possible parallel wall

2.35 m. N of southern edge of square
level 3, batt. 2

one small bag of shreds
~~level 3, batt. 2~~
1 lead ring (ancient?)

below surface level of blocks

level 5 built

9-11

M¹, N¹ - 1 AREA BOUNDED BY P¹, A, A¹, M¹ LEVEL 3

TROWEL WORK BROUGHT ALMOST TO COMPLETION.

PAVEMENT PRESENT THROUGHOUT AREA. FINDS FEW

IN NUMBER 1 ASSORTED COARSEWARE + GLAZE WARE FRAGS.

N¹, O¹ - 2 LEVEL 3 - AREA ALONG EAST EDGE OF A

PAVEMENT AREA ~~ALREADY~~ PARTIALLY CLEANED. ~~POT~~ SHERD

DENSITY CONTINUES TO BE VERY HEAVY, MOST SHERDS WERE

LEFT IN SITU FOR PHOTOGRAPHY. SOME ~~LARGER~~ STONES IN

AREA SEEM TO HAVE FALLEN FROM WALL. OF SHERDS

REMOVED - ASSORTED G.W., 6TH RIM, GLAZE WARE.

CLEARING OF AREA WILL CONTINUE.

M¹-6

level 5 batt. 1

below surface level of blocks
water level precarious
blocks ca 1 m. each
very brittle conglomerate

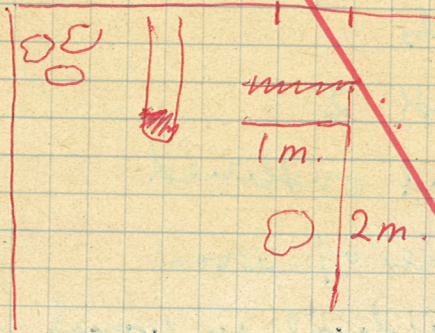

in white deposit
wire steel trap
2 small complete
vases
large flat TC pan
'brazier'

1 box of shears

one very fine W
of wall

blocks in E
section

N²-6, O¹-6

level 6 batt. 4

wood fragments - put in
aluminum foil in grey wet soil,
between stone block and over tile

N⁴-7, O¹-7

level 3 batt. 3 staked

very little pottery

lead weight

few sherd
level 3 trashy
N-7, 0-7
2-0-7

~~N-8, 0-8~~

~~level 6 ball 1 dark, brownish-
black soil heavy
corresponds to pavement
in N-6, 0-6, and N-7, 0-7
a few tiles in section
1-2 sherd~~

~~level 6 ball 2~~

~~extent of pavement outlined~~

~~two pieces of wood PZ 77-1002~~

~~Spindlewheel w/ wood preserved
PZ 77-1003 T~~

0-1-1 LEVEL 3 AREA WEST OF K. —

AREA EXTENDED EASTWARD ALONG SOUTH EDGE OF K. LARGE
STONES CONT. TO APPEAR WHICH MAY BELONG TO A WALL HOWEVER
THE EXACT FUNCTION OF THESE STONES IS STILL NOT KNOWN.
PAVEMENT CONTINUES THROUGH AREA. MATERIAL CONSISTS OF
MOSTLY COARSEWARE WITH SOME BLACK GLAZE WARE, A FEW
FRAGMENTARY VOTIVE VASE, ONE RIM FRAG. W/ CHAR. 6TH RIM.

TROWEL WORK NECESSARY IN THIS AREA.

N-1 AREA BOUNDED BY λ , λ' , & K LEVEL 3

TROWEL WORK CONTINUES. PAVEMENT APPARENTLY PRESENT
THROUGHOUT AREA. UNUSUAL CIRCLE OF STONES FOUND W/IN
PAVEMENT AREA, NOT CERTAIN WHETHER ~~THEY~~ IT IS THE
RESULT OF ACCIDENT OR THE DEFINE A CIRCULAR AREA OF UNKNOWN
FUNCTION. NO CHARCOAL FOUND IN AREA TO INDICATE FUNCTION
AS FIREPLACE. MATERIAL VERY SCANTY: LEKANE FRAG.
BLACK GLAZE, 6TH RIM, A FEW ASSORTED COARSEWARE
FRAGS.

N¹-7, O¹-7

level 3 batt. 4

few sheels
a few stat. frags

level 3, batt. 5

few sheels
stat frags

level 3 batt. 6

dark heavy
soil

few sheels

level 4 batt. 1

corresponds to 2d pilefall in
N¹-6, O¹-6 but fewer hills
dark heavy soil

N⁰ 1-2, -3 LEVEL 3

HEAVY PICK WORK FINISHED IN THIS AREA, TROWEL WORK IN AREA BEGUN.

IN EASTERN HALF OF CORNER FORMED BY J & J. THERE TWO TYPES OF PAVEMENT & POSSIBLY A WATER ORNAMENT. THERE IS APPARENTLY A WATER

~~level 4 batt 5~~

~~grey soil - specks of mud brick
very few tiles~~

~~1 small bag of sherds
including 1 small stat. frag~~

~~level 5 batt 1~~

~~black soil - very few tiles
more towards the
W end
thin shreds
small bag of~~

~~level 5 batt 2~~

~~continuation of tile fall
virgin soil at E end~~

~~level 5 batt 3~~ ^W tiles ^W pile out - black soil - virgin soil E

~~tile fall frags of blocks
mixed in (slivers)~~

~~cover tile - complete W.
1 small bag of sherds~~

~~level 5 batt 4~~

~~few tiles 1 large bone
few sherds~~

N¹, O¹-2, -3 LEVEL 3

HEAVY PICK WORK FINISHED IN THIS AREA, TROWEL WORK IN AREA BEGUN.

IN EASTERN HALF OF CORNER FORMED BY μ & μ'' THERE TWO TYPES OF PAVEMENT & POSSIBLY A WATER OR ANNEAL. THERE IS AREA OF PAVEMENT WHICH USES SMALLER STONES THAN OTHER PORTIONS OF P. THIS PAVEMENT IS ALSO AT A LOWER LEVEL & MAY HAVE SERVED AS SOME SORT OF WATER CHANNEL.

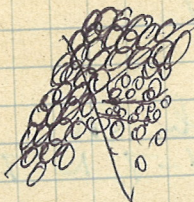

IN AREA IMMEDIATELY ~~SOUTH~~ EAST OF λ NO PAVEMENT HAS BEEN UNCOVERED. ~~IT MAY BE DEEPER~~ THERE ARE SOME SCATTERED STONES BUT NO WELL-DEFINED PAVEMENT. FURTHER INVEST. MAY REVEAL P. AT A LOWER LEVEL BUT AT PRESENT THE P. IN THIS AREA EITHER HAS BEEN DEST. OR WAS NEVER THERE. AN AREA 1.90M ~~W~~ NORTH OF INTERSEC. OF μ & λ + C. 0.30 ~~E~~ EAST OF λ YIELDED A COMPARATIVELY LARGE AMOUNT OF POTTERY

AREA APPEARS TO BE SUNKEN & MAY ~~BE~~ HAVE A ^{PAV.} ~~CO~~ AT LOWER LEV. AS INDICATED BY SOME STONES FOUND BY TROWELING. ~~A MORE~~ FURTHER INVEST. IS NEC., POSSIBLY A WATER CHANNEL - MATERIAL COARSEWARE WITH SOME BLACK GLAZE. SIXTH CENTURY DATE LEAD 0.049m MATERIAL THROUGHOUT AREA - COARSEWARE W/ SOME BLACK GLAZE. REMNANTS OF WOODEN POST FOUND C. 0.30 EAST OF μ'' - AT THIS TIME DO NOT KNOW IF SURVIVAL OF 6TH C. WOOD IN THIS SOIL IS POSSIBLE. MAY BE MODERN - REMNANT OF DEAD PLANT OR A POST.

M¹, N¹-1 AREA BOUNDED BY ρ , λ , μ'' , & λ' LEVEL 3

HEAVY PICK WORK COMPLETED & TROWEL WORK BEGUN. PAVEMENT APPEARS TO CONTINUE THROUGHOUT AREA. NO FURTHER COMMENT POSS. UNTIL TROWEL WORK FINISHED. MATERIAL COARSEWARE & ~~BE~~ SOME GLAZE WARE. - 6TH C. B. C.

N¹, ~~O~~-1 AREA BOUNDED BY λ' , λ , & K. LEVEL 3.

HEAVY PICK WORK BEGUN, AND NOT COMPLETED. MATERIAL - COARSEWARE - (2 LEXANE FRAGS, AMPH. HANDLE) SOME GLAZE WARE - 6TH C. B. C. PAVEMENT APPEARS TO BE PRESENT THROUGHOUT BUT TROWEL WORK IS NEC. BEFORE EXACT SIT. IS KNOWN.

Thursday July 14, 1977

Friday July 15, 1977

N1-8, 0'-8

level 4 ball 1 grey heavy soil
70 cm below present level 2

dark stain
in prev. ball. ca 0.70 m. at N edge

W. of burial trench in
N1-6, 0'-6, N1-7, N1-7 + 0.70 m

N1-7, 0'-7

level 5 ball 2 - tile full at E end
small vase or narrow neck

few sherds

level 4 ball 2
few more tiles visible

votive head PZ 77.10017

small bag of sherds

level 4 ball 3 grey clay-ish
some tiles small bag of soil
sherds

level 4 ball 4 grey soil
very few sherds
tiles

8-10' 8-11N

Friday July 15 1977

Thursday July 14, 1977

N'-7, 0'-7

level 4 batt. 1 cont'd

1 bag of shreds

level 4 batt. 2 started

getting into carbon streak 1 bag of shreds

[Levels need to be correlated between W'-5, -6, -7 and 0'-5, 6, 7]

level 5 batt. 1 (more like 2 because of Giusseppe's lawn)

1 bag of shreds
shreds (= pavement?)
appearing

immediately above carbon (below remnants of mud brick alas) tile fragments around it and below

pyramidal loam weight heavily some of the material burnt

N'-8, 0'-8

cut expanded 5 m. to the E

no finds!

level 2, batt. 1

~~search~~

N'-1 AREA BOUNDED BY λ , $\lambda + K$ LEVEL 3

HEAVY PICKWORK FINISHED, TROWEL NOW NEEDED FOR FINAL CLARIFICATION OF SITUATION. THERE APPEARS TO BE A WALL AT THE 6th B.C. LEVEL AND RUNNING PARTIALLY UNDER λ . PAVEMENT IS PRESENT THROUGHOUT AREA BUT TROWEL WORK NEC. TO DEFINE ITS NATURE.

N'+1 LEVEL 3

HEAVY PICKWORK BEGUN IN CONT. SEARCH FOR THE LIMITS OF THE PAVEMENT. SMALL TWO HANDED POTIVE VASE FOUND AT LEVEL OF PAVEMENT.



~~level 5, ball 2~~

E-1, O 'E, N

N1-8, O'8

level 3 ball 4

~~few sheets~~

1 RF sheet w. spiral design

N'-7, O'-7

level 5, batt. 2

Pottery tiles
mass of mud brick

stal pag. -
head

tile fall at E end

~~mass of tiles~~

N'-8, O'-8

level 2, batt. 2

1 full tile
frag.

seed kernels

no pottery or tiles

N'-7, O'-7

level 6, batt. 1 = pavement

stone
one block
left from
level 3
as a
testimony

small cup, complete

pavement cleaned

N'-8, O'-8

level 3 batt. 1

dark heavy soil bones

2x sherds w. 'rippled' design

1 round loomweight

OVER →

N'-8, 0'-8 level 3 ball 2

again rich brown soil

kiln shivers

4-5 loose stones like

4-5 sherds in fall

1 piece of glass (modern?)

level 3 ball 3

very few tiles

2 bones

five sherds

[Elevations N end of benches in M'-6

- 9.04

pavement level 6 N'-7, 0'-7

- 10.15]

N'+1 LEVEL 3 HEAVY PICKWORK COMPLETED

0'+1 LEVEL 3 ^{AREA WEST OF END OF K.} HEAVY PICKWORK BEGUN IN CONT. OF OPERATION

SMALL AREA
RESTRICTED
BY END OF
K + PUMP
AREA.

PAVEMENT. TWO SMALL TWO HANDED VOTIVE VASES FOUND
SIDE-BY-SIDE, JUST WEST OF WEST END OF K. VASES ARE OF
SAME TYPE AS FOUND IN N'+1 LEVEL 3 AND C. 3.00 m.
SE. OF FIND SPOT OF VASE IN N'+1.

A LINE OF LARGE STONES HAS APPEARED WHICH MAY VERY
WELL BE A CONTINUATION OF μ .

MATERIAL SCANTY: COARSEWARE + BLAZE WARE

M, N'-1 AREA BOUNDED BY ρ , λ , λ' , μ LEVEL 3

TROWEL WORK CARRIED OUT ALMOST TO COMPLETION. PAVEMENT
THROUGHOUT AREA IN VARIED CONCENTRATION. NW-CORNER
OF AREA SEEMS DEVOID OF PAVEMENT. FINDS FEW, \therefore COARSEWARE +
BLAZE WARE. FRAG. COARSEWARE SPOT MAY BE SMELTING SPOT?

N¹-2 LEVEL 3 TROWEL WORK CONTINUES IN THIS AREA, PAVEMENT
PRESENT THROUGHOUT OF VARYING DENSITIES. WORK NOT YET
COMPLETE. FINDS FEW: COARSE WARE + GLAZE WARE + ONE BONE
SEVERAL PIECES OF LARGE 6¹/₂ c. Bowl FOUND - ~~SEE~~ HORIZ. BAND DEC.
SEVERAL PIECES OF SMALL ^{CRUP.} BOWL W/ BAND DEC.

0¹th LEVEL 3 AREA WEST OF END OF K —
AREA EXTENDED EASTWARD ALONG SOUTH SIDE OF K.
LARGE STONES CONT TO APPEAR WHICH MAY BELONG TO WALL,
HOWEVER THE EXACT FUNCTION OF THESE STONES IS NOT