

CANAL 1976 - JUNE 23 1171

CANAL 1976

15 June
We
today
line is
the pres
the 1975
course
fragmen
A gravel
designat
with
wall of
Levels
block
associat
Level 1
The gro
The Sou
This wa
structu

15 June, 1976

1

We began excavating the southern area of the site (canal zone) today in square O'-2 (named by the NW stake). A wall line is associated with this square, although it is below the present working surface. The wall line was uncovered during the 1975 season. Pottery was in abundance in level one; coarse ware and sherds with black glaze. Roof tile fragments were noted, although they occurred infrequently. A gravel level was noted while excavating. This was designated 1A; assuming the fill of level one ^{above it} is associated with this level. A stone block protrudes from the East wall of the square, and is imbedded in the "pavement." Levels of the floor have been taken and dimensions of the stone block noted. A level Report has the square and the features associated within it sketched in to scale. (Level Report O'-2, Level 1 and Level Report O'-2, 1-A)

75.5 P

76.6 P

The gravel floor was removed except for a line running along the southern perimeter of the square projecting into it $\frac{1}{2}$ meter. This was left to give an idea in cross-section of the construction of the floor.

76.9P 3,
A large base (painted - black glaze) was found directly beneath the floor; it was classified as a find. This sherd, being in association with the floor, may be an aid in dating the floor. It should be noted that the SE stake, P¹-3, is our arbitrary datum (0) elevation. All elevations and notes will be relative to this stake unless otherwise noted.

At the edge of the current square to the north, above the wall line below is a tile fall. This is interesting for a number of reasons - it is directly below the pavement surface; it is approximately on top of the lower wall line (a little SE of the wall, hence inside the structure); and some of the tiles appear to be archaic (yellowish clay). Black glazed pottery is associated with this group. These artifacts may aid in dating this structure. The black-glazed pottery was collected and bagged separately.

June 3

5

We continued excavation in square 0'-2, removing the southern part of the square. A fieldstone wall, running c. EW below the present working surface. Two cross walls, running c. NS, intersect the longitudinal wall at right angles. This area was excavated in 1975; the wall extends under the baulk we are currently removing. I have designated this wall as FS1 (fieldstone wall one).

The "pavement" (IA) noted at the bottom of level 1 was removed, leaving a block baulk 1/2 meter wide along the southern face of the square. Some interesting features were noted. A concentration of pottery and tiles was found in the northern area of the square. Black glazed cups ^(fragments) were collected separately. A small pedestal containing a conglomerate block fragment was left remaining immediately NW of this concentration. Coarseware and tiles were noted in this concentration also. 76.8P

A large black ^{coarse ware} glaze pot base was found directly below the pavement surface in the SW sector of the square. This was collected as a Find, and mapped in on the level report. 76.9P

Two large fieldstones were noted in the south-central area of the square; 2 complete tegulae lie directly west of this.

[Consult level report 1A for a scale-drawing] ~~and~~ JUNE 3 (CONT)
extends c. 30 cm below surface. (Stake P'3 is the permanent 0 elevation for the southern sector of the site.) A 1/2 meter bank was left along the southern wall of the square at the level of the pavement. The tiles found in this square vary in color; a yellow-green fabric was noted, possibly indicating archaic tiles. A sherd (ceramic) containing numerous punctations was found in the east-central portion of the square. A large conglomerate block projects into the square from the eastern face. The block is imbedded in this pavement, indicating association with this occupation level.

Level one - A
76.16P
76.18P
76.19T

Level two was somewhat different in soil type and artifact material. The soil was Munsell color 2.5y 4/2 - dark grayish brown, with streaks of rust color, probably from seepage. The soil is very clayey.

This level begins immediately below the gravel pavement (1A) and is 2 horizons - a gravel fill and a clayey soil fill. Artifacts were found directly above and below the gravel lens but not in it; the clay horizon was rich in artifact material.
76.20P

Black-glaze pottery, coarse ware and tiles were noted. The majority of 2 pots were collected - one concentration near the east wall; the other approximately in the west-central area of the square. These concentrations were found on the floor of level 2. Roof tiles were scattered sporadically throughout.

Fieldstones appeared in the eastern sector of the square, continuing under the wall of the adjoining square O'-3. These stones may be associated with FS1, but ~~are~~ they are not on line with FS1, and are higher. This wall line is designated FS2 until its association with the rest of the architectural features (FS1 and crosswalls) can be discerned.

2 daemonic cover tiles were exposed in the faces of the southern wall. These are red clay, and altho broken, are in almost complete form. These will be left in situ to see if they can aid in determining the relationships of levels.

Other pottery clusters - black-glaze sherds south of FS1, approx. central in the square, tiles near the east face of O'-2, south of FS2 (in the same concentration as the first ceramic cluster described above). These concentrations were collected separately to aid in reconstruction in the lab.

1) 76.24P

2) 76.25P

76.26P

76.38P

76.39P

76.40P

76.41P

76.42P

76.43P

76.45P

76.46P

Note: 76.38-46P
were removed from
bank S of FS1,
level 1A, 2,
(under tile fall below
pavement)

76.22P

76.23P

76.27P

76.29P

76.28P

76.36P (FS2)

Level 3 was begun, and extended west into square 0'-1 June 4
about 3 meters. A floor was found at the bottom of Level 3 - a floor made of river gravel. Artifacts occur on top of the floor. The removal of level three shows clearly the relationship of walls, crosswalls, etc. FS1 and FS2 are the same wall, the stones falling outward when the structure collapsed. A cross wall was found south of the fieldstone wall (now called FS1). This divides the structure into 4 rooms - the SW room is designated alpha, SE Beta, NW gamma, -BETA NE Delta. Pottery was found in large numbers. Clusters of pottery occurred and were collected separately when possible, but the amount at times prohibited separation into separate units. Coarse ware predominates, but black glaze (cups?) are abundant also. Roofing tiles occur in small fragments, and are pale yellow to light orange mainly. The fabric and color seem to indicate archaic tiles; this will have to be verified. It is possible that level 2 and level 3 are all one occupation level; they seem to grade into each other stratigraphically and context-wise. However, this is not verified.

ROOM ALPHA
76.53P
76.54P

BETA
76.56P
76.57P
76.58P
76.59P
76.60P
76.61P

June 4

B

A large amount of charcoal occurs at the bottom of level 2 and continues into level 3 (0'-2) (greater amounts in level 3). It is confined to room Beta, and was noted first along the crosswall, altho it extends into the center of the room, south and east. However, neither the pottery nor wall-stones appear burned.

The floor pavement is confined to the western rooms; beta and delta do not have pavement. This could be due to washing^{out} or settling of the pavement in these rooms; or possibly the junction of the room didn't demand a pavement and hence merely had a dirt floor. (Artifacts are bagged separately from each room - functional usage may be determined from content.)

The cross wall (crossing FS1) extends south c. 60 cm, and does not continue in this excavation unit. FS1 extends E into the eastern wall of the square 0'-2. In this eastern face a terra-cotta figure was found. It was boxed separately. 76.347
Pedestals from levels 1A and 2 were removed also, clearing the entire unit 0'-2 and the western portion of 0'-1 to level 3.

It should be noted that the pavement of level 3 may pass under FS1. We don't have the entire structure exposed,

14

only one longitudinal wall (FS 1) and 2 cross walls. The pavement had polley above it, polley extends down into next level in room Beta. However, it is so wet (due to seepage) that excavation below this level (31), this year will be impossible.

In O'-1 in N.W. corner, is a soft stone architectural block peering out of the unexcavated boulders. This may confirm this structure as sanctuary or may tie in with one of the wall lines. Removal of all O'-1 down to level 3 will shed more light on this.

O'-3

O'-3

June 10

17

↑ N

Batutta 1, 2

0'-3

0'-4

Tiles

Found
in
abundance
here.

CONGLOMERATE
BLOCK

Began working in 0'-3 in the canal zone this morning. We left a 1m. baulk between 0'-2 and 0'-3, which will be removed later. We took out level one, hoping to come to the pavement of level 1A found in 0'-2. However, we haven't reached it yet.

Level one was predominantly slope wash. 76.123P Roof tile fragments, coarse ware and black-glaze pottery were found. A number of 76.127P Finds were recovered: A bronze bar, 6cm by 9mm, 2 circular loom weights of clay; 76.124T a statuette head; a sherd with paint - 76.125T

76.130P ~~black~~ figure? Some grey glazed pottery was found also. The tegulae seem to have consisted of flat (Corinthian) pan tiles and curved (Lacanian) cover tiles - both types were noted. The fabric is a mixture of red and yellow clays, the yellow tiles having a pinkish surface.

A large conglomerate block was found in the southern wall of the square, extending NE into the square. This block may be associated with the one protruding from the eastern face of square 0'-2. They both are conglomerate blocks, probably not

associated with the fieldstone wall of level 3 of 0'-2. However, the block just found in 0'-3 may be associated with level 1A. An area along the western edge of the square contains roofing tiles and 2 large fieldstones. It has been photographed, but did not seem to indicate that it represented an occupational surface.

An interesting tile fragment(?) was found, bearing an egg and dart design on the flat side. It is doubtful if this is a roof tile; the flat side wouldn't show! This may be part of a sima or associated with artefixes.

76.126P

Large blocks appeared in the floor of Batutta 2, near the northern wall of the square. This may be the top of a wall line. Tomorrow will tell!

June 10 (cont)

19.

We finished Batutta 2 of 0'-3 and began Batutta 3. All material is being combined in the lab, but is being excavated as 3 separate parts. No elevations have been taken yet.

June 11

A statuette fragment (head) was found in the NE area of the square, #6.137T in Batutta 2. Black glaze pottery, coarse ware are abundant to go, as 139T are roofing tiles. Again curved and flat tiles were noted. The colors vary - a deep yellow, friable; a paler yellow of harder consistency; reds from deep to orange were noted. Most pieces were very small, as if cracked from burning. No charcoal has been noted. However, a dark area immediately east of the conglomerate block in the south wall had a burned look to it. It is possible this area burned, but this hypothesis has not been verified.

The wall line noticed yesterday was exposed more today. It is on axis with the conglomerate block in the south wall but doesn't completely attach to it - stones are missing or at least, have not yet been exposed.

Note - Previous week's work was predominantly excavating tombs at San Salvatore. June 21 is the first day back in the canal area.

June 21

We are again in 0'-3. Work ended with Level 1, Bat. 3. Level 2 begins today, and extends from the top of the wall line down. Elevations were taken but have not yet been tied in. The material collected from the area west of the NS wall (called NS conglomerate wall) was kept separate from the eastern side of the wall. We hope to be able to determine functional usage of the rooms by this procedure. West of the wall the soil is Munsell 2.5Y 4/2, the east 10YR 3/1. E-76.173 W-76.172

The NS conglomerate wall line does not connect with the southern conglomerate block, altho it is on axis with it. However, tiles and field stones are found in between (S of the NS wall), and indicate an EW

June 21

21

wall, possibly an extension of FS1 found in 0'-2.

Breccia was noted along the western edge of the NS Conglomerate wall, extending out (west) c. 50 cm. Sandy clay appears west of this. Artifacts noted in the western area - black-glaze cups, coarseware pottery, roofing tiles. Black glaze seems to be a fine ware - probably Attic; and a more poorly constructed ware - possibly locally manufactured.

Some charcoal occurs in the western area, especially to the south near the cross-wall. L. 3
E-76.175P
76.190P

Note - The tiles and stones are slightly higher than the wall (EW wall).

The wall line signifies 2 things - the division of this area into 4 collection areas, and the beginning of Level 3. The Cross-wall transects the square into 4 unequal-sized rooms. 200P
NW-76.178
76.177P
76.184P
199P

The SW room contained much pottery - black glaze and coarseware again. A large vase fragment was collected separately. The soil was very wet (due to seepage from the canal) and very clayey. 76.176P
196P
187P

The NE room was of similar soil. Artifacts collected were - the torso of an archaic figurine, part of a large plate, a cut-stone brick. 76.198T

Immediately N of the EW crosswall (FS1) is the remnant of a parallel wall line. It is c. 50 cm long and at approximately the same elevation as the complete crosswall. NW
76.192P
191P

Pottery was collected immediately south of the EW crosswall, in between the conglomerate block and the EW crosswall. 76.193P

In the NE room a floor of gravel was noted. This marks the bottom of level 3. Charcoal was noted and collected from the fill on top of this floor and also from directly on the floor. The pavement doesn't cover the entire square; just the NE room. Pottery deposits mark the bottom of level 3. These lots were collected separately when possible. 76.179SS
76.180P
76.181P
76.184P
76.186P

A large plate was collected from immediately N of the NS conglomerate

wall, as a find. The plate was at about the level of the pavement 192 T ²³
of L. 3; in fact imbedded in it - so it isn't classified as either 191 T
L. 3 or L. 4. JUNE 22

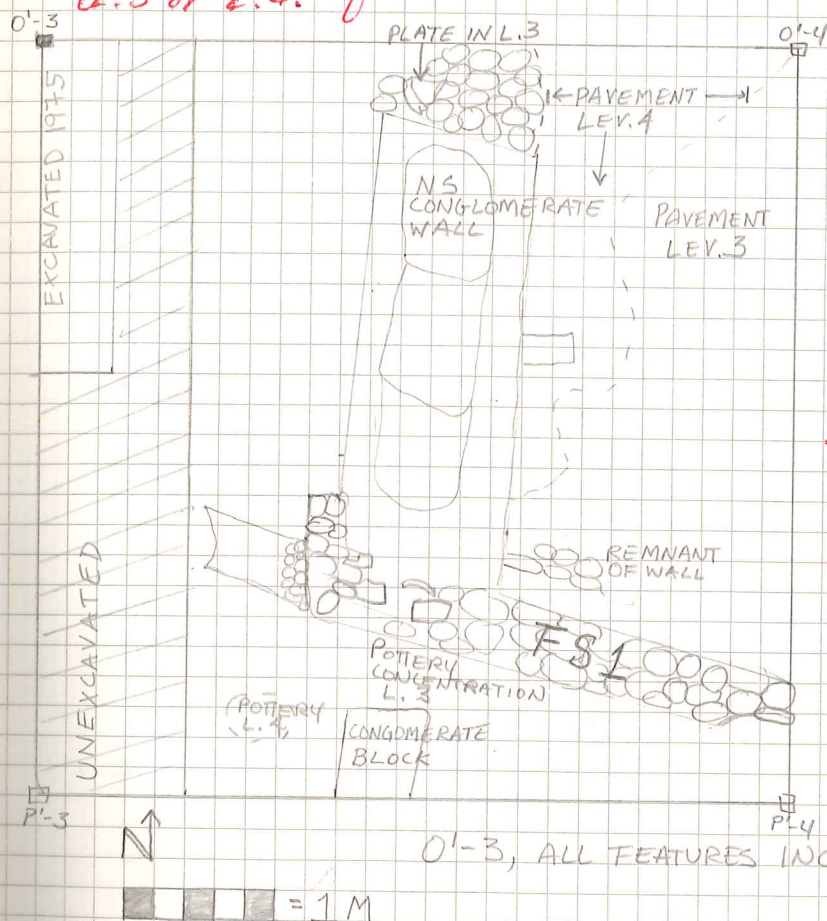

LEVEL 4

L. 4 begins in the west part of the square at the level immediately beneath the pottery concentrations (-56 cm below level of P-3, the 0 stake). In the east, it begins immediately below the pavement floor. Artifacts were collected from the floor of L. 3 separately.

L. 4 ends at -67 cm below surface (P-3) in the SW and SE. It is marked by another pavement, of smaller stones in the SE. No pavement has been noted in the western area.

Artifacts appear on the floor of L. 4, and also were collected separately. These are mainly small votive pot and cup bases, but other types occur also. (6th cent)

Charcoal was collected from the pavement of L. 4.

Part of the western area was taken down another batutta (L. 5) to determine if another floor or living surface existed. Artifact material was scant, indicating that L. 3 and L. 4 were the actual living surfaces.

Find #4 Finds: Left breast of figurine S. of FS wall (in L. 3, below level of wall.

SW Room
76.187 P
76.188 P
NE
76.186
76.186

76.189
76.209

23 JUNE

25

Working in both N'-1 and P'-1 today. N'-1 was partially excavated in 1975, exposing a NS Fieldstone wall. Level 1 was removed completely, to bring entire square to level 2 (even with wall line). Not much material recovered. Soil was dark, gravelly, plow zone, churned material. AN EW wall of large blocks was uncovered, intersecting the NS wall line. Level 2 begins at the level of the EW wall line. 219P
76-227SS
76-226SS 221P

24 JUNE

Level 2 in N'-1 begins at the top of the EW wall line. A possible wall line appears North of this wall, also running EW. Both intersect the NS wall. The NS wall extends into O'-1 and seems to continue (in intervals) into P'-1. Level 2 goes down to the bottom of the large architectural block at the NE corner of O'-1. This block sits almost on the pebble pavement seen in O'-1.

Level 3 begins at the bottom of the architectural block in O'-1 and extends down to the pavement.

June 22

O'-3 in NE corner at level of stone pavement

FIND small white vase

South of E-W stone wall and east of NS Conglomerate wall at the level of the wall, the left breast of a white figure of the early type.

FIND left breast of early type white figurine south of EW field stone wall in level 3. And east of NS Conglomerate wall. That is below the level of the field stone wall.

0'-3 June 22

N.B. Large deposit of pottery removed from south 27
of EW field stone wall and west NS conglomerate
kinder. Includes Be Cup and Anglized plate into
kinder. Bagged separately.

N.B. Deposit of pottery south of EW field stone wall and
under tile full at point where NS conglomerate wall
passes over field stone wall.

0'-3
FIND Attr. (?) to north of EW field stone wall, and
west of NS conglomerate wall, below level of field
stone wall.

0'-3
NB Considerable amounts of charred wood
Sample taken Both 0'-2, 0'-3 have lots of
76. 20755

Level 4 -

The next battuta begins at the level of the bottom
of the deposit of pottery found next to the EW stone
wall. The deposit is ca. 10-20 cm thick.

Level 3 and level 4 may overlap, as the slope of the
ground is uneven, rising toward the wall. Another
deposit begins in SW corner of 0'-3

0'-1 level 2 (second large battuta)
in grey clay, well below level of NS wall (Note the
large plate found yesterday was on a level with the
top of this wall of
FIND Fragment of a statuette

NB, Large deposit of pottery removed from south
(over)

28.

of EW wall (of field stone) and west of NS
conglomerate wall. It includes ~~34~~ cups and
unglazed plate with handle. Bagged separately

N.B. Deposit of pottery south of EW field
stone wall and under tile floor at point where
NS conglomerate wall passes over field stone wall.

June 25 Square N'1
Level 1 - see p. 47

Jack

6/21/76

Exc

Level a

40 cm

REPORT

COARSE

6/24/76

PAVEME

SQUARE

DEFINED

~~SCALE A~~

SIDE OF

the EAST

FOUND.

7/1/76

FIFT

SOIL IS

TO YELL

IS A SO

Jack B. Irion

29.

6/21/76

Excavation was begun at LEVEL 1 of square O'-1. In the first level a heavy terra cotta plate was unearthed which was approx. 40 cm in dia. near the center of the square. (SEE GENERAL REPORT FORM FOR THIS SQUARE) LEVEL CHARACTERISED BY HEAVY COARSE WARE.

6/24/76

SQUARE P'-1, LEVEL 3

PAVEMENT AT THIS LEVEL IN O'-1 DOES NOT CONTINUE INTO THIS SQUARE. ON THE WEST SIDE OF THE DRAINAGE CANAL IS AN AREA DEFINED BY 2 N-S WALLS AND 1 E-W WALL. ONE ~~OF THIS WALL~~ ^{N-S WALL} ~~SCARCE AMOUNT~~ EXTENDS FROM O'-1 TO P'-1 ON THE WEST SIDE OF THIS WALL SCARCE AMOUNTS OF COARSE WARE WERE FOUND, ON THE EAST SIDE FINER BLACK GLAZED WARE, INCLUDING A CUP WERE FOUND.

7/1/76

NORTH-SOUTH TRENCH, west extension, south side (L'-2)

FIFTH BATUTA, LEVEL 2 (LEVEL 2 DESIGNATED FROM 5th & 6th BATUTA)

SOIL IS LIGHT GRAY 2.5 y 7/2 IN THIS LEVEL AS OPPOSED TO TO YELLOW CLAY IN THE UPPER STRATA. THE PURPOSE OF THIS TRENCH IS A SOUNDING IN DEPTH TO PICK UP WALLS FOUND IN 1975 AND

DETERMINE ASSOCIATION TO CONGLOMERATE IN NORTH SIDE.

31

MATERIAL: FOURTH CENTURY POTTERY, FRAGMENTS OF HEAVY STORAGE AND COOKING WARE.

FINDS - 1 RED FIGURE FRAGMENT

IN BATUTA 6 MORE TILE FRAGMENTS AND ROUND STONES WERE UNCOVERED ADJACENT TO THE CONGLOMERATE WALL AND APPARENTLY PARALLEL TO IT.

THIS CONGLOMERATE WALL PROVED TO BE NO WALL AT ALL BUT A THIN LAYER OF PEBBLES WITH SOIL UNDERNEATH. THE WORKMEN REMOVED THE FEATURE IN THE COURSE OF BEGINNING BATUTA 7.

BATUTA 7

MATERIAL: BONE, COARSE WARE, 1 FRAG. OF GLASS (BAGGED SEPARATELY)

BATUTA 8. WORKMEN COME DOWN ON A PEBBLE LAYER. A PORTION OF THIS WAS LEFT UNTOUCHED FOR PHOTOGRAPHING WHILE THE REST OF THE TRENCH CONTINUES TO BE EXCAVATED.

IN BATUTA 9 THERE IS NO CHANGE IN SOIL

FIND: 1 RED FIGURE SHERD.

ALL MATERIAL RECOVERED FROM THIS BATUTA WAS FOUND IN THE SANDY GRAYISH BROWN SOIL, WHILE THE YELLOW CLAY WAS VIRGIN OF MATERIAL. ARTIFACTS DATE FROM 6th c BC TO 1st c BC (including frag. of RED FIGURE) IT IS FELT THAT THE SANDY AREA REPRESENTS A ROBBED WALL IN TO THE AREA OF WHICH DEBRIS FROM THE SUCCEEDING CENTURIES COLLECTED. THE PROBLEM WITH THIS, HOWEVER IS THAT ARCHAIC ~~TRADITIONAL~~ BRICKS ARE NOT KNOWN TO USE DRESSED STONE.

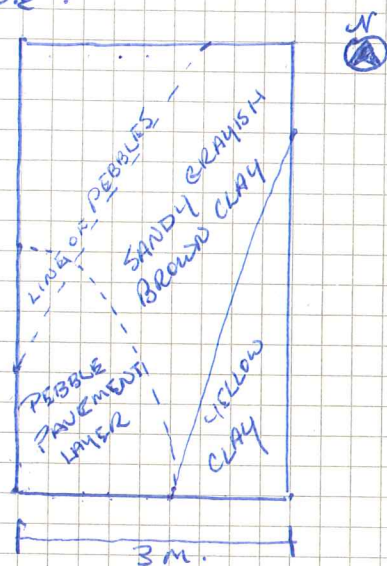

JULY 2/1976 N-S TRENCH, N-W QUADRANT, 2ND LEVEL (K'-2)

3RD BATTUTA (JUST NORTH OF AREA EXCAVATED YESTERDAY)

MATERIAL IS MOSTLY COARSE WARE FRAGMENTS AND ANIMAL BONE
ONE FRAGMENT OF GLASS FOUND IN BATTUTA 6

BATTUTA 7 SHOWS MIXTURE OF ROMAN GREY GLAZE AND BLACK GLAZE
(4th c. BC) THIS MATERIAL HAS COME FROM NE CORNER OF TRENCH.

AT BATTUTA 8, 2 stones, one large and rectangular, one smaller
were found in association with one another. They were known
to exist from yesterday's section but at this level their dimensions
were made clear.

JULY 5, 1976

Continuing in N-S TRENCH. At this point the north-south
trench is in 3 levels. The south side is in battuta 9,
approx a meter wide strip in the center is at B. 8 and
the north end is at B 7. Work begins with the stripping
of these levels to that of the stones. At this point all
the material seems to be coming from the eastern side.
Round stones appear in the NW corner. Material: Coarse ware
gray glaze, Terra Sigillata, etc

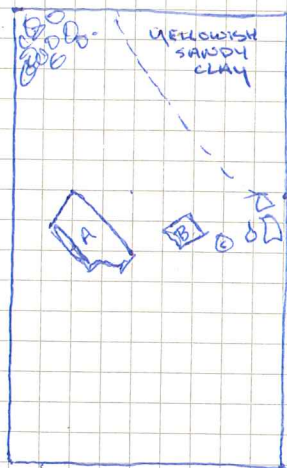

NORTH-SOUTH TRENCH (K-2)

BATUTAT

STONE A - triglyph

STONE C - MILL STONE?

STONE C

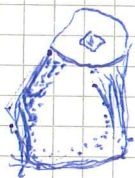

MUCH material comes from the eastern side of the trench
 Terra Sigillata, Gray glaze, an immense number of broken
 tiles. Some of these appear to be roof tiles 
 A small amount of black glaze, some cutting. Large amount
 of material at this level.

Battuta 9 material: one fairly complete amphora neck and handle ³⁹
one architectural fragment (statue base?) one lamp fragment.
Following the removal of Battuta 9 it was decided to excavate
a 2 meters wide deep sounding along the east wall to
discover the extent of the cultural fill.

At Battuta ~~9~~⁹⁻¹⁰, there is a change in soil color from dark
grayish brown to light yellow-brown sandy clay grading
into greenish yellow clay ^{on} east side of ~~trench~~ trench
north of trglyph

Battuta 11 characterized by yellow-brown sandy clay. On top
of this is a burned layer with small carbon fragments.
Some pot sherds show evidence of burning on the exterior.
This layer shows a sharp decrease in the amount of
cultural material and its presence here at all may be due
to subsidence from higher levels.

NOTE - SECTION DRAWN OF NORTH END OF TRENCH.

July 6 / 1976

Work begins with the lowering of the north end of the N-S trench from level 2. Batuta numbers will begin with #3.

41.

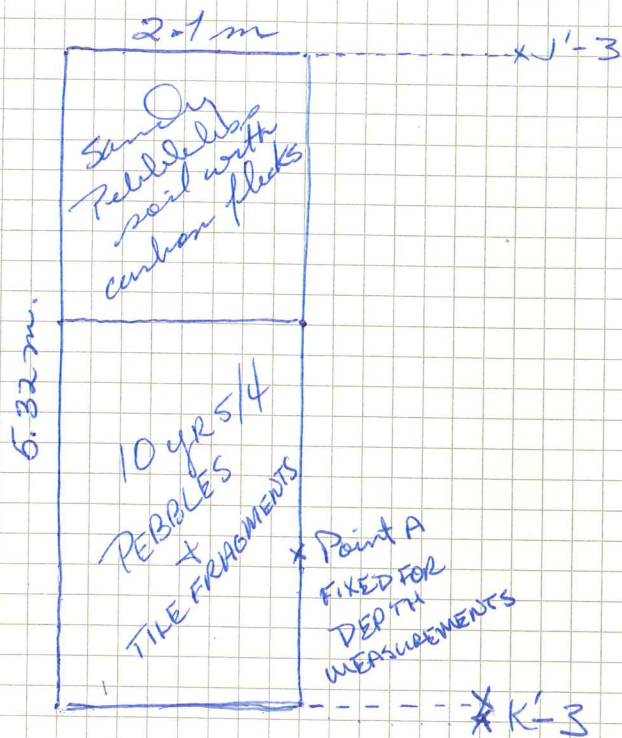

SOUTH SIDE SOIL COLOUR 10YR 5/4 yellowish brown.

lots of rocks, especially compacted towards south end approx 25 cm below surface (point a)

North side pebbleless sandy clay soil becoming more yellowish 10YR 5/6 charred material in soil (approx. 33 cm below point a)

Battuta 4, level 2 N-S trench

43.

South side - soil color remains essentially the same, slightly less gravel approx 50 cm below surface level.

North side - soil is essentially the same color; no pebbles
veins of reddish brown and carbon frag.

finds include a bronze ring (horse bit?) About 1/2 meter from north end ~~road~~ section soil grades into 2.5y 6/16 olive yellow. A number of tile frags. appear in this zone
Depth - 59 cm.

Battuta 5, level 2 N-S trench

South side - large no. of rounded stones and tile fragments, soil color unchanged. Gray glaze, black glaze and coarse ware fragments. ~~Soil~~ Soil is lighter in color at south edge of trench
Depth - 69 cm.

North side - burned frags. in 10yr 5/4 clay extends into south side, where the pebble layer recedes southward olive yellow clay also extends further south and contains larger carbon bits. a sample of this was taken as well as a soil sample of the three types of soils.

76-40755

76-41055

BATUTA 4

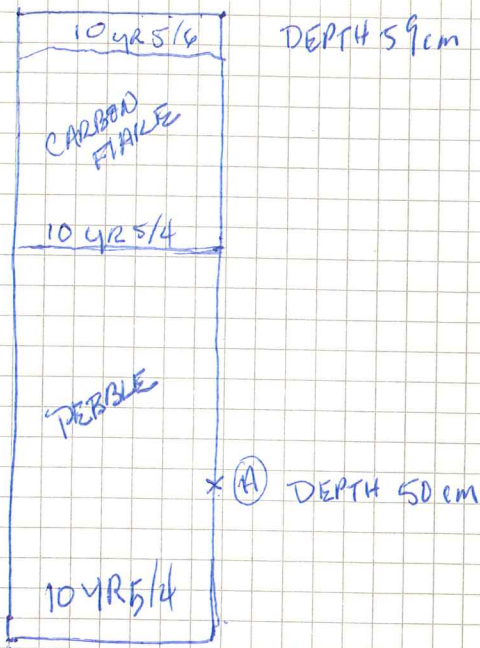

BATUTA 5



45.

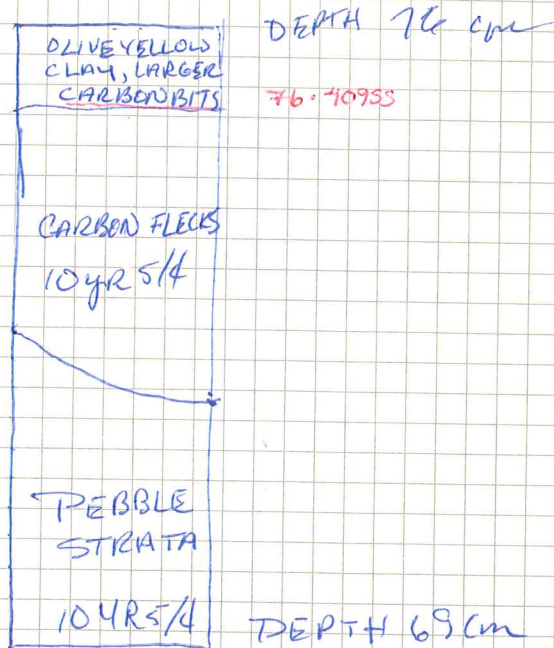

Batuta 6 South Side - PEBBLE LAYER CONTINUES TO DECREASE in WIDTH, DEPTH of LEVEL is 83 cm.

North Side OLIVE YELLOW CLAY EXTENDS FARTHER SOUTH, BROWN SANDY CLAY WITH CARBON FLECKS has yielded most of gray glaze material in all levels. The slope of the three levels is evident on the trench section. Out of olive yellow clay level a Greek black glaze frag. was excavated. Depth - 83 cm

June 25 N' 1

level 1 - down to fall of tile and
stones which covers only the western half
of the trench and appears to extend to N, S, W.

level 1A - tile and rock fall and
immediately below material, Greek 4th
Century B.C.

level 2 - Eastern half of trench only. Grey clay
with some material

June 28

Long NS trench which extends from S. 6 to S. 5 N.
It is centered on the W. edge of conglomerate
block (north of S 5 N) discovered by pala on
Friday and is three meters wide. This
centerline corresponds to N-S axis and
falls approximately in squares R, R, S.

Level 1 - around conglomerate block, at level
of the tile wall to east and, below a yellow
brown, clay with stones, some material.

FIND BF fragment, just to N of the wall.

To South of conglomerate block, extensive tile and
rock fall. Type 7 tile in wall next to conglomerate
block suggests that wall Sigma may reach up
with this level 1 is all that above the tile
fall, with of conglomerate block patch of
white clay appears. Material all coarse ware.
level 1 is just balluta here.

About 30 1/2 meters south of north wall
of S. 6 a rubble "wall" running in E-W direction.
Level 1 is above level of "wall". Lots of tiles in
small fragments.

Level 2 - Below level of rubble wall. Material
N.B. Grey glazed base. Aretine

NS Trench, widened by 3 meters

5. South half
 2nd battuta - 3rd fail to uncover the western extension of the E-W conglomerate wall. N. extension of Trench does not appear to continue into NS Trench.

3rd battuta takes us 15-20 cms below level of tile and stone fall at the corner of conglomerate and stone wall (which also uses levels of tiles). The soil is yellowish brown, compact, and contains little material. It is still considered level 1 in view of the fact that we have not picked up the wall. Perhaps 3rd battuta should be considered 1A as it will be below the level of the fall, but too late now, and material is sparse.

North half (division between North and South comes about 1 meter North of conglomerate wall).

2nd battuta reveals that the wall of stone and tile is really a compact layer measuring 2 x 2.5 meters and located in original 3 meter wide NS trench, but not in west extension. Material from level 1 is largely coarse ware.

Level 2 is taken to be that below the level of compact layer and contains large fragments of grey-glazed and Argentine patches of almost white clay on east side of the long NS trench about 2 meters south of compact layer of tile and stone, looks like varje. This is level 1.

N wall S6

53.

to clay pit



from NS to West
layers approx 2m

S wall
S.6

NS to
West

Compact
layer of
sand

and stones

2 x 2.5m

long
NS to

Scale 2cm = 1 meter

June 30

55.

NS to. end West.
Level 1 3rd battuta

FIND: Just not a line EW of conglomerate and stone wall, but West of visible blocks — TC band "proxitelem" material. mostly coarse, but some Greek material

NS to. West extension

North half. Level 2
in West (3 meters) A NS trench at some point where south face of the tile and rock compacted level found in NS to (original 3 meters) is a level of gravel. no material.

Level 2 to the North, the gravel (which stops about where the compacted layer peters out to north. Much material, including porcelain, Grey glaze, lumps of iron, charred wood. Important sample taken.

NS to. (original)

North half.
Level 2 to south of compacted level of stones and bricks. An area where much fine pottery appears. Area measures approx $2\frac{1}{2}$ m in EW direction, and 2 meters in NS. Soil is grey brown.

At South edge of crean Alpha (NS Tr. east, north half) a fragmentary amphora found, (sprung in) soil fragment collected left in place for photo. A level 2 patch of white clay - (vergen?) noted above. NSTr. West ext.

Level 4
North end
halfway between conglomerate wall and compact layer of tile and brick contains little material. Seems to be part of the same pavement of a road. Could be part of the same stratum as the compacted layer (though tiles are very scarce) which was just at lower level in West extension of NSTr.

NSTr. and West ext.
Level 2
North end a cut parallel to the N wall of S. 6 and parallel to it, wide 2 meters or so. Earth is reddish brown and sandy. Sweeping reveals a long strip of burned wood (samples taken earlier) which lies in a roughly E-W sense. Its west end is to the north. Dimensions are roughly 4 m long, 20 cm wide. It appears to disappear under the compacted layer of rock and tile in NSTr. east.

The area of NSTr. south of compacted layer called Alpha has gravel also. The gravel seems to be associated with Roman material and to divide the cut in S. 6 from area to the South.

The trace of beam of carbonized wood found in Beta 80 down to a level of yellow clay, which

suggests that it was burned at the time the
clay pit ceased to be used as a clay pit.

59.

July 2

61.

N'1

Reopen trench in level of clay under tile fall
in west half of trench. This is Level 2. Level 1A
was the tile fall and immediately below material
appears to be 4th cut soil here is harder, but less friable, the same
level 2 in N'1 soil from the level of the tile
fall immediately below to the level of the
the E-W conglomerate wall in SE corner of the trench
cut the brick "wall" on the NE edge.
Level 2 in N'1 - photographed after cleaning up
in NE section Level 2A ¹ beneath the level of gravel,
at the same level and just

76-318ss

76-328p

July 5

0' → Level 1 begins with the plane of the
bulldozer cut of tile. Greyish Brown Clay, many fragments

FIND coin, bronze, badly corroded.

Level 1, 2 batt - small fall of tiles appears in
N center, angle of wall in SW corner, the NW corner
of a room?

Level 1 batt 3

NB several fragments of statuettes
FIND: head of a statuette

at the bottom of Unit 3, in N half appear the
 tops of large stones. Some appear to be "pudding"
 Level 2 - NW corner, strip of breccia with material
 immediately under.

July 6 Susan Andrews supervises a.m. see page
 p.m.

0'4 level 2, Unit 2 - We are now at the
 level of the field stone pavement of 0'-3, but field
 stones extend only about a meter in 0'-4, but field
 should be then the equivalent of level 3 in 0'-3
 material. Archaic pebbles resting on a layer
 of clay. Above the field stones pavement in east sector
 of square is a collection of plates. These were
 discovered in morning at bottom of level 2, Unit 1
 (probably). They will be collected in a separate box.
 These plates are located at - 30 cm below level 2
 conglomerate walls in 0'-3. The top of the plates
 is about 10 cm above field stone pavement. The
 stone wall in south west corner of 0'-4 is much
 higher than conglomerate wall, and approximately
 on a level with tile fall in N half of trench.
 There are several collections of field stones in N
 half of trench to west, which appear to have belonged
 to a wall. This wall may have been a north
 extension of the long EW field stone wall found in 0'-3,
 etc.

0'-2, South, P'-2 North Banks, clearly
 Level 1A

0'-2 S, P'-2 N bauls
level 2, 1 batt (Raffaele working alone)

level 2 stems slightly to the west of the line of the NW field stone wall which intersects the long EW fieldstone wall in 0'-2. Conglomerate blocks also. These are slightly above the level of the tiles which appear in the S. face of 0'-2. This corresponds to the level of gravel at bottom of conglomerate block in east wall of 0'-2.

0'-4, level 2, batt 2

There is a part at the bottom of this level when the grey clay pulls away from the clay which has more sand in it. The material which is a mix of archaic and fourth cen. The archaic appears to come mostly from the sandy levels and is pulled out with the grey.

Level 3 - the next battata should be clearer. The pits, if should be noted are entirely in the non sandy grey clay. The sandy level begins about the level of the field stone pavement, or slightly below.

July 7

NS Tr. Narrow sounding North sector begun
 July 6. Works left off. North part of 7 batt in
 N end unexcavated. North end is the section
 of the trench to the north of the cut noted much
 earlier, which lies slightly to the north of the
 S6 bulldozer cut. In this area, the soil is
 changing from soft sandy brown & yellow clay
 with gravel. Material grey gneiss & large orange
 ware, iron fragments.

O:4 Level 2, batt 2

Works left off on July 6 with a small amount
 of this level in east end of trench yet to be excavated

NS Tr. "South End" (see notes July 6) Soil here changes to soft brown
 seen earlier to north. At the south end of the South end soil is grey and gravelly.
 It is the lower edge of distinct level of gravel and tiles which can be noted
 in the EAST wall of the trench

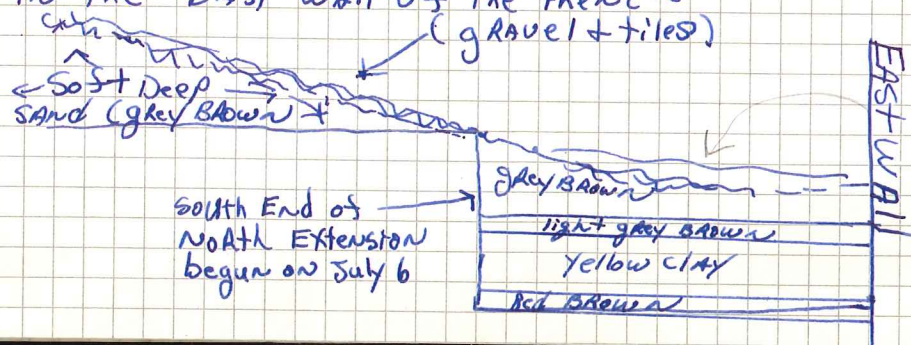

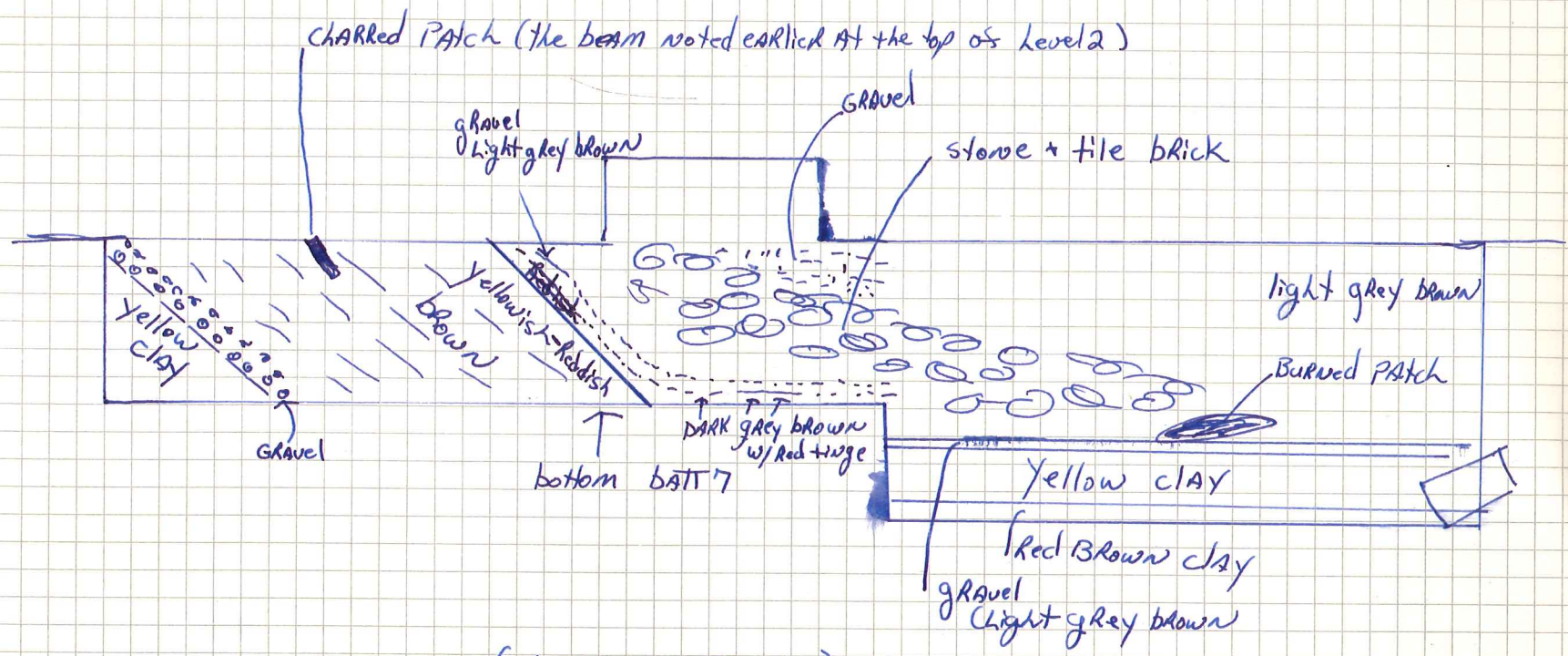

(NOT TO SCALE)

BAULK O'-2, P'-2

Level 2, 2 batt

begun July second; continued; this is below the level of the pebble and fieldstone surface, described yesterday. We wish to define this mass to see if it is in fact the continuation of the N.S. wall.

At the bottom of this battuta appears a level of large field stones, perhaps, a continuation of pavement in O'-2

N.S. Trench N End

Battuta 8 the level of grey with stones is thin, the yellow clay reappears

July 7

O'-4 Levels

Soil is sandy occasional fieldstones material ARCHAIC - At bottom, the pavement of fine field stones (found in O'-3) At the west end of the trench we succeed in isolating level of ARCHAIC material

Segment of stone wall in north face N trench which continues to north. Rests on level of small stones like the ones discovered

73
in O-3, under it is the layer of sand; and under the sand, a layer of clay. All the material which comes from the construction of sand and clay is ARCHAIC we have been calling the material "O-4 level 3 batt 1" Below the piece of pavement on which the fieldstone wall rests is another pavement of tiny stones, like that found in east half of O-4 earlier this morning. The level of this tiny stone pavement (found also in the immediate vicinity of the field stone wall) is the same as that of the clay under the sand described just above. Di TARANTO thinks there is also a little clay above the level of the pavement. The tiny stone pavement is thus the ARCHAIC floor, of which little is left because (perhaps) the area was very much disturbed when the pavement and wall above were put down. Material of 4th Cent B.C. is found above the small stone pavement on which the wall rests.

Theory of three levels of pavement seems to be confirmed by excavation in Eastern part of O-4. There is pavement of large fieldstones AS in O-3 under this, near north wall of trench is pavement of smaller stones AS in O-3. Even farther down is level of tiny stones. The distance separating all three pavements is perhaps 4-5 cms in each case.

N.S. Trench S. End
batt 10

75

Find: head of terra cotta duck white glaze.

TAKE sample of burned wood from face of virgin clay. This should help to date the first filling of the clay pit. It is considerably below the level of the burned beam; of which the samples were taken. A meter below in the vertical sense in terms of stratigraphy, below the level of the "beam" which angles deep, southward is to the ground going 40 below the surface from which the samples were taken. There is a layer of brown soil, a thin layer of yellow, a layer of brown. This brings us down to the face of the cut. It can all be seen in the east face of the cut. The stratigraphy in the west differ. There is a more or less uniform layer of reddish brown soil down to a layer of greyish soil with tiles in it. Then the face of the cut comes next. The charred wood sample was taken from this greyish layer. but some yellow clay mixed with it. There are also some hunks of iron with charred wood

July 8

77

N.S. Trench

Finish 12 BATT in South end (N. End virgin clay for several batt.)

Soil is sandy grey brown. With the 13th BATT the level of deep sounding begun on July 5 and that of last week are even. The stratigraphy changes very sharply at the point dividing, north and south ends of North Extension. Deep sounding begun on July 5.

||| N.S. Trench 5th Batt large horizontal patches of charred wood in west wall ||| July 7th Rained out in afternoon |||

It slopes sharply following the slope of the clay deposit. Fortunately we have been dividing material at this point. So our artificial horizontal stratigraphy can be adjusted to the reality; soil color description will help.

BATT 13.

greyish clay as one approaches the clay bank, becoming yellowish to S. End

BANK 0'-2 0'-3 3 BATT

Wall discovered in BANK (1st BATT yesterday went down to level of gravel on top of conglomerate block visible in west face)

2nd BATT went below this stone pavement.

3rd BATT reaches level of lower gravel pavement

Conglomerate block appears to be isolated part of wall discovered in north 79
End of baulk

4th BATT - Down to slightly above level of field stone floors (which
Doesn't exist here. Soil is grey clay. Large squared block found under
field stone wall in north face of cut. This block rests on a layer of
gravel which is the same on which the conglomerate blocks in East
face of O-2 rests. It can be seen to extend in section in north
wall of O-3 and O-4 for their whole length.

P-3, P-4

Open a 10m long trench in EW sense, which is approx 3m wide in N.S
Sense

Level 1

BATT 1 - A grating by the bulldozer, removed by hand.

BATT 2 - Wall of stones dividing line b between P-3/P-4 it seems
to be related to the rough stone wall found in S.W. corner of O-4
Baulk O-2 / P-2

Level 3 - material from just above field stone pavement

N.S. Trench

81

BATT 14. - begins AT + triglyph. MANY loom weights; at least a dozen. A lot charred wood some ~~tiles~~ tiles (soil sample taken)

Find - nearly complete lamp

material is concentrated near the face of the clay cut. Grey clay is apparently dipping down toward cut

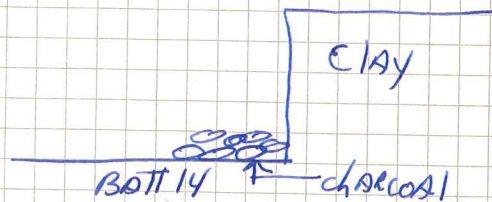
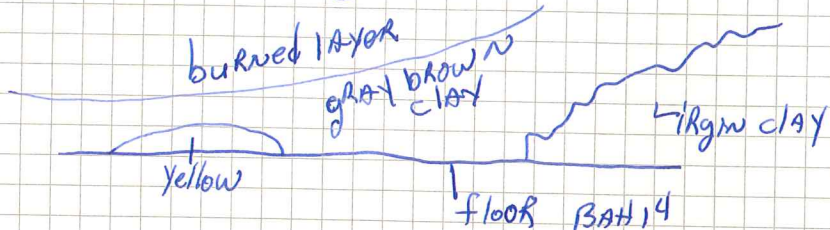

Bottom of BATT 14 - much charcoal, large chunks occurs near clay deposit in NE. corner of trench

BATT 15 - DARKER clay horizon, Rocky (gravel, although not massive, amts)

very few artifacts almost sterile to J. mostly roof tile fragments

O¹⁻³ - baulk removed in SW corner south of FS1 Black glaze and fineware, coarse ware appears.

N.S. Trench

Find - gray glaze cup complete artifacts seem to occur in IV part of trench some large field stones cut stone appears. Tiles and clay curved

marble block small (but with ~~water~~ finished edge?)

Tile mottled yellow red core w/ yellow surface curved. The soil to the E (E $\frac{1}{2}$) is very sandy. Different from the west $\frac{1}{2}$ which is clayey, DARKER. This begins 2.5m north of triglyph. Partially complete vase found in N.E. corner next to yellow Bank, found under burned area.

16th Batt Reach virgin clay virtually all over the trench, but there is an apparent ancient ditch? running from NE to SW, little material some grey glazed rims. 76-412.23

BATT 17

N1-1

Continue take down the gravel floor between two walls. South wall is the conglomerate wall, we are ^{BATT} level below the level of the top of the N1 wall. It is pure gravel with little or no material.

July 9

P1-3 Finished 2nd battuta which is level 1. Find - Head of figurine with headless

P1-4 Begin 3rd battuta grey clay, call this level 2 because it takes us below the level of the top of the wall.

Discovered yesterday in NW corner of PL4 a thick concentration of plates + cups 85 with anchor profile, we are still much higher than the level of the field stone floor in O'-3, There appears to be some large field stones under this mass.

Find. Consider the whole collection ^{of pottery} as special find. (note, profile of archaic cup mixed with large field stones in pavement in O'-3)

Correction both. Line level ascertain that we are at the level of the field stone floor in O'-3, slightly above the level of the smaller stone floor in O'-4 N. face still well above the level of the tiny stone pavement. The lower course of the field stone wall which disappears into N. wall of O'-4 is more or less at the same level. As is other fragment of field stone wall in O'-4

Note: the level of stones under the concentration of pottery seems to be expanding. If it does in fact turn out to be a field stone pavement as in O'-3 then we would be in what we call level 3 there ~~at~~ and level 2 batt 2 in O'-4

Find - head of statuette in p'-4 (batt 4) level 2

PL4 batt 3 Lev 2

Clear rest of square down to the level of the batt. The area of the archaic material had been left. A second layer under it contained a number of big plates and other archaic material including fragments

of IONIAN ~~Temp.~~ These plates must be ARCHAIC in date, not 4th cent as claimed by D'ANDRIA since all material is ARCHAIC. For this reason it is important TO KEEP the material together as a SEPARATE collection, and have it DRAWN. 87

This second layer is ALSO collected and put in a special bag. To east of rough stone wall, in P-3 A level of fine cups, also of an ARCHAIC DATE ARE DISCOVERED AT the bottom of batt 3. They extended down into what will be batt 4. The most complete cup collected in a separate bag

Find: Above field stone pavement in 0-3 - These cups and material in the deposit in P-4 just described ARE located in a layer of clay

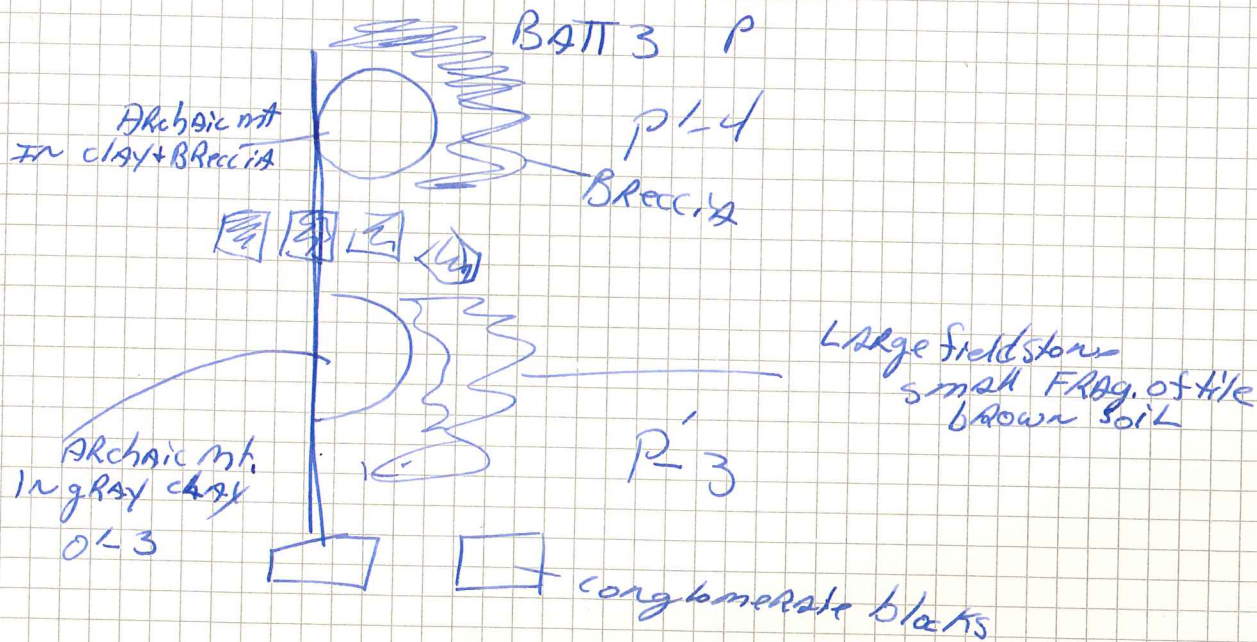

It appears that the material to the west in P¹-3 at the bottom of batt 3⁸⁹ has been dumped there. It consists largely of big fieldstones, small frags, of tile, brown soil. In the SAR west end are two lg Cong. blks.

Find: Seated Figure (T.C. Figure without head)

Find: Head of different make (T.C. fig.) Note other TC fig. FRAG.

Find: BG CANTHOS in several lg frag. Smaller pieces nearly complete.

Against southern of the two Cong. blks.

With line level determine that the top of the deposit of cup's cot in P¹-3 is even with the bottom of deposit in P¹-4. Even also with pavement of lg fieldstones and lowest courses of fragments of wall in P¹-4

P¹-3

Finish Batt 4

July 16

91

P¹-4

Begin Batt 4. Under the level of the special collection of pottery found on July 9 is a gravel layer and at some points under gravel ~~was~~ are a few tiles.

P¹-3

Go slightly below level of Batt 4 with Crowell. In area in which special collection was removed on July 9 is more archaic material; "Ionic cup", large plates, etc. Call this Batt 4A.

O¹+1, P¹, 1

Two battens and down to the tile fall which was uncovered in the western half of O¹, 1. The tile fall is very uniform in O¹, 1. Tends to peter out in P²-1, field stones mixed in, one squared stone.

Battuta 5

93

P1-3

Finds: near conglomerate blocks

where plaque found on July 9, TC figurine.
head of bearded man, small votive
more precisely between in the most
of tuted blocks of "pudding" stone in
P1-3 and testimony.

To the east of the conglomerate level is a
circular patch of dark soil with several
large field stones in it. Hearth? or
plug of st

P1-4 batt 5 only just

M-1

101

N.S. wall at highest level (rho)

composed of layers of tile over round field stone. Below the level of field stones to the west is a tile fall..... besides the field stones - at intervals are larger squared blocks. One in N.S. wall, middle and one at north end. Just east of corner there are several layers of tiles EW section of same wall (TAU) extends into

M-2

Where it turns north, this north extension is interestingly by the cut for the underground canal, a modern work. EW wall at north end of square composed of large stones and squared blocks of pudding stone

25 cm, 50 cm long (Discovered in 1976 extends into L-2) this wall makes an angle into a NS wall (sigma) composed of 5 layers of tile at one point near N end. At its S end this wall this wall rests on a layer of clay which rests on a ~~tile~~ tile fall. The layer of clay is 5-10 cm. thick, this tile fall. A scan be seen in section lies over the top of 2 EW walls (zeta + theta). Under the

Tile fall is a layer of pebbles which is also under the level of ~~the~~ pebble 103 Southern most of the 2 EW walls (theta) This level of pebbles is even with the top course of the northern of the 2 walls (Zeta). These walls and pebble layers rest on grey clay. 40 cm separate the lowest course of the Southern most of the 2 E.W. walls and the field stone pavement.

NS. wall on east side of M²-2 (NS stone wall)

Composed of field stones - occasional pieces of pudding. This wall goes down to within a few cm's of the field stone pavement. It rests on grey clay at a point between the two EW walls. This wall apparently takes a jog continues into N¹-1

Still composed of field stones and pieces of pudding, but on top of these was a leveling course of tiles in N¹-1. And this level is in a layer of pebbles. A wide expanse pavement to the east has been considered. This wall apparently had an extension to the west in N¹-1 - out there is an interruption. It rests on a layer of pebbles even with the NS stone wall. The level of pebbles is 40-50 cm above field stone pavement, and separated from it by a grey clay. The level of pebbles under the S most of the EW walls in M²-2 is 50 cm above field stone pavement but it's 20 cm thick.

The line of this N.S. wall (N.S. stone wall) continues into O'-1, there are two sections of it. Here chunks of pudding stone are most common with leveling courses of tile. There are some ~~field~~ field stones in the southernmost of the 2 sections. A ~~large~~ layer of grey clay separates this wall from field stone pavement.

N'-1

E-W wall compromised 40 cm wide in conglomerate blocks. This rests on a layer of grey clay ^{with} some yellow roof tiles mixed in, which is 25 cm above field stone pavement. This wall apparently intersects the N.S. stone wall at a right angle but the top of its higher course is below the level of the course of field stones and tiles in the N.S. stone wall. South of conglomerate wall resting on 20 cm of grey clay above field stone pavement is Anta Capital.

N¹+1

107

The face with many field stones mixed in the west half of square level is about that of the conglomerate wall or slightly higher.

Isolated large stone in north wall of eastern half of the trench.

Below this tile fill is a second (30 cm. lower) It is only a small section.

PAIO AA-11'
 POSTA A, A'-1-1
 (9.0.00)

0.00

1

(22)	1	-	18,1	q.	-0.63
(24)	2	-	22,7		-1.09
(26)	3	-	24,6		-1.28
(27)	4	-	29,2		-1.74
(28)	5	-	29,9		-1.81
(29)	6	-	30,4		-1.86
(30)	7	-	31,4		-2.01
(31)	8	-	35,1		-1.33
(32)	9	-	38,1		-1.13
(33)	10	-	19,3		-0.75
(34)	11	-	24,8		-1.30
(35)	12	-	35		-2.28
(36)	13	-	37,4		-2.52
(37)	14	-	39,5		-2.73
(38)	15	-	39,0		-2.68
(39)	16	-	36,9		-2.47
(40)	17	-	36,7		-2.45
(41)	18	-	30,4		-2.42
(42)	19	-	40,4		-2.82
(43)	20	-	40,2		-2.80
(44)	21	-	38,5		-2.63
(45)	22	-	35,6		-2.54
(46)	23	-	34,3		-2.21
(47)	24	-	37,2		-2.50
(48)	25	-	39,2		-2.70
(49)	26	-	35,2		-2.34
(50)	27	-	35,9		-2.41
(51)	28	-	30,2		-1.84
(52)	29	-	31,2		-1.94

395
 222
173

~~-2.73~~

1.74 per ogni livello oltre 32
 -1.81 per i primi 25 tollami
 -1.86 d. cm.

(16)

30

↓ 306

- 1.88

(15)

31

2465

- 1.285

9102

POSTA B (14)

9.

- 3.20

(-320 + 102) = -218

(2)

32

1255

- 3.435

(6)

33

231

- 4.49

(5)

34

2105

- 4.285

(6)

35

249

- 4.67

(4)

36

187

- 4.05

2025
2024

37

2045

- 4.225

(7)

38

343

- 5.61

(10)

39

307

- 5.25

(10)

40

331

- 5.49

(12)

41

361

- 5.79

(10)

42

382

- 6.00

16

43

360

- 5.78

16

44

181

- 3.99

16

45

153

- 3.71

(10)

46

1295

- 3.475

(12)

47

138

- 3.56

(11)

48

95

- 3.13

(15)

49

161

- 3.79

(13)

50

200

- 4.18

(18)

51

82

- 3.00

(19)

52

191

- 4.09

(19)

53

281

- 4.99

(21)

54

346

- 5.64

(20)

55

131

- 3.49

2

Fabrica

POSTA

(C)

-778

Cancel

(3)

1	- 8.65	23	- 8.59	45	- 8.56
2	- 8.61	24	- 8.76	46	- 8.74
3	- 8.96	25	- 8.83	47	- 9.09
4	- 8.58	26	- 8.77	48	- 8.78
5	- 8.06	27	- 9.12	49	- 9.05
6	- 7.96	28	- 9.00	50	- 8.42
7	- 7.89	29	- 8.83	51	- 8.93
8	- 8.27	30	- 9.03	52	- 8.79
9	- 7.71	31	- 9.23	53	- 9.05
10	- 7.65	32	- 9.05	54	- 8.60
11	- 7.59	33	- 9.08	55	- 6.85
12	- 7.85	34	- 9.03	56	- 6.65
13	- 7.34	35	- 9.25	57	- 6.88
14	- 6.79	36	- 8.69	58	- 6.95
15	- 7.13	37	- 8.77	59	- 6.81
16	- 7.87	38	- 8.29	60	- 7.73
17	- 8.22	39	- 8.65	61	- 7.12
18	- 8.20	40	- 9.10	62	- 7.55
19	- 8.26	41	- 8.68	63	- 7.09
20	- 8.24	42	- 8.60	64	- 7.06
21	- 8.45	43	- 8.94	65	- 6.89
22	- 8.50	44	- 8.69	66	- 7.73
				67	- 7.17
				68	- 6.87
				69	- 6.47

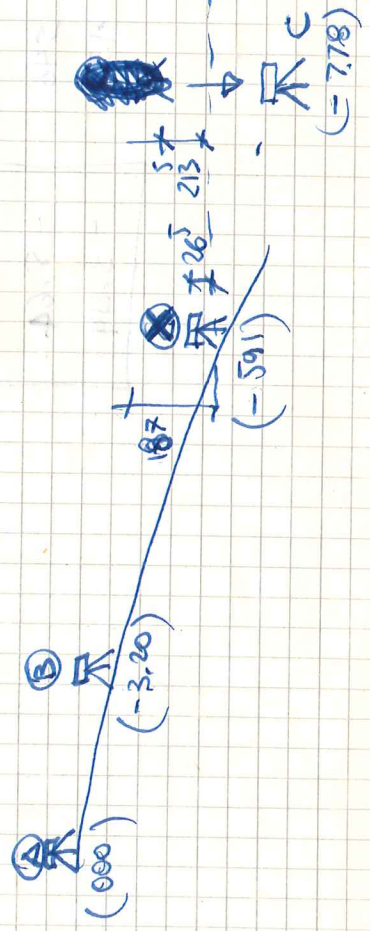

4

Canal

70 -689
71 -7225
72 -763
73 -876
74 -878
75 -938
76 -948

689-1000
7225-8000
763-1000
876-1000
878-1000
938-1000
948-1000
1000-1100
1100-1200
1200-1300
1300-1400
1400-1500
1500-1600
1600-1700
1700-1800
1800-1900
1900-2000
2000-2100
2100-2200
2200-2300
2300-2400
2400-2500
2500-2600
2600-2700
2700-2800
2800-2900
2900-3000
3000-3100
3100-3200
3200-3300
3300-3400
3400-3500
3500-3600
3600-3700
3700-3800
3800-3900
3900-4000
4000-4100
4100-4200
4200-4300
4300-4400
4400-4500
4500-4600
4600-4700
4700-4800
4800-4900
4900-5000
5000-5100
5100-5200
5200-5300
5300-5400
5400-5500
5500-5600
5600-5700
5700-5800
5800-5900
5900-6000
6000-6100
6100-6200
6200-6300
6300-6400
6400-6500
6500-6600
6600-6700
6700-6800
6800-6900
6900-7000
7000-7100
7100-7200
7200-7300
7300-7400
7400-7500
7500-7600
7600-7700
7700-7800
7800-7900
7900-8000
8000-8100
8100-8200
8200-8300
8300-8400
8400-8500
8500-8600
8600-8700
8700-8800
8800-8900
8900-9000
9000-9100
9100-9200
9200-9300
9300-9400
9400-9500
9500-9600
9600-9700
9700-9800
9800-9900
9900-10000

Elevations of Canal Area

109

June 22

height of instrument = 70.0 from conglomerate
blocks in TRE (o point) ~~conglomerate~~

0'-3

1. P¹-3
surface S.W. corner ——— - 1.26
o point for sections
2. S.W. bottom
level 4 - 1.98
3. S. end of conglomerate wall - 1.46
(level 1, bottom)
4. N. end of same - 1.23
5. large projecting conglomerate
block on line of N.S. wall - 1.22

Canal Elevations 1976

- 6. W. end of field stone wall
(level 2, bottom) - 1.69
- 7. E. end of same - 1.70
- 8. field stone pavement, north
(level 3, bottom) - 1.62
- 9. S. same - 1.84
- 10. Fieldstone wall
under conglomerate wall north - 1.62
- 11. Pottery deposit south of field
stone wall, next to it
(photo graphed) - 1.76
- 12. level of ~~pebbles~~ pebble floor
(level 4, bottom), north - 1.76

13. South, same

- 1.92 1/3

14. P'-4. - 1.08

15. 0'-4 - 0.54

0'-2

1. level of pebble pavement,
South, east corner

- 1.58

2. West, same

- 1.50

3. level conglomerate block on
east wall trench, top

- 1.36

3. height of block.

top of block corresponds to upper
level of gravel bottom, to lower
level of gravel.

Upper level of gravel is same level
as pavement in 0'-2

- | | |
|--|---------------|
| 4. level of gravel pavement at
N. E. corner | 115
- 1.28 |
| 5. lower level of gravel, N. E. corner | - 1.54 |
| 6. S. E. corner
difference in level between the
two gravel pavements in N. E. and
S. E. corners | - 1.70 |
| 7. E. W. field stone wall at east wall
of trench | - 1.70 |
| 8. E. W. field stone wall where it
intersects with N. S. field stone
wall | - 1.65 |
| 9. E. W. field stone wall where north
spur intersects | - 1.67 |
| 10. N. S. field stone wall just north of
intersection with E. W. | - 1.64 |

- | | |
|--|---------------|
| 11. N. S. fields tone wall just south of E. W. | 117
- 1.81 |
| 12. Roof tiles in southern wall of trench top | - 1.82 |
| 13. highest level of pavement in room alpha (just south of E. W. wall) | - 1.86 |
| 14. highest level of pavement in room gamma | - 1.86 |
| 15. highest level of pavement in delta | - 1.86 |
| 16. p1 - 2 | - 1.48 |

0' - 1

- | | |
|--|--------|
| 1. Top of NS wall, north section | - 1.54 |
| 2. same, southern section | - 1.58 |
| 3. top pilaster capital
height of capital | - 1.67 |

height of bottom of capital above
stone floor (rests on clay)

119

- | | |
|-------------------------|-------|
| 4. field stone pavement | -1.87 |
| 5. stake P1-1 | -1.55 |
| 6. stake O1-1 | -1.21 |

P1-2

- | | |
|--|-------|
| 1. top of western conglomerate block
(belonging to the "corner" pair
Depth to bottom, height above
field stone pavement | -1.48 |
| 2. level of pavement | -2.2 |

South Bank, Canal S. 4

- | | |
|-----------------------------------|-------|
| 1. N.W. corner, conglomerate wall | -1.93 |
| 2. N. end, tile wall | -1.98 |

Elevations

121

from conglomerate block in Trench I, marked
with orange X

height of instrument +.70

Wall TAU

- | | |
|---------------------------------|------------------------|
| 1. W. wall trench | - .38 |
| 2. S.E. corner | -0.32 |
| 3. midpoint | -0.43 |
| 4. S.W. end
(corner / photo) | - .54 - .54 |

Rito

- | | |
|----------------------------|-------|
| 1. Squared block in middle | |
| 2. S. end | - .94 |

Sigma

- | | |
|-------------------|-------|
| 1. N. wall trench | - .32 |
| 2. midpoint | - .40 |
| 3. S.E. corner | - .53 |

Zeta

- | | |
|-------------|-------|
| 1. East end | - .85 |
| 2. West end | - .87 |

Theta

- | | |
|-------------|------------------------|
| 1. East end | - .89 |
| 2. West end | - .87 - .87 |

"Zeta W"

Between TAU and ZETA

- | | |
|----------------|-------|
| 1. N. end, top | - .90 |
| 2. bottom | |
| 3. S. end, top | |
| 4. bottom | |

ETA

125

(between ZETA and THETA)

1. N. end, top
2. bottom
3. midpoint, top
4. bottom

"North South Stone Wall"

North extension, North, just south of large conglomerate block (our zero point)

1. approx. same as midpoint of ETA
 2. same, south (just south of N¹-2 south extension (after interruption)) -1.26
 3. N. end, top -1.25
 4. S. end, top -1.45
- Field stone wall which angles under "N/S stone wall" with spur in E.W. direction

1. at north end

-1.68 127

2. at corner (highest point)

-1.50

Wall which seems to make an angle
with N.S. stone wall, with extension
to the west.

West end

-1.30

Apparent end of "N.S. stone wall" in P1-1 where
it intersects E.W. wall

-1.28

Principal line of WS stakes from A'-1 129

A'-1	0
B'-1	-.40
C'-1	-.72
D'-1	-.89
E'-1	-1.23
F'-1	-1.90
H'-1	-3.30
I'-1	
J'-1	
K'-1	0
L'-1	-.40
M'-1	-.98
N'-1	-1.33
O'-1	-2.39
P'-1	-2.93

(feet)

a) from H'-1 to K'-1 -3.61

b) height of instrument +.87

c) from K'-1 to conglomerate stone in TRF

(our zero point X in orange)

-3.06

d) height of instrument +.95

Level 1 (-7.56) N1-3 (5)

1:25
N
↑

1/2" dotted lines =
boundaries of squares as
survey
solid lines = boundaries
of areas actually
excavated

numbers refer to
elevation points

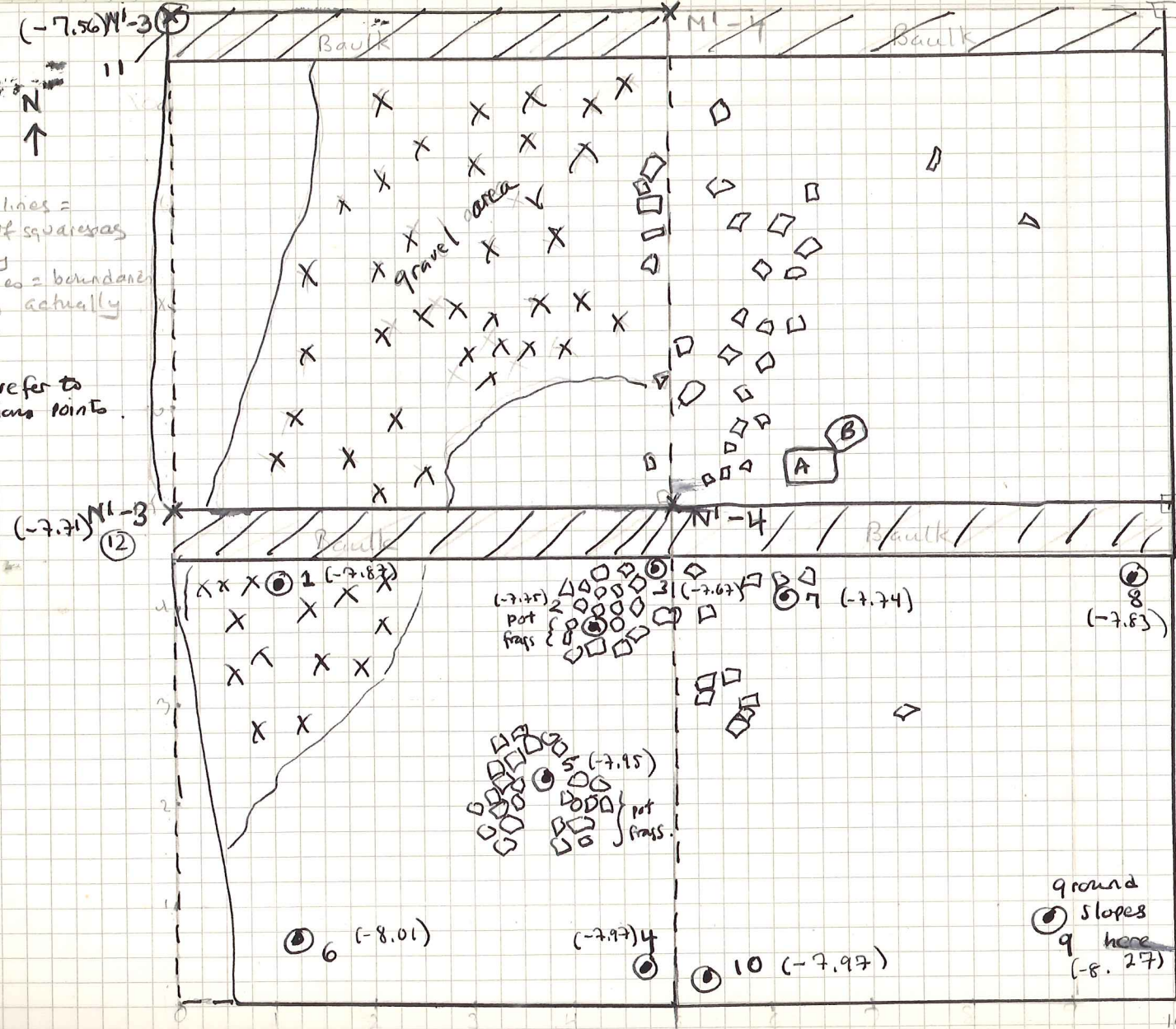

drawing #1
#2
#3
#4

p277 color
459P find
p277 black
460T in
lev

p2 456M
p2 457P
p2 465P

ground
slopes
q here
(-8.27)

CANAL AREA 1977.

NOTE elevations are from N1-7 (-6.46) (31) with ref # to plan sheet beside - the (-6.74 #1)

M1-3, M1-4, N1-3, N1-4 - Level 1.

Work in this area began on Friday May 27 1977. On that day, a 10 M square area east of the previous excavations was cleaned + excavation began in the first of the 4 5 M squares. This area (see diagram) is identified by the following star squares (from N to S) M1-3, M1-4, N1-3, N1-4.

The area was cleaned + surface finds collected. These finds contained a proportionately large amount of Greek ceramic material. After the area was cleaned, an ~~square~~ ~~rectangle~~ ~~4 x 5~~ was excavated. area 4 x 5 x 4.5 x 6 was excavated. (The irregular shape is due to excavations of the previous year at the west and the leaving of a 50 cm. baulk at the north). This area, for convenience called a square, is square N1-3. Level 1 was excavated.

Level 1 soil in N1-3 was dry + hard, medium-dark brown in color + filled with small smooth river stones, ceramic + tile fragments. Finds were few + included, in addition to coarseware, grey ware, + black glaze fragments, and a handle with a plastic ram's head in the NE quadrant were found 3 deposits of tile and pottery in situ. Level 1 a defined as the level above + around the tile deposits.

The next square, N1-4, to the west was excavated (4.5 x 5, because of N baulk). Level 1 in this square was of a similar soil type + the pottery from this level here contained a mixture of pottery types similar to that found in N1-3. Small find = a nail. The tile deposits noted in N1-3 were ~~only~~ increased in N1-4 but only in the NE but otherwise there were no large deposits.

The next square to the NW, M1-3 was begun. (circa 4 x 5, although a slightly larger area was excavated to the west where last year's excavation stopped + including N + S baulks of 50 cm). The soil here seems slightly less hard than in the southern squares + is full of small gravelly stones such as were noted in N1-3, but perhaps to a greater degree. It contains the same type of ceramic mix - Greek + roman. Note that a small (circa 8.5 cm) lamp was found in level 1. also a nail.

pz 77 454M

pz 77 452T

pz 77 453P

#1
#2
#3
#4

drawing
#4

The
the ja
west
east
soil
The
cr

The
the

D
M
T
W
ea
s

2
1

(4 x 5 really)
 The square west of M¹⁻³, M¹⁻⁴ was excavated. Level 1 contained the same type of ceramic mix, the small gravelly stones are found in the west of the square but are not found to the same degree in the east. At the extreme NE + N a wedge shaped area of orange soil is seen. Finds here include a figure of shaped loom weight. At 1.20 E-W x 7.0 N-S were found 2 column drum fragments. The measurements that can be made while they are in situ are:
 col. Drum A: diam: 50 cm
 length: 30 cm

col Drum B: Diam: 40 cm
 ht: 25 cm

These drums are made of fine limestone. A plow mark is visible on the top of column drum B.

It is to be noted that the ground slopes from the North to the South in this 10M area. Therefore in squares M¹⁻³ + M¹⁻⁴, level 1 is at a higher level than in M¹⁻³ and M¹⁻⁴. The tile fall in this area in level 1 runs along the N-S axis of the 10M area, for slanting slightly NE + SW. Towards the east, the number of tiles + gravel is insignificant. In the west, the gravel area is fairly uniform though especially heavy in the NW of square M¹⁻³. Note that the column drum fragments are included in this diagonal strip of tiles + pottery. Perhaps this gravel area that is to the east of the tile fall can be attributed to a flood of the area which brought river stones over + around the tile fall. The mixture of ceramic types might also be attributed to the flood of which brought the Roman material down the hillside.

Note also that the column drum fragments are north of other masonry fragments discovered in the previous season.

PZ 77 461T

PZ 77 462D

Level 1 finished
 May 31

N1-3 N1-4

Level 2

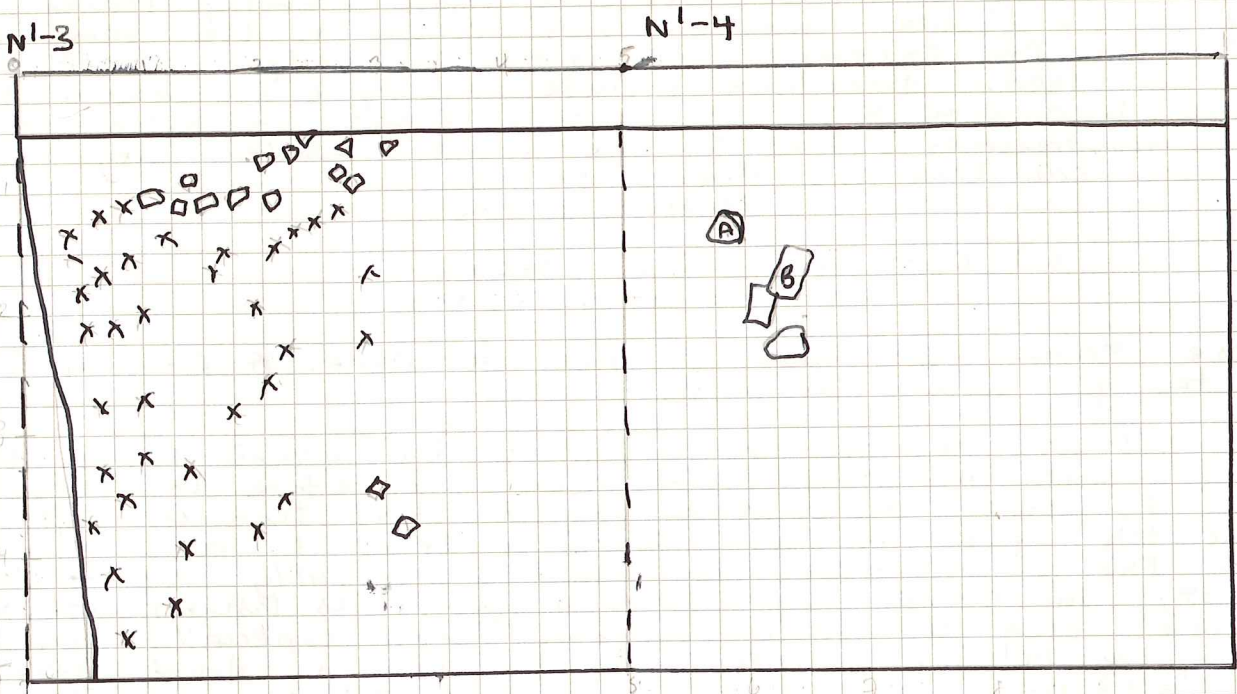

drawing #5

N1-3

N1-3

N1-3

from Potts

file

1

Str

as

of

s

PZ 77 458 P

PZ 478 T

PZ 490 P

PZ 491 P

PZ 492 M

PZ 493 T

#1

drawing #6

N1-4

N1-3 N1-4 Level 2.

N1-3

After excavating level 1 of the 10m square area, level 2 was excavated in N1-3 + N1-4. Level 2 is defined as the level under the tile fall in N1-3, N1-4 + N1-3 + N1-4. The soil is a drier + lighter brown. Pottery finds from N1-3 are numerous + include gray ware + coarseware. ~~finds are more~~ Pottery is more numerous in this level than in level 1. The level 2 in N1-3 has the gravel area noted in level 1 west of the tile fall to a depth of only about 5 cm. Therefore west of the tile fall, level 1 is composed of a thin gravel layer under which is a layer with much less gravel. However, the soil matrix appears to be the same. This gravel layer, as noted in level 1, does not extend to the tile fall or under it.

~~of the~~ The material in level 2 found under the tile was collected separately. Several restorable coarseware bowls were found.

pz 77 458P level 2 finds have a distinctly casalinghi touch to them - coarseware vessels, pz 478T locmenuts, a shalier fragment.

Also a nice red-figure rosette fragment, (prose - Kellenutis)

pz 490P

pz 77 455T lamp fragment - level 2.

pz 491P

ht. of level 2 from N1-3 = -7.41

pz 492M

pz 494P

pz 493T

~~pz~~

~~pz 503P~~

~~pz 504T~~

~~pz 505T~~

~~pz 506T~~

~~pz 506T~~

~~pz 508M~~

~~pz 477P~~

~~pz 478T~~

N1-4 - level 2 here as in N1-3 is defined as the level under the tiles found in both squares.

Circa 60 cm west of N1-4 stake were found a small cluster of architectural fragments - a small rectangular block A 20 x 25 cm, block B, 39 x 20, a large tile (35cm) and a fragment of what appears to be masonry, 39 cm long. These architectural fragments are not in line with the column drum fragments found in level 1, N1-4, but are near them, though to the south + probably are associated with the same building which collapsed.

ure =
pz 466P

lamp nozzle

pz 464T

fine rf sherd with an figure of upper torso of a woman found near the stove fragment (12 cm below top of rock fragment).

N1-3 + N1-4
level 2 Battuta 2 N1-3

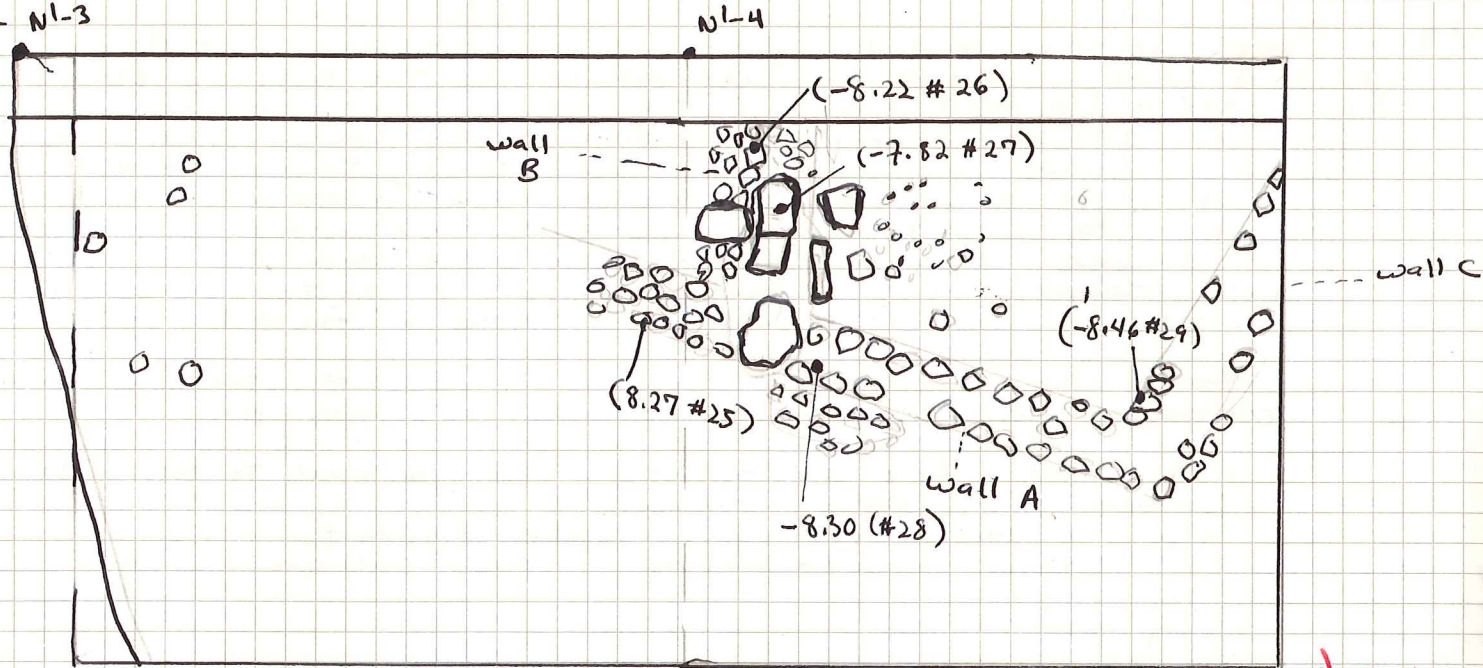

n.b. in heavy outline are the masonry fragments found in level 2

drawing
#7

N1-4

PZ 470P
PZ 471B
PZ 483P

PZ 46

PZ
PZ

Since
the
plan
Bat

N1-4

Ba
a
T
C
S

N¹-4 level 2.

Also near this complex, fragments of charcoal, ^{PZ 472SS} samples of which were saved. 137

PZ 470P

PZ 471B

~~PZ 471C~~

PZ 483P

In the ceramic material from level 2: coarseware, black glaze bases, grey ware.

Also small TC head of statuette ^{PZ 474P} PZ 473T

PZ 469P

Fragment of Terra sigillata (Arretine?) Stamped GNAIEI
MARPAN

PZ 467T

Lamp fragment (Roman)

PZ 468T

loomweight.

Note that level 2 is a deep level, ranging from 20 cm at the east to c. 50 cm at the west. No gravel is found in N¹-4 as in N¹-3.

Since the soil of ~~level 2~~ remains the same and since no features except for the fallen ~~of tiles~~ masonry fragments are visible level 2 is considered to continue. However, the finds from this level are called from level 2 Battuta 2, although Battuta 1 was not identified as such.

N¹-4 level 2 Battuta 2.

Battuta 2 is not as deep as the first excavation of level 2, therefore there are fewer finds.

The tiles that were visible at the end of level 1 in N¹-3 + to some extent in N¹-4 as a tile fall are perhaps part of a larger tile fall that can be seen in the baulk but at a lower depth in the east than in the west. (See section of E-W Baulk, South face.)

Charcoal fragments found in level 2, Batt. 2 near the NE end.

A wall, called wall A was found in the S. 1/2 of the square. This wall is composed of fieldstones + tiles, c. 38 cm in width + it runs SE-NW,

Fragments of a statuette found near the wall.

~~Finds~~ Another wall, wall B, with tiles in situ associated with it was found L to wall A. This wall lies under some of the architectural

N1-4 leu

fragm
desp

p2 476P

p2 486P

p2 479

p2 4

p2

w

+ b

b

drawing
#8

N1-3

p2 77

p2 478T

p2 503P

N1-4 lev. 2, Batt. 2.

139

fragments found in level 2. Wall B, like A, is of fieldstone + tile. It is perpendicular to A + heads North.

p2 476P The material at the level of walls A + B was kept separate.

p2 486P

p2 487T

Finds include p2 488T

p2 479T

Figure 8 loomweight

p2 480T

stakette fragment 40 cm west of wall A.

Black clay base

p2 481T

stakette fragment near wall A.

p2 489M

Brnze strigil.

p2 509P

Wall C, at the extreme ^{NE} of the square also is perpendicular to wall A + is made of fieldstone + tile construction. Wall A seems to extend beyond its intersection with wall C + not to make a corner. We seem to have a small room bounded by C at the east and B at the west. In this room there ~~is a~~ are medium + small fieldstones at a level a few cm lower than the walls which seem to be a surface in the room.

There are also tiles in situ immediately south + touching adjacent to wall A. Perhaps also a fieldstone + gravel surface (floor) in this small room. ~~note it is not clear if wall A continues to these ends at its intersection~~

N1-3

lev. 2 Batt. 2.

In this Battia, the continuation of wall A to the ^{North} East was found. However, the wall disappears as it heads north except for a few traces.

Finds.

Terracotta fragment of Salyr head (?) near western end.

p2 507T

p2 506T

Small bronze fragment found. p2 508M

p2 505T

p2 504P

p2 77 ~~477P~~

477P

material here seems mostly Greek.

p2 478T

p2 503P

material from the clearing of the walls A, B + C ~~is~~ saved separately.

M1-3, M1-4
level 2

N
↑

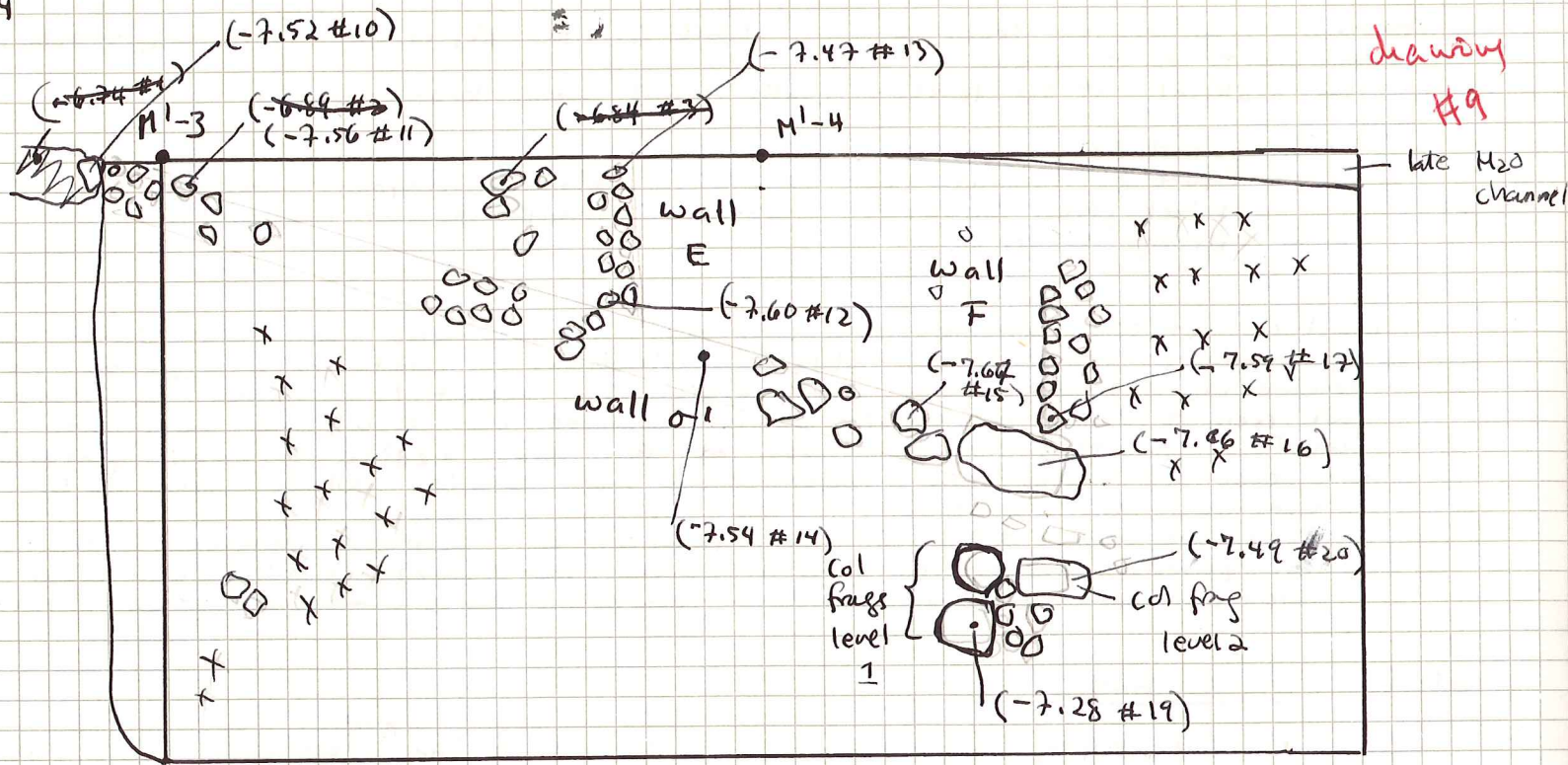

M¹-3, M¹-4

level 2.

June 7, 8, 9

141

M¹-3 level 2.

This level is the one under the gravel area found in level 1. Level 2 soil - hard dry
light brown with some ceramic material + gravel in it.

In the NW a continuation of a NW-SE running wall found in 1976 found, called
sigma' (σ') This wall is composed of tile + fieldstones as wall A, but
also to have conglomerate rocks + worked blocks. It seems slightly narrower
than walls A, B, C. But is parallel to wall A.

Also in this level is an area of gravel south of the wall σ' + a few
large fieldstones.

~~In the middle of the square at the NE is a group of fieldstones~~
also make a wall perpendicular to σ', called wall E, also of fieldstone
+ tile construction.

There is also ~~some~~ a group of fieldstones east of wall E whose function
is not apparent.

PZ 498P pottery - mixed - greyware, black glaze.

PZ 499P

Finds: Fragment of RF vase - feet (4th c.?)

PZ 482P small pot almost complete in situ west of wall E, 55 cm s + 82 cm w of
M¹-4 pot - c. 8 cm high. coarseware flask.

PZ 485P 1/2 of small volute bowl with red stripes inside. 5 cm in diameter.

drawing #10

M

p2775

p2

p

M1-4 level 2.

In M1-3, level 2 is the level under the gravel. In M1-4 it is the level under the tile fall. In both instances it is of hard brown (lynt soil). level 2 in M1-4 is deeper than in M1-3.

wall O' continues SE in M1-4. Here it is composed of fieldstones + tiles + of a large conglomerate block + perhaps a broken conglomerate block repaired with stones. (which appears to be perhaps the same wall as wall B.)^{levelled}

perpendicular to wall O' in M1-4 is another fieldstone + tile wall, wall F running north.

In the NE of the square there is a gravel area except at the extreme NE where the yellow soil from a late water channel found in 1976 to the west can be seen.

Another column fragment, this time of one on its side, just east of the two previously discovered, is found

p277545P pottery from here - mixed.

Finds:

p277515T

p277546T

(note large # of limestone found in this area - does this suggest a house?) This season in the canal

PZ 77 484P Small votive pot found near N end. ht. 2 cm. black glaze

Decorated RF fragment.

~~ML~~ lead tube (7 cm long) PZ 77 517M

lead slug found in cleaning of σ^1

PZ 77 517M iron object 14 cm long (a tool?)

PZ 77 518T TC stamella - arm + hand 9 cm long. Found in extreme NE of level 2.

PZ 77 519M Bronze votive shield, small (see polichoro for comparanda)

Bones
slag PZ 77 514P

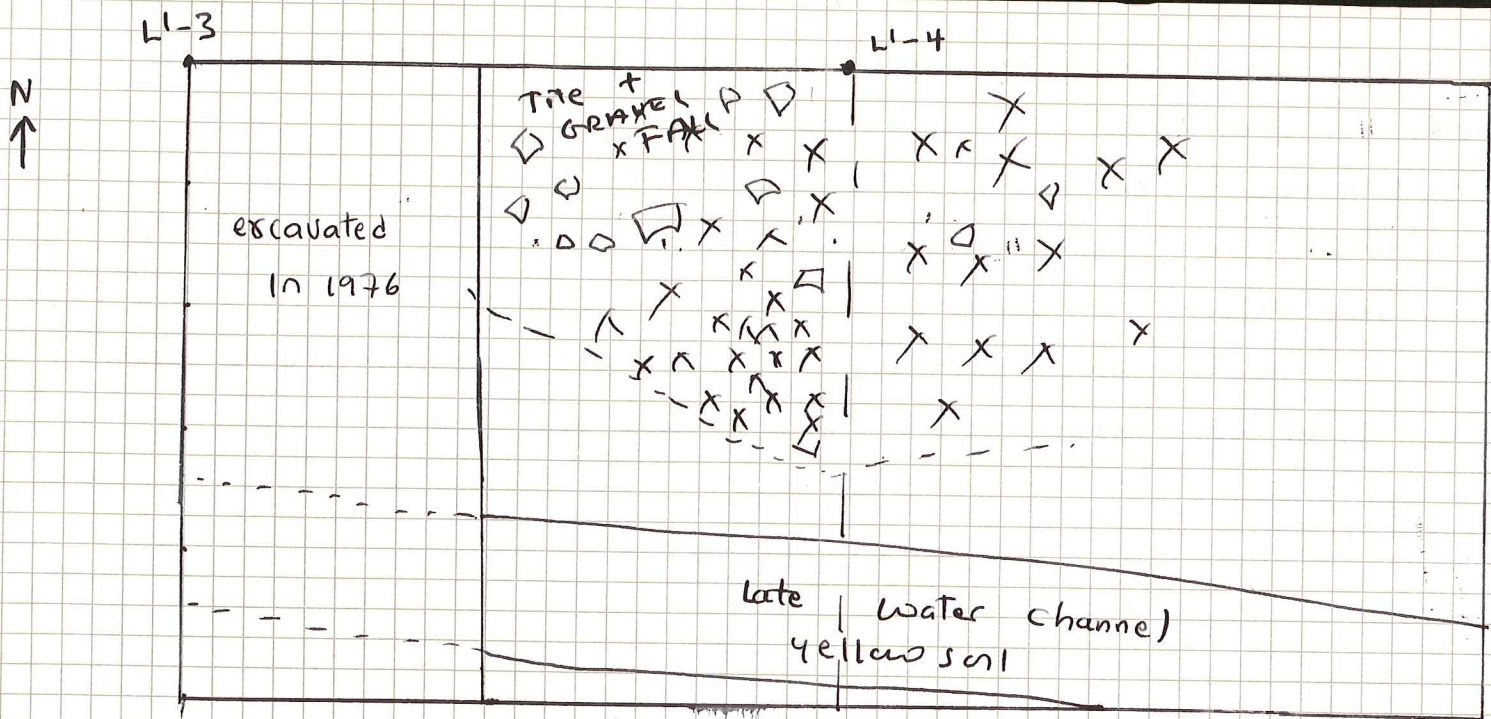

Level 1

drawing 11

L1-3, eastern
 p2 77 52
 52

level 2

522P
 level 2
 524P
 525M →
 527P
 529

June 8, 9, 10

L¹-3 eastern 1/2 L¹-4, Level 1, level 2.L¹-3, eastern 1/2

The eastern 1/2 of L¹-3 is being excavated. The western 1/2 was excavated in 1976 (actually more than 1/2 of L¹-3, 3.10 m x 5')

P2 77 520 P Level 1 - Dark brown earth with tiles, mixed material.

521 P

Tile fall found in northern 1/2 of square which corresponds to the tile fall found in other quadrants of the area. (not very ~~some~~ substantial tile fall.)

In the south of the eastern 1/2 of L¹-3 we found the yellow ^{sandy} soil of the water channel noted in the north east of M¹-4.

level 2

The continuation of wall 10a' found in the NW of the western 1/2 in 1976 was found. The wall runs NW-SW near the north end of east 1/2. It is composed of tile + heldstones, c. 40 cm in width. (note that in cleaning the dirt from part of 10a' discovered last year it was observed that at the north west end a small wall running L to 10a' to the north seems to abutt this wall, not to be bonded to it - but more excavation is needed. The emergence of this wall indicates the beginning of level 2. ~~Level 2 is the level under the tile fall~~

522 P

Level 1 Finds:

Furiform urnentarium. (late 4th - early 3rd) in north end.

level 2

level 2 Finds.

1. Roman coin - Tiberian found in the yellow soil of the water channel.

Fragment of terracotta figurine.

524 P

525 M

527 P

529

In the NW corner of L¹-3 eastern 1/2 just N of wall L¹, is a gravel surface which possibly indicates a floor? just at the level of the wall. (However, it is level 2)

L1-3, L1-4 level 2

drawing 12
20

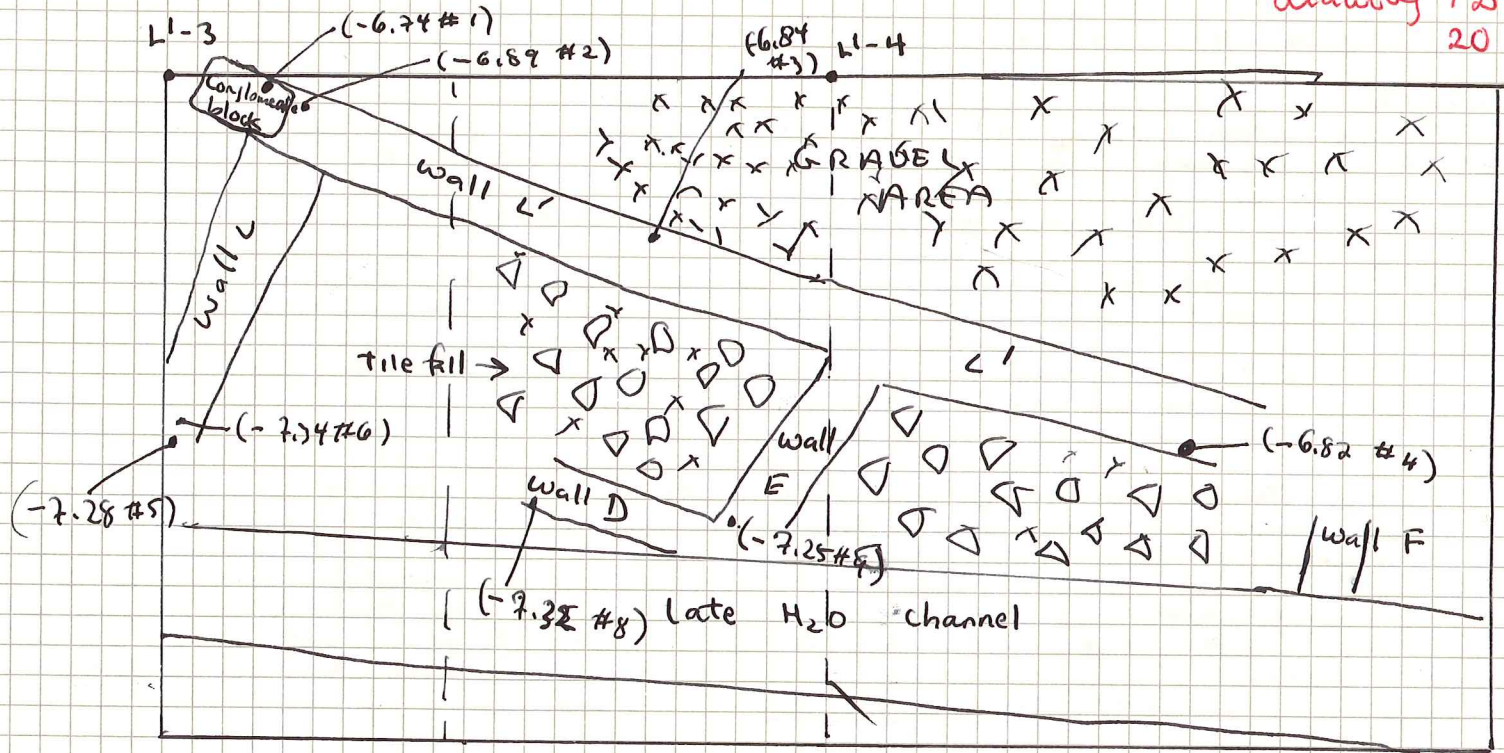

necessa
valid

L1-
495P
496T
539
543
544

L1-3

necessary to understand the depth of the wall first. (I would very much doubt the validity of this observation now (June 26))

L¹-4

Level I.

495P Dark earth except where the yellow channel comes through.
496T very deep layer, little material. c. 50 cm from top of bank at W.

539P

Finds: 2 thin pieces of metal ~~found~~ with a rounded shape.

543G

544M

L¹-3 East 1/2 level 2. At the level of wall lota¹ was found a heavy tile full, including many almost complete tiles. Also another wall, Wall E which is L to lota¹ + also seems to be L to O¹ in M¹-4 (although the water channel cuts through this, was found. Also of tile + held stone construction. Another wall D, parallel to lota¹ and L to E was also found. It is not clear if the intersection of D + E marks a corner and an end or if D continues.

However the walls lota¹, D + E make a small room within which there was a large tile fall. Wall D does not ^{seem to} join with wall lota found in 1976 which runs north-south.

January 28

549

538 T

572 P

~~573 T~~

607 P

608 T

609 T

L1-4 Level 2.

June 10, 13

note that a tile fall above a wall was not found here as was found in other quadrants. Therefore in this level, level 2 begins at the level of the wall that emerges, not at the tile fall. However, since the amount of earth between tile fall + wall is relatively slight, I believe that level 2 can be said to begin either at the beginning of a tile fall or at the beginning of a wall. The soil in both these situations is the same light brown dry soil.

Therefore in L1-4 a tile fall not found, but a continuation of wall 10a C' and a possible continuation of wall B found in N1-4 called wall F which might have formed a corner with 10a C' at the east. More cleaning is needed to determine this.

The earth under the level of walls C' + F in level 2 is full of gravel.

547

Finds. NE of wall C' - Statuette arm fragment

538 T

in yellow water channel soil - small bronze (Greek?) coin

572 P

piece of green slag

573 T

607 P

608 T

609 T

level 2 in L1-4 is not carried to its completion (i.e. to ~~the~~ another architectural feature) but was excavated primarily to determine if any architectural features existed very close to the level of walls 10a C' and F.

June 9, 1.

Area South of wall σ' in M¹-3 + M¹-4

Level 3, Battuta I.

In M¹-3 and M¹-4 a rectangular area 1.90 (N-S) X 7 (E-W) in the south of the squares is being excavated. This area is immediately south of wall σ' + extends to the column fragments in M¹-4.

Since this area is lower than the top of wall σ' the 1st level to be excavated is level 3, Battuta I.

Area 10 cm under the wall σ' are tiles in situ at west end.

p2548 material mostly green - black glaze + coarseware.

550T

551

549A

553T

Finds: RF fragment - upper torso of draped female (4th c) a few cm below level of wall σ' . 552

Level 3, Dattata 2
drawing 14



M1-3

M1-4

wall E

wall A

wall

F

Level 2

Area S
of wall

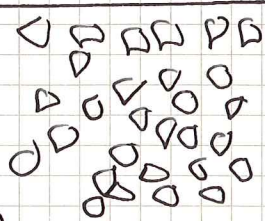
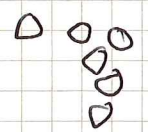

Tiles +
occasional field stones



Column
bases

p2 510

p2

p2 536M

June 10
Area South of Ol Wall.

Level 3, Battuta 2,

This battuta is about 10-12 cm below the first battuta,
material coarseware, small amount of grey ware.

Under the tiles noted in level 3 is a flintstone wall running SW-NE
at the west end of the area. (Wall G)

material from above This wall removed separately + labelled "from above
wall G"
There is a large amount of tiles, especially in the west + east + some
large flintstones in the center.

p2 510

~~p2~~

p2 536M

finds include lowweight
statuette fragment

Bulk Trimming - p2 533 P
p2 534 P
p2 535 T
p2 537 P

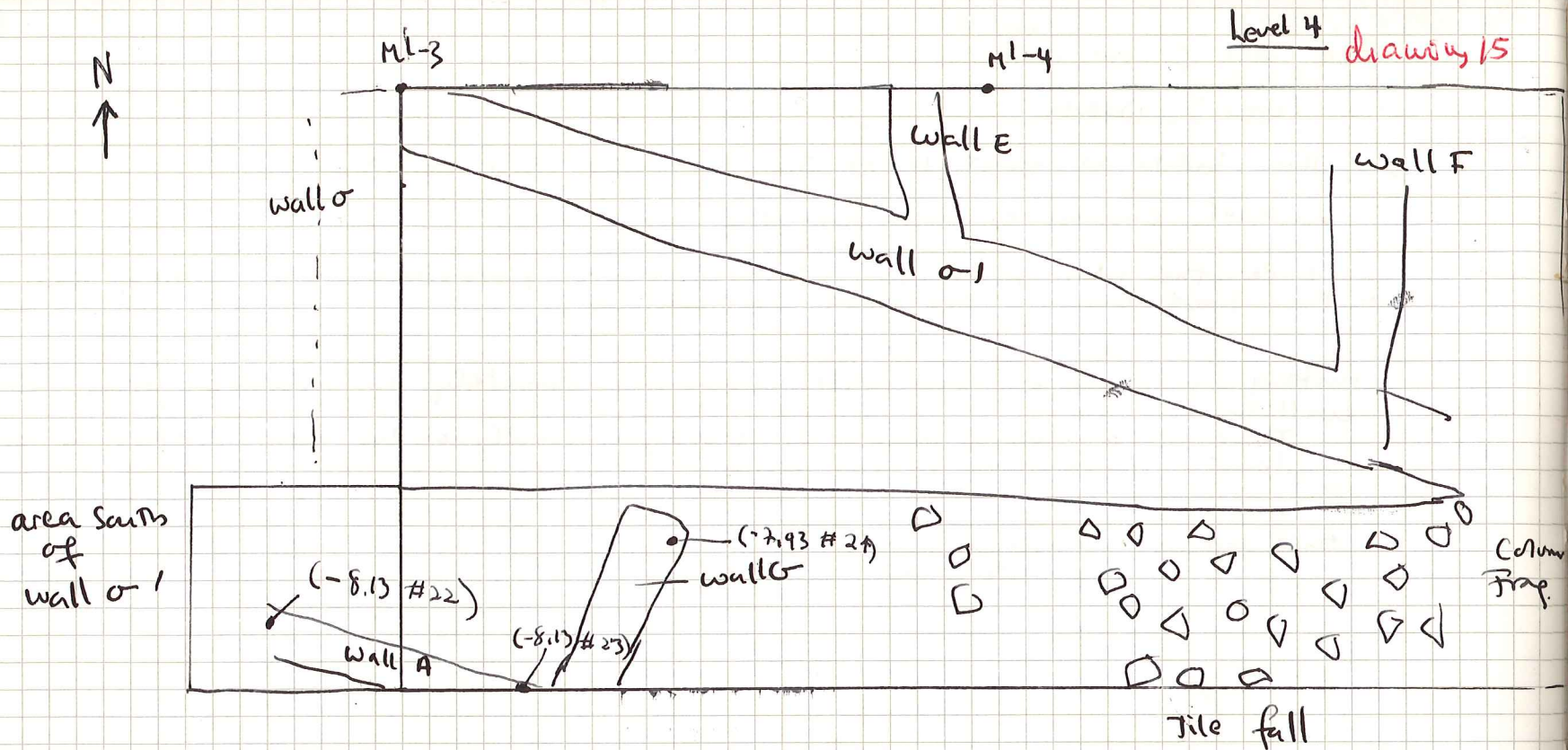

note area south of wall O, has been enlarged to include an examination of the relationship of wall A, wall G and wall O.

Area S of Sigma 1 wall,

Level 4.

This is the level under wall G + tiles associated with wall G.

note 2 pieces of ribbed *smathia* with red band at top (*pellicosa comparanda*)
grey ware base.

Wall G appears to be made of fieldstone + tiles and to connect to wall A found in N1-3 + N1-4 level 2 which also emerges in the S of this area. Tile fall in the east. The

558 p note fragments of restorable coarseware bowls found at east end of the area.
Associated with this bowl were several pieces of charcoal.

note that "level 3" + "level 4" are used to define the areas between recognizable architectural features - i.e. wall O' and wall G but that in terms of soil the walls O' and G' seem to be associated. In other words we are still dealing with one level - level 2 in which architectural features that seem to be related in terms of wall composition + even to connect one with another, occur at different levels in the earth. But the soil matrix appears to be the same. When dealing with those complex of walls, it would be better to consider them as occurring in level 2 of course it is necessary to examine closely the associations, ~~between~~ relationships among all these walls before this can be truly determined.

area S of old wall in May
level 3 Bathita I
level 4
drawing 17

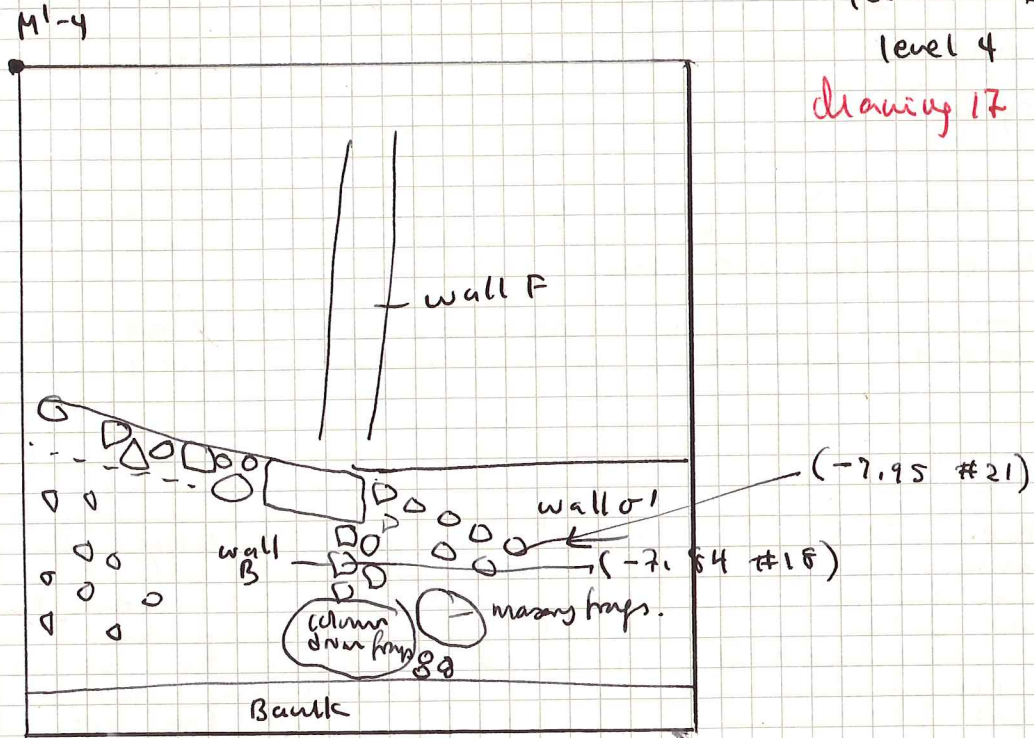

The remainder of the area S of wall O1 in M1-4

June 10

159

level 3 Battuta 1.

The rectangular area excavated to the column fragments is now extended to the N-S bank of M1-4 and one battuta is made which uncovers more of wall O1 running SE and what appears to be a continuation of wall B found in M1-4 level 2.

locumveritas

level 4 is the level under the level of wall O1 continuation to the SE and under wall B.

2 guttus fragments (black ^{flage} ~~flage~~)

more masonry fragments are also found

Level 2

drawing 16



N-S

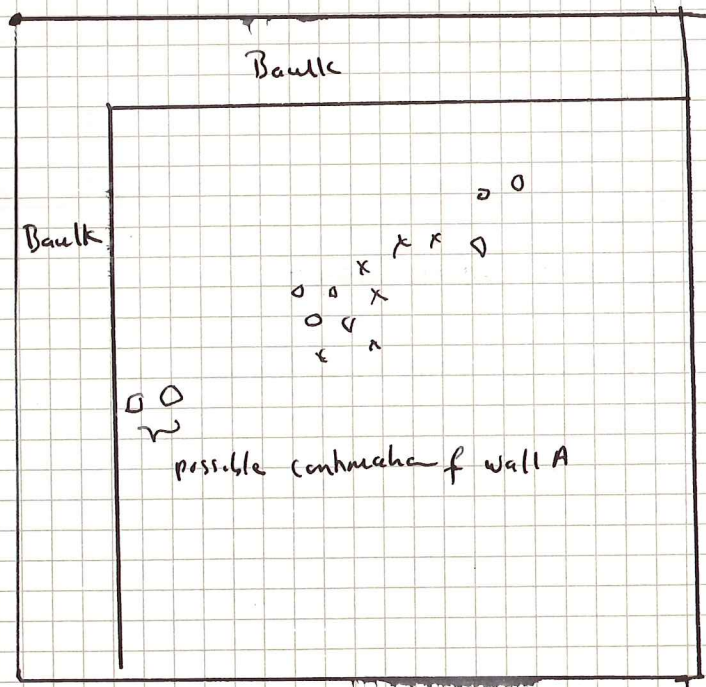

513P
553P
554T
559

562T
561T

497
57

574P
576P

June 10, 13

N1-5 level 1. ^{or}513P
553P
554T
559level 1 is very deep here.

little material. concentration of small white shellfish at
base of level 1.
no features except a possible continuation wall A in the SW. ;
Below this possible feature is level 2.
lacunweight

N1-5 level 2. Dry light soil. Still not much material. Tiles - soil full of.

562T stamped lacunweight

561T numerous stamette fragments found in NW corner of the square.
Small white pot + many heads in center of square + to the north. - 84 cm from
(4 heads, 1 male torso, 1 female with the arm of another).
A layer of gravel directly above this level. This gravel extends around the square N1-5,
incised greyware plate fragment. as can be seen from the baulk.

497P
570T563P
564P

O1-5 level 2. Since most of level 1 was removed from this square by the
bulldozers, work began in level 2 here, which corresponds to level 2 in N1-5.

No features found in this level, tiles + gravel.

574P
576P

pyramidal lacunweight 577T
nice fragment of ceramic ware.

→ N

N-5

level 4+5

drawing 26, 27

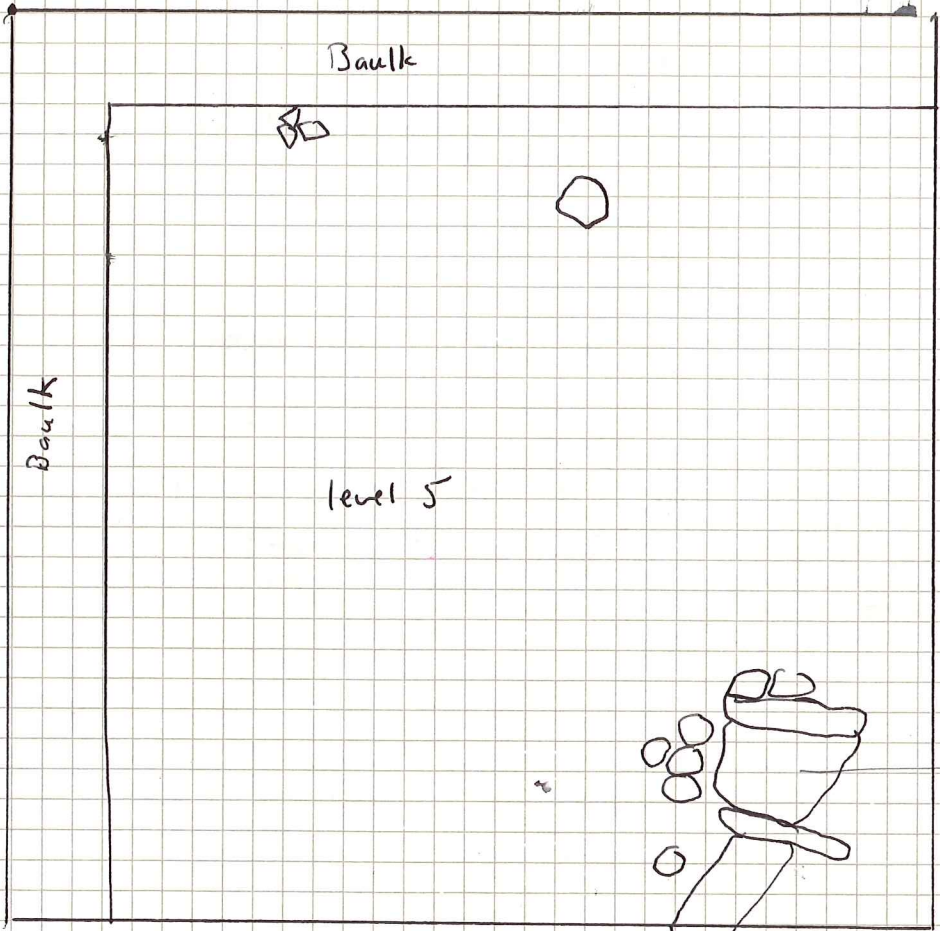

Baulk



Baulk

level 5

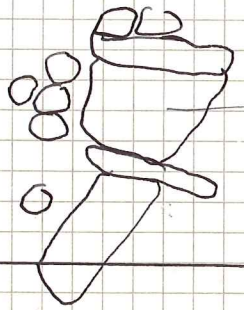

level 4 wall

~~N1-5 June 13, 14.~~

~~level 1. little material.~~

~~gravelly area found in west,
mostly coarseware.~~

N1-5 level 3, O1-5 level 3,

O1-5 level 3, under the level of the wall is O1-4. But here, no features.

540T
541T

Small sthette fragment
Carbon fragments
lead sheet
RF Sherd.
grey ware fragment.

Dark wet soil. note gravel layer in bank above level 3.

N1-5 level 3. PZ. 77. 664P, 665T, 666T

sthette head -100 from E-W bank, this is lower > level 3 which
other fragments were found but in the same area.

~~PZ~~

N1-5, O1-5 level 3 Dattuta 2.

This bathub begins 20 cm below the N-S bank in the west.

relief decorated greyware sherd,
lead neck + mouth - corresponds to lead sheet found in level 3 Dattuta 1.
sthette head -120 from N-S bank of this area.

641T

PZ. 77. 702P, 703P, 704T

Note - layer of gravel from N1-6

163

is
N1-4 -50
N1-5 -87
O1-5 -110

This gravel is found lower + lower,
probably indicating the wash of
gravel + soil down the hill + not
a habitation level.

01-5 level 4. wet dark clay + sand. no level before the water
N1-5 level 4
Battuta 1. w/c material

01-5 level 5
N1-5 level 5. walls appear in N1-5 level 5 in no level at the level of the walls.
material - black flake, note in N1-5 - Herakles last type of handle. (6th c.)

Δ 1

57
5

TRIANGLE 1

June 13, 14, 15, 16

165

In N1-3 + N1-4 The wedge of earth bounded on the north by wall A + on the south by the area excavated last year is excavated. Approximately 30 cm on the S side of wall A is left. The area is called Triangle 1 and excavation in it begins at level 3. The level under wall A. Note that in the west this Δ extends beyond the limits of N1-3.

$\Delta 1$ level 3

material ... loamweight with 3 incised circles. loamweights.
 Black flint flaps + coarseware.
 625P Black flint lamp nozzle.
 624T Small amount of grey ware.

level 3 Dattata 2.

carbon + soil samples taken in west end of $\Delta 1$.

575P

582T

lead found, very gravelly earth in the west, as has been the case all the way down in this area.

In level 3 were found a room bounded by 4 walls in N1-3 and another wall, in N1-4.

This room is called Room 1 + is very small, bounded by fieldstone + irregular stone walls, one of which wall 2, appears to extend to the south + possibly to connect with a wall found last year.

Wall 5, in N1-4 is also of tile + fieldstone + was N-S.

~~note found~~

Note that these walls are lower than the wall A complex + oriented slightly differently.

TRAVEL 1

drawing 18
19

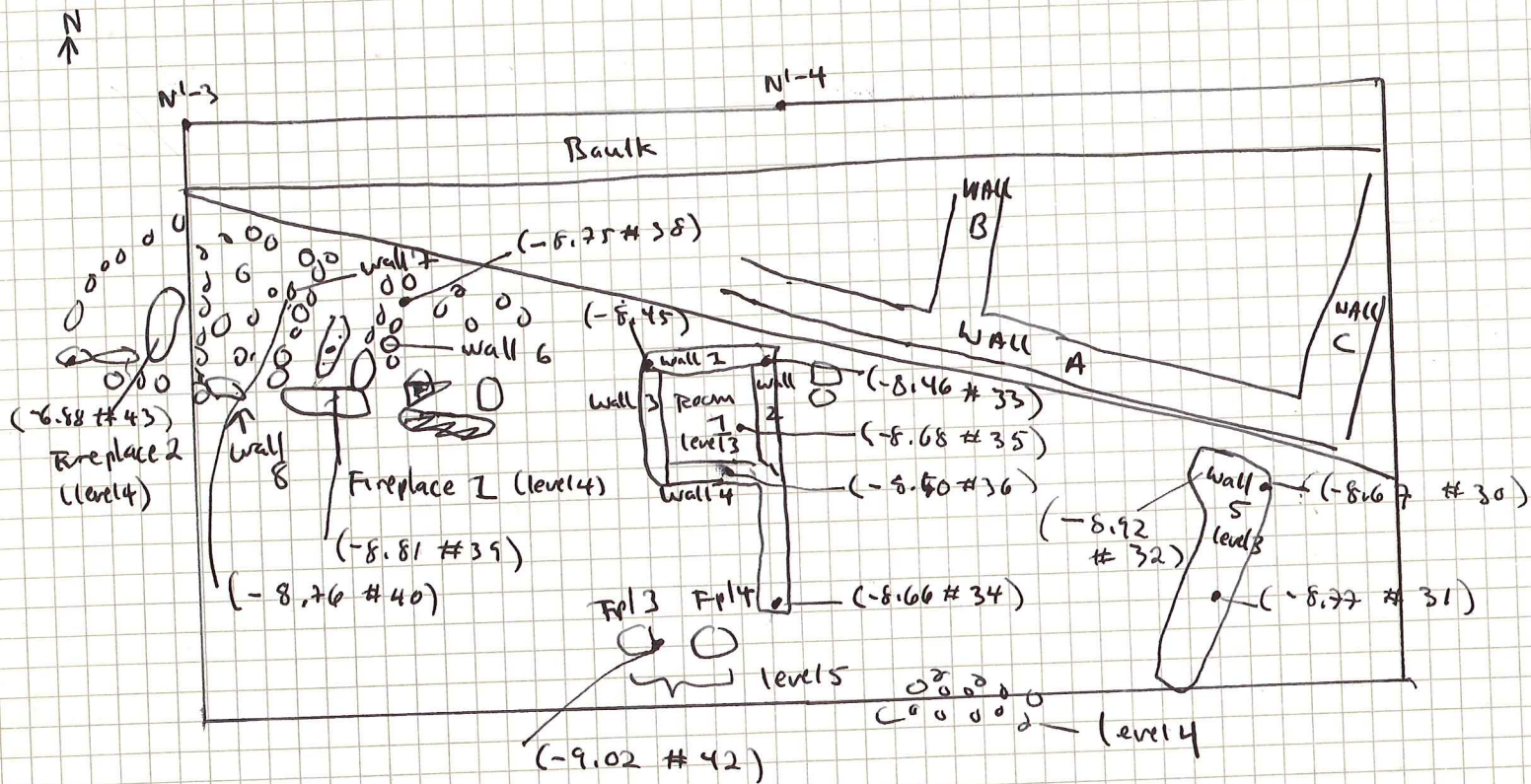

AS
 Δ I
 under
 which
 f soil
 ne y
 wall
 level
 583 P
 584 M
 601 P
 603
 585 SS
 586 SS
 lev. 4 T

As we go down, tiles are less frequent + gravel is scarce.

Δ I. level 4. This is the level under room 1 with the wells (1, 2, 3, + 4) + under well 5 in N1-4.

There is a layer of yellow ^{claylike} soil visible in the bank directly under level 3 which is found also in Room 1. It contains no material + perhaps is a flooring of some kind. In an investigation of room 1, it was found that this yellow soil was on top of a pebble surface. There were no bricks, but perhaps the yellow soil is to be associated with a floor associated with the walls of room 1 + well 5 + the pebble surface serves as drainage.

583A level 4 Battuta 2. material coarseware, black glaze, greyware (note incised plate frag)

584M level 4 Battuta 2 ^{610P 611P 612T} begun in east end of Δ I. large smooth fieldstones found.

601P level 4 Battuta 2. west of room 1.
603T Terracotta bead.

material divided here between material found east of room 1 + that found west of room 1.

585SS level 4. Battuta 3, ^{605T 606P} east of room 1. Tiles + round hollow stones arranged in situ.
586SS

level 4 Batt 3 in situ - large coarseware hydria head + shoulder.
west of room 1. brownware - rounded pyramid - small c. 6 cm.

601

black glaze frags + greyware.

fragments of charcoal found in concentrated area at the west end of Δ I. Associated with it black glaze + piece of greyware.

The soil is grey clay interspersed with sand.

-110 from N1-3

This material is collected slowly for carbon dating - the concentration should indicate burning, but the pottery is not burnt.

drawing 34

near are the surrounding rocks. Surprisingly it becomes clear that this charcoal area is in a type of fireplace, bounded by a large flat flint rock to the south + by one definite N-S wall, wall 6 + possibly another one wall 7. It is it + by an E-W wall, wall 8 which includes the flat stone. On the other hand, these may not be walls but heldstone paving stones as were found in previous excavations. This charcoal area is called Fireplace 1
 Carbon sample taken again - level - 1.13 from N1-3.

Another smaller fireplace, Fireplace 2, is found to the west of fireplace 1. It is bounded by vertically placed stones + might be considered to be in a corner of a room bounded by walls 7 + 8.

Carbon samples collected here.

When coming down in this level to the heldstone pavement - level complex 1 first there is a layer of brown-yellow sandy soil under which are the fieldstones.

in level 4 Battuta 4 east of room 1 - very little material + no pavement found in 01-4 in 1976 has not appeared in level 4 Battuta 4.

58755 level 5 west of room 1 - under the level of "pavement" - "walls" in area west of room 1, here that what finds there are on this day come from the bottom of the level - found by the heldstones beneath level of fireplaces + south of them.

c. 45 cm in diam. about 15 cm apart. in this level 3rd + fourth fireplaces found south of room 1 - not bounded by stones but large area of carbon stained earth. These carbon stains are lower than fireplaces 1 + 2.

in area east of room 1, level 4, Battuta 5.

Carbon samples taken. (- 1.14 for N1-3)

Dot pavements remain in situ from this area just east of room 1.

Δ 1. Elevations from N'-3.

- 1. Wall 5 : -1.09
- 2. Fpl 1 -1.17
- 3. Fpl 2 -1.19
- 4. Fpl. 3 -1.39.

drawing 33

— SMALL TEST IN SOIL BELOW ROOM 1 —

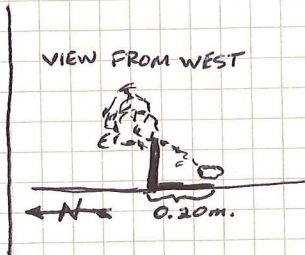
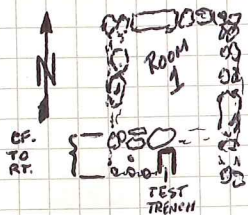

— SMALL TEST SOUNDING OF WALLS A + 2 —

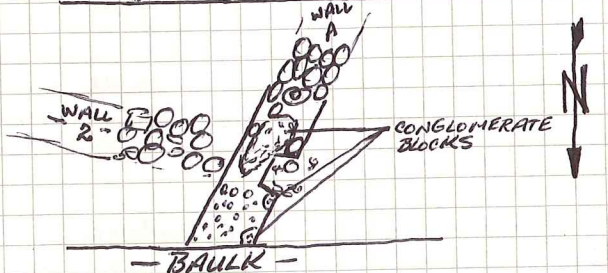

— SOIL SAMPLE, TEST SQUARE A —

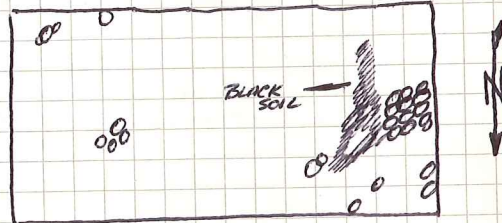

level 5 east of Room 1, below the level of the walls west of 171
Room 1 (walls 6, 7, 8)

Excavation of Room 1.

589 SS 1.10 m of dry hard earth just below level of walls.
Then yellow-soft clay-sand + -25 cm from the top of Room 1 walls,
a pavement of stones + small fieldstones.

No material

Δ 1 - LEVEL 4, BATT. 3.

SMALL TEST TRENCH DUG INTO SOIL JUST SOUTH OF SOUTH WALL OF "ROOM 1": SOIL JUST BELOW WALL IS LIGHT TAN ALMOST YELLOWISH IN COLOR W/ STREAKS OF REDDISH SAND. BELOW THIS LEVEL THE SOIL IS GRAY CLAY WITH STREAKS OF REDDISH SAND; THIS LEVEL ALSO IS FILLED WITH MANY STONES RANGING FROM SMALL PEBBLES TO LARGER STONES, C. 0.05-0.17m. A SOIL SAMPLE WAS TAKEN OF BOTH SOILS. ONLY MATERIAL WAS ONE TILE FRAGMENT AT DIVIDING POINT BETWEEN THE TWO LEVELS. A LAYER OF STONES AT THE LOWEST LEVEL ARE HEAVILY CONCENTRATED AND MAY BELONG TO A PAVEMENT. IT HAS BEEN SUGGESTED BY THE CHIEF EXCAVATOR AT THE SITE THAT THE UPPER LEVEL OF SOIL MAY BE A LAYER OF SAND PUT DOWN DURING THE CONSTRUCTION OF THE WALLS.

Δ 1 (N'-3)

CARRIED OUT A SMALL SOUNDING TO DETERMINE WHETHER WALL A OF ROOM 1 JOINS WALL 2. WALL A CLEARLY PASSES UNDER WALL 2. APPEARS TO BE A PAVEMENT NORTH OF WALL 2 COMPOSED OF SMALL STONES AT THE LEVEL OF WALL A. WALL A MAY HAVE A BREAK IN IT OR TURN, FURTHER WORK IS NECESSARY.

Δ 1 TEST SQUARE A - SOIL SAMPLE

SOIL SAMPLE TAKEN OF BLACK SOIL OF WHICH THERE WERE SEVERAL STAINS THROUGHOUT THE AREA. PURPOSE OF SAMPLE TO DETERMINE WHETHER BLACK COLOR IS DUE TO HIGH CARBON CONTENT OR NOT. CHARCOAL LENSES AND LIMBS PRESENT IN AREA OUTSIDE OF THE BLACK STAINS. SOIL IN A GRAY CLAY MATRIX WITH STREAKS OF RED SAND, PEBBLES, AND ROOTLETS PRESENT. BLACK SOIL CONCENTRATED IN WESTERN 0.90 m. OF AREA. -1.20m. FROM N'-3 (-7.71 m.)

drawing 35.36

Δ 1 (N^{1-3,4}) LEVEL 4 - JUNE 17, 20, 1977

173

FIREPLACE 1 - SECOND CARBON SAMPLE : SMALL LENSES WITH SOME LIMBS . ROOTLETS PRESENT. POTTERY ASSOC. WITH SAMPLE : BLACK GLAZE FRAGMENT, COARSEWARE, AND A FRAGMENT OF A SHELL.

CARBON SAMPLE FROM EAST OF ROOM 1, BATT 5. (-8.85[±] measured from N¹⁻³) LARGE LIMB WITH SOME LENSES IN A MATRIX OF GRAY CLAY WITH SOME SAND. NO ROOTLETS PRESENT.

EXCAVATION OF FIREPLACE 2 - OPERATION CARRIED OUT TO DETERMINE EXACT FUNCTION OF "FIREPLACE."

LEVEL 1 CONSISTED OF CLAY MIXED WITH SAND AND CHARCOAL FRAGMENTS. THE SOIL IN A. (cf. drawing) has a blacker hue than the other soil in the fireplace - black color may be due to a higher concentration of carbon. CHARCOAL IS VERY SCATTERED, SMALL LIMBS AND LENSES. BOTH CARBON AND SOIL SAMPLES WERE TAKEN FROM A. SEVERAL FLAT STONES, B. NEAR THE SOUTH WALL APPARENTLY FELL INWARD FROM A POSITION ON THAT WALL. THE SOUTH WALL OF THE FIREPLACE SEEMS TO BE PART OF THE WALL OF A STRUCTURE; WHILE THE EAST WALL OF THE FIREPLACE APPEARS TO ABUT ON A CROSS WALL. LEVEL 1 OF THE FIREPLACE RANGED FROM 0.09 - 0.03 m. in depth WITH THE DEEPEST AREA BEING IN THE NORTH ~~WEST~~^{EAST} CORNER, A. AND THE LEVEL IN THE MAJORITY OF THE FIREPLACE BEING 0.03 m. ACTUAL LEVEL OF LEVEL 1 = -1.85 m FROM N¹⁻³ (-7.71).

LEVEL 1 CONSISTS OF SOIL DOWN TO THE BASE OF THE LARGE STONES IN THE INTERIOR OF THE FIREPLACE. IN ALL AREAS OF FIREPLACE EXCEPT A. SOIL WAS REACHED WHICH WAS LIGHTER LIGHTER GRAY IN COLOR WITH STREAKS OF REDDISH SAND. A. REMAINED ~~BLACKER~~ BLACKER IN HUE. AREA C. SOUTHEAST CORNER, SEVERAL PIECES INCLUDING A LARGE NECK FRAGMENT OF A COARSEWARE HYDRIA. FOUND IN AND AROUND ROCKS IN THAT AREA. FRAGMENTS ARE ORANGE IN COLOR AND ARE SIMILAR IN SHAPE BUT NOT COLOR TO FRAGMENTARY HYDRIA FOUND 2.60 m. EAST OF FIREPLACE 2.

LEVEL 2 - ATTEMPTED TO TAKE DOWN A. TO DETERMINE IF FIREPLACE HAD A FLOOR. THIS EFFORT WAS THWARTED BY WATER. THUS THE EXCAVATION HAD TO BE HALTED UNTIL THE INSTALLATION OF THE PUMPING SYSTEM. A SAMPLE OF THE CLAY IN A. WAS TAKEN. IT CONSISTED OF GRAY CLAY WITH SOME CHARCOAL LENSES. ROOTLETS AND PEBBLES ARE ALSO PRESENT IN THE CLAY. AT THE SOUTHERN MARGIN OF A. UNDER THREE ROCKS A LARGE COARSEWARE BASE FRAGMENT WAS UNCOVERED. THIS BASE MAY BELONG TO THE FRAGMENTARY HYDRIA FOUND IN C. SOIL SAMPLE TAKEN FROM CLAY BELOW ROCKS WHICH WERE REMOVED.

Level 1 (to tiles)

drawing 21 A,B

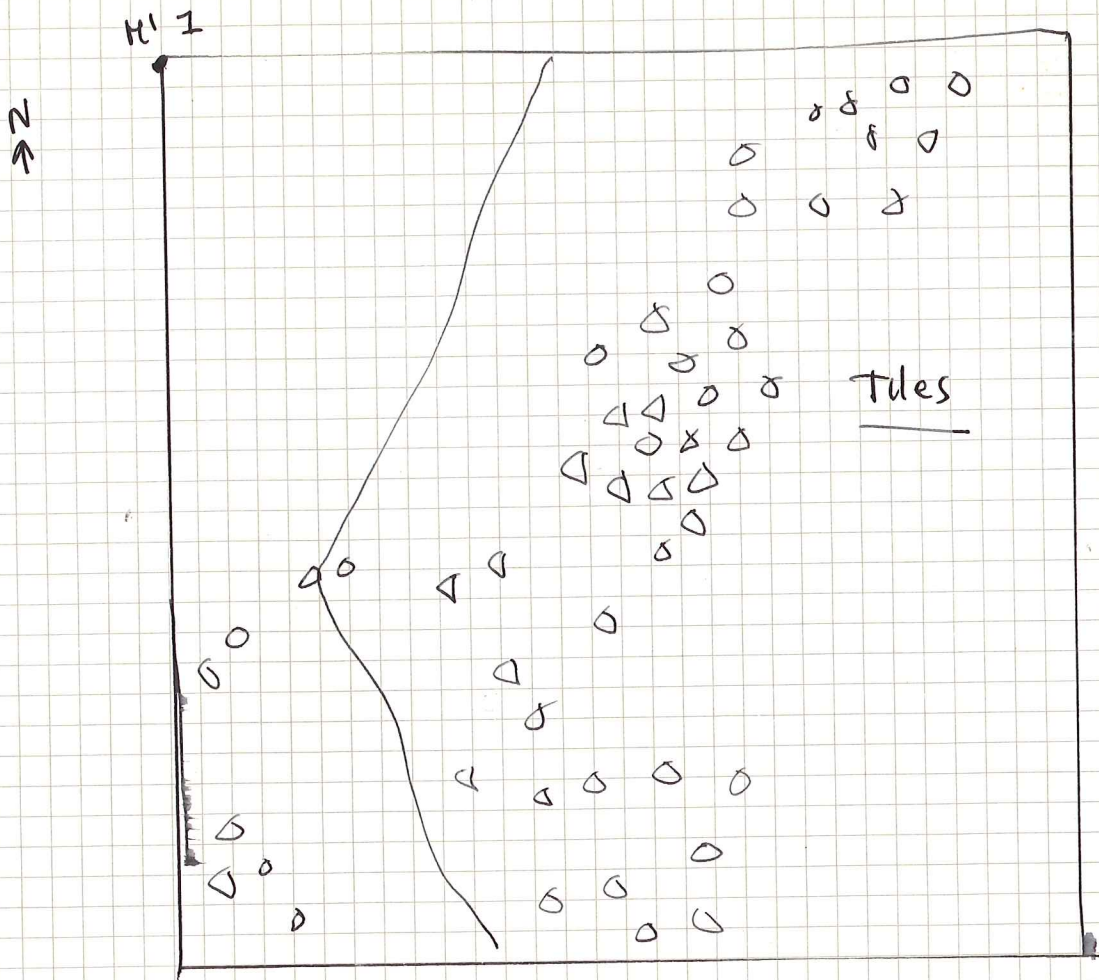

M1

P2 53
57

(-8.26
from M1-7)
H44) P25

June 13, 14.

M1

Level 1, Dark earth

Coarseware.

Uniform unguentarium base.

P2 531

Tiles in situ in the center of the square + in northeast. Lots of rocks with tiles.

571A

June 15

(-8.26

Level 2.

Under the tiles.

from M1-7)

#44)

P2 532

A large tile + rock fall composed of large chunks of tile + large rocks, possibly a wall (S) can be found here, but at the moment it looks like a large fall of rocks + tiles. (Track tiles - possibly Roman)

The material taken from + slightly under these tiles is called from level 3, scanty material - pieces of bone, bone-ribbed fragments. very little material

Level 3.

P2 597 55

drawing 22

578P
579P

598M

June 13, 15, 16

A1-5Level 1

578P little material

579P 580P

level 2 - circa 50 cm below level 1, at the top of which is a large
~~area of cut in~~ a cut limestone slab.
 This level is of lighter earth, full of gravel + small stones in the NW
 tile fall + large architectural fragments at the bottom.

level 2 deepest in the east.

598M

level 3 - (excavated only lightly) under the fall + fallen masonry. (many
 masonry fragments note squared blocks + column fragments.)

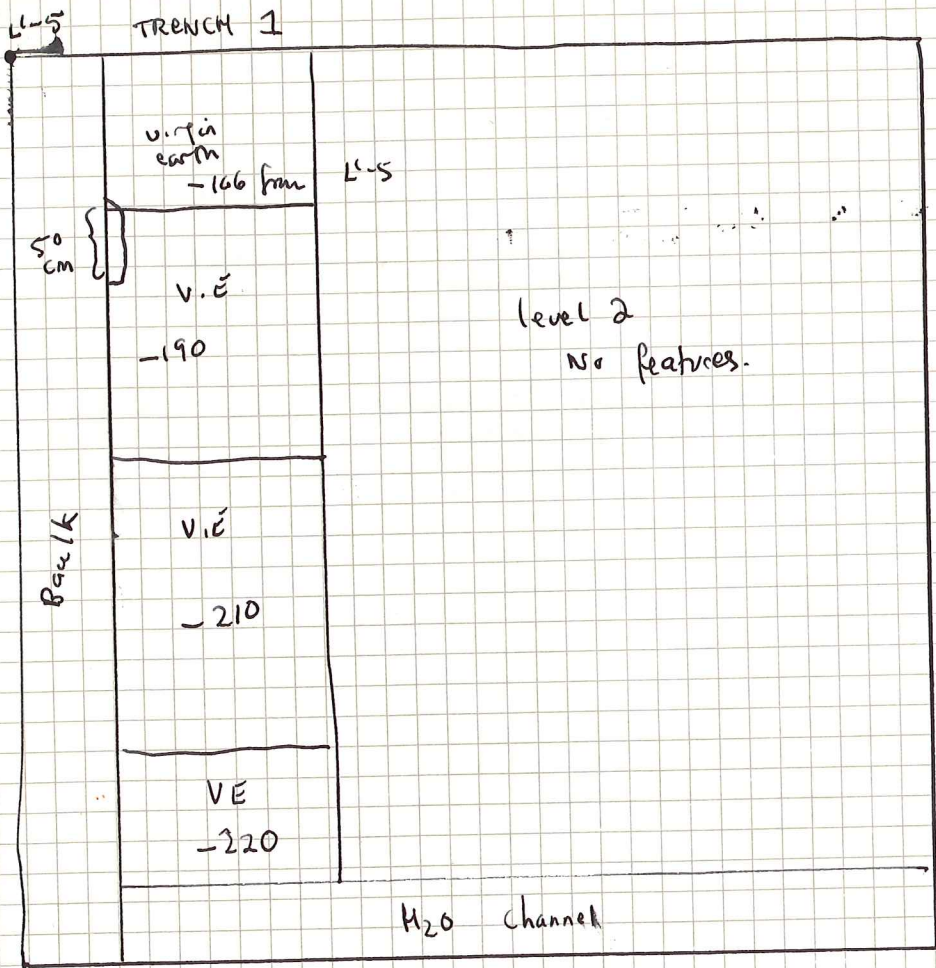

Elevations - Trench 1.
 From L-5
 level 1 -82 Dartsen's
 level 2 -112
 level 3 -152 (beginning)

drawing 23, 24, 25

Level 3

level >

L1-5

June 15. June 20.

~~Levels;~~

181

Level 1.

Coarseware mostly.

600P

Level 2.

June 21, 22

light brown soil, gravel

in this square a small trench 1.50 x 4.50 approx - Trench A.

Stray fragment.

terra sigillata fragment

metal lump

grey ware.

Level 3

level >

Dattata 2.

Dry orange soil

Virgin earth reached at -166 in the north - soft sandy orange soil.
to the south the virgin earth has not yet been reached.

material:

coarseware

greyware

black glaze.

ribbed fragment.

several large-medium flintstones found in south virgin soil eventually reached
in the entire trench

levels of virgin soil from N1-5

From N-5

- 166

- 190

- 210

- 220

material found after virgin soil reached but in the north a called
level > Dattata 3.

lacunary - pyramidal

coarseware

black slip sherds

1 large stone in situ at NE end of trench.

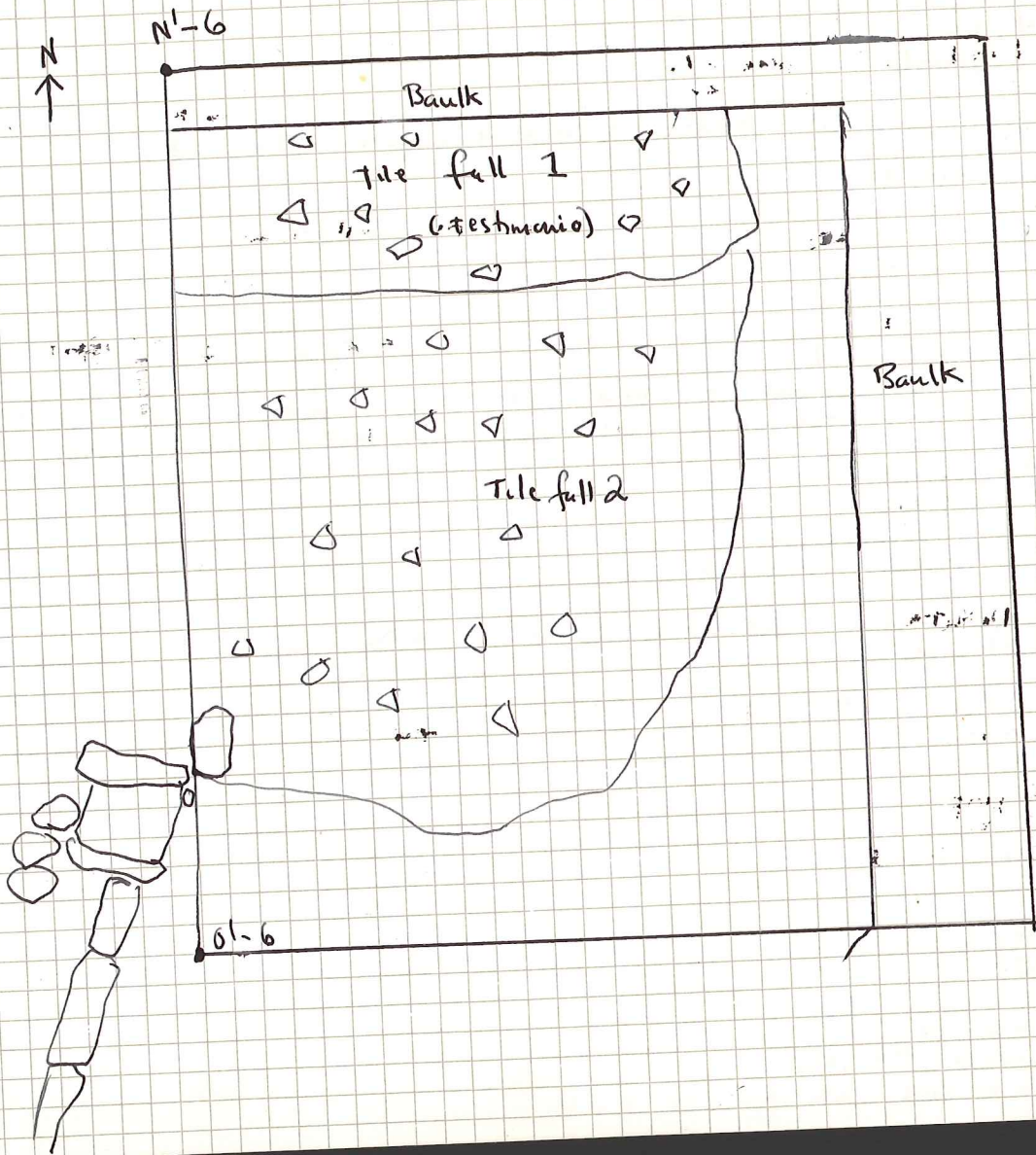

drawing 32

N1-6
Level 1

N1-6

Note these
Also see layout
Clonusy - like those in
M11 - (Roman?)

101

N1-6
Level 1. June 20,
Dark earth.

N1-6 01-6 level 2. June 21.
little material 22 These squares are being excavated as one + the
material will be labelled from both of them close.

Note these
tiles are large +
clay - like those in
N1-1. (Roman?)

level 2 Dattata 2 - ends with tile fall found in N1-6 N. -80 from N end
of trench.
little material
relief decorated tiles - altar fragment - iron + bones. 18 cm long. - 92 from
found - 80 cm from ground level of N1-6. N1-6
180 cm from NW corner + 60 cm to the east. Same level as
tile fall in N1-4
(-93 from
N1-6)

~~181~~

level 3 under the tiles found in level 2. Datt 2 at NW end.

coarse ware
Bronze nail
Iron nail

level 3 Dattata 2 June 23.

617T Stechette fragments from NW end - 123 from N1-6
542T Head of sally 3 meters from N1-6 - 144 from N1-6
small votive cup.
more fragments.
black slaty
coarse ware
much material.

N1-6 01-6
Level 3 Delta 3. - to the level of the blocks (wall) in 01-5 N1-5
618 T
619 T structure fragments

Level 4.
621 T

drawing 31

Lead
Jun

Jun

JUNE

Cleaning of walls:

June 16.

M¹-3

wall G.
cleaning along west face of wall G reveals a lower course of conglomerate blocks as found in O¹.

material from cleaning - black slip frags, including a lekythos foot.

June 21.

In cleaning of intersection in M¹-4 of walls 10a¹ and wall 2, a skeleton was found - 9 cm from top of walls in this corner. The skeleton is in good condition, lying in a flexed position with the head facing east. It appears from the pelvic structure to have been a woman, 40s, long femur. An adult. No ribs were found except for 1 nail (corroded iron) + a few shreds.

The skeleton is on its side with the one hand visible but towards its head. There are tiles directly under the right leg of skeleton + the skeleton's left foot is covered by the tiles from wall 10a¹ which have slipped over it. There is also a large tile directly associated with the left leg. No tiles covered the skeleton + the earth associated with it does not seem different from the earth in this area at this level.

The tile fall that is heavily concentrated in this region seems connected with the skeleton. To me however, the skeleton appears to have been placed in the corner, not to have fallen there. However, the tiles must have fallen almost immediately after the body was placed there. It is not yet known the depth of the walls or if the skeleton lies on a special floor.

JUNE 22, 23

WORK IN CLEANING AND DEFINING WALLS + TILE FALL IN SOUTHEAST CORNER OF M¹-2
SEVERAL LARGE BASE FRAGMENTS OF BLACK GLAZE SKPHOI FOUND ALSO A FRAGMENT OF A PYXIS OR HYDRIA,
FRAGMENT OF SMALL, SHALLOW BLACK GLAZE BOWL, CONICAL LOOMWEIGHT, AN AMPHORA HANDLE, A PYXIS LID,
AND NUMEROUS COARSEWARE AND BLACK GLAZE FRAGMENTS. ALSO FOUND WAS AN AT PRESENT
UNIDENTIFIED OBJECT WHICH RESEMBLES A SPOOL OF THREAD. IT HAS A HOLE THROUGH ITS CENTER
AND THE INDICATION OF HANDLES AT ITS SIDE - CF. PARALLEL IN METAPONTO MUSEUM.

JUNE 23, 1977 WALL CLEANING, CONTINUED

M¹-2

AREA SOUTH AND WEST OF WALL A CLEANED. WEST END OF WALL CLEARLY DEFINED. HEAVY TILE FALL IMMEDIATELY NORTH OF WALL A. TILE FALL EXPOSED TO THE SOUTH AND WEST OF WALL 6 TO CLARIFY RELATION BETWEEN THESE TWO ELEMENTS AND WALL 5, RUNNING E-W IN M¹-2.

LEVEL 3 - TILE FALL AROUND WALL A

FINDS: SOME SHERDS MIXED IN WITH THE TILES. Pz. 77.762P. Pz. 77.791B. Pz. 77.792T
MINIATURE LEKYTHOS WITH CRISS-CROSS PATTERN (TOP MISSING) FOUND ALONG THE SOUTH EDGE OF WALL A, BETWEEN FIELDSTONES. LOCATION: 0.25 m. FROM WEST END OF WALL.

SEVERAL PHOTOGRAPHS TAKEN OF FIND IN SITU. Pz. 77.615P

LEVELS: WALL A - TILE FALL OVER AND AROUND WALL. SAME TILE FALL IS BELOW WALL 6, AND OVER WALL 5 (RUNNING E-W IN M¹-2, EXCAVATED IN 1976).

BELOW TILE FALL: LARGE CONCENTRATION OF SMALL PEBBLES THOUGH NOT THICK ENOUGH TO CONSTITUTE A PAVEMENT. RATHER A WASH FROM FLOODING OF AREA?
VERY FEW SHERDS BELOW TILE FALL Pz. 77.790P

