

1976 ?

J Carter



pignastyl
5

Wales

N'-1, N'-2

Field stone wall below
"NS Stone wall" appears
in gap. Has different orientation
there is an extension to the
East which is interrupted by
after 60 cm. It contains
two pieces of pudding. There
are some rough stones as
well as ^{rough} field stones as
in NS sector. This wall
is respected by the pavement
of field stones found to the
East in N'-2 and to north
in N'-2. And all over
to the South, but not to
the ~~East~~ ^{West} at this point.

Field stone pavement is
found farther to the west
in O'-1

East-West Field Stone
wall. O'-2 O'-3

at West end there is a
projection to the north which
stops after 50 cm. The wall
is composed of smooth field
stones, rough ones, and
pieces of pudding as is
wall in N'-1

Wall is 42-45 cm wide
while NS Spur in O'-2 is
35-38 cm wide. The dimensions
of wall and spur in N'-1 are
the same 45, and 38

Pavement of field stones is

0-2 S of EW field stone wall many smaller stones ~~to the N~~ This is Room alpha - The east limit of the room is a NS field stone wall. The pavement stones short of this wall, but apparently runs under the EW field stone wall

To the ~~west~~ west of EW field stone wall; the pavement to the west is all large stones. A meter to the west of the NS wall which divides rooms Y and Z the pavement is sharply differentiated and becomes fine ~~the~~ stones. It

runs out however before
reaching the NS wall -

NS wall is 0'-2

to the South of EW field stone
wall, it is composed mostly
of smooth field stones and
is 40 cm wide. It tapers out
after about 60 cm. The EW
wall apparently passes over
it. To North of EW field
stone wall the wall is 45 cm
wide, has long flat stones
A similar one is found in
EW field stone wall to
East of intersection, under
the ~~EW~~ rounded field stones
of EW wall, could this be

the SW corner of a
previous structure

Roof tiles in 0'-2' south
side lie under conglomerate
blocks and field stones, but
rest on top of clay which
is well above the level of
field stone pavement. These
tiles were removed July 29
1976 ~~1976~~

Apparent NS wall
consisting of blocks of
limestone and field stones
apparent makes an angle
with the conglomerate
blocks lying on top of the
tiles.

to the east of the Conglomerate
Block a pavement of
medium sized field stones
well below the level of the
Conglomerate block, ~~and~~ but
more or less on the level
of the medium sized field
stone floor in O'-2

In S corner of O'-2
is section of pavement (?) of
larger boulders which
is higher than the ~~small~~ ^{medium}
field stone floor in O'-2 apparently
and much higher than the
field stone pavement in P'-2
(Sounding 5, 1975)

Hilltop - Wales

Rectangular building

SW corner A13

Cornerstone is a block of
Conglomerate 46×36
At the corner the wall was
originally 60cm wide, and
the corner stone would have
had a mitre to the west.

The S wall is closer to 65
cm wide at corner, but
narrows to 50 at 2 m ~~A~~
to east. It may be
that there are several courses
underneath what is exposed
and that the foundation
course is uniformly 65-60
cm wide.

From the inside corner
the wall extends 1.20 m
to the NE. It is uniformly
about 60 cm wide. There
is part of ^{upper} ~~lower~~ course still
in situ. — Two swales
blocks of limestone

Composition of wall is
squared blocks of limestone
and conglomerate.

At 70 from inside corner
in S wall is piece of
column. 45 cm long and
ca ^{fallen} 35 cm in dia.
The ^{fallen} tiles around this corner
respect it. apparently.

There is an opening in
the West wall which is 2.75
cm wide. Part of the
pavement of small chips
of TC were found ~~on the~~ ca
1. to south of the Southernmost
block of the north extension
of West wall. This balluta is
slightly below the level of
the tile fall, above it.
This Southernmost block is
a block of conglomerate 40 cm
wide 65 cm long. Above it
is another similar but shorter
balluta base marks of the floor
in top.

Corner stone is missing.

~~At corner~~
~~North wall~~

North Extension of W wall is
120 long measured from
inside corner. Identical to
North extension

July 16.

P'-~~3~~
Finish Batt 4.

P'-4

Begin Batt 4. Under the level of the special collection of pottery found on July 9 is gravel layer and at some points under gravel are a few tiles.

P'-3

Go slightly below level of batt 4 with trowel. In area in which special

Collection was removed
on July 9, is more
archaic material, "Tonic
Cup", large plates, etc.
Call this ball 4A

O'+1, P', 1

Two ballulas down to
the tile for which was
uncovered in the western
half of N', 1. The tile
fall is very uniform in
O', 1. tends to peter out
in P'-1. field stones
mixed in; one squared
stone.

Battuta 5

P'-3. Finds: near
conglomerate blocks where
plaque found on July 9.

TC ~~stated~~ figure, head
of bearded man, small
white curio. ~~this~~ more precisely
between northernmost of
tilted blocks of "pudding"
stone in P'-3 and the
testimony.

To the east of the
conglomerate blocks is
circular patch of dark
soil with several large
field stones on it. Hearth?
or plug of stone?

P'-4 but 5 only just
~~partially~~ begun?

Walls

0'-3 E-W field stone wall.

B'8 Roof tiles

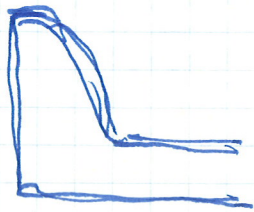
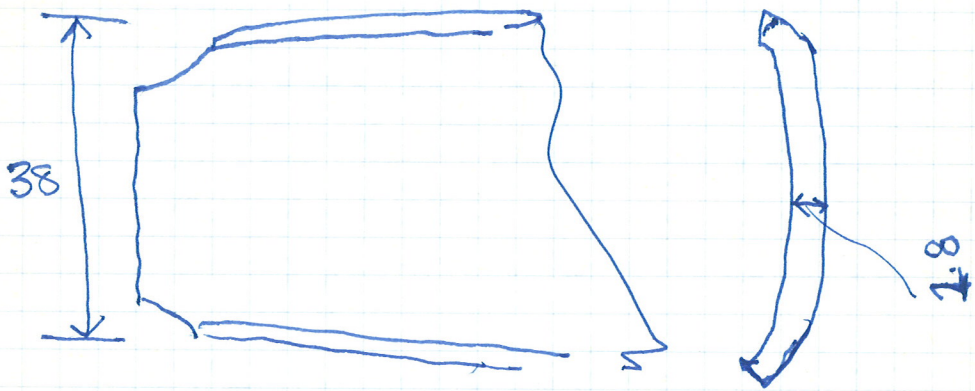
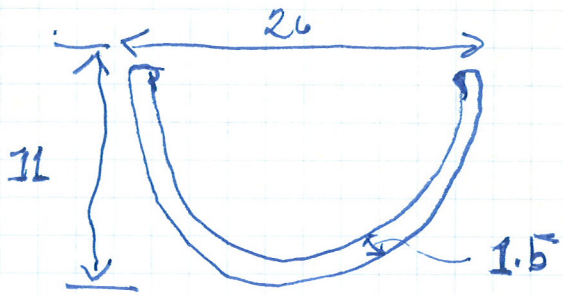

also put join
tiles with
high ridge

Walls.

C'6 - two blocks on level belonging to wall
pri

58 cm wide x 74 cm long

58 cm wide x 52 cm long

The larger block appears to be limestone, while the smaller is a conglomerate very fine, some shells.

D'6 - Two stones in line

48 cm wide x 56 L

- northern

northern has the same dimensions, however is a coarse conglomerate with many shells.

The conglomerate of southern
block resembles that of
northern of two blocks in
C'6

Walls

C'9, B'9 Wall Gamma East

starting from southernmost
of conglomerate blocks.

58 W x 82 L

68 W x 94 L

65 W x 94 L x 27 T

67 W x 98 L x 30 T

63 W x 90 L

60 W x 104 L

block displaced to W

46 W x 90 L

blocks further to north in A'9?

46 W x 60 L

45 W x 40 L This stone

is a more compact sort
a limestone) with no
shells.

D'8 SW corner of ~~M~~ M
shaped building

57 W x 94 long Conglomerate
like that in YE

Foundation course in C'9
is 65 W

E'13 End of West Wing
below kiln. ~~to E~~

Wall to east of Praeforn.

62 W x 88 L x 40 T, same
conglomerate as monumental
blocks in YE

W. of Praeforn.

Upright block

66 W x 96 L x 48 T, same
conglomerate as in mon. Wall

highest course, height
63W x 93L x 30T

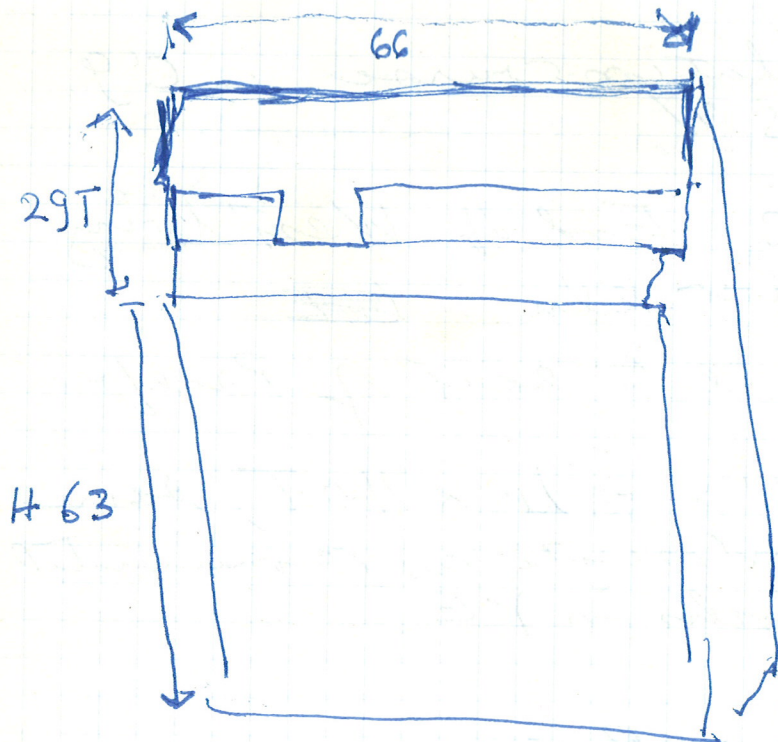

highest course, horizontal

63W x 93L x 30T

next lowest course

62W x 82L x 50T

both stones are of same
Conglomerate

Fill from Kiln

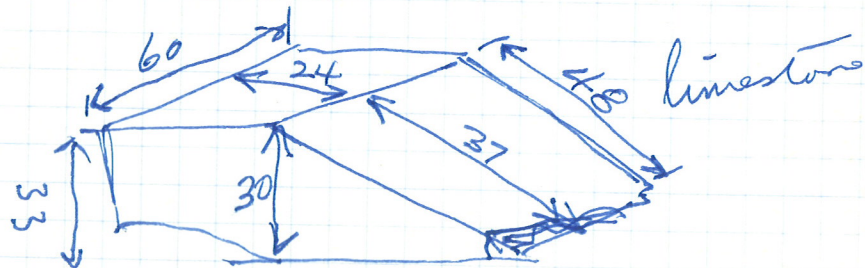
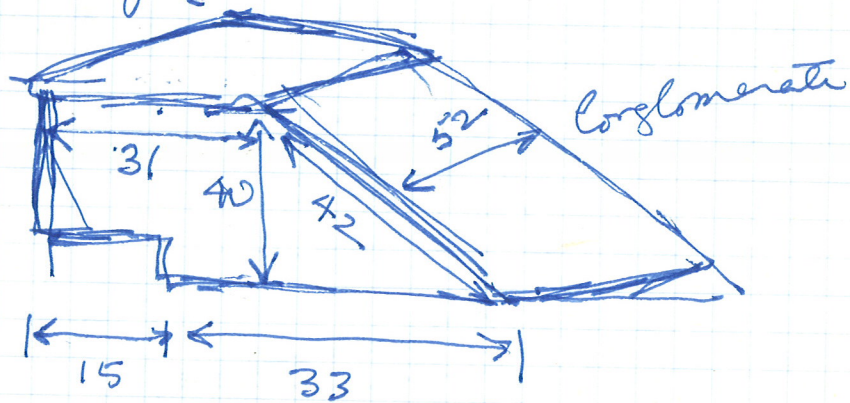

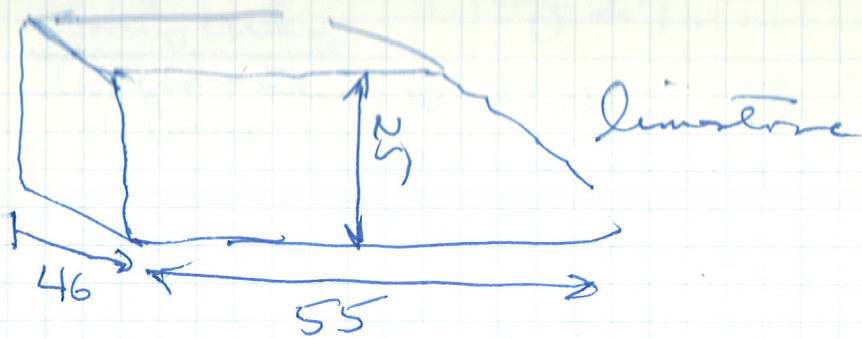

limestone block with
clamp holes in it.
33 cm wide

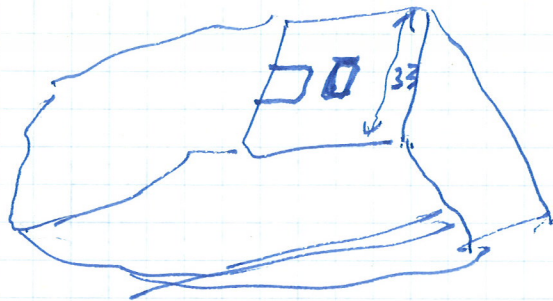

San Blas May 21.

Sunguero
Conglomerate
blocks.

W	L	Th
68	96	30

limestone
blocks

H	W	L
62	40	127

Conglomerate

Th.	W	L
30	68	96

limestone

L	Th.
116	40

Thunpse on
hill →

Column diam, 0.41
dia

limestone block

W	L
65	125

Tees

A 13 outside γw

From nearby complete large pen lines
there will end a line in a line
close to wall γw . Test are
express shown

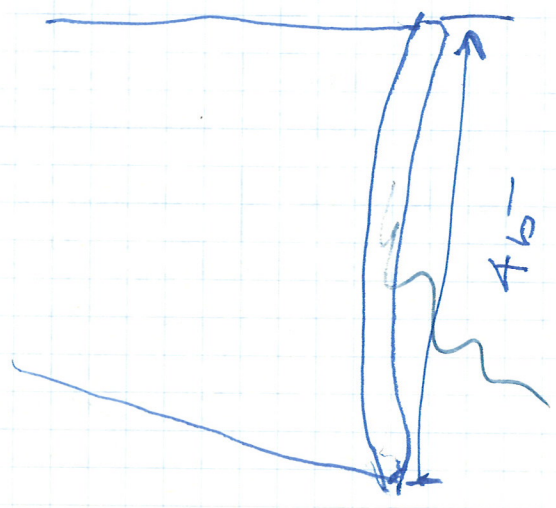
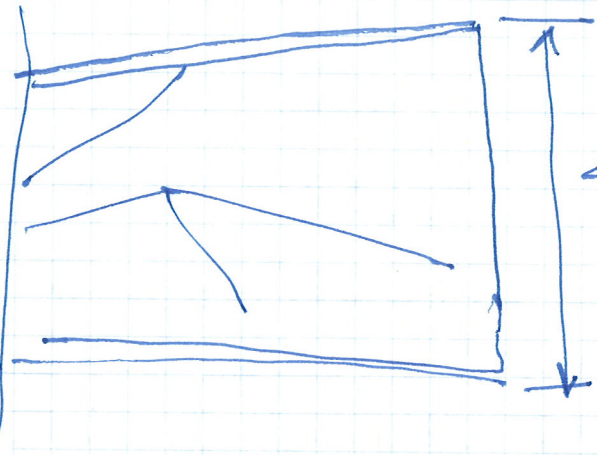

Walls.

A' 13

Blocks of conglomerate

47 W x 58 L

49 W x 60 L

Type of construction :

Above the squared blocks is mixture of smaller stones with flat surface only on outer face. The ~~are~~ interstices are filled with tiles. Conglomerate and chunks of "pudding" same type of construction as in B'12



Walls B' 12

Lowest course composed of
field stones and small fragments
of tiles. Rests on sandy gravel.
Next a leveling course
of tiles. On top of that two
rows of squared blocks.
Only the outer face is always
flat.

limestone blocks.

26 W * 30 H x 43 L

limestone drums.

24 D x 22 H.

Smaller blocks of conglomerate
with broken tiles used for filling

C' 8 Omega Wall?

part of fluted column reused?

Tiles

B'12

Large collection of "cups"
or rounded cover tiles

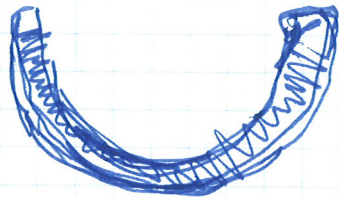

Some flat pan tiles with
high ridge

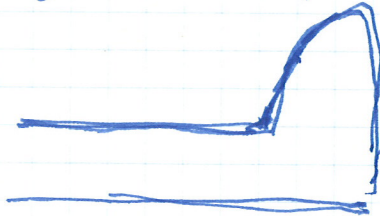

Some of the big pan tiles

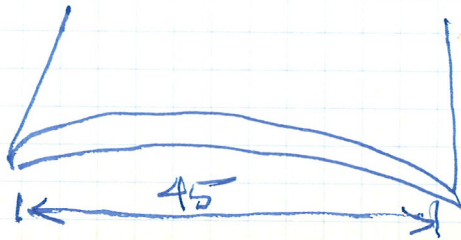

C10

Wall or T shaped building
tiles used in foundation course

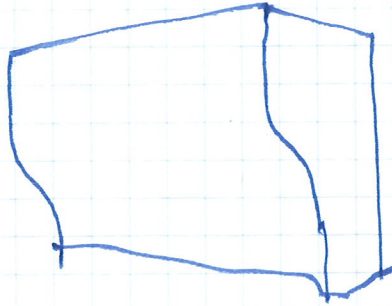

Walls. A'10 / B'10

limestone ~~wall~~^{layers} in alpha Dully

48W x 106 L

48W x 73 h

June 22

O-3

in North east corner at
level of stone pavement

FIND.

Small votive vase

South of E-W field stone
wall ^{and east of NS conglomerate wall} at level of the
wall, the left breast
of a votive figure of the
early type.

FIND

left breast of early
votive figurine south ^{west}
of ~~E-W~~ field stone wall ^{east}
in level 3. That is below
the level of fieldstone
wall.

0'-3

FIND: Attic(?)

Cap to Nor of EW
field stone wall and
W of NS Conglomerate
wall, below level
of field stone wall

0'-3

Note, Considerable
amounts of charred
wood, sample
taken, But 0'-2,
0'-3 have lots of it.

Level 4 -

The next battuta begins at the level of the bottom of the deposit of pottery found next to the EW stone wall. The deposit is ca. 10 ~ 20 cm thick.

Level 3 ~~and~~ and 4 may overlap, as the ~~level~~ slope of the ground is uneven, rising toward the wall.

Another deposit begins in SW corner of
O' - 3

0^c-1 level 2
(second large balluta)
in grey clay, well
below level of NS wall

(Note: the large plate
found yesterday was
on a level with the
top of this wall)

FIND.

Fragments of statuette



N.B.

Large deposit of pottery removed from south of E-W field stone wall and west of NS Conglomerate wall. Includes BE keys and unglazed plate with handle.

Bagged separately

N.B.

Deposit of pottery south of E-W field stone wall and under tile fall at joint where NS Conglomerate wall passes over fieldstone wall

Handwritten notes in blue ink, mostly illegible due to fading and bleed-through. Some words like "Elevation" and "Diagram" are faintly visible.

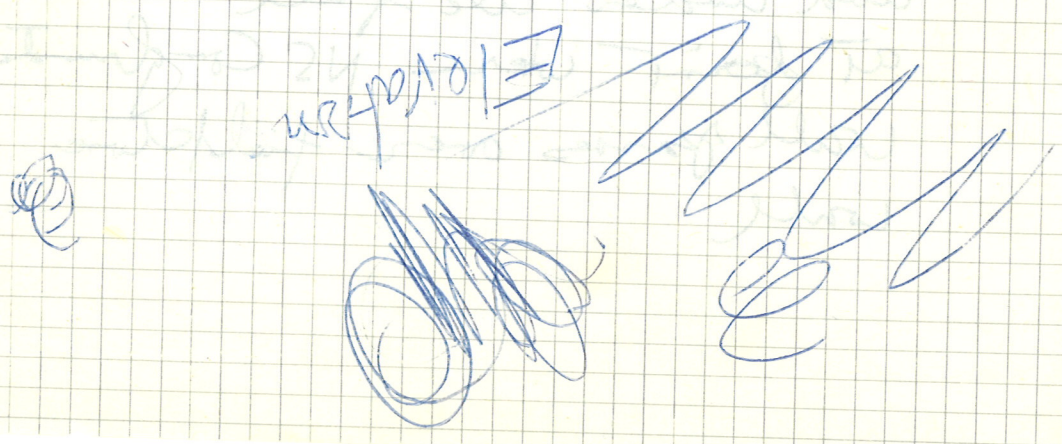

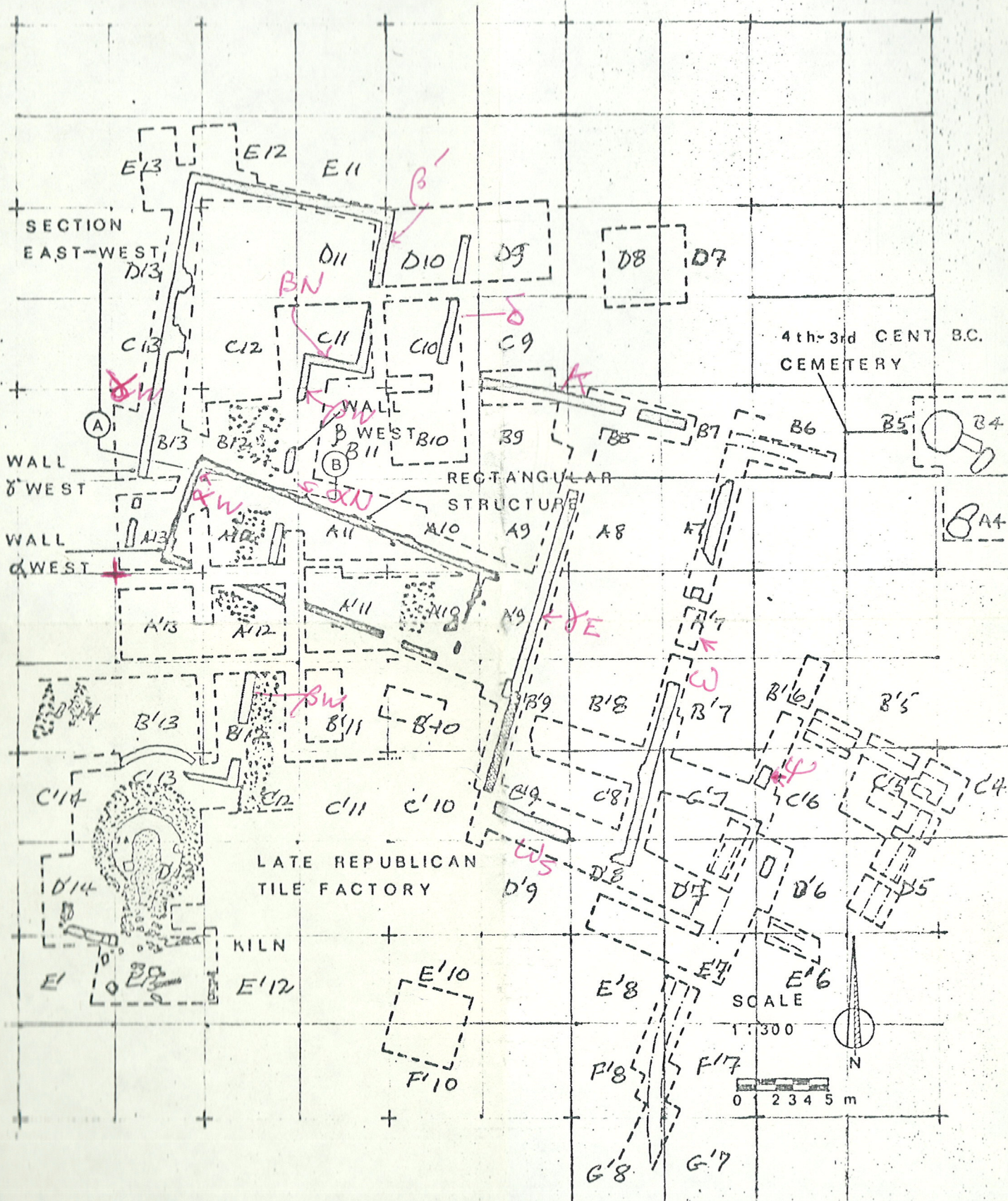

Figure 3 Plan of the hilltop site (Marino-Seavone)

