

"HILL TOP" "

1976



per richiedere un registro
uguale al presente
servirsi
di questo tagliando

Mod. 2007, 43

Registri Buffetti

FABBRICA DI MATERIALE
RAZIONALE PER UFFICIO

00149 Roma - Via di Villa Bonelli, 21
Tel. 52 67 641 - 2 - 3 - 4

Mod. 2007, 43

HILLTOP 1976

Farmhouse

Pizzica 1976.

HILL TOP 76

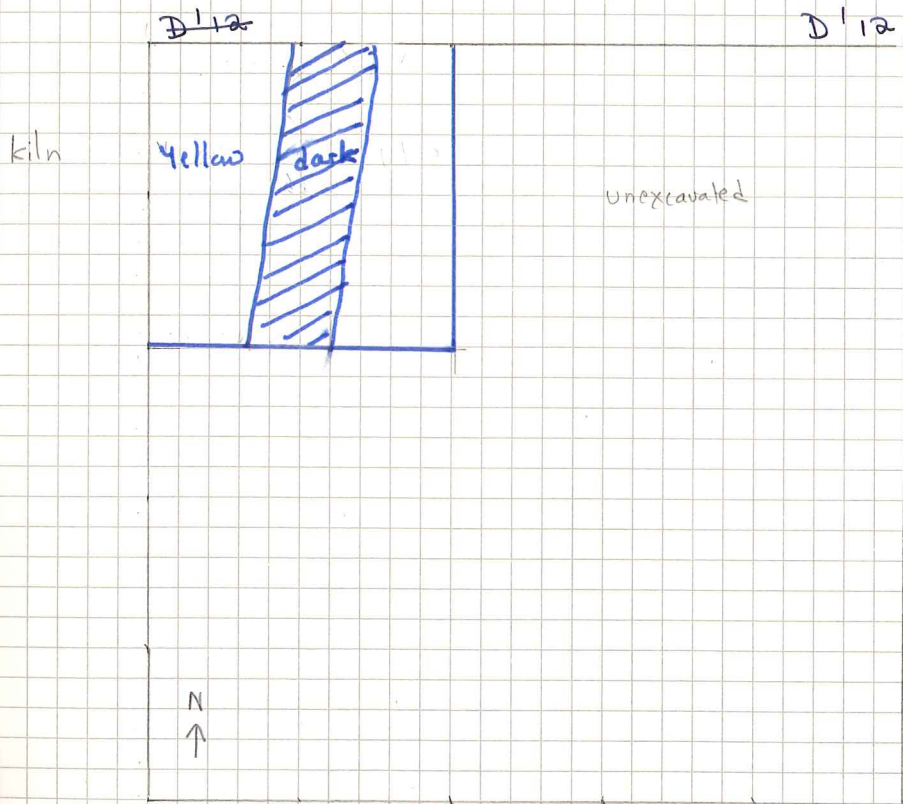

Dark = 3/3 10 yr Dark brown
 yellow = 5/3 10 yr Brown

28 May.

work began at 7 am. After removing weeds, level 1 in NW quarter of D'12 was excavated.

Pottery from level 1 - coarseware, small amount.

Level 1 was about 40 cm deep at the north and sloped to 30 cm towards the south, measured from the side of the trench.

Level 2 was made up of 2 types of earth - the same dark earth as in level 1, and, on either side of this dark earth, a much yellower earth 3/3 " dark brown. This dark earth indicates the existence of a wall which seems to align with wall y (?) west, which runs approximately N-S, discovered in 1975.

The width of the dark earth is about 50 cm.

photographs taken.

No ceramic finds from level 2.



The area covered by smooth field stones around the east of the kiln was cleaned to level 2 (This area is due west of ~~The~~ D'12, also the area north of D'12 was cleaned to remove soil accumulated over the winter.

N-S Section, E'14, West Face

→ N

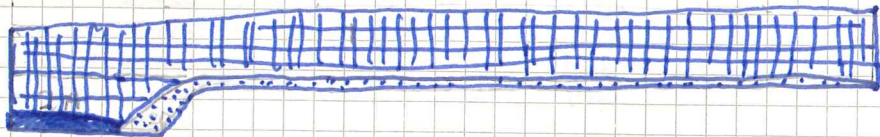
E'14



-  = level 1, 4/3 10 yr dark brown earth
-  = level 2A 4/3 10 yr dark brown earth.
-  = level 2B 5/3 10 yr brown.

Note
time of That Section does not correspond to the notes - it was not noticed at the excavation that level 2B, the level above the wall and beside it existed. The excavation of this section was confusing + needs clarification.

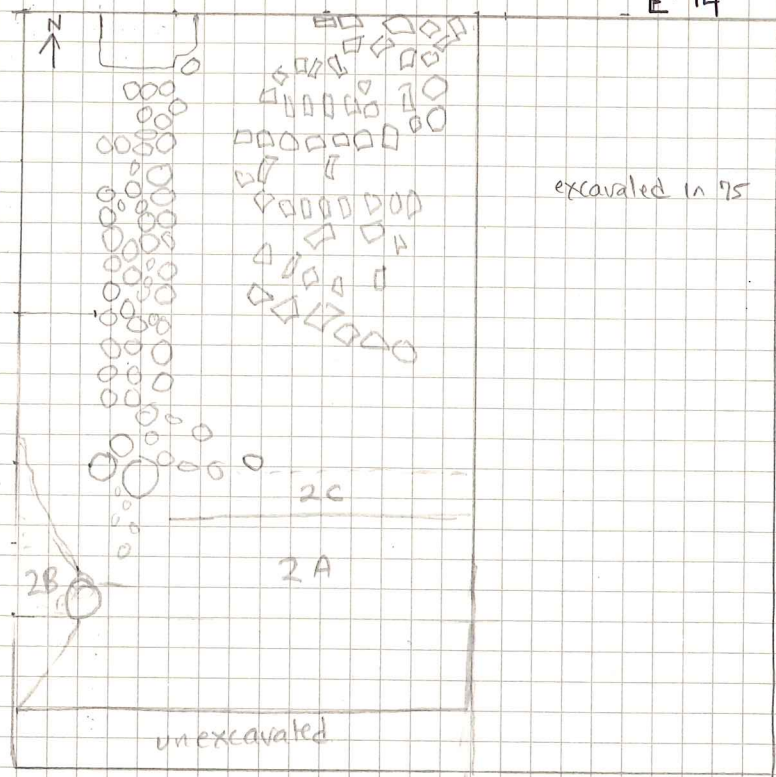
kiln →
E'14

May 28.

5

Level 1, plowed earth, removed in South part of E'14.

76.3P

76.1M

76.2M (nail)

pottery - small amount of coarseware.
Find - level 1 - small bronze coin.

May 31.

Level 1 also being excavated in N quarter of E'14, south of wall of south? excavated in 1975. This is the wall composed of large squared blocks which runs E-W and ⊥ to wall of west(?) in D'14.

Find - small piece of obsidian - level 1.

A continuation of wall of west found in NW of E'14. Also a small tile area + red earth found in NE, East of the new part of wall of west.

Photographs taken.

6/4 2.5y light yellowish brown

76.4P

level 2, yellow earth found to west of wall in E'14.

level of level 2 pottery - under tile area to the south + below level of top of wall.

perhaps there is another wall ⊥ to wall of west - since there seems to be an angle to this wall quite close to end of tile area, at 6.220 M from N-S wall. after further excavation, under the wall level gravel and virgin soil found to the west.

The continuation of the wall in E'14 consists of one limestone block at the North, 70 X 35 X 14. The rest of the wall is composed of small (10-20 cm) smooth oval stones, (as found around the kiln) and a few small irregular limestones. At approximately 2.56 M from the ⊥ wall ^{another} wall ⊥ to this new wall seems to appear a smooth oval stone + a piece of conglomerate. This tile area east of new W-S wall is interesting - there seems to be a pattern of horizontal and vertical tiles.

E'14. continued.

June 3.

7

we returned to SW quarter of E'14 + began to excavate again. Level 1 - plowed earth, being removed.

In line with js (discovered May 28) to the south are a few small stones. These stones, if they be part of the wall, extend it approximately 65 cm to the S. But since they are smaller than the majority of stones used in the construction of wall js, they may not be part of it. About 10 cm SW of this line of stones is a large round field stone, c. 25 cm in diameter.

Dark level 1 earth continues at SE.

Coarseware base + amphora base etc found in level 2, at line of wall, in hard brown pebbly earth. 76.106 - glass vessel. west of

76.32P Once level removed - level 2 is seen to consist of 3 types of soil. (see plan)
2A - Dark brown earth like that of plowed earth found in S + SE.

2B - lighter brown gravelly earth ^{south} ~~north~~ of this. This 2B earth is also found west of line of wall.

76.12P

Find - Neolithic stone in 2B west of wall js line - indicates a mixed level or intrusion.
Pottery labelled level 2A + level 2B.

Note - black glaze plate? fragment found in level 2A, E of line of wall js.

2C - This third type - is the hard yellow earth, claylike in consistency that is found east of line of wall js. This is the same type of earth found under the tiles in the NE of E'14 (previously excavated - S. 28 - S. 31) + west of wall js in the N of E'14. (6/4 2.54)

Also in level 2A - at the line of wall js - large stones - perhaps fallen from js.

Levels 2A + 2B seem to run in bands. 2B to the ^{south} ~~north~~ of 2A with a small area of gravelly yellow earth to the west of line of wall js. This is not at all clear.

1:50

June 1

9

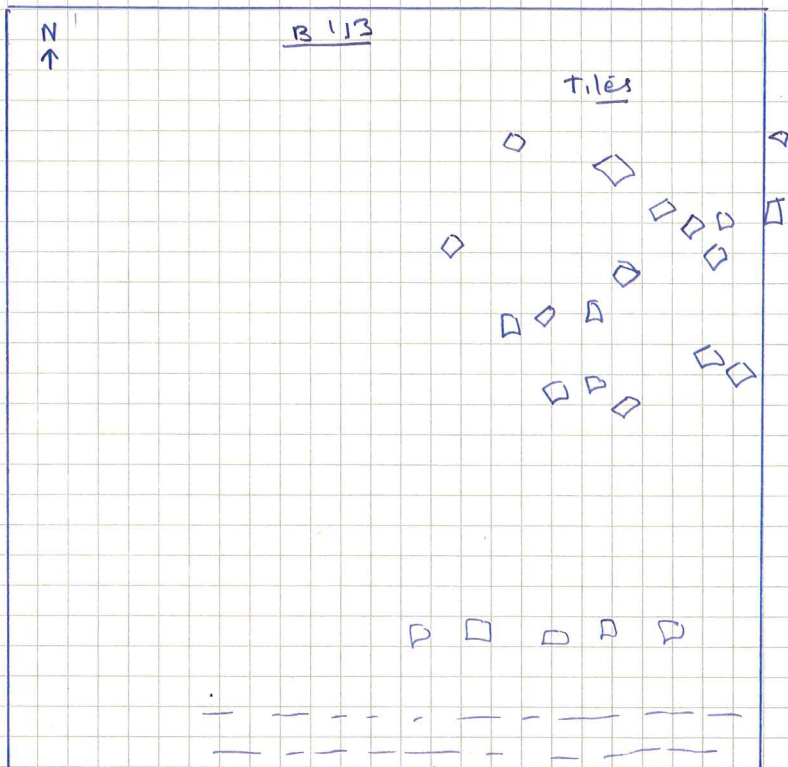

--- = dark lines

North of kiln - B 113 - B 114.

B 112
balk

The n-s balk between B 113 + B 114 is being removed - level 1 - plowed earth, coarseware.

The n-s. balk between B 112 + B 113 is being removed. Level 1 - plowed earth.

The East 1/2 of B 113, excavated to about 35 cm in 1975 & again excavated to remove level 1.

under level 1 in this E 1/2 of B 113 - a tile fall.

pottery from this level 1 on top of tiles placed in bag labelled B 113 E 1/2 + balk between B 112 + B 113 - level 1.

Bones also found.

The E-w balk between C 114 + C 113, B 113 + B 114 excavated also - level 1 removed - plowed earth.

level 1 in n-s balk between B 113 + B 114 is deeper at the north

June 2.

cleaning of level 1 in E 1/2 of B 113 (including n-s B 112 + B 113 balks), a row of tiles south of tiles found yesterday - is revealed. This row seems to parallel the 2 dark lines of earth to the south (B 113 - C 113 - E-w balk area) which seem associated with the kiln and the fire bricks which are also aligned with these dark lines.

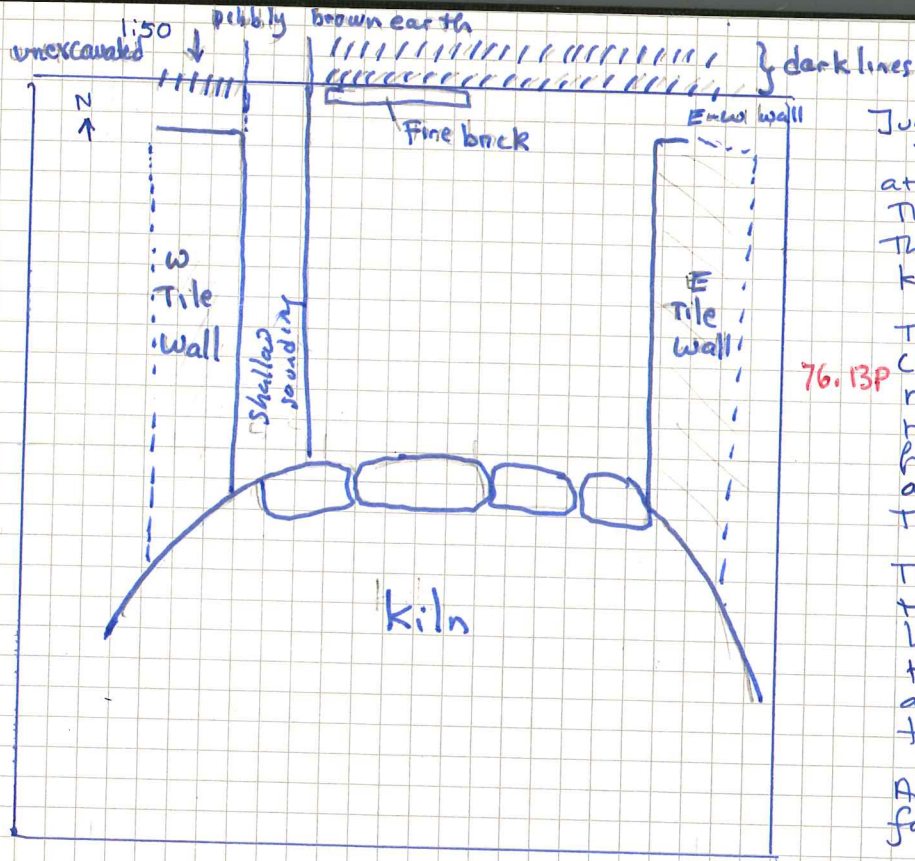

C113

11

June 3.

The tiles between the 2 parallel rows of tile at the N entrance to the kiln are removed. These are the tiles at the level of the top of the kiln. The large blocks at the N end of the kiln.

The dark earth under the tiles ~~is~~ removed (levelled). more tiles, very large field stones are removed. Are large or larger than the field stones used in construction of walls? and the circumferential path? around the kiln.

76.13p

The tile rows, which run parallel N-S from the kiln, now are found to consist of several layers (at least) of tiles which form a tile wall. (some make up as kiln. This wall at present is 20 cm in depth from the top of the tiles.

Around the large blocks of the kiln is found very dark red-brown earth.

pottery from this level - coarse ware.

76.14p Level 2 - sandier, finer light brown earth, at the level where the tile wall ends. c. 25 cm below the tile surface. Pottery from this level includes a rim.

The area excavated at level 2 is extended N up to line of fire-bricks (about 25 cm south of this line)

pieces of glass found in level 2 near west tile wall. including a large rim fragment.

As we go down in level 2 - fewer tiles + large stones. Material seems fairly consistent - thin walled pottery, coarseware.

12

Section N-S above West wall (East face)

cl 13

→ N

N-S Section above West Tile wall (East face)

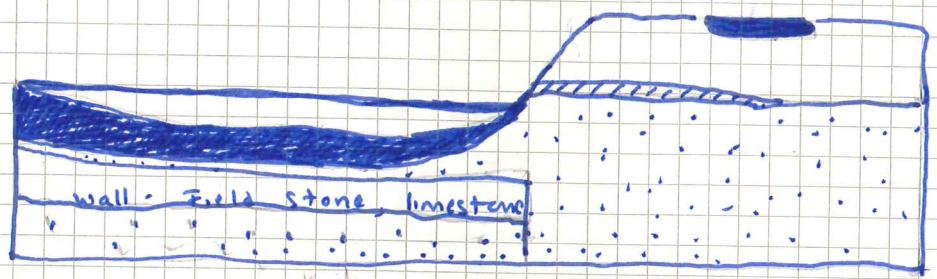

- 
- 
- 
- 

Dark earth 4/2 10yr dark grayish brown
 yellow claylike 6/4 2.5yr light yellowish brown
 brown pebbly earth 4/3 10yr dark yellowish brown
 - Sandy yellow with small stones

Scale

June 4. The E-W baulk between C113 + B113 where we excavated yesterday is being straightened.

The north 1/4 of C113 (which includes the NE portion of the ^{E-W} baulk between C113 and B113) is being excavated to see if the west tile wall of kiln forms an angle with an E-W wall, known only as a dark band of earth visible in the E-W baulk of C113, C114 B113, B114 and as a wall near East Tile wall.

what we seem to have is the 2 tile walls which run N-S forming a right angle with east west walls, leaving the area between the walls as an entrance.

We are also trying to determine the relation of the fire bricks north of and \perp to the tile walls.

After the E-W baulk between C113 and B113 is taken down to the level of the top of the tile walls, photos taken.

Then this N 1/4 of C113 is excavated:

level - E-W dark line is visible in section running through yellow level.

also dark line visible at height of tile wall.

reddish earth visible in line of fire-bricks + tile wall.

reddish tile earth + tile fragments in line with firebricks, otherwise hard

yellow + dark brown soil.

At about 13 cm from fire-brick level - the red earth is visible in East 11a but not in west, where the soil is yellow + sandy. The black line is no longer visible except in extreme south east.

Top plan - 13 cm 1M x 1M Level 1 =

~~7.6.63~~

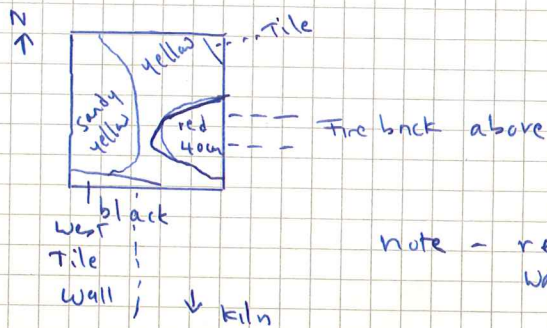

note - red earth stops almost at line of west Tile wall.

note - levels here correspond to battutas - not to usual level = plowed earth, etc.

June 4 c13

15

In the next battuta c. 5 cm - the earth seems darker brown, less sandy, more like earth at level 2 in c13 excavated yesterday between tile walls.

Level 2 - Top Plan 18 cm.

76.63P

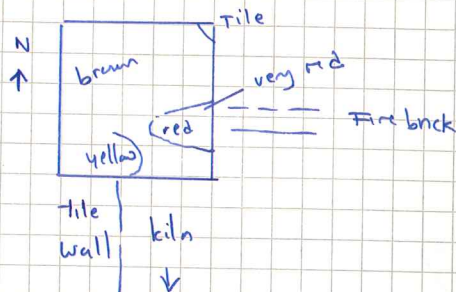

Level 3 - earth seems uniformly brown + pebbly over entire area. c. 21 cm. here black glaze piece found.

76.64P

Level 4 - Same soil as in level 3. 1 piece of pottery - combined with level 3 pottery, we are now at the level reach yesterday in c13 area bounded by tile walls.

76.74P

now a narrow sounding (c. 50 cm in ^{N-S} width) made along side of west tile wall - the brown from this sounding (level 2 - seems almost sterile, but a piece of black glaze found.

76.114

June 9 - excavated deeper - not by me -

11.25

Sounding A E-W section N face

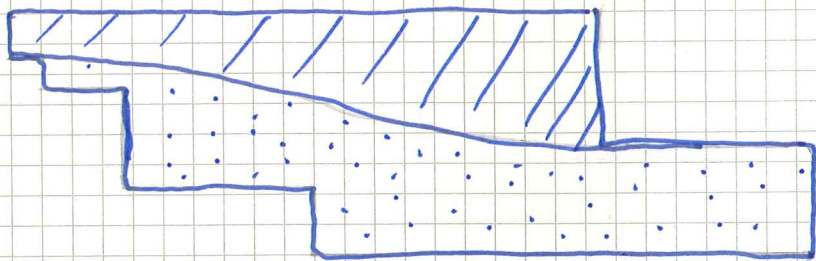

/// = 4/4 dk yellowish brown 104R

::: = 6/4 light yellow brown 2.5y

1:50.

D114.

June 4.

17

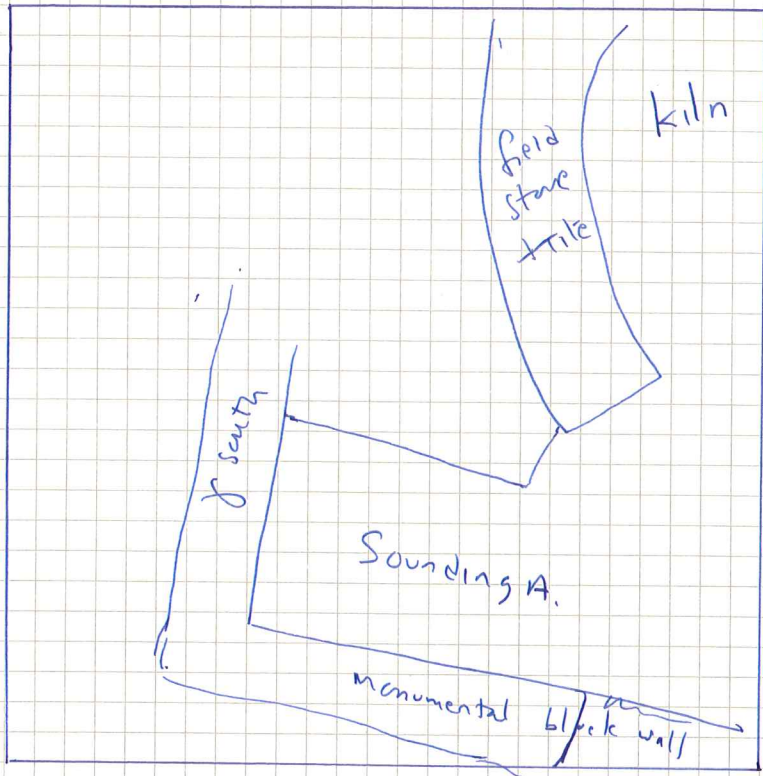

In SE of D114 a sounding, Sounding A made. This in area of kiln bounded by monumental wall of large blocks which form a rt A to JS. This area was excavated to about 25 cm below tile + field stone path level of kiln in 1975. This rectangle was excavated deeper.

76.62p Level 1 - hard light brown earth, no tiles little material at 30 cm ^{of stone} yellow clay with large white flecks found. This white earth is not found at the south ~~est~~ near the right A of the 2 walls. Out in E-W direction it extends about 1 m. ceramic material only found in brown earth.

This white clay is virgin clay - quite deep. The brown ~~est~~ earth contains few rocks or pebbles + is quite hard. The brown earth, 60 cm from top of wall is disappearing + the white clay is appearing. In other words the white clay is deepest at west. This seems to be a clay pit bounded by these walls.

The clay begins 20 cm below the wall in the west + is found at least to a depth of 90 cm in the east where we stopped digging.

The earth near the W side of the E-W monumental block wall is now removed except for about 50 cm at the west near JS. From this earth - level 1 - material - the dark earth, 76.62P

This monumental wall \perp to JS is now shown to consist of at least 2 courses of large limestone blocks. 76.7655

1125

18

Sounding A E-W Section South Face

↓
N

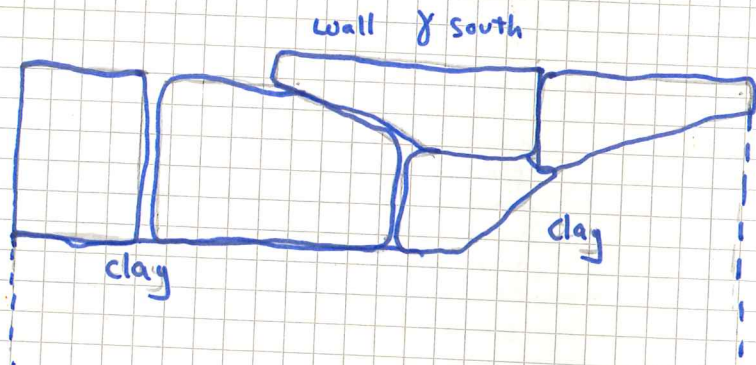

clay = 6/4 2.5y - light yellow brown

1:50.

Sounding B (c'9)

19

June 7.

NT ↑

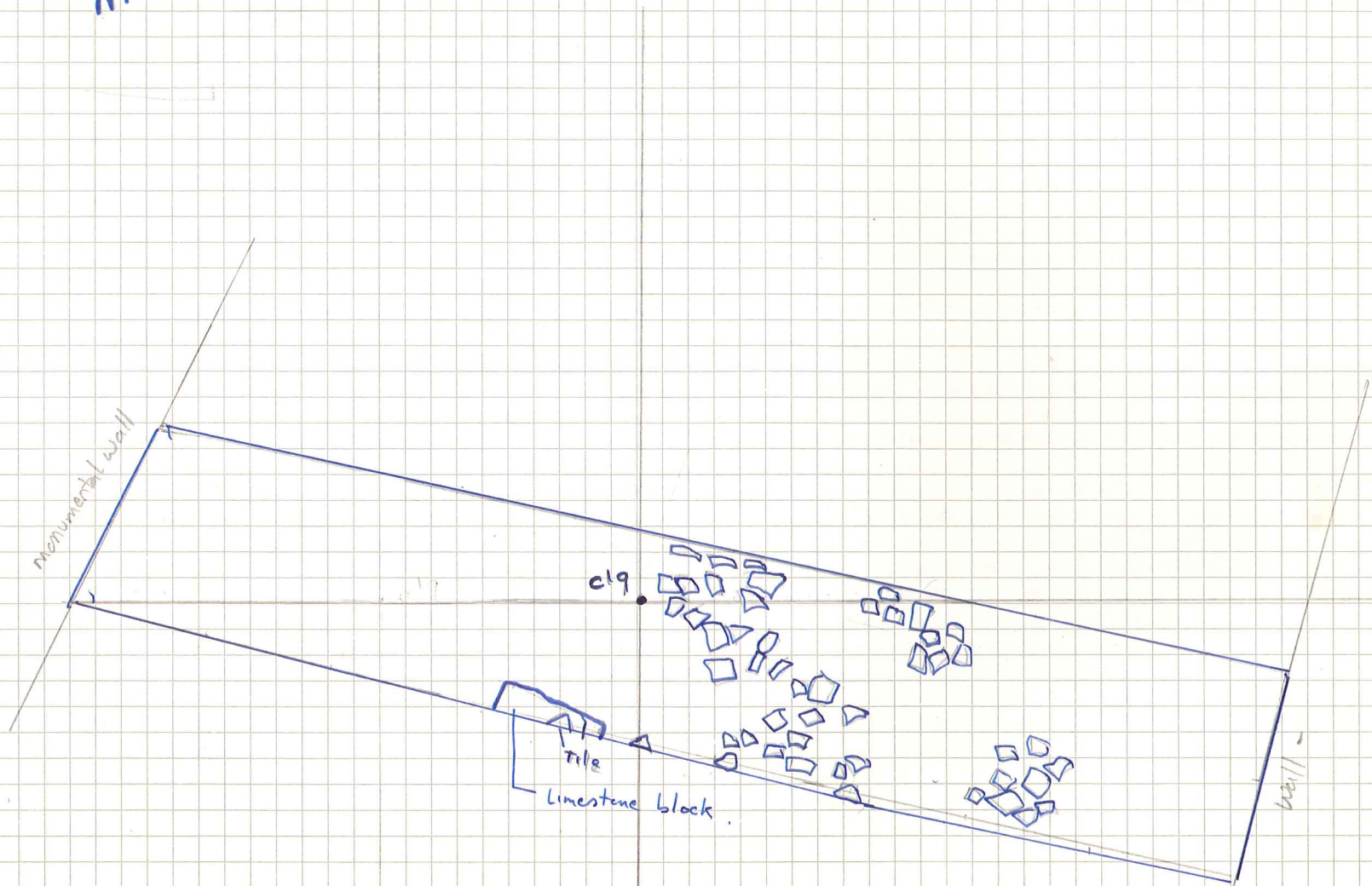

June 7.

Sounding B. (C19)

21

This sounding is \perp to the N-S wall of monumental blocks, ~~of~~ inside the East wing of the U-shaped building. It is $150 \times 800\text{cm}$ + runs to the ~~parallel~~ wall parallel to the monumental wall at the east.

This sounding includes about 2M of soil undug in 1975 + then goes into earth which had about 10 cm of level 1 removed in 1975.

The sounding runs E-W from the monumental block wall in the E-W bank of C19 and B19 and then into the North of C18. ~~and~~

Level 1 - plaved earth - Tiles, coarse ware,

The purpose of this sounding is to clarify 1975 stratigraphy.

In the east, where c. 25 cm of level 1 was removed in 1975 and a sounding was made at that time, the sounding was filled in with sand, about 180 M West of wall.

76.71P Level material - fragment red glaze w rosette + linear pattern near ^{but above} tiles in situ 180 M from East wall.

Level 2 - c. 35 cm from surface - soil a little sayer - above + at level of tiles,

76.66P

This is the level

a piece of black glaze base found in this level. grey ware rim, black glaze, mixed.

Level 2 soil starts at c. 35 cm from the surface in the east but lower (about 10 cm) at the west where it becomes very hard to distinguish level 1 from level 2.

At about 3 meters from the monumental block wall (i.e. east of it) a large piece of limestone, damaged, visible in the south scarp. Tiles are in situ above it. Is this a wall?

under level 2 in east - a tile fall.

Level 3 - c. 60 cm from N scarp - brown, sandy soil, under level of tiles, at level of stone "wall".

Note - tile fall in same line as limestone block.

76.67P

pottery - coarseware

Level 4 - c. 70 cm below N scarp surface. Brown earth, dry, gravelly.

76.68P Material - black flint, coarseware

Find - 4m c. Black flint ^{partially} fragment - lower torso of nude male with kaler/basket.
76.97P 5 1/2 x 9 cm. found about 50 cm west of Tile fall area.

Note the area of Tile fall not dug yet - so levels 3 can occur between monumental block wall and Tile fall.

Find 10 cm ~~too~~ east of monumental block wall - 70 cm from N surface near well. - fragment of a Roman lamp - 5 cm wide, with nozzle + raised decoration.
76.70T

Find - Terracotta Figurine Head - 75 cm depth 1 meter east of monumental wall.
76.69T

Large tiles found in level 4. Same mixture of material as in levels 2+3 but more clay + of a better quality.

For section of Sounding B, see Sounding C.



1:50

c18 South and c19

25

Monumental wall

c19

Sounding B

c19 South

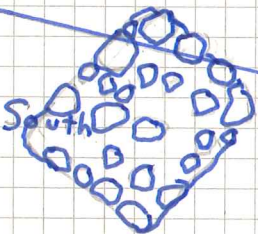

c18 South

wall

C18 South and C19 (SE)

27

The area excavated in Sounding B was extended to the south, incorporating an area in C18 and C19 about 2.70 x 7 M.

76.65P
76.78P

Level 1 - plowed earth.

Level 2 - gray earth as in Sounding B. Tiles not yet found here.

June 8

76.778P

Find level 1 - bronze coin.
76.798 ground slopes to South.

76.80P

Level 2 excavated in NE - dense gray soil. Towards the west, level 2 very hard to distinguish - almost the same color as level 1, but more compact. Level 2 seems associated with tile fall - thus in places where there is no tile fall, it is not surprising not to find a very recognizable level 2.

Level 3 - brown earth, slightly sandy, divided into level 3 west 1/2 and level 3 East 1/2, the "wall" being the dividing point.

76.133P
76.84M

Level 3 west 1/2 - Loamweight found, circular with hole, found 1 M from monumental wall.

Level 3 material - mixed brick, Roman and coarseware.

76.81P

Level 3, E 1/2 found at a higher level than level 3 west 1/2 because the ground slopes to the west.

The "wall" found yesterday in Sounding B continues to the South about 120 M + then seems to stop. Tiles found on this wall. Dimensions of wall:

76.86P
76.87P

Level 4 found in west 1/2. Sandy brown earth

~~76.82P~~

Level 3 in E 1/2 becoming harder with gravel under level of tiles. Material - gray s.l.g., coarseware.

in line with the new "wall" and also to the east are small pieces of limestone,

June 8 1946

C18 South, C19

29

76.85P + very gravelly dry soil. Material in this area very little. Labeled & material from line of wall in C18 S, C19 at level of level 3 in south west.

in the west $1\frac{1}{2}$, level 3 continues at S layer than in the north.

As we go down in the east, the earth is changing, becoming more gravelly and dry, especially in the north - not so in the south, but perhaps this is because the south face was exposed to the recent rain.

76.82P Find - black glaze fragment decorated with a pattern in level 3, east $1\frac{1}{2}$, in gravel area to the north.

level 3 still found in the east as the hill slopes to west and south. in west $1\frac{1}{2}$, level 3 almost all removed except very close to line of the wall in the south.

in level 4 in west $1\frac{1}{2}$ - near monumental block wall - tiles in situ + several large limestone fragments.

76.88P Find - level 4 - small rim fragment - black glaze with pattern.

Top plan - Sounding C - after excavation

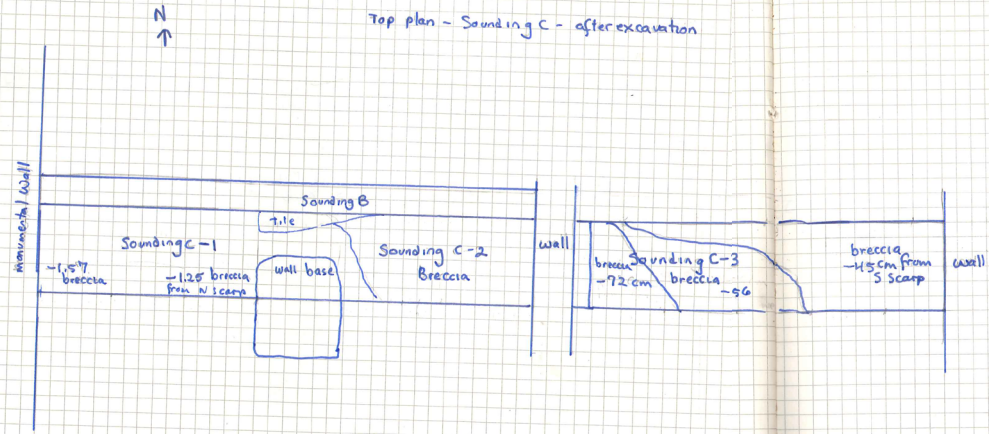

Sounding C (C18, C19, C17)

June 8.

Sounding C was started. This sounding is 1.20M x 12M + runs E-W, primarily through squares C18, C19, C17. This sounding is divided into 3 sections from the west, next to the monumental wall, C-1, which continues (although 30 cm smaller in N-S direction) to go down from Sounding B.

In C-1, the material begins at level 5. This section extends east from the monumental wall about 3 M to the wall-base discovered in Sounding B.

76.93P C-2 is east of C-1 and includes the wall base. This section cuts through the tile fall and thus begins in level 3. This section ends at the wall at the east.

C-3 is ~~still name~~ east of C-2 and is bounded by the wall at the west and another wall, unexcavated in 75 at the east. In this section, excavation begins at level 1.

76.90P C-1 - level 5 - reddish brown sandy soil. Same type of material as in level 4. Some tiles, some black sludge, including a handle.
76.92P

perhaps there is a gravel surface next to the monumental wall in level 4 - but this is not clear.

Tiles saved C-1, level 5. ~~Sounding B level 2~~ ~~level 2~~ - some from the tile fall which was removed in C-2, tiles were saved.

76.94P Level 1 earth in C-3, plowed earth.
76.95P level 2 in C-3, brown fairly compact earth with tiles.

~~76.93P~~
76.96P C-3 level 3 - brown hard earth, ~~just below breccia~~ ~~which is reached earlier in level 3~~

the east.

June 8.

C-2 level 3, quite deep. a 40 cm

C-1, level 6 - same color as 5, but less gravel, more clay like. no large tile fragments.

76.89P

76.91P

From the 20 cm of earth left near the monumental wall is C-1 level 4 material removed and also level 5. These include greek material.

June 9.

C-1 In cleaning the monumental wall, it is clear that it is set upon a lower foundation course of medium stones and tiles (on top of stones) in a manner of construction similar to other walls in the site. Note a place where accommodation was made for an A-shaped cut in the rock by the use of a rock + tile to fill the gap.

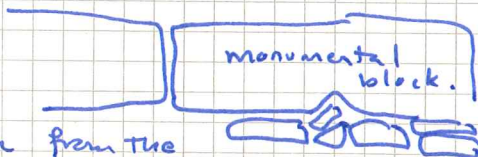
~~76.89P~~~~76.91P~~

76.99P

76.100P

C-1. level 6 - 35 cm from the top of the monumental wall - almost at level of termination of wall.

Material next to wall in level 6 kept separate. 76.105P, 76.106P

in east, near square wall - base - darker earth with gravel breccia is reached in west at -1.57 m. The N scarp, dark compact earth level 7, with no material is found. This level 7 is probably almost breccia - since the soil was sterile. material in level 6 becoming less and less.

Sounding C - Continued.

35

June 9.

C-2.

Level 4 - Sandy brown soil, tiles, ^{shell}

76.101P material - grey ware, black glaze. not much material. less than found in C-1 at level 4.

Level 5 - reddish brown soil, slightly sandy, found between square wall and tile fall and a little to the east. It is found in the east near the wall base. This layer is very thin. 10 cm

76.102P

material - little, but a ~~chunk~~ black-glaze fragment found near the wall base. ~~perhaps then we can associate the wall base~~

After level 5 ~~in the east~~, breccia is found as it was in the east of the square.

Level 5 then appears on both sides of the square wall base in C-2.

C-3.

Level 4 - brown, sandy with tiles, extends for 1.60 M East of west wall in this section. To the east, near the easternmost wall, breccia is reached at -45 cm from the south scarp. Breccia is not reached in the west of this square until -72 cm from the south scarp.

76.103P

76.104P

material in level 4 - grey glaze, coarseware, no black glaze. very shallow level.

Sounding B + Sounding C E-W Section N Face.

36
N
1.25

B
C-1

B
C-2

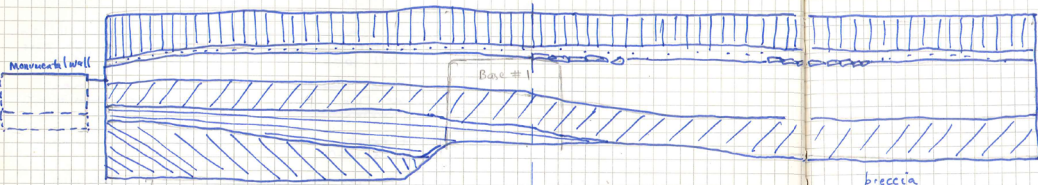

- ▨ = level 1 3/2 104R dark grayish brown
- ▨ = level 2 5/2 104R grayish brown. claylike
- ▨ = level 3 5/3 104R brown, tiles.
- ▨ = level 4 4/4 104R dark yellowish brown. - sandy with gravel. much material, tiles
- ▨ = level 5 4/4 7.5 4R dark brown sandy, tiles
- ▨ = level 6 4/4 7.5 4R dark brown more claylike, less material than 5.

omission of wall to
B7 section B-3
on this page.
(see South face
section of C-3
below)

C-3

on this face, levels 1 + 2 removed in 1975

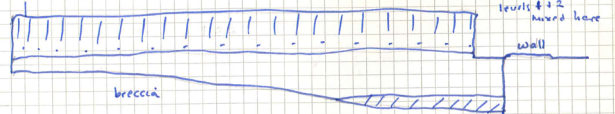
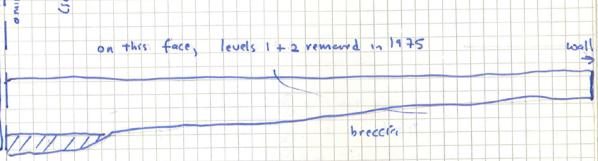

C-3 South Face

N

Sounding D - Top plan

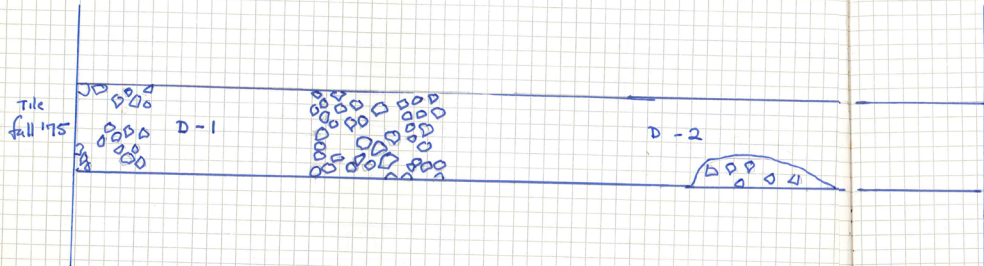

Sounding D. (B'10, B'11, B'12).

June 9.

Sounding ^DB is 1.20 X 12.50 M, running approximately E-W (NE-SW) which is the continuation to the west of Sounding C. It begins west of the monumental wall which was the western limit of Sounding C and continues NE to the tile fall excavated in 1975 in B'12.

76.107P
76.108T
76.109M

Level 1, plowed earth removed in areas unexcavated in 1974 or 1975. Level 1 is quite deep c. 30 cm.

Level 2 - Gray, harder earth found under level 1.

76.110P
76.111P

c. 3.40 m from the west end of D, a tile + stone area is found as well as the continuation of the tile fall in B'12 at the west end.

The area between this new tile-stone area and the tile fall in the west will be known as D-1 and the area east of the tile-stone area to the monumental wall in the extreme east will be known as D-2.

A small area of tiles was also found in D-2 at about 4 m from the monumental wall. This tile area occurs at the south side of the trench and extends N about 40 cm. It is about 3 m long with the heaviest concentration of tile in the east.

This tile area in D-2 is 96 cm from the top of stake C'10. The tile fall in Sounding B is 20 cm from the top of the stake.

76.112P

D-2. Level 3 - under tile level. hard, light brown soil. note level 3 - D-2. rim of red glaze, coarse ware, black-slsje fragment. little material.

June 10.

- D-2. Level 4 - Jandy small stones, reddish brown. A few tiles.
 76.113P Material - black slip fragments, 2 painted found with 1 m
 76.119P west of monumental wall.
 As we dig towards the west - less material found.
 As we dig lower, less material, more gravelly soil.
- 76.120P perhaps a snathia fragment. Most material has been
 black slip, very little grey ware.
- 76.121P large fragment of black slip with a pattern of rays,
 virgin soil, breccia, found 60 cm from the top of the
 monumental wall. It is found at 85 cm towards
 the west, as the ground seems to slope.
- D-1 Level 3 excavated between the tile fall at the east and
 the tile-stone area.
 76.118P

- 1 = 3/2 104R - v. dark gray brown
- 2 = 5/2 104R grayish brown (clay like - harder than 1)
- 3 = 5/3 104R brown 104R hard moist light brown.
- 4 = 4/4 104R dark yellowish brown. - sandy small stones reddish brown.

Sounding D E-W section
N Face.

1:25 43

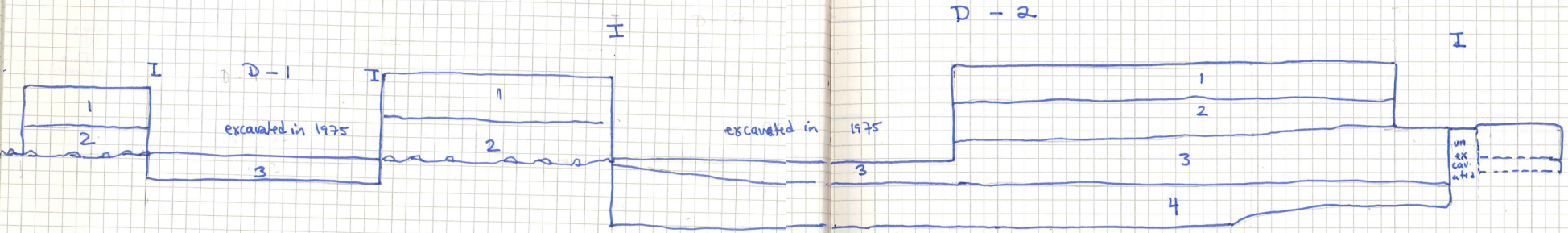

20

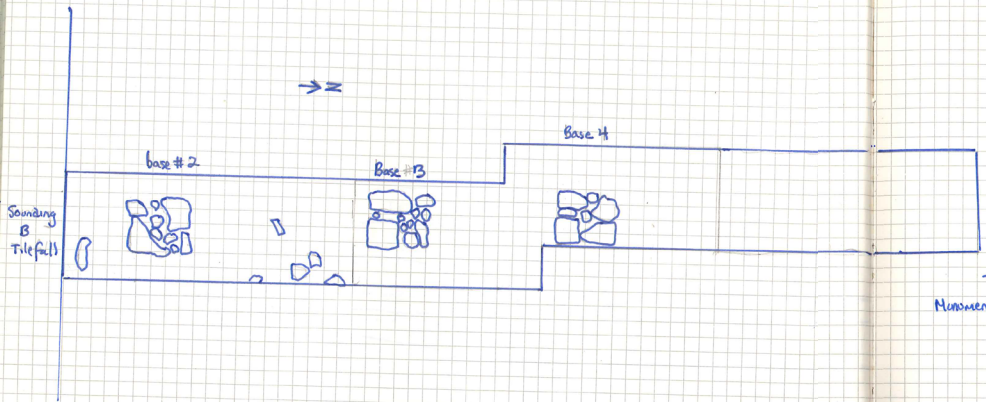

TABLE OF DISTANCES - (Measured from centers)

Monumental wall	↔ 3.90	Base 1	↔ 4.20	East wall
		↑ 3.30		
	↔ 3.90	Base 2	↔ 4.30	
		↑ 3.53		
	↔ 3.85	Base 3	↔ 4.40	
		↑ 3.30		
	↔ 3.80	Base 4	↔ 4.50	



Sounding E (B18, A18, A8)

June 10 (A18)
 Sounding E was begun to determine if there were any more wall bases like the one found in Sounding B running N of the original one. Accordingly, a Sounding 1.50 x 4 was made N of the original base (now called base #1) perpendicular to Sounding B.

Level 1 - plowed earth. About 28 cm from surface another base discovered in line with base #1.

Level 2 found over this base + also tiles under this level - Level 2 - gray harder soil as in Sounding B.

A large brick (?) with a stucco fragment attached to also in line south east of base #2.

base #2 - 78 x 78 - composed of stones, some square. It is smaller than #1. Base #2 is 3.30 m from base #1.

June 11. 2.50 m
 Sounding E is extended N (A18) to see if another base can be found.

Level 1 - plowed earth.
 Level 2 - gray earth.

base #3 found 3.53 from base #2 this base is composed of squared lime-

June 11

Sounding E.

47

stones. This base however is more to the NE than base #2. Base 78 x 80.

~~Base~~ Since the base #3 is slightly to the NE the founding goes to the east about 50 cm + continues to the N to try to pick up another base.

level 1 - plowed earth.
level 2 - gray earth.

base #4 found. 72 x 76, squared limestone blocks. it is 3.30 m N of #3.

June 14

Sounding E extended 3m N to see if base #5 is present. No base is found. (now a square 1.50 x 1.50 m (dus) scribby + gravelly in level 2. tile frags. perhaps there was something. No finds.

Level 1 plowed earth.

1 small 1m square 1.70 m N of where base 5 should have been is opened. This square is 3.80 m from the N wall - the same distance as base #1 from the S wall. No trace of a well^{base} found.

Removal and cleaning of Baulks. June 14 + June 15.

49

The following Baulks were removed to level of the Tile fall in A112 (primarily).
Level 1 was removed from the baulks.

E-W baulk A12 + A'12 - under this baulk a section of the south wall of the rectangular building was found.

N-S baulk A13 + A'13. Tile fall continues under it.

N-S baulk A13 and B13.

Finds - Note bronze handle (?) + metal plow blade - level 1.

June 15.

E-W baulk A13 + B13.

E-W baulk A13 + B'13. - loomweight + small glass on - level 1.

June 28.

Cleaning of Tile fall in A'12 + A'11, south of south wall of rectangular building.
Charcoal found in Tile fall - saved.

South wall of rectangular building found to have 2 courses. In several places in the cleaning of this wall, tiles can be seen under the wall.

June 14

Kien

76.141.55
76.143.P

Cleared praefurnium of rocks and reached a level of burned rock compacted. Under the arch at the level of the "ash pit" appears a hard curved surface which is covered or filled over by the burned rock. Work stopped at noon. The hard surface appears to belong to early phase of June 15. Removed the fill under left side of the arch and began excavating the pit filled with hard stone. Burned material found on the hard surface of the pit. Samples taken. 76.148.55 76.151.55 76.182.55

Bruno excavated the wall of the platform surrounding the ash pit. There are two periods, evidently the space between the arch should slope down toward pit,

53
according to Santarola which worked in
family brick kiln at Bernabada ~~the process~~ if this
proves to be the case the platform is a later
addition. Bruno pulled out a piece of tile
with mortar(?) which he believes ~~is~~ is part
of the original masonry of the first kiln.

5A

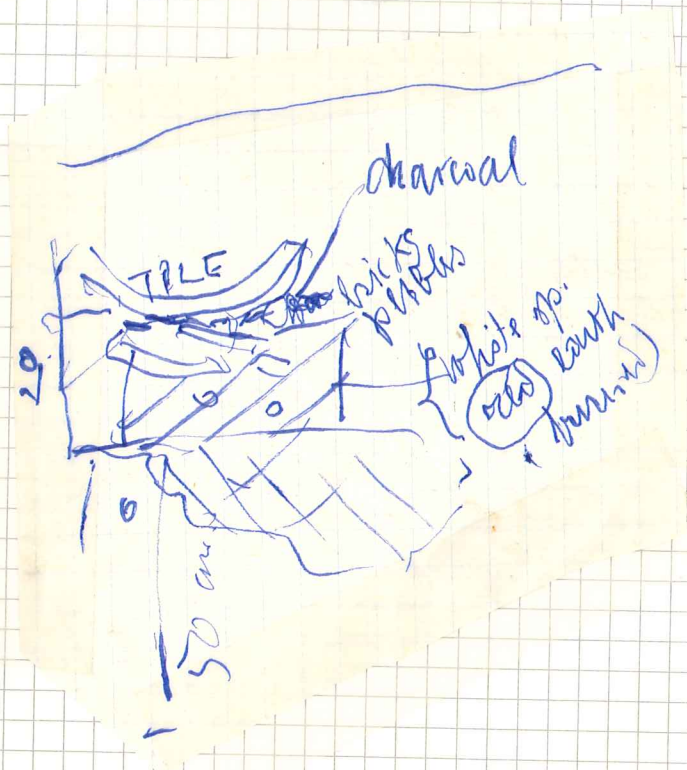

July 9, 1976



bricks heat (wood)

T. Co

publ. heat
earth
chilwa (N)
brown's
(S.E.)

chiller

Pharecton



yellow clay

40 cm

15 cm PRAGMIVIM

white spots

K1 L2

June 7 59

Rain over the weekend has prohibited further activity in the southern area of the site. Instead, I worked on tiles today in square B12. Samples were taken for analysis in Austin; each tile was drawn and labeled. A mixture of ~~two~~ Lacanian and Corinthian occurs. D. Emanuele reported last year he believed the tiles to be arranged in alternate rows of Lacanian (curved) and Corinthian (pan). I have not observed enough flat pan tiles to verify this hypothesis.

June 8

Again working on tiles in A'12. Three almost complete Lacanian tiles were recovered. Samples were taken west of wall Beta west. While clarifying wall line, 2 metal pegs were noted at the bottom of the wall next to the wall. These pegs may have been attached to the wooden beams supporting the tiles.

Small amounts of charcoal were noted in 61 this area, within the tile fall. One sample was collected. Terra sigillata pottery was collected from next to the wall line.

June 9

Again working in A'12, west of wall Beta west, more burned material was found - charcoal, 2 more metal pegs which appear burned, very hard. Many of the tiles were very brittle and were in small fragments. This could have been a result of burning. However, charcoal wasn't in heavy concentrations, rather a consistently light lens. The tiles apparently fell on the floor. A soil change to light brown and more compact earth (may) indicate the level of the floor.

A molded tile fragment (south of rectangular structure Fl. 117I wall line, west of

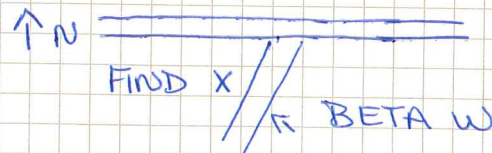
Beta west) was collected. This was labeled 63
FIND. ↑ N  RECT. STRUCT. n. wall

The tile fall extends up to the rectangular structure. Charcoal was noted in this area also. The tiles are mainly Laconian aetho - some Corinthian pan tiles were noted, although less frequently than the curved. Most were too small to be helpful in profile drawings, but give an indication as to materials and forms used. Almost all the tiles were red, both ~~to~~ Laconian and Corinthian.

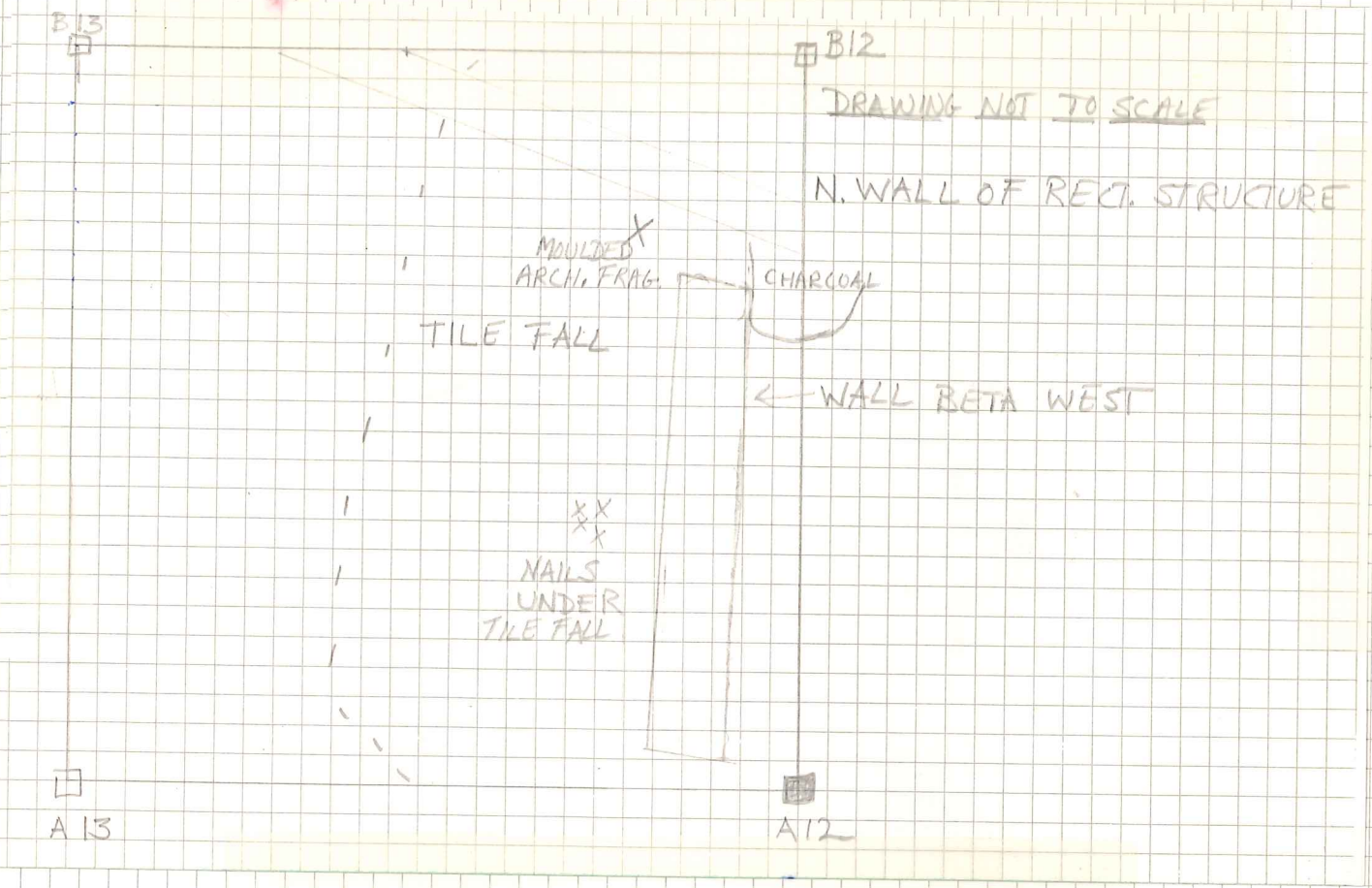

Hill top - walls

Rectangular building

SW corner A 13

Date ??

69

Cornerstone is a block of conglomerate 46×36 .
At the corner the wall was originally 60 cm
wide and the cornerstone would have
had a notch to the west. 1

The South wall is closer to 65 cm. wide
at the corner, but narrows to 50 cm. at
to east. It may be that there are several
courses underneath what is exposed
and that the foundation course is
uniformly 65-60 cm. wide.

From the inside corner the wall extends
1.20 m to the NE. It is uniformly
about 60 cm. wide. There is part of
upper course still in situ - Two
blocks of limestone.

Composition of wall is squared blocks of

71

limestone and conglomerate.
At 70 cm. from inside corner in S. wall is a
piece of column, 45 cm long and 35 cm.
in diameter. The fallen tiles around this
corner respect it apparently.

There is an opening in the west wall which
is 2.75 cm. wide. Part of the pavement of
small chips of TC were found
to south of the southernmost block of the
north extension of west wall. This
dattuta is slightly below the level of the
tile ~~fall~~ fall. Above it this southernmost
block is a block of conglomerate 40 cm
wide & 65 cm long. Above it is another
similar but shorter block having marks of
the plan? ~~on top~~ or plan? in top.

Corner stone is missing.

N. extension of W. wall is 120 cm long,
measured from inside corner. Identical
to south extension.

Walls

Date?

75

C'6 - two blocks on level delimiting to wall

58 cm. wide x 74 cm. long

58 cm. wide x 52 cm. long

The larger block appears to be limestone, while the smaller is a conglomerate very fine, some shells.

D'6 - two stones in line

48 cm wide x 56 cm. long

- Southern

Northern has same dimension, it, however, is a coarse conglomerate with many shells.

The conglomerate of southern block resembles that of northern of two blocks in C'6.

Walls

77

C'9, B'9 Wall Gamma East starting from southernmost of conglomerate blocks.

58 W x 82 L

68 W x 94 L

65 W x 94 L x 27 T

67 W x 98 L x 30 T

63 W x 90 L

60 W x 104 L

Block displaced to W.

46 W x 90 L

Blocks further to north in A'9?

46 W x 60 L

45 W x 40 L This stone is a more compact part of limestone, with no shells.

D'8 SW corner of shaped building
 57 w x 94 long conglomerate like that in SE

Foundation course in C'9 in 65 w
 E'13 End of West below Kilm

Wall to east of Platform

62 w x 88 h x 40 T, same conglomerate as
 monumental blocks in SE

w of Platform upright block

66 w x 96 h x 48 T, same conglomerate as
 in wall

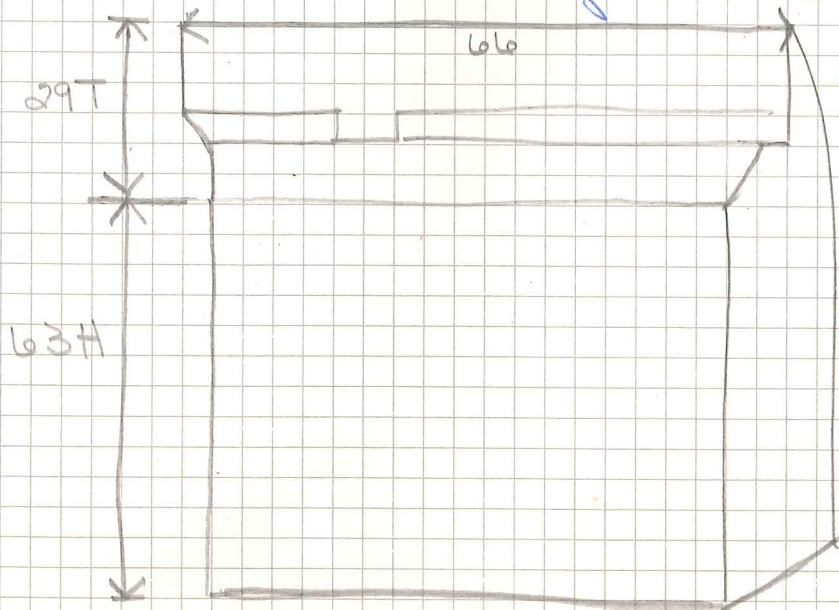

Highest course, horizontal 63w x 93h x 30T
 next lowest course 62w x 82h x 50T
 both stones are of same conglomerate

Full from kiln:

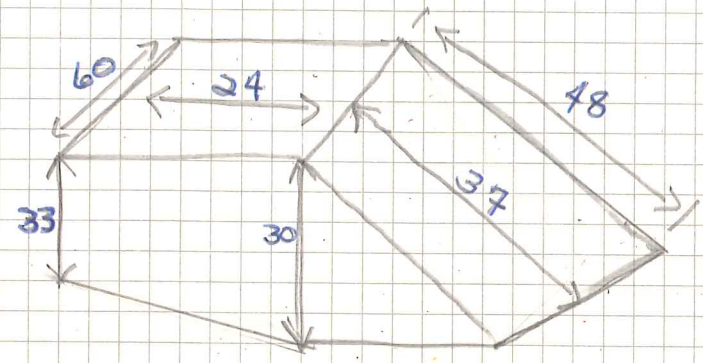
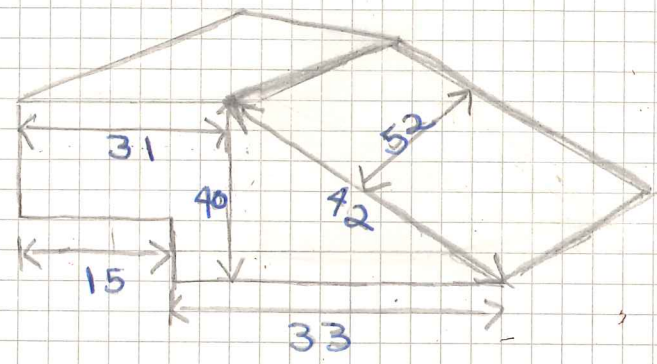
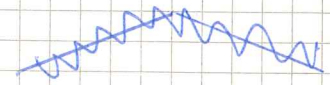

limestone
 ↓

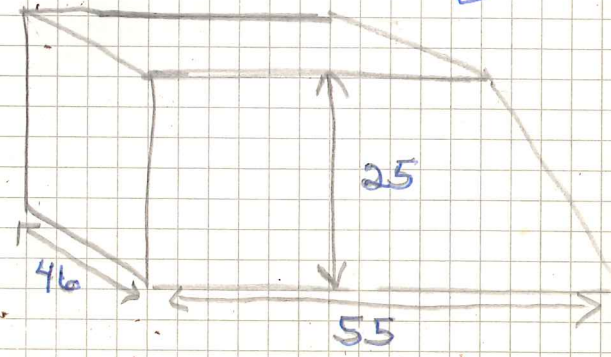

limestone block with clamp holes in it
33 cm. wide

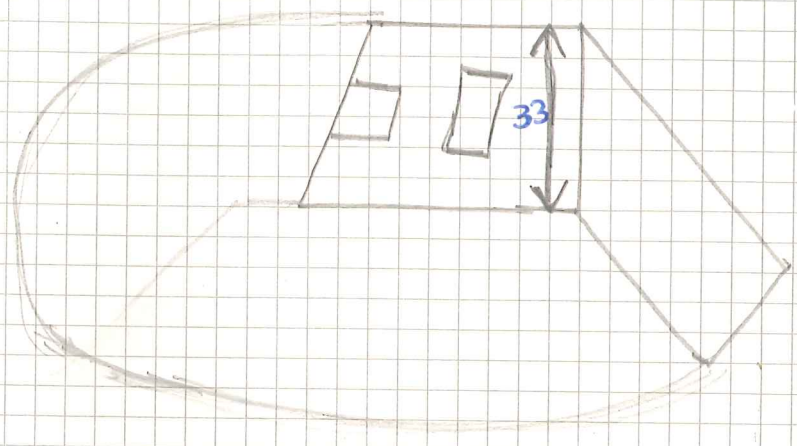

Sam Bi

May 27

85

Spring Area

Conglomerate	W.	L.	Th.
block	68	96	30
limestone	H.	W.	L.
block	62	40	114
conglomerate	Th.	W.	L.
	30	68	96
limestone	L.	Th.	
	116	40	

Temple on hill

column drum dia. , 0.41

limestone block	W	L
	65	125

Tiles.

A 13 outside γw

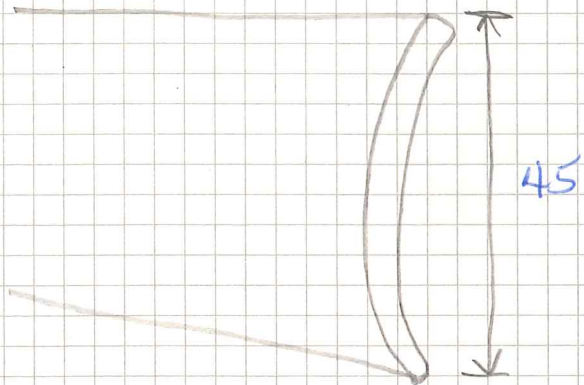
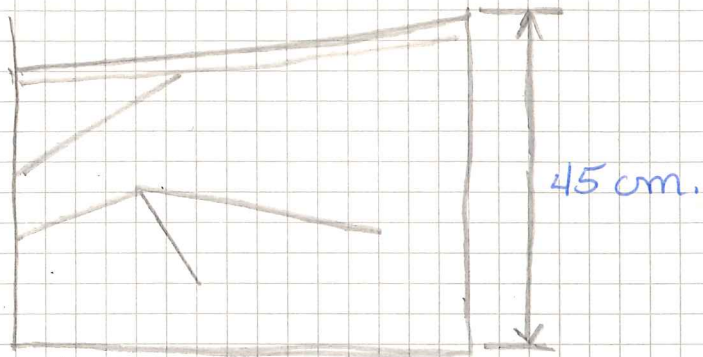

four nearly complete large pen tiles. their
wide ends line in a line close to wall
 γw Two are upside down.

Walls A'13

89

Blocks of conglomerate 47 W x 58 L
49 W x 60 L

Type of construction:

Above the squared blocks is a mixture of smaller stones with a flat surface only on outer face. The interstices are filled with tiles; conglomerate and chunks of "pudding".
Same type of construction as in B'12.

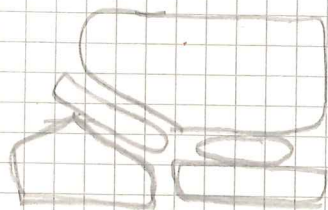

Walls B'12

Lowest course composed of field stones and small fragments of tiles which rest on sandy gravel. Next a leveling course of tiles. On top of that two rows of squared blocks only the outer face is always flat.

limestone block 26 W x 30 H x 43 L

91

limestone

24 D x 22 H

Smaller blocks of conglomerate with broken
tiles used for filling.

C's Omega wall?

part of fluted column drum

Tiled

95

C 10

wall of T shaped building

also used in foundation course.

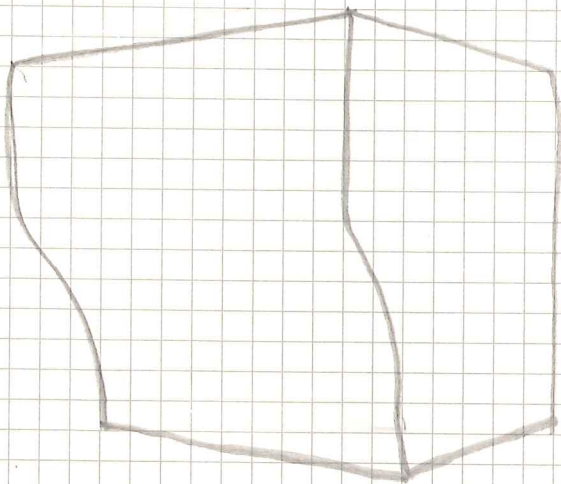

Walls A' 10 / B' 10

97

limestone blocks in alpha building

48 w x 106 L

48 w x 73 L