

METAPONTO

EXCAVATION AT PIZZICA 1975
FARMHOUSE

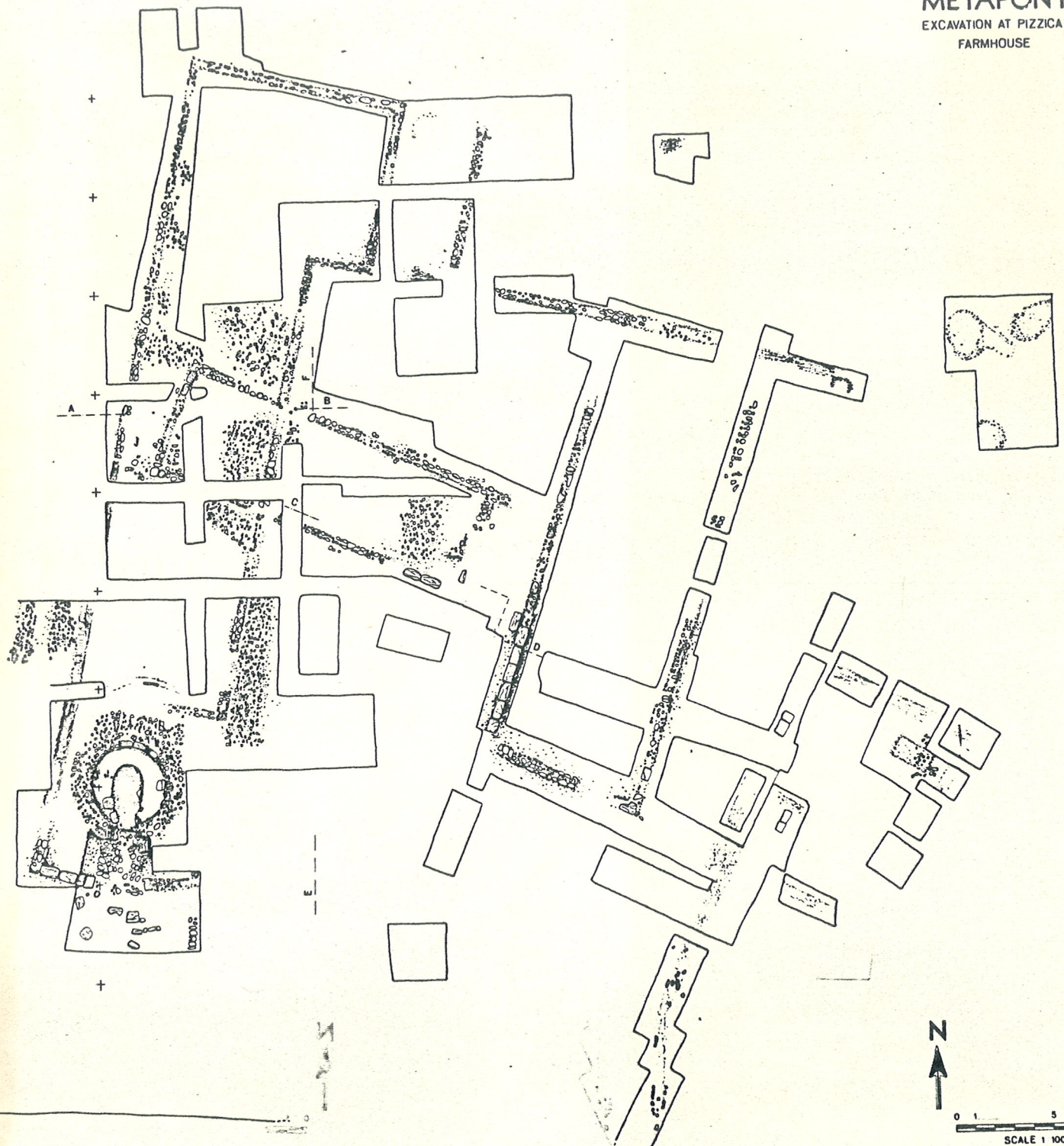

PIZZICA 1975

FARMHOUSE (2)

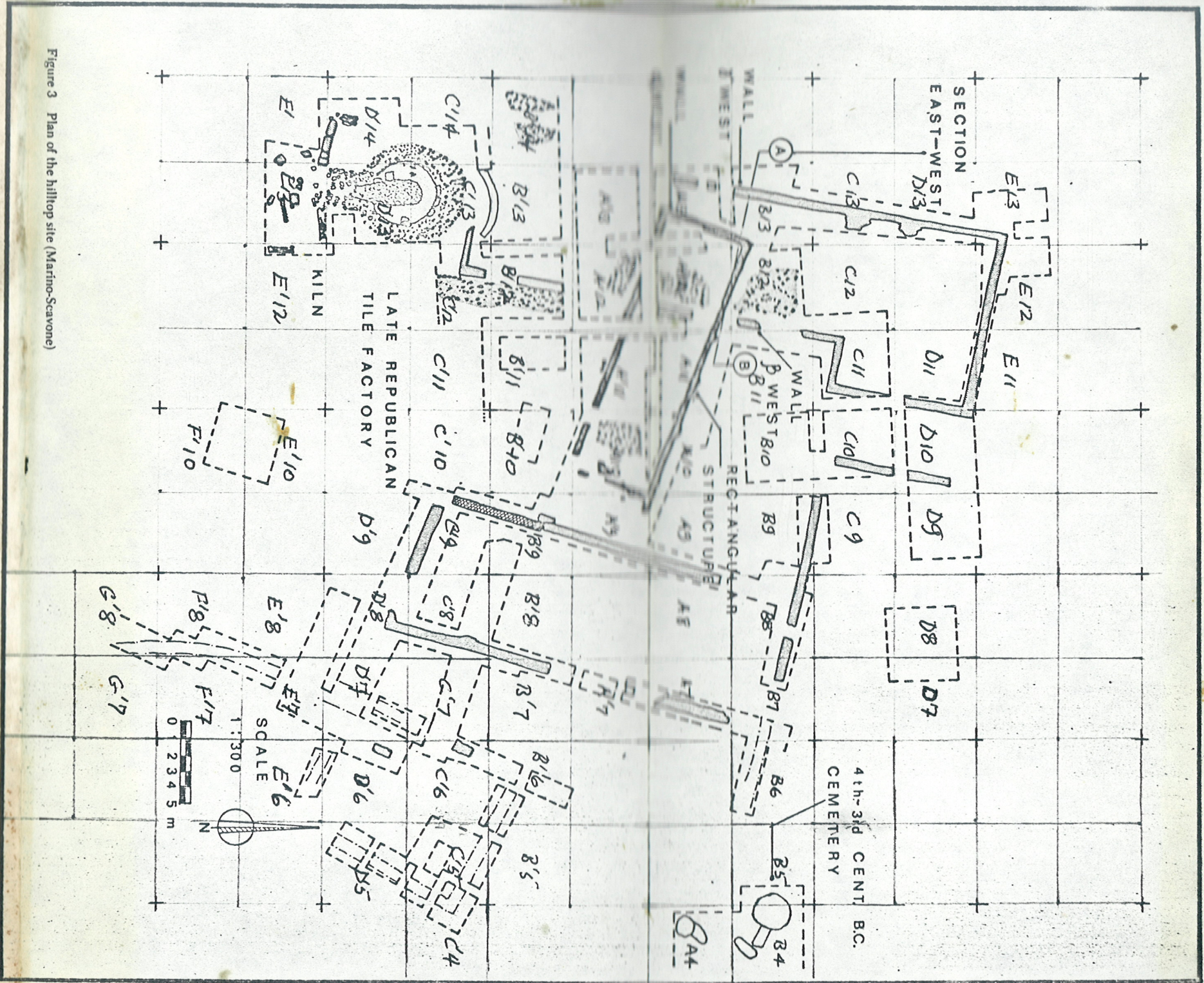

Figure 3 Plan of the hilltop site (Marino-Scavone)

14 →
Couple
or
File

Block
Length Top
Length Bottom
Width

A-D, #
Block E Co
H }
I }
J-K Co

July 2

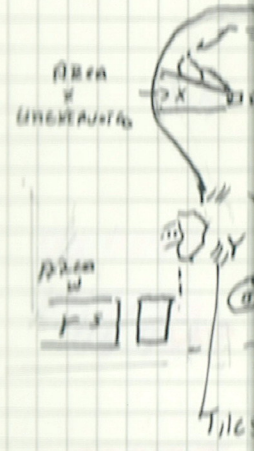

Oven [Log p. 161]

7/10/75 July 7, 1975
← W

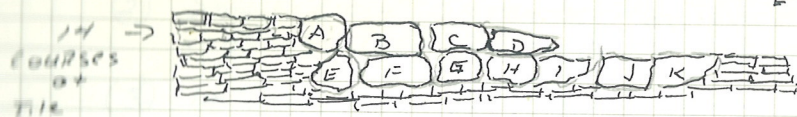

E → SKETCH PLAN OF REPAIRS TO N. WALL OF
~~SMALLER~~ OVEN
(NOT TO SCALE)

Block	A	B	C	D	E	F	G	H	I	J	K
Length TOP	127	37	44	50	17	34	25	40	46	25	15
Length Bottom	20	37	40	47	10	35	23	40	40	20	10
Width	14	19	19	13	20	16	20	16	17	16	6

A-D, F E Brownish-Buff Limestone - Reused?
 Block E Conglomerate Fieldstone
 F }
 H } Pitted Grey Limestone
 I }
 J-K COARSE (BURNED?) RED Limestone Reused?

July 7

Level 2 (Soil below plow zone) Remainder of Level removed.

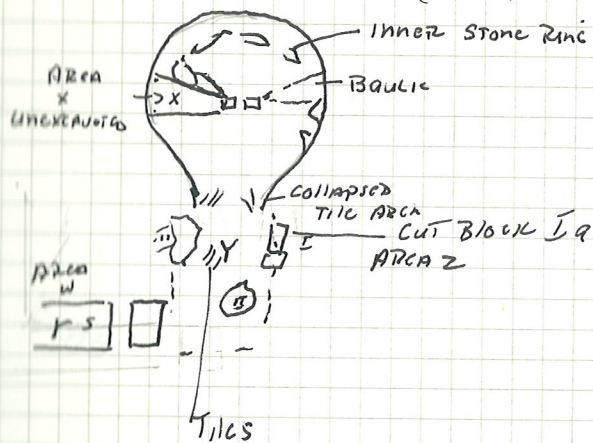

soil W: 10 YR 1/6/3
 2 10 YR 4/2 Greyish Brown
 Y 10 YR 6/4 Lt. Yellow Brown TO 7 YR 6/3

Floor of AREA Y AT END OF LEVEL 2 PHOTOGRAPHED
 CERAMICS WERE ENCRUSTED WITH HARD SOIL
 few fine grey ware. MORE COARSE WARE.

Level 3. Soil chance Yellowish red 5 YR 5/6
 on E EDGE of AREA Y Block I-a - Re-used
 well cut Limestone 23 x 74 - PARTIALLY EXCAVATED
 cutting 9 x 4 x 4 cm DEEP - PHOTOGRAPHED

Note with finds

75.718P

① Small Black Glaze knob - in soil of AREA
 2. BUT, close TO Block I-a - TO BE FOUNDATION
 MATERIAL

2

July 8th
SKETCH plan of S. Extension of Praetorium NOT TO SCALE.

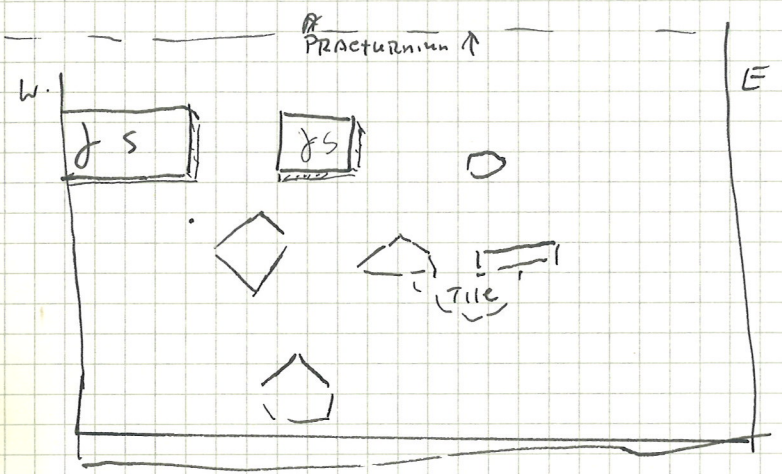

M
(2)
(3)
(4)

No.

75.729 P
75.725 G
75.726 P
75.734

75.93
75.92
75.91

75.90
75.89
75.88

July 7, 1975 Over [Log p. 161]

3

Note worthy Finds (Cont.)

- (2) Small Black Glaze handle Located 90 cm. West of Cut Block I₉. Imbedded in Below Rock Mass II in association with tile deposit. 75.718P.
- (3) Imbedded in Rock Mass III Painted Red Figure Design
- (4) Painted Red Figure type shard (Black glaze on Butt slip) in Level 3 material 75.724P

North Cut - Through Areas W Y Z - Begins at Level 2 - To Define the Area Adjacent to the Collapsed Tile Arch.

75.729P

Coarse ware shards. Small piece of ancient glass.

75.7256

- (5) One painted handle immediately over Cut Block I₉. Also possible architectural fragment - stone.

75.726P

Soil removed from between the springing of the arch. There were several large coarse ware fragments

75.734. Mortar Sample from Arch [Log p. 171]

Over.

[Log p. 170]

July 8th.

All work on the exterior. S. Extension of Praetorium is a Trench

3.50 m E → W 3.20 m N → S

The western edge of the wall is in line with the gap in wall J S.

The eastern edge is slightly to the W. of Cut Block I₉

Level I Blowed earth 10 yr 6/3 There is a deposit of

Dark powdery soil 1.25 m E → W. 1.10 m N → located 20 cm. from E edge of trench. There are loose tiles in this soil but little ceramic material

75.729P

75.7256

75.735P

Level 2 Gravel hard packed 10 yr 6/3. Coarse ware and Bone

in this soil but below the deposit of charcoal

There are 4 large blocks in this area and

one small worn limestone which may represent a remnant of wall J S

75.740T

75.738P

75.730B

July 7, 1975

South Extension of Rho, Third sounding C'5

[Log p. 163]

5

purpose: to find possible 'ghost wall'
Level 1 - begun July 6 by D. Henderson. Soil brown and crumbly with small stones and a few tiles.

75.713?

CERAMIC MATERIAL - Mostly coarse, NO Black Glaze, some grey ware and Terra Sigillata.
one large 'pyramidal' loomweight.

75.708?

Came down on yellow-brown hard pebbly earth at 0.47 m as measured from the west bank.

The top soil is too shallow to preserve any clear traces of a 'ghost wall.'

Sun
June 7, 1975

Photos

7

Sounding East of First Sounding South of ψ B'8 #.

A one by two meter trench was begun in order to follow the dark area of soil indicating a robbed-out wall in the first south extension of ψ .

Level One - to a depth of 0.36 m from B'8, soil color 10YR 5/3.

Some tile was found, but no major accumulation. A good number of sherds ~~ceramic~~ were found, grey ware, Terra Sigillata, black glaze, also one Medieval or modern sherd. One tile with finger impressions and an 'archaic' roof tile were saved for study.

Bone fragments were also found in level one.

At 1.80 m south of stake B'8, at a depth of 0.36 m from that same stake two limestone blocks were uncovered. Their width was 0.50 m. There are plowmarks on the stone.

Level 2 - begun at approx. 0.40 m IN depth from B'8 at the level just below the top of the limestone blocks.

Breccia begins about 0.70 m north of the most northerly block.

Ceramics were very scarce and all 3 pieces came from the soil just a few centimeters to the north of the blocks.

1 bone fragment was found

1 piece of flint.

July 8, 1975

2nd

A
Level /
Cer
Bon

in
Ash

hit

EXCAVA

July 9
Level 2 -
Gne
Terra V
depth

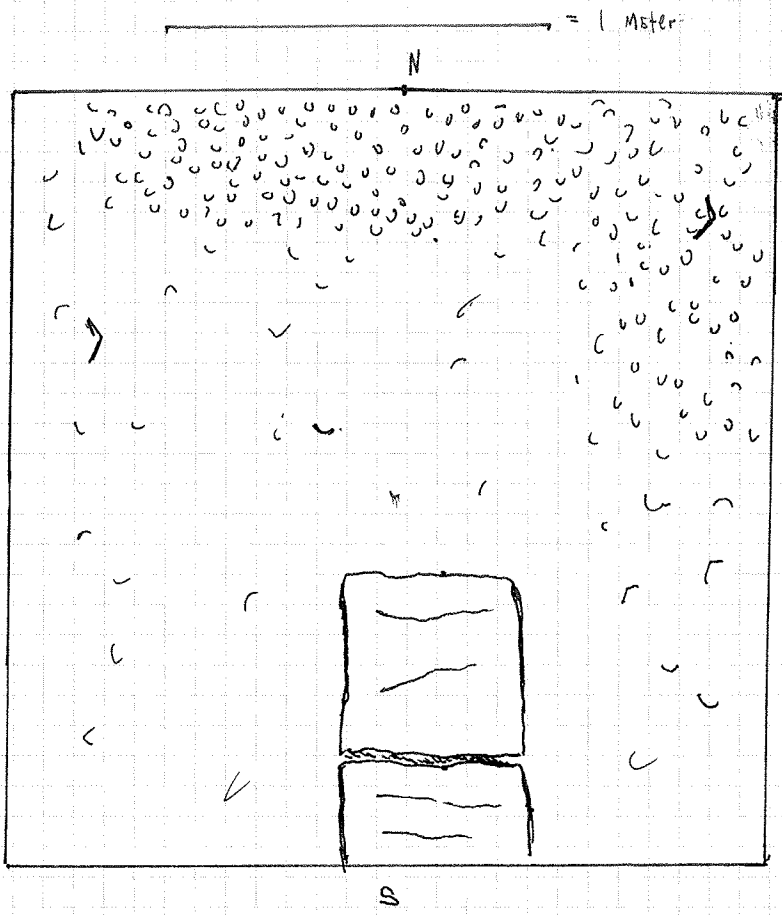

July 8, 1975

2nd Sounding North of Y

A 1.30 m x 2.50 m sounding was made to a depth of 0.42 m as of this date.

Level 1 - plowed earth, 10 yr 5/3. Some tiles in moderate numbers.

Ceramic material, a mixed lot of black glaze, African red slip, grey ware

Bone - 1 fragment

A deposit of ash and charcoal in the southern portion of the trench, measuring in its densest portion 0.40 x 0.15 fanning out. A modern type was found in the ash deposit - which tended to diminish its importance.

hit breccia in the north at approx 0.42 m.

Excavation will continue in this sounding

July 9

Level 2. The Grey Area was designated Area A - very few sherds were found

one bone fragment

Terra Virgata was hit just under the ash deposit

depth at north baulk 0.58 m and 0.39 m on south

2nd Sounding North of ψ 1.30 x 2.50 M

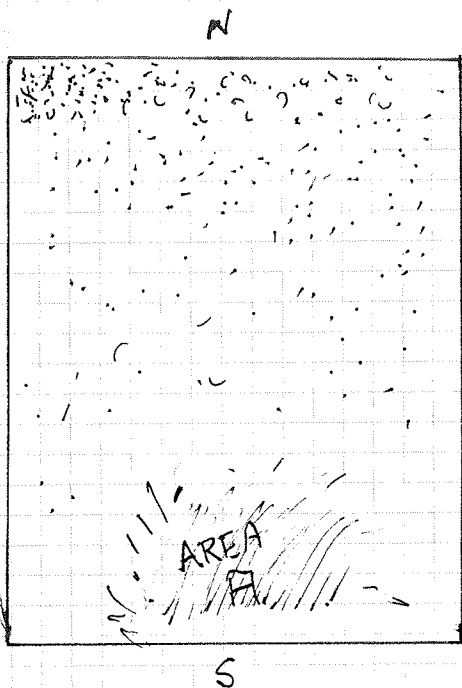

9 J
AREA
(This
The
FORM



SECTION B
Note: Local
FINDS ARE

Roman Numeral
ROCK/STONE

FOR PHOTO OF
SEE NB ①

9 July 1975

AREA Y Level 4 Soil Loose MODERATE Amount of TLE Color is VR 5/6
(This is the LIGHT COLOR Soil of the Praetorium area - may be the same as level 3)
The ROCK MASSES PREVIOUSLY DESCRIBED AS I, II AND III NOW SEEN TO
FORM TWO IRREGULAR OVALS This may simply be due to ROCK FALL
BUT MATERIAL WAS SEPARATED INTO SECTION I AND SECTION II

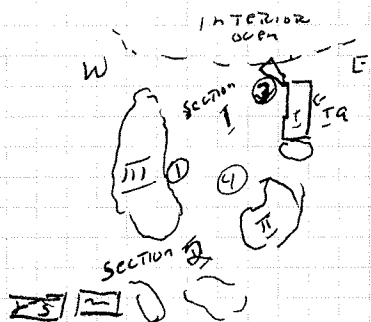

NOTE: LOCATIONS OF
FINDS ARE CIRCLED.

ROMAN NUMERALS ARE
ROCK/STONE MASSES

FOR PHOTO OF BLOCK I 9
SEE NB ① p. 168

Level 4 was 60 cm. Deep AND there is a floor of
hard PACED EARTH which is similar to the
inner oven floor. There are also several moderate
size ROCKS which appear to be the floor of the
Praetorium. - SECTION 2 (South Higher, NOT WITHIN THE STONE CIRCLE)
BLOCK I 9 WAS FULLY SEEN TO REST ON A
FOUNDATION WALL 20 cm. Deep made of irregular limestone
THIS BLOCK HAS BEEN TRIMMED AS IT NEARS THE
S. WALL OF THE OVEN. NOT FULLY EXCAVATED
N.



Block IA

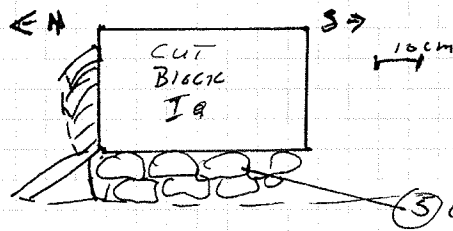

SECTION I MEASURES
1.1 m N-S
1.20 m E-W AT CUT
BLOCK

NOTEWORTHY FINDS

- ① FINE GLASS - ONE RIM IMBEDDED IN ROCK MASS III
- ② T.C. KNOBS
- ③ COARSE WARE BASE AT LEVEL OF FLOOR
N. E. SIDE OF BLOCK I 9
- ④ BLACK GLAZE RIM ON FLOOR (~~2000~~)
- ⑤ GLASS BASE NEAR ROCK MASS II BOTTOM OF BLOCK I 9

Oven
July 9, 1975
(Cont.)

Other pottery from Level 4. - Black Glaze, Red Slip Knob, Coarse Ware.
A large amount of bone was also found.

Area Y Section 2

Floor seems to be of stone - approximately 20 cm. higher than Section 1
and may be an antechamber (or simply rock trail)
There is a 38 cm. opening between the two sections
Section 2 is 1.40 M → S and terminates at a point slightly S
of the line of wall Gamma S.
Ceramics were Black Glaze, one sherd with fig. bands in Brown Glaze
Coarse Ware.

Depth as measured from Stake D'15

Section 1	1.71 m.
Section 2	1.54 m

July 9, 1995

15

Sounding in C'5

Level 1 - very loose dry soil, brown with small rocks and stones to a depth of 0.38 m from surface
A few fragmentary tiles, no Archae

Ceramic Material - a mixed lot of black glaze, Terra Sigillata, Grey ware, Red slip and coarse strands.

Features - 2 stones, limestone, in the center area of the sounding. The first a block measuring 0.40 x 0.33 m - 1.04 m from the west baulk. The smaller triangular stone measures 0.28 x 0.26 and is 0.46 from the east baulk.

Level 2. So far to a depth of 0.50 as measured from east baulk
The color and texture of the soil is different from level one. The color is greyish
Tiles are imbedded in the surface.
Ceramic Material - large pieces of pottery, few in number
1 bone fragment.



4 July 1975

(1) E Extension of Rho (cont) 2nd Sounding (C'S) Level I

Bone fragments and teeth found.

(1) Loomweight (round)

Stones and tile encountered on E and S banks, also smaller stones wall trench line.

From stake B'6:

Depth of stone in E bank: .39m

Depth of large stone, out of wall trench line: .54m

Depth of "tiles" in S bank: .47m

Depth of stone and tiles in line of wall trench: .60m

Level of breccia underneath wall trench on E bank: c. 1.5m thick

Large stone out of wall trench line:

width: .21m

length: .40m

N of wall trench = ringin breccia width: .60m

S of wall trench = pavement width: .46m

Tiles are embedded in wall trench

width of wall trench: c. .64m - .56m

Roof tiles: moderate

Pottery: moderate - mixed lot Note: pottery seems to be very coarse

Trench soil is much softer and darker than either pavement or breccia.

(2) E Extension of Rho 3rd Sounding (C'S - C'4) (3.00 EW x 1.70 NS)

Level I: pottery: mixed lot - moderate 75.684P

Bone fragments and teeth found. 72.75.696X

Noteworthy: (1) piece of flint, probably worked 75.675R

(2) molded sherd 75.670P

NE corner is total breccia and very fine sandy soil - color: 10 yr 6/6 "brownish yellow"

1.20m in E of trench is breccia, but not ringin.

Wall appears to turn S, but outlines and precise direction are vague.

Depth of Sounding (ground level of N bank): 1.43m

Thickness of breccia: 1.2m on N bank

(3) S Extension of Rho 1st Sounding (C'S) (3.00 EW x 1.50 NS)
pottery: mixed lot - moderate
to be continued

~~(4) Extension E of psi 1st Sounding~~

4 July 1975

17

(1) E Extension of Rho (cont) 2nd Sounding (C'S) Level I:

Bone fragments and teeth found.

(1) Loomweight (round)

Stones and tile encountered on E and S baulks, also smaller stones in and out of wall trench line.

From strata B'6:

Depth of stone in E baulk: .37m

Depth of large stone, out of wall trench line: .54m

Depth of "tiles" in S baulk: .47m

Depth of stone and tiles in line of wall trench: .60m

Level of breccia underneath wall trench on E baulk: c. 1.5m thick

Large stone out of wall trench line:

width: .21m

length: .40m

N of wall trench = ring in breccia width: .60m

S of wall trench = pavement width: .46m

Tiles are embedded in wall trench

width of wall trench: c. .64m - .56m

Roof tiles: moderate

Pottery: moderate - mixed lot Note: pottery seems to be very coarse

Trench soil is much softer and darker than either pavement or breccia.

(2) E Extension of Rho 3rd Sounding (C'S - C'4) (3.00 EW x 1.90 NS)

Level I: pottery: mixed lot - moderate 75.684P

Bone fragments and teeth found.

Noteworthy: (1) piece of flint, probably worked 75.675R

(2) molded sherd 75.670P

NE corner is total breccia and very fine sandy soil - color: 10gr 6/6 "brownish yellow"

1.20m in E of trench is breccia, but not ring in.

Wall appears to turn S, but outlines and precise direction are vague.

Depth of Sounding (ground level of N baulk): 1.43m

Thickness of breccia: .12m on N baulk

(3) S Extension of Rho 1st Sounding (C'S) (3.00 EW x 1.50 NS)

pottery: mixed lot - moderate

to be continued

~~(4) Extension E of Rho 1st Sounding~~

7 July 1975

19

- (1) S Extension of Rho (cont'd) 1st sounding (C'5) Level I:
pottery: mixed lot - moderate 75-717P
Tile level is in W part of Sounding
Depth: .54m (C'5)
Tiles embedded in soil corresponding with pavement in E Extension of Rho 2nd Sounding
Depth of pavement: .55m (C'5)
Width: c. 1.13m
Wall trench continues S
Width: c. .65m
Depth: .53m (C'5)
Breccia in E .75m of Sounding
Depth: .48m
Note: tiles are in large pieces
Soil color of pavement: 2.5y 7/2 "light greyish yellow"
Find: (1) glass fragment 75-704G 707B
- (2) S Extension of Rho 2nd Sounding (2.00 NS x 1.45 EW) (C'5)
Level I: pottery: mixed lot - moderate
Roof tiles: moderate
Bone fragments found.
Trench seen vaguely to continue towards S.
Breccia encountered except for SE corner where there is a small area (c. .70 x .70m) of grey material.
Depth of Sounding: (from ground level on W baulk) c. .42m
- (3) S Extension of Rho 3rd Sounding (C'5) (1.63 EW x 1.90 NS)
Level I: pottery: mixed lot
to be continued (by Beth)
- (4) E Extension of Psi 1st Sounding (D'7) (5.00 NS x 2.00 EW)
Level I: pottery: mixed lot
to be continued
- (5) S Extension of Omega, Psi and anchaic structure (12.00 EW x 2.00 NS)
(D'8 x D'7) Level I:
pottery: mixed lot - moderate
roof tiles: large amount

Bone fragments found.

Note: Level I extends across the whole sounding EW

then, for level II, sounding divided: Area A - West 6.00m
Area B - East 6.00m

Dry soil color of I: 10gr $1/2$ "dark grayish brown"

Area B Level II

Stones in NE corner extend S, and are fieldstones. This is a possible continuation of Psi. Stones are a. .10 x .13m

Depth of stones: (D.8) .64m

Pottery: mixed lot - moderate 75.74P

Bones and teeth and an iron lump found.

Note: fieldstone "wall" set slightly off projected course of Psi 75.706-X

Depth of II: .93m (D.8)

Soil is light-colored and stony. Dry soil color: 10gr $6/4$ "light yellowish brown"

Area A Level II

In extreme W portion are assorted fieldstones and tiles - W baulk has tiles and darker soil.

Width of "wall": c. .50m

Distance from W baulk: .72N - c. .30S

Depth of "wall": (D.8) .89m

Depth of II: (D.8) .92m

1 piece of pottery found.

Dry soil color: 10gr $5/2$ "grayish brown"

8 July 1975

23

(1) E Extension of Psi (cont'd) 1st Sounding (D'7)

Level I: Areas A + B

Area A: N 2.50m

Area B: S 2.50m

pottery: mixed lot - moderate in Areas A + B
soil color in Areas A + B: (dry) 10 yr 4/2 "dark grayish brown"

roof tiles: moderate in Areas A + B

Wild onions found in Area B.

Depth from D'7: Area A: .57m

Area B: .81m

Level II Area A

pottery: mixed lot - small

soil color: (dry) 10 yr 5/3 "brown"

Stonier and harder soil than I - rounded pebbles present.

roof tiles: moderate

mostly breccia at this level.

Large lump of breccia extending from N baulk c. 1.44m (width) and entirely across Sounding (2.00m length), and it was cut to accommodate E turn of Psi.

Note: wall trench going E

Width: c. .70m

Depth: (D'7) .67m

Level II Area B

lighter soil, much stonier

Same soil color as Area A Level II.

pottery: mixed lot - small

Depth of II: (D'7)

Area A: .67m

Area B: .96m

Fieldstones in E portion, also breccia

Depth: (D'7)

E: .84m

W: .88m

Width: 1.18m

Bone fragments found

Few roof tiles - many rounded pebbles - mostly breccia, with a few large fieldstones

Level III Area B

tiles were embedded in soil in W, and the soil was darker and softer

Pottery: none

Tiles and pieces of limestone in wall trench material - few stones

Depth: (D'9) 1.04m

Soil color: (Dry) 2.5y 6/2 "light brownish grey"

Note: Wall psi has a trench offset to the E that also continues S and E

(2) S Extension of psi 3rd sounding

(2x2m) (E'9)

Level I: pottery: mixed lot - small

Noteworthy: (1) broken tile fragment

(2) glass fragment

(3) shard with stamped inscription

Bone fragments found.

Depth: (D'9) 1.14m

Note - shotgun shell case

Level II: lighter soil with many tile fragments

Note - grey-wane

pottery: mixed lot - small

lighter soil concentrated in NE corner

more pebbles at this level.

Depth: (D'9) 1.33m

Wall trench continues S.

width: e. .94m

Depth: 1.33m (D'9)

Trench has dark soil, with tiles embedded in it.

Level III: wall trench material

pottery: mixed lot - small

Depth: (D'9) 1.36m

many pebbles present.

Trench soil color: (dry) 10yR 5/3 "brown"

Noteworthy: (1) loom weight fragment (2 - holed, round)

Note - tile fragments (large) embedded in trench material.

Light soil in NE corner may be pavement

width: e. .39m

9 July 1975

27

- (1) S Extension of Psi 3rd Sounding (E'7 - F'7)
- Sounding extended S for 4.50m to determine direction and extent of wall trench.
N 2.50m of extension was bagged as levels I, II, III (E'7)
S 2.50 was bagged All as level I (F'7).
Length of wall trench: 4.50m
Width: a. 1.00m
Levels are similar to those described in yesterday's (8 July) account of 3rd Sounding.
Wall trench continues to have large tile fragments embedded in it.
pottery (of all 3 levels): mixed lot - small
possible E angling of wall.

- (2) EW section cut into Omega (D'8) (2.50 EW x .80 NS)
to check on S continuation
Begins at level II:
Soil is light-colored and stony in E
↓ darker and tile-filled in W - more ceramic material
pottery: mixed lot - moderate
E soil color: 10gr 5/3 "brown"
W soil color: 10gr 5/2 "greyish brown"
Bone fragments found.
to be continued

10 July 1975

(1) Extension

Level I:

NW:

Following Wall Omega (A'7)
pottery: mixed lot - moderate
(1) iron lump

1st Sounding

24

Level II:

red-brown soil and clear indication of burning in the area.
Also traces of the wall, stones, tiles and charcoal.
pottery: mixed lot - moderate
Depth of Sounding: (N bulk) c. .70m

(2) Sounding in

C's, C'6, J's

on "NE Room"

[LOG P.175]

(1.20 NS x 2.50 EW)

Level I:

plowed earth

thickness: .23m

75-796X

bone fragments found

pottery: mixed lot - moderate

Level II:

Sounding in E portion (1.00 NS x 2.00 EW) perpendicular to E wall, but not through it.

Soil is light grey powdered concentrated near wall with tiles and pebbles embedded in it.

Tiles are close-packed and suggest a roof fall.

Thickness: c. .10m

75: 781P

Tiles crumble, which evidence of burning.

Pottery: mixed lot - moderate

To the W of Sounding is virgin breccia about 10m below top of level.

75-797X

Bone fragments found.

Level III:

Soil is brown with many rocks and is clay-like.

75-795X

Bone fragments found.

NW: (1) coarse ware lip

pottery: mixed lot → small

75-780P

Depth of Sounding: (N bulk) c. .64m

Thickness: c. .14m

Breccia at this depth.

(3)



Ex
Lev
Til
H +
So
Re

Lev
To
So
St
co
Po
B
W

(4)

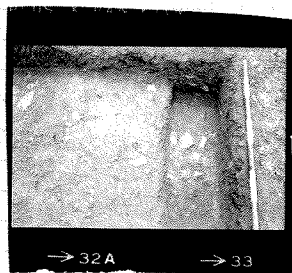

Ex
Lev
Pun
N
Mo

Lev
So
ma
Po
B
De

Th
Bo
P
of

(5)

Ex
Lev
St
Lev
D
Th

(3) Extension following Omega 2nd Sounding (1.50 EW x 2.60 NS) ³¹
Level I: pottery; mixed lot - moderate
Tile fragments; moderate
At a depth of .55m (A7) encountered a mixture of red and grey soil with embedded tiles.
Red soil is mostly concentrated in E.

Level II: Sounding (about .50m wide) taken in S end to reach level of stones in 1st Sounding.
Soil is dark, with tile fragments.
Stones (smaller) encountered about .62m from A7, which was the continuation of wall Omega.
Pottery: moderate - small - mixed lot
Burned tiles included in pottery collection.
Width of wall: .50m

(4) EW Sounding E of Psi (B'6) (1.50 NS x 2.00 EW)
Level I: pottery; mixed lot - small
Purpose; to follow S direction of monumental block
NW: (1) lump of iron
Monumental block is isolated amidst breccias and has plowmarks in it.

Level II: below monumental block
Soil is stony; to W and N of block is grey-colored trench material.
Pottery: mixed lot - small
Breccia-like soil is more prevalent as the sounding became deeper.
Depth of sounding: (E baulk) c. .50m
Thickness of block: c. .15m
Bone fragments found.
Possible E turning of wall trench - breccia is cut on N end of sounding

(5) Extension following Omega 3rd Sounding (A7) (3 NS x 2 EW)
Level I: pottery; mixed lot - small
Stones of Omega encountered.
Level II: soil is reddish
Omega continues N, and perhaps there is evidence of terracing.
The burned area in the 2nd Sounding had no stones, but in this

sounding, the stones resume again.

- (b) Extension following Omega (A7) 4th Sounding
 Level I: pottery: mixed lot - small
Tooth found. 75-793X
 To be continued.

11 July 1975

- (1) Extension following Omega (B7) (5th Sounding)
 Level I: pottery - mixed lot - moderate
 NW: (1) piece of molded ware
 Bone fragments found.
 - Omega seen to have possible door space, also it continues both
 W and E. It makes a corner with wall Kappa.
- (2) Continuation of Sounding in A11, A12, A13
 (A) Bank straightened across EW sounding in A12
 Level III: pottery - mixed lot - moderate
 Level III is the soil under the tile fall, it is 10 yr 4/3 "brown"
 and full of tiles.
- (B) Deepen sounding in level III
 NW: (1) sea-shell
 More ceramic material towards W
 Level IV: soil becomes redder - 10 yr 4/4 "dark yellowish brown"
 pottery: mixed lot - small - sparse in E
- (3) Small Sounding in E of A12
 To check relationship between Beta West and tile fall.
 Level III: pottery: mixed lot - moderate
 Floor makeup encountered below wall - also some tiles.
 There were many round pebbles, also fragments of charcoal = destruction
 level.
 Conclusion: floor makeup is possibly same period as wall.

(4) E Extension of Kappa (B6)

To check on its direction after connex made with Omega.

75-805X

Level I: pottery: mixed lot - large ~~to~~ STOP

Base fragments found.

we: (1) pieces of figured pottery

Well seen to continue E, but large stones thin out, possibly because of plow damage.

Soil becomes more like breccia towards E

Wall trench is visible. It is tiles and lighter-colored soil.

Sounding was extended E about 6.00m.

JUNE 23, 1975

E-W CUT, AREA C (Between B west and ~~west~~ south walls).

In order to examine stratigraphy within the farmhouse a one-metre-wide trench was opened beginning with level 2.

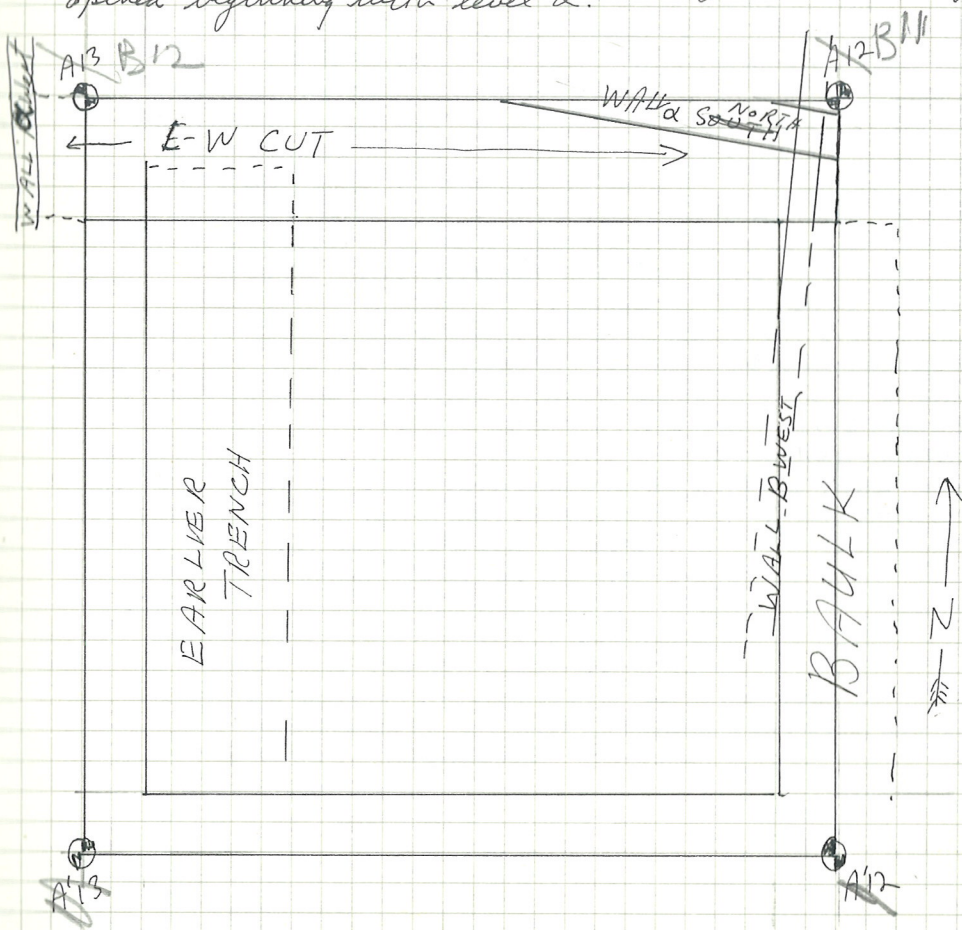

Level 2 - Soil: colour was Brown, 10YR 5/3; much tile, since this was a tile level. Some stones; very little pottery, coarse; earth loose.

In the western part of the trench a rectangular area of dark grayish brown soil 10YR 3/2 was discovered (see diagram; part of area marked "earlier trench"). it measured 81 x 42 cm, beginning 93 cm below stake B11, ending at 1.22 m. It was discovered that professor Carter had dug a trial trench here and filled it in later.

~~The rest of~~ The tile layer (level 2, beginning at 78 cm. below B11) ended at a depth of 89 cm.

Level 3 - The soil here was the same as in level 2, but tightly-packed and containing more stones. ~~Very little~~ No tile fragments were found; pottery featured coarse ware, black glaze and African red slip.

Digging ended at depth 1.22 m. below stake B11.

= 1m

A12

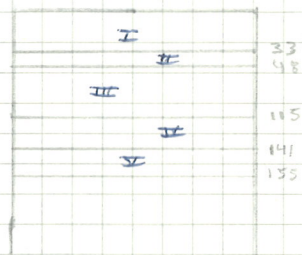

Thickness of : Level I 1.33
II 1.15
III 1.67
IV 1.26
V 1.14

Total Depth : 1.55m

Level I : yellowed earth
Level II : tiles
Level III : yellow soil
Level IV : darker yellow soil
Level V : dark grey soil and fieldstones

14 July 1975

A11

(1) Sounding in A12 (cont)

Level II: cleaned up - pottery bagged separately

Level I: floor located at 1.45 W, 1.45 E from B13. Top of floor is beginning of Level II.

The floor was at the same depth at both the E and W ends of the sounding.

Color change: soil is 10% 3/4 "very dark greyish brown" and full of pebbles

Pottery: None

But earth is not yet virgin at this depth.

The floor in A11 is at 1.20m from B13.

Note: Fieldstones uncovered in E portion.

Depth: 1.55m (B13)

Depth of Level I: 1.55m (B13)

This concentration may correspond with the one in A11, but A12 stones are larger, and the depth of the stones in A11 is only 1.30m (B13).

(2) Sounding in A10 and A11 (c. 5.00m EW x 1.50m N-S) (Between Walls Alpha North and Alpha South)

Sounding divided in half:

East is Area A (c. 3.00m)

West is Area B (c. 3.00m)

Area A Level II:

pottery = mixed lot - moderate

roof tiles: moderate - large amount

Bone fragments found.

4 July Baulk AII, A'II

41

- Level 1 was taken down to a depth of -27m. There were few ceramic finds and few roof tile fragments. Fragments of bone were discovered in this level.
- LEVEL 2 was taken down to a depth of -40m. Shards were scarce and there were no roof tile fragments. In this level was to be found the red red terracotta layer called "floor-makeup" which was noticed in square AII & A'II.
- LEVEL 3 was a tile deposit in which an abundance of charcoal was discovered which was not discovered when A'II was excavated. Bone was also found. A large stone, still in the western baulk, was found immediately under the tile deposit; its position corresponds to the large, worked stone immediately under the tile deposit in AII.
- LEVEL 4 was taken down to a depth of -87m at which a large field stone was unearthed. A thick deposit of charcoal surrounded the stone. In A'II this level was designated as a floor level. Tile fragments were scarce as were ceramic finds, which for the most part, were black glaze. Bone also was found.
- LEVEL 5 had few shards and no tile fragments. Charcoal was abundant and a conical iron object was discovered. The full depth of the field stone from level 4 was not, as yet, reached.

7 July Bank A'11, A'10

LEVEL 1 was the level of plowed earth. There were roof tile fragments, flintstones and pieces of limestone; this corresponds to the situation at the bottom of level 1 in A'10 and not in A'11. There were few shreds. A fragment of marble was found. Wall x south was uncovered and the red terracotta "floor-makeup" was seen to spread slightly over the stones in a low spot in the wall.

8 July Bank A12 - A11

Level 1 was plowed earth. Shreds & roof tile fragments were scarce.

LEVEL 2 was the level of red "terracotta floor-makeup" which extended above the tile deposit. This tile deposit is level 3 in squares A10 and A'11 and level 2 in square A12.

10 July

PRAEFORNIUM, E'14 + E'13

* NOTE the level dug by N.T., previously labelled 2, 3, 4, are now combined by W.W. into level 2.

75.777T
75.789P
75.790P
75.791X
75.776T

LEVEL 2, continued. In this level there were many roof tile fragments, fragments of limestone & field stones of varying sizes. The level was taken down to a depth of ~ 74 m on the eastern bank and ~ 82 m on the western, as measured from surface level. A great amount of ceramics was found; a large quantity of ware was also discovered. A small fragment of a terracotta antefix was found at a depth of ~ 45 m, from the surface of the northern bank, four worked stones, width approx. ~ 25 m, were unearthed. These stones apparently were dragged by the plow from Wall B west.

11 July

PRAEFORNIUM, EXTENSION TO THE EAST, E'14, E'13

LEVEL 1 was plowed earth, 10 YR 4/2. There was a moderate amount of roof tile fragments; ceramics were scarce. This level went to a depth of ~ 28 m from base of stake E'13.

LEVEL 2 was hard-packed, pebbly soil, 10 YR 4/2. At a depth of ~ 29 m (E'13) a stone was found in the eastern bank which appears to be a continuation of Wall B west; more of Wall B west was found in the southeast quadrant of the square moat of Wall B west was unearthed. ~ 20 m from the northern bank a semi-circular area of light coloured, clay-like soil was discovered, 2-5 YR 6/2. This area of light soil was bounded in the south by the four stone dug from wall B west.

14 July

47

PRAEFORNIUM, EXTENSION TO THE EAST, E'13

LEVEL 2 cont. This level continued to depth of 70 m (E'13). At a depth of 68 m (E'13) a foundation course of tile for Wall γ south was discovered; the width of this course was 65 m. This course of tile lies in turn upon a lower course of worked stone, width 62 m. The westerly most (and largest) of these stones is 62 x 85 m (height as yet, undetermined). A dowel hole is to be noted in this stone. The other stones of this course are considerably smaller. This course of tiles and worked stones peters out near the eastern bank where it would have intersected w/ Wall β west.

LEVEL 3 FOUNDATION TRENCH dug along Wall γ south (E'14) and the foundation course for Wall γ south (E'13). Only one sherd was found; the were few tile fragments.

15 July

SOUNDING IN A'11 & A'10

49

15-827P

15-833P

15-836X

LEVEL 2 - the colour of the soil was greyish-brown 10 YR 4/2. There were few roof tile fragments & a moderate amount of pottery. Level 2 began w/ the red clay floor make up & ended w/ a tile deposit which began level 3. LEVEL 2 - 36 - 63m as measured from base of stake A'10.

15-826P

15-828B

LEVEL 3 began w/ a great concentration of roof tiles which became scarcer as the level ended. Colour was 10 YR 4/2. A great deal of Greek pottery was unearthed. Depth 64-80m (A'10).
NW: base of small unguentarium
many bone fragments found.

15 July 1975 A 19

1st Sounding (cont. of Sounding in A'11 + A'10)
(Level I previously excavated)

Level II: Soil color: 10 yr 4/2 "grey-brown"
Pottery: mixed lot - moderate
Bone fragments found.
Tile fragments: scarce

In W extremity of trench, a series of small stones + tiles was uncovered which appears to foundation course for wall to west, the width of this course being .42m.

Level III: separated from II by thin deposit of tile fragments
At a depth of .45-.48m from stake A10. Below line of tiles, fragments became very scarce + soil color changed to yellow-brown
7.5 yr 4/4. much Greek pottery found. Bone fragments discovered. Less pottery in each successive battuta.

Level IV: same color as III
No pottery found.
Series of large fieldstones in no apparent order was discovered.

2nd Sounding (SE of 1st Sounding) (B'9)

Levels I + II had no ceramics or roof tiles.
Soil color: 10 yr 4/2 - both levels

Level III: similar in color + composition to III in "1st Sounding in A'9." Also great quantity of Greek sherds.
Bone fragments found.

W: 1, 1cm weight
S of large block + near wall J East was uncovered possible filling of tile + coarse-ware fragments.

16 July 1975

(1) B'9 Sounding 2 (cont)
Level 3: pottery: mixed lot - moderate
two NW bags of sherds

(2) A'11 - A'10 1st battuta
Level 4: tile layer which is thick in the W 1/2 of the trench
and in E 1/2 becomes a layer of pebbles and small fieldstones.
Pottery: mixed lot - moderate
2nd battuta
Level 4: pottery - mixed lot - moderate

(3) Sounding over S Extension of Φ (F'8 - F'7)
Level 1: pottery: mixed lot - small
Wall trench continues S.

(4) Sounding over E wall perpendicular to Φ (E'6)
Level 1: pottery - mixed lot - small
Breccia hit about .20m from surface.
Soil is very stony and yellowish towards E.
Trench material appears stronger in W, continues E, and
abruptly terminates about .16m from E bank.
Trench material still has tiles in it + some smaller stones.
Roof tiles: small amount

(5) E Sounding to follow Φ (F'7 + G'7)
Level 1: pottery: mixed lot - scarce
Breccia hit at .50m.
Wall trench goes S, but not E
Width: .80m
Trench material is same dark soil and tile fragments.
Bone fragments found
Roof tiles: small amount
Level 2: trench material itself

75-844X

57

pottery mixed lot - small amount
Trench appears to continue S (possibly E)
Some stones left in trench material.

- (6) E Sounding in C'6 (2x2)
Level I: pottery: mixed lot - small
Purpose: to check on possible E turn of wall trench.

17 July 1975

- (1) E Sounding in C'6 (cont)
Level I: pottery - mixed lot - moderate
Soil was strong with roof tile fragments
Stones encountered in NE corner - they are set in trench material
And surrounded by braccia.
Largest: c. 20 x 30 cm
NW: piece of marble
Along S bank is line of trench material mixed with braccia.

- (2) E Sounding to follow Ψ (cont) (B'7)
Level I: pottery - mixed lot - small
N.B. bulldozer cut through some of trench.
Bone fragments found.
Stones and tiles encountered in wall trench material.
Wall appears to curve SE and trench material widens out.

Level II: trench material itself
Darker soil
pottery: mixed lot - small
NW: molded sherd
Tiles and stones make an ellipse measuring c. 1.00m between
its "arms"
Bone fragment found.

- (3) Canal N Bank Sounding 5 W Extension over EW wall
Level I: pottery: mixed lot - large
Iron + bone found.
Much anchaic pottery, 2 statuette fragments.
Discovered: large block of conglomerate fill one by canal.
Tiles and pavement of sorts.