

US	LOCALITY	AREA	DATE	CODE						
	CHERSONESOS	SOUTH REGION	12/07/02	CH102 209						
AREA/TRENCH NO.	SECTION	QUADRANT	ROOM	ORIENT.	FROM	LEVEL	TO	STRAT UNIT		
SECTOR PA			26					209 NAT. ART. X		
PLANS	SECTIONS	ELEVATIONS	PHOTOGRAPHS	QUANTIFICATION TABLES						
DEFINITION						POSITION				
LAYER OF SOIL						VERY NEAR US 29				
DISTINCTIVE CRITERIA										
VARIATION IN: COLOUR <input type="checkbox"/> CONSISTENCY <input checked="" type="checkbox"/> COMPOSITION <input checked="" type="checkbox"/> OTHERS										
FORMATION PROCESSES										
EROSION <input type="checkbox"/> ACCUMULATION <input type="checkbox"/> CONSTRUCTION <input type="checkbox"/>			DESTRUCTION <input type="checkbox"/> ABRASION <input type="checkbox"/> AGRIC. ACTIVITY <input type="checkbox"/>			OTHERS		AGENTS:	CHARACTER: INTENTIONAL <input type="checkbox"/> CASUAL <input type="checkbox"/>	FORMATION TIME
C O M P O N E N T S	INORGANIC				ORGANIC					
	TYPE OF SOIL SOFT STONE MATERIAL - SMALL FRAGMENTS CERAMIC FRAGMENTS - SMALL FRAGMENTS TILES OTHER - IRON NAIL				FAUNAL REMAINS - SMALL VEGETAL REMAINS - SMALL ROOTS OTHER					
C O N S I S.	LOOSE <input type="checkbox"/> SOFT <input checked="" type="checkbox"/> FRIABLE <input type="checkbox"/> COMPACT <input type="checkbox"/> HARD <input type="checkbox"/>			COLOUR			MEASUREMENTS			
				MUNSELL MOIST = 5YR 4/2			On the Top the depth is 20cm. about			
STATE OF PRESERVATION										
NOT BAD										
DESCRIPTION										
Layer of dark reddish gray situated close to southern wall of the room, US 74, and @ the eastern wall of the same room, US 29. The soil has a soft consistence - It contains small fragments of stones, roots and pottery -										
P H Y S I C A L S E Q U E N C E	SAME AS			BONDED TO			LATER THAN			
	ABUTTED BY			ABUTS						
	COVERED BY			COVERS						
	CUT BY			CUTS						
	FILLED WITH			FILLS						
PA 215, PA 181,			PA 29, PA 210, PA 218, PA 221							

INTERPRETATION

DATING ELEMENTS

DATE

PERIOD OR PHASE

POTTERY, TILE AND OTHER FREQUENT FINDS

QUANTITATIVE DATA FOR FINDS

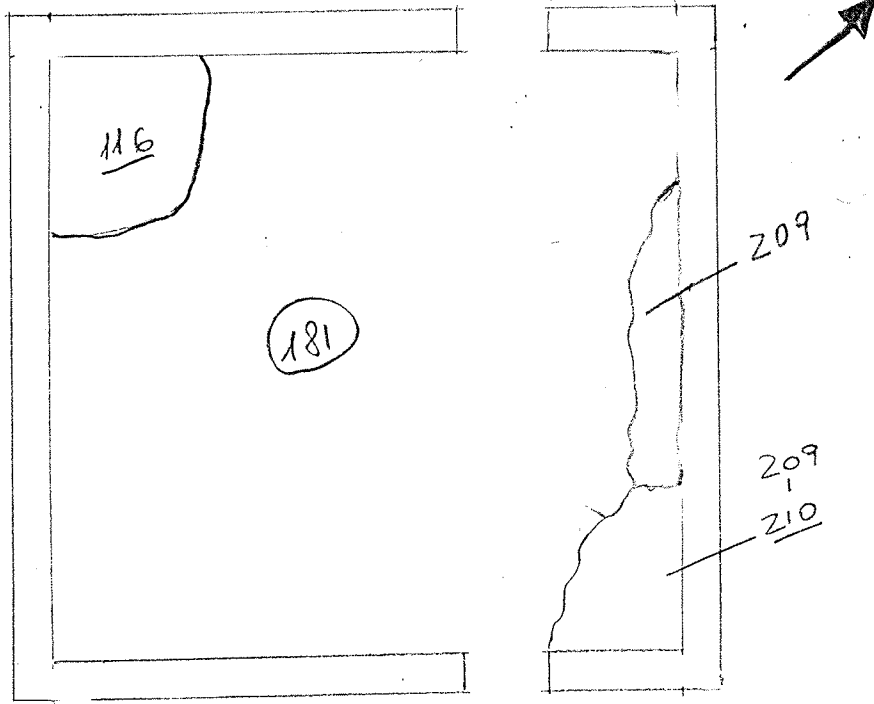

OSTEOLOGICAL FINDS

MALACOLOGICAL FINDS

BOTANICAL FINDS

FINDS

STRATIGRAPHIC RELIABILITY:

- NONE
- BAD
- MEDIUM
- GOOD

SIEVING

BY HAND /

TYPE OF SIEVE

SAMPLING

FLOTATION /

DIRECTOR

SEDIKOVA/ARTHUR

SITE SUPERVISOR

Brunella Bruno