

SITE: CH06SR YEAR: 06 ROOM # OF AREA NAME: Courtyard CONTEXT NUMBER: 6897

TYPE (positive, negative, wall): Negative DEFINITION (cut in floor of X, fill of pit Y, north wall of room Z, etc.): Cut filled by 0877 ~~0877~~ in Central Area 3, Courtyard

DESCRIPTION (include consistency, color, composition, inclusions, dimensions; for cuts, also include shape and orientation):
 Large cut filled by context 0876 & 0877 (which are related to metalworking activities) with ~~the~~ dimensions that are \approx 2.1 M (NW-SW) likely x 1.65 M (NW-SE) and \approx 20-25 cm in depth. The sides are gently sloping and irregular & the bottom is uneven.
 - If this is accurately reflected by drawing in ATR NB p. 92, it has rather the form of two pits, one subrectangular and one circular, joined together; notebook pits circular pit in center of long side of rectangle but photo suggests more at one corner (see sketch on back)

MUNSELL COLOR: [Blank]

FORMATION PROCESSES: NATURAL ARTIFICIAL (circle one) CASUAL INTENTIONAL (circle one) TYPE: metalworking

STATE OF PRESERVATION: Very poor Poor Medium Good Very Good STRATIGRAPHIC RELIABILITY: Very poor Poor Medium Good Very Good

COVERS: [Blank] COVERED BY: [Blank]

CUTS: 759 (?), 782 (?) CUT BY: [Blank]

FILLS: [Blank] FILLED BY: 0877, 0876

ABUTS: [Blank] ABUTTED BY: [Blank]

EQUALS: [Blank] BONDS WITH: [Blank]

INTERPRETATION:
 Large cut filled by contexts associated w/ metalworking activities.
 - Fill is certainly associated with metalworking phase, but if pit was as photo suggests, similarity to other square/rectangular and circular pit combinations is striking

MATERIAL DATABLE IN FIELD? (if yes, specify): [Blank] PRELIMINARY DATE: [Blank]

FINDS (tick): Pot Bone Glass Metal Wood Leather Tile Other None TILE: (quantity buckets?): [Blank] SPECIAL FINDS (number and description, continue on back if necessary): [Blank]

FLOAT? (Y/N) SAMPLE? (if yes, # and type): [Blank] SECTION? (Y/N)

PHOTO? (Y/N) PLAN? (Y/N) NOTEBOOK PAGES: 81-83 SKETCH ON BACK? (Y/N)

STRATIGRAPHIC NOTES/DOUBTS (include any comments on methods, contamination, excavation conditions, or anything else that seems relevant):
 what contexts are covered by 0877/0876? [912+999]
 - layer into which pit cut not noted, but seems to be 759 - see, however, sheet for 759 - confusion about whether

DATE: 18.VII.06 INITIALS: JMW CLOSED (tick):

759 descends to bed rock at N end of Area 3, or a surface associated with wall remains was missed and excavated together w/ 759

SPECIAL FINDS (continued)

SKETCH

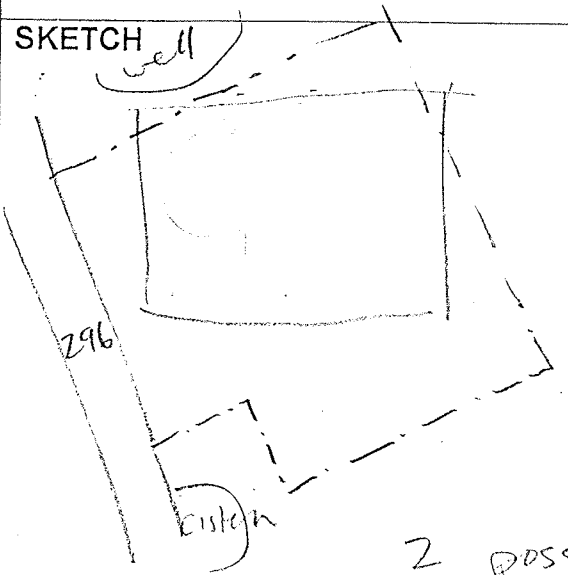

2 possibilities
from ATR NB p. 92

suggested by AHCHOGSR1439

