

SITE CH 06 SR	YEAR 2006	ROOM # or AREA NAME Room 38, Complex 2	CONTEXT NUMBER 0753
TYPE (positive, negative, wall) Positive	DEFINITION (cut in floor of X, fill of pit Y, north wall of room Z, etc.) Brown soil with inclusions in SE part of Room 38		
DESCRIPTION (include consistency, color, composition, inclusions, dimensions; for cuts, also include shape and orientation) Layer of loosely packed, medium brown soil, heavy with debris of all types - especially iron nails (50), pottery shreds, glass fragments and bronze (copper alloy) coinage. This layer was very thick - easily 20 cm - and filled the whole of cut 728. There was very little ash and <del>very</del> charcoal though, as we reached the next context layer, there was an increasing amount of clay lumps in the soil. There were also very many medium - large stones (many re-used).			
MUNSELL COLOR 2.5Y4/2			
FORMATION PROCESSES NATURAL <u>ARTIFICIAL</u> (circle one) CASUAL <u>INTENTIONAL</u> (circle one) TYPE: <u>Filling</u>			
STATE OF PRESERVATION <input type="checkbox"/> Very poor <input type="checkbox"/> Poor <input type="checkbox"/> Medium <input checked="" type="checkbox"/> Good <input type="checkbox"/> Very Good		STRATIGRAPHIC RELIABILITY <input type="checkbox"/> Very poor <input type="checkbox"/> Poor <input type="checkbox"/> Medium <input checked="" type="checkbox"/> Good <input type="checkbox"/> Very Good	
COVERS <u>768</u>	COVERED BY <u>712, 754</u>		
CUTS <u>r</u>	CUT BY		
FILLS <u>728</u>	FILLED BY		
ABUTS	ABUTTED BY		
EQUALS <u>746</u>	BONDS WITH		
INTERPRETATION This layer appears to be a large fill - possibly from construction debris - intended to raise the level of the floor of a previous habitation. This layer raised floor level to just below walls 257 and 207.			
MATERIAL DATABLE IN FIELD? (if yes, specify) Bronze coinage and glass - evenly date to approx. 10-11c.			PRELIMINARY DATE Mid-Byzantine
FINDS (tick) <input checked="" type="checkbox"/> Pot <input checked="" type="checkbox"/> Bone <input checked="" type="checkbox"/> Glass <input checked="" type="checkbox"/> Metal <input type="checkbox"/> Wood <input type="checkbox"/> Leather <input checked="" type="checkbox"/> Tile <input type="checkbox"/> Other <input type="checkbox"/> None	TILE: (quantity buckets?) <u>15</u>	SPECIAL FINDS (number and description, continue on back if necessary) 3426 - object (Bronze/iron) 3428 - Piece of Bronze 3429 - Bronze Coin 3431 - Frag. Bronze Coin 3432 - glass bracelet	
FLOAT? (Y/N) <u>(Y)</u>	SAMPLE? (if yes, # and type) <u>none</u>	SECTION? (Y/N) <u>(Y)</u>	
PHOTO? (Y/N) <u>(Y)</u>	PLAN? (Y/N) <u>(Y)</u>	NOTEBOOK PAGES 11, 12, 15-16, 18-19, 21-23, 24	SKETCH ON BACK? (Y/N) <u>(Y)</u>
STRATIGRAPHIC NOTES/DOUBTS (include any comments on methods, contamination, excavation conditions, or anything else that seems relevant) There is doubt about the mingling of layers 754 & 753. Although, at one point, it appeared that 754 (which covered 753) had been fully removed, the further we went down in that area, the more we find greyish soil that appears to still be 754. So, at this point,			
DATE <u>29 June 2006</u>		INITIALS <u>lll</u>	CLOSED (tick)

it appears that 753 surrounded 754 but, we have begun to treat them as the same layer.

SPECIAL FINDS (continued)

- 3433 - Bronze object
- 3434 - Bronze coin
- 3435 - Stone Ball
- 3438 - Bronze coin frag.
- 3439 - Lead bar
- 3440 - Arch. detail
- 3441 - Bronze object
- 3443 - Stone Ball
- 3444 - Stone weight
- 3445 - Bronze coin
- 3446 - Marble frag.

- 3448 - Worked stone
- 3450 - Arch. frag. stone
- 3451 - Bronze coin
- 3452 - Bronze piece
- 3454 - Bronze coin
- 3456 - Arch. frag.
- 3457 - Bronze coin
- 3458 - Iron object
- 3459 - Arch. frag.
- 3460 - Bronze coin
- 3461 - Bronze coin frag.

- 3464 - Bronze coin
- 3465 - Iron object
- 3467 - Bronze coin
- 3468 - Iron object
- 3469 - Iron clamp
- 3470 - Arch. frag.
- 3475 - Bronze coin
- 3476 - Arch. frag.
- 3477 - Iron object
- 3478 - Bronze object

SKETCH

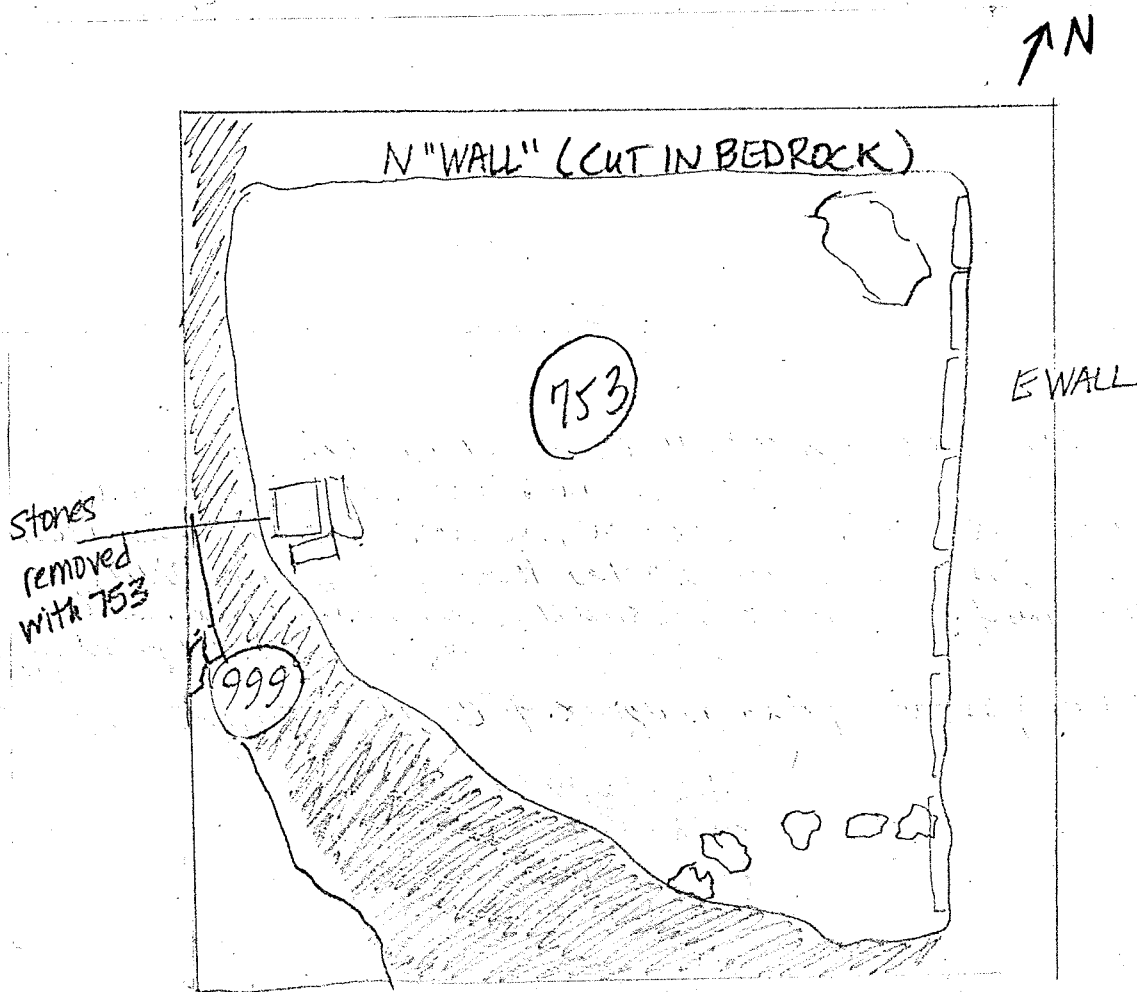

- Small finds - cont.
- 3479 - Bronze piece
  - 3480 - Bronze pieces
  - 3481 - Iron object
  - 3482 - Bronze coin
  - 3483 - Bronze coin

- 3484 - Bronze piece
- 3485 - Iron object
- 3487 - Bronze object
- 3488 - Bronze object
- 3489 - Bronze pieces
- 3490 - Bronze coin

- 3491 - Bronze coin
- 3493 - Arch. frag.
- 3497 - Bronze pieces
- 3501 - Bronze object
- 3503 - Iron object
- 3504 - Stone worked object
- 3654 - Object, iron (from sample)