

SITE CMOC	YEAR 2006	ROOM # or AREA NAME Stenopos	CONTEXT NUMBER 797
TYPE (positive, negative, wall) Pos	DEFINITION (cut in floor of X, fill of pit Y, north wall of room Z, etc.) Surface 3 of the Stenopos.		
DESCRIPTION (include consistency, color, composition, inclusions, dimensions; for cuts, also include shape and orientation) Compact brown soil including tile and ceramic vessels ^{fragm} stones. Depth: ca. 5 cm.			
MUNSELL COLOR 10 YR 3/2			
FORMATION PROCESSES NATURAL <u>ARTIFICIAL</u> (circle one) CASUAL <u>INTENTIONAL</u> (circle one) TYPE:			
STATE OF PRESERVATION <input type="checkbox"/> Very poor <input type="checkbox"/> Poor <input type="checkbox"/> Medium <input checked="" type="checkbox"/> Good <input type="checkbox"/> Very Good		STRATIGRAPHIC RELIABILITY <input type="checkbox"/> Very poor <input type="checkbox"/> Poor <input type="checkbox"/> Medium <input type="checkbox"/> Good <input checked="" type="checkbox"/> Very Good	
COVERS 802		COVERED BY 796	
CUTS		CUT BY 779	
FILLS		FILLED BY	
ABUTS		ABUTTED BY	
EQUALS		BONDS WITH	
INTERPRETATION Specially prepared surface of the Street!			
MATERIAL DATABLE IN FIELD? (if yes, specify)			PRELIMINARY DATE
FINDS (tick) <input checked="" type="checkbox"/> Pot <input checked="" type="checkbox"/> Bone <input type="checkbox"/> Glass <input type="checkbox"/> Metal <input type="checkbox"/> Wood <input type="checkbox"/> Leather <input checked="" type="checkbox"/> Tile <input type="checkbox"/> Other <input type="checkbox"/> None		TILE: (quantity buckets?)	SPECIAL FINDS (number and description, continue on back if necessary) 3627 - Coin (Bronze) 3630 - Iron Obj.
FLOAT? (Y/N)	SAMPLE? (if yes, # and type)	SECTION? <input checked="" type="checkbox"/> (Y/N)	
PHOTO? (Y/N)	PLAN? (Y/N)	NOTEBOOK PAGES AS: 6-7	SKETCH ON BACK? <input checked="" type="checkbox"/> (Y/N)
STRATIGRAPHIC NOTES/DOUBTS (include any comments on methods, contamination, excavation conditions, or anything else that seems relevant)			
DATE 24.VII.06		INITIALS AS	CLOSED(tick)

SPECIAL FINDS (continued)

SKETCH

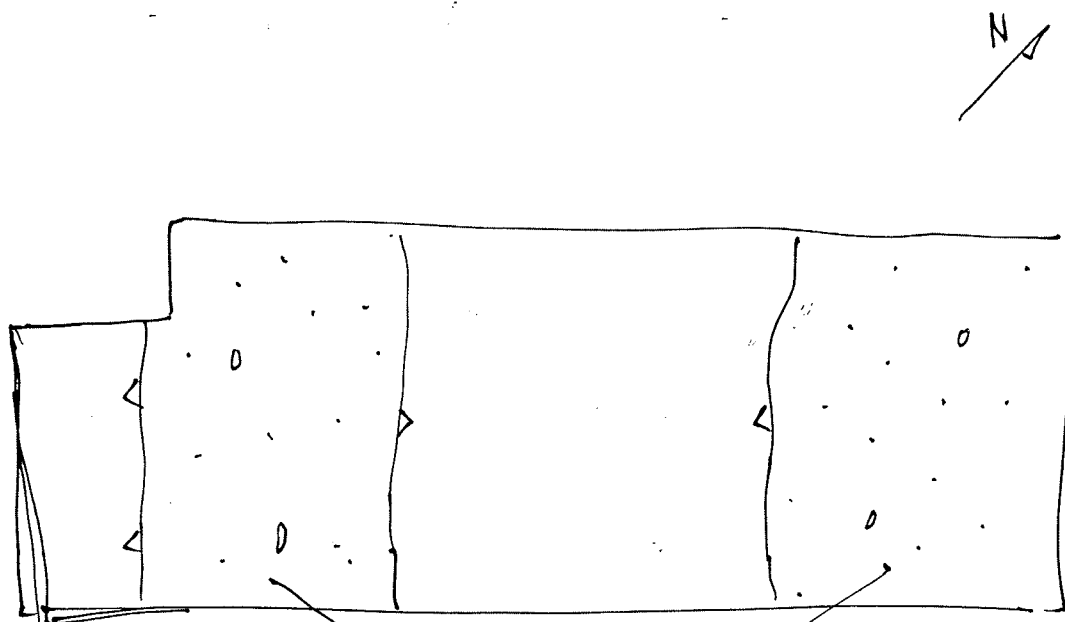

797

AS.