

SITE CH	YEAR 04	ROOM # or AREA NAME Room 32	CONTEXT NUMBER 462
TYPE (positive, negative, wall) positive	DEFINITION (cut in floor of X, fill of pit Y, north wall of room Z, etc.) Post hole fill for landing rm 32		
DESCRIPTION (include consistency, color, composition, inclusions, dimensions; for cuts, also include shape and orientation) Possible fill for posthole along with top of stair possibly supports for second story landing. Fill loose brown / bedrock inclusion. Also small fragment of wood found in hole.			
MUNSELL COLOR	ELEVATIONS (if more than one, sketch locations on back)		
FORMATION PROCESSES NATURAL <input type="checkbox"/> ARTIFICIAL <input checked="" type="checkbox"/> CASUAL <input type="checkbox"/> INTENTIONAL <input type="checkbox"/> TYPE:			
STATE OF PRESERVATION <input type="checkbox"/> Very poor <input type="checkbox"/> Poor <input type="checkbox"/> Medium <input checked="" type="checkbox"/> Good <input type="checkbox"/> Very Good		STRATIGRAPHIC RELIABILITY <input type="checkbox"/> Very poor <input type="checkbox"/> Poor <input checked="" type="checkbox"/> Medium <input type="checkbox"/> Good <input type="checkbox"/> Very Good	
COVERS		COVERED BY 461	
CUTS		CUT BY	
FILLS 463		FILLED BY	
ABUTS		ABUTTED BY	
EQUALS		BONDS WITH	
INTERPRETATION PTO.			
MATERIAL DATABLE IN FIELD? (if yes, specify)			PRELIMINARY DATE
FINDS (tick) <input type="checkbox"/> Pot <input type="checkbox"/> Bone <input type="checkbox"/> Glass <input type="checkbox"/> Metal <input type="checkbox"/> Wood <input type="checkbox"/> Leather <input type="checkbox"/> Tile <input type="checkbox"/> Other <input type="checkbox"/> None		TILE: (quantity buckets?)	SPECIAL FINDS (number and description, continue on back if necessary)
FLOAT? (Y/N)	SAMPLE? (if yes, # and type)	SECTION? (Y/N)	
PHOTO? (Y/N)	PLAN ? (Y/N)	NOTEBOOK PAGES	SKETCH ON BACK? (Y/N)
STRATIGRAPHIC NOTES/DOUBTS (include any comments on methods, contamination, excavation conditions, or anything else that seems relevant)			
DATE 2/17/04		INITIALS SW	

Good ✓

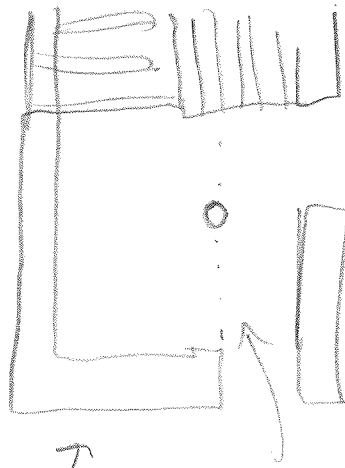

indicates its alignment with
 end of wall and top of stairs. This
 alignment is supported by presence of 460x461
 contents defined to the NW of this line.
 So space different. Support a second stage /
 banking possible & probable that this banking
 led to space one room 36.